

1 SECTION
1/2" = 1'-0"

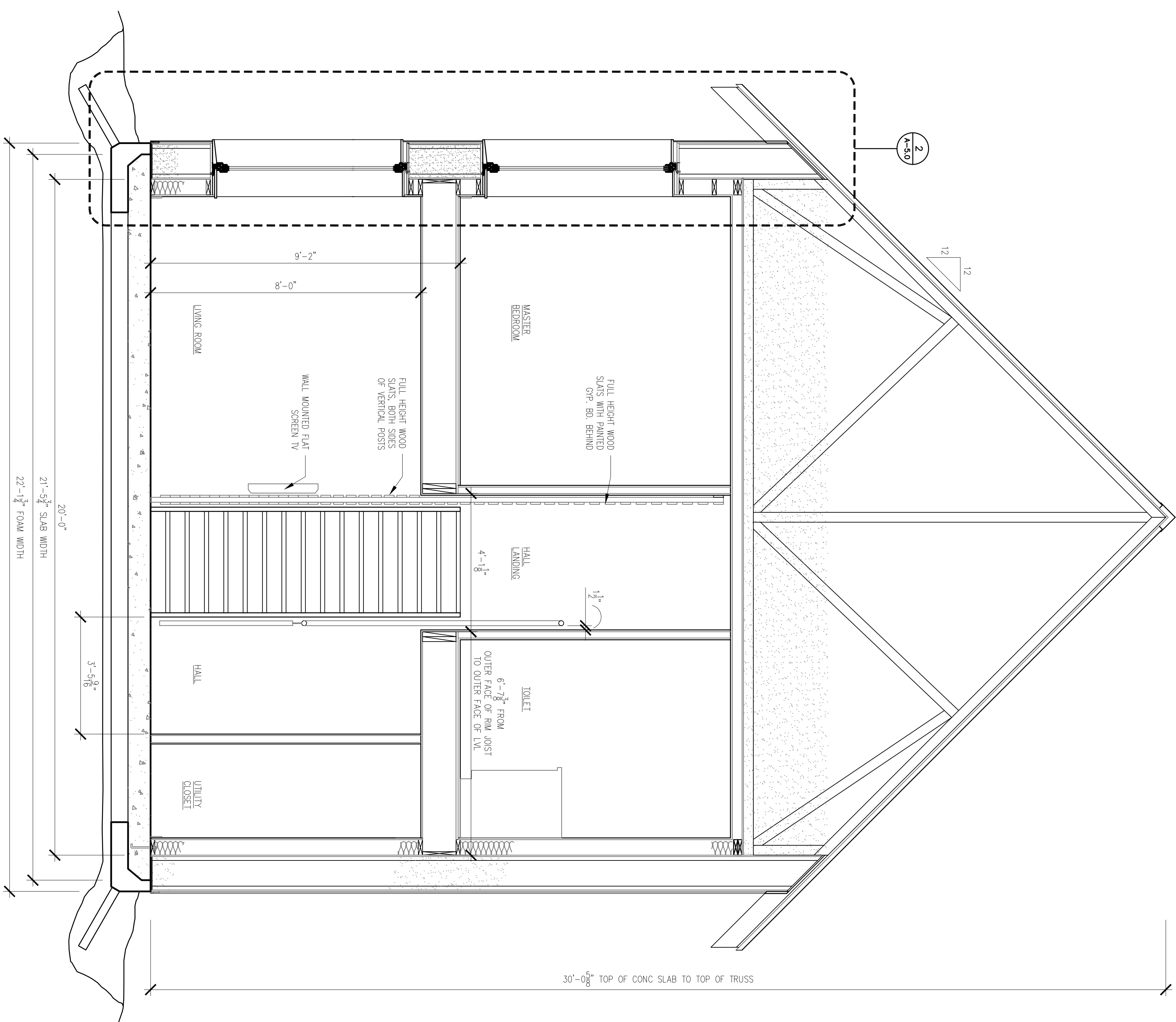

2 PARTIAL ELEVATION
1/2" = 1'-0"

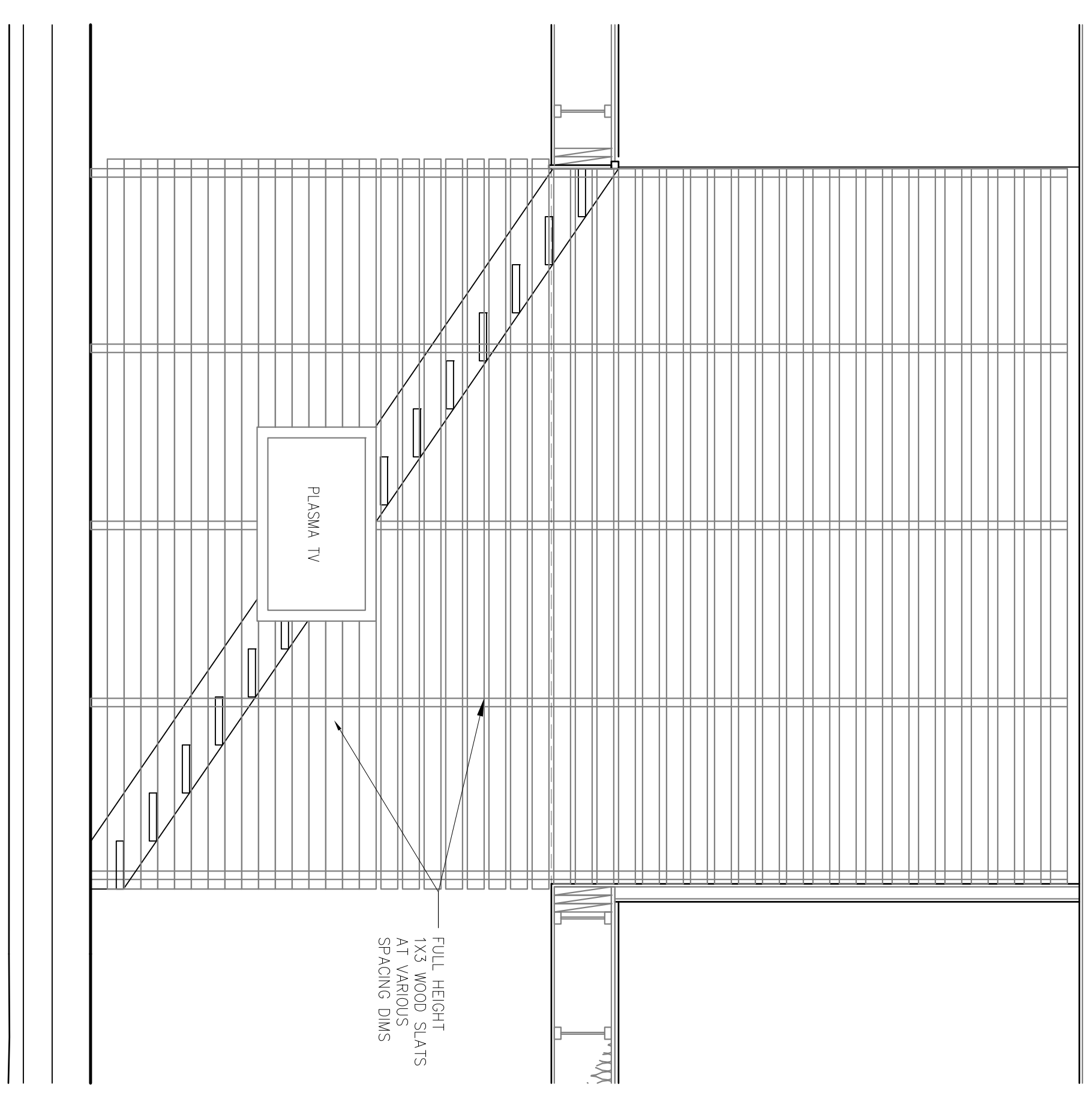

Drift
DESIGN OFFICE
DRIFT INC. : DESIGN OFFICE
KAREN BALA AIA LEED AP
305 COMMERCIAL STREET
PORTLAND MAINE 04101
TEL: 917-776-3543

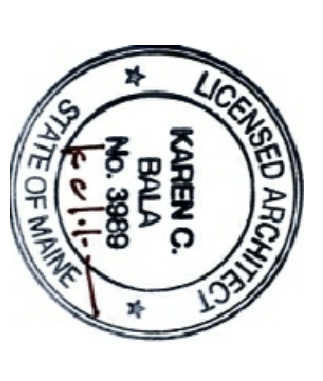

STAMP:

760 OCEAN AVE

760 Ocean Avenue
Portland Maine 04103

RELEASE HISTORY
DATE: 15 APR 2013 BUILDING DEPT FILING

REV	DATE	REVISION

REVISION HISTORY
SHEET TITLE:
BUILDING SECTIONS

SCALE: 1/2" = 1'-0"
DATE:
DRAWN BY: KCB
CHECKED BY:
DRAWING #:

A-3.0