

GENERAL STRUCTURAL NOTES

SI Job # 15-0169
 Portland Retirement Residence
 Box Culvert Design
 Portland, ME

DESIGN LIVE LOADS: MUEBC, ACI 318 and AASHTO/HY-25
 * Vehicle/Traffic TA400 (56,438 #/ Axle)

FOUNDATION:
 * Based on geotechnical report No. 14-1188 S by S.W. Cole, dated January 16, 2015. See report for earthwork requirements. Soils engineer shall verify soil conditions and types during excavation and prior to concrete placement.
 * Footings shall bear on ledge, or otherwise be placed on undisturbed natural soil or compacted fill tested and approved by soils engineer where ledge bearing is not possible.
 * Maximum design soil pressure: 4,000 psf on crushed stone on firm virgin soil.

CONCRETE AND REINFORCEMENT:
 * Concrete shall conform to applicable provisions of ACI-301 and 318.
 * Minimum 28 day compressive strength (f'c)
 * Footings, slab, and walls: 5,000 psi w/ 6% air entrainment, max w/c ratio = .42
 * Cement Type: I/II
 * Deformed reinforcement: ASTM A615 grade 60, except bars specified to be field-bent, stirrups, and ties which shall be grade 40.
 * Reinforcement shall be fabricated and placed per ACI Manual of Standard Practice (ACI-315). At splices, lap bars 50 diameters unless noted otherwise.
 * Concrete cover over reinforcing: 1 1/2" for concrete placed against forms; 3" for concrete placed against earth. See also drawings.
 * Keep reinforcement clean and free of dirt, oil, and scale. Oil forms prior to placing reinforcement.
 * All reinforcing steel to be epoxy coated
 * All reinforcing steel **crossing cold joints** shall be stainless steel [when required by DOT].
 * Repair damaged epoxy coated bars with approved repair coating.
 * Grout: 2500 psi at 28 days. Vibrate to consolidate.

STRUCTURAL ERECTION AND BRACING REQUIREMENTS
 * The structural drawings illustrate the completed structure with all elements in their final positions, properly supported and braced. The contractor, in the proper sequence, shall provide proper shoring and bracing as may be required to achieve the final completed structure.
 * These plans have been engineered for construction at one specific building site. Builder assumes ALL responsibility for use of these plans at Any Other building site. Plans shall not be used for construction at any other building site without specific review by the engineer.
 * Observations of foundation reinforcing as required by the owner, lender, insurer, building department or any other party will be accomplished by the engineer at the owner's expense. At least 24 hours advance notice is requested.

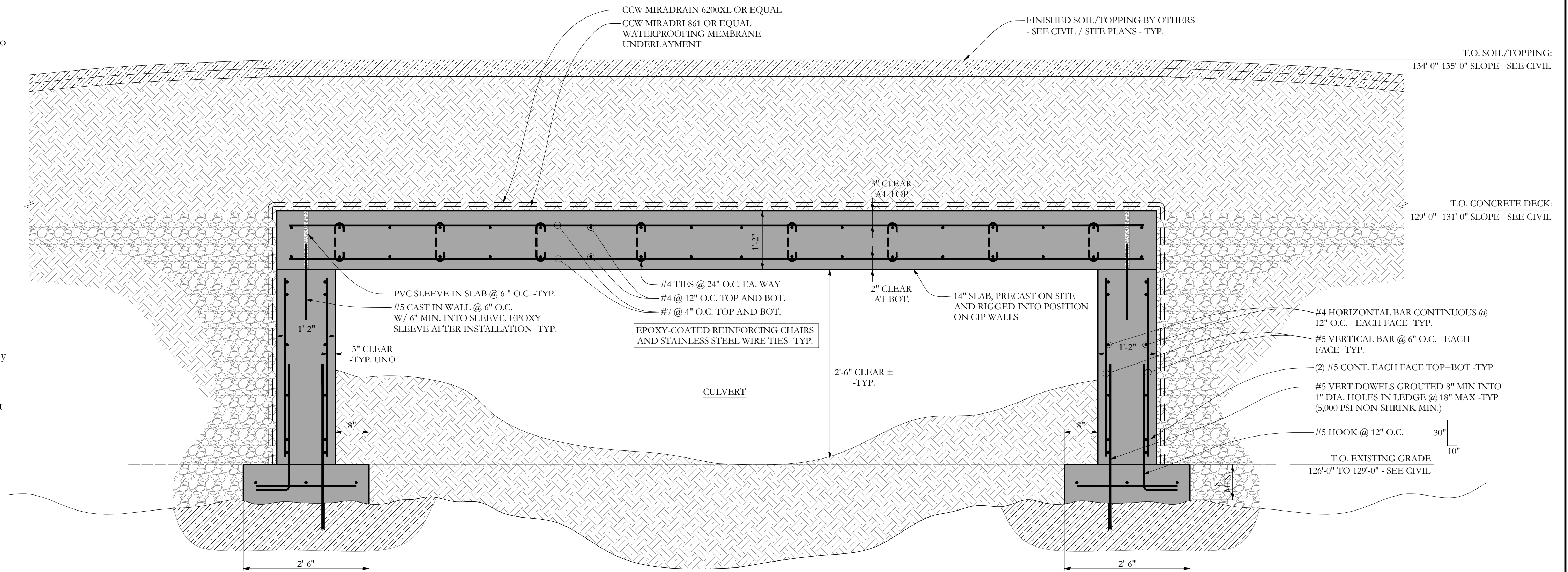

SECTION **A-S1** 3/4"=1'-0"

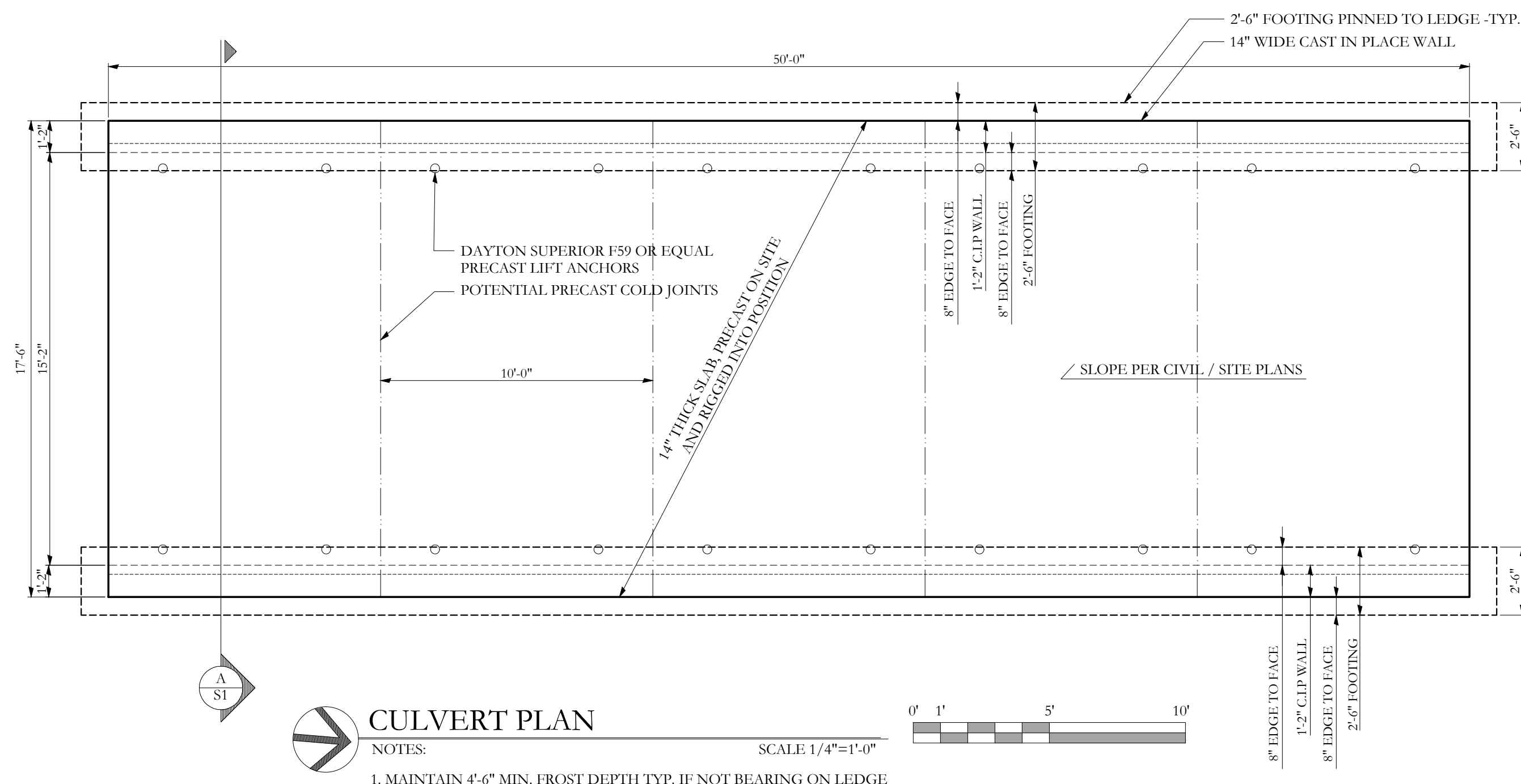

CULVERT PLAN
 NOTES:
 1. MAINTAIN 4'-0" MIN. FROST DEPTH TYP. IF NOT BEARING ON LEDGE.
 SCALE 1/4"=1'-0"

DESIGNED	CHECKED
CDM	CLB
E CDM 05-04-2015 ADDED FOOTPATHS/TRAILS & CORRESPONDING NOTE 12 D CDM 02-26-2015 REVISED UTILITIES IN OCEAN AVENUE C CDM 01-23-2015 REVISED BORINGS/PROBES B CDM 01-23-2015 PLAN REVISED TO REFLECT TITLE COMMITMENT 14030089 REVISED 1-12-15 A CDM 01-07-2015 ISSUED TO CLIENT FOR REVIEW REV. BY: DATE: STATUS: THIS PLAN SHALL NOT BE MODIFIED WITHOUT WRITTEN PERMISSION FROM SEBAGO TECHNICALS, INC. ANY ALTERATIONS AUTHORIZED OR OTHERWISE SHALL BE AT THE USER'S SOLE RISK AND WITHOUT LIABILITY TO SEBAGO TECHNICALS, INC.	

SEBAGO TECHNICALS
 WWW.SEBAGOTECHNICALS.COM
 75 John Roberts Rd. - Suite 8
 14 South Portland, ME 04240
 4076
 Tel. 207-765-5656
 Fax. 202-232-2102

FOR PERMIT
 STATE OF MAINE
 AARON C. JONES
 No. 10968
 LICENSED PROFESSIONAL ENGINEER
 8/25/15

Structural Integrity
 Consulting Engineers, Inc.
 77 Oak Street
 Portland, ME, 04101
 p. 207-774-4644
 f. 866-793-7835
 www.structuralintegrity.com

BOX CULVERT PLAN AND SECTION
 ON LAND OWNED BY:
 GRAVES HILL LAND COMPANY, LLC
 802-838 OCEAN AVENUE
 PORTLAND, MAINE 04103
 PREPARED FOR:
 HAWTHORN DEVELOPMENT, LLC
 9310 NE VANCOUVER MALL DRIVE, SUITE 200
 VANCOUVER, WASHINGTON 98462-8910