

WING 'B'

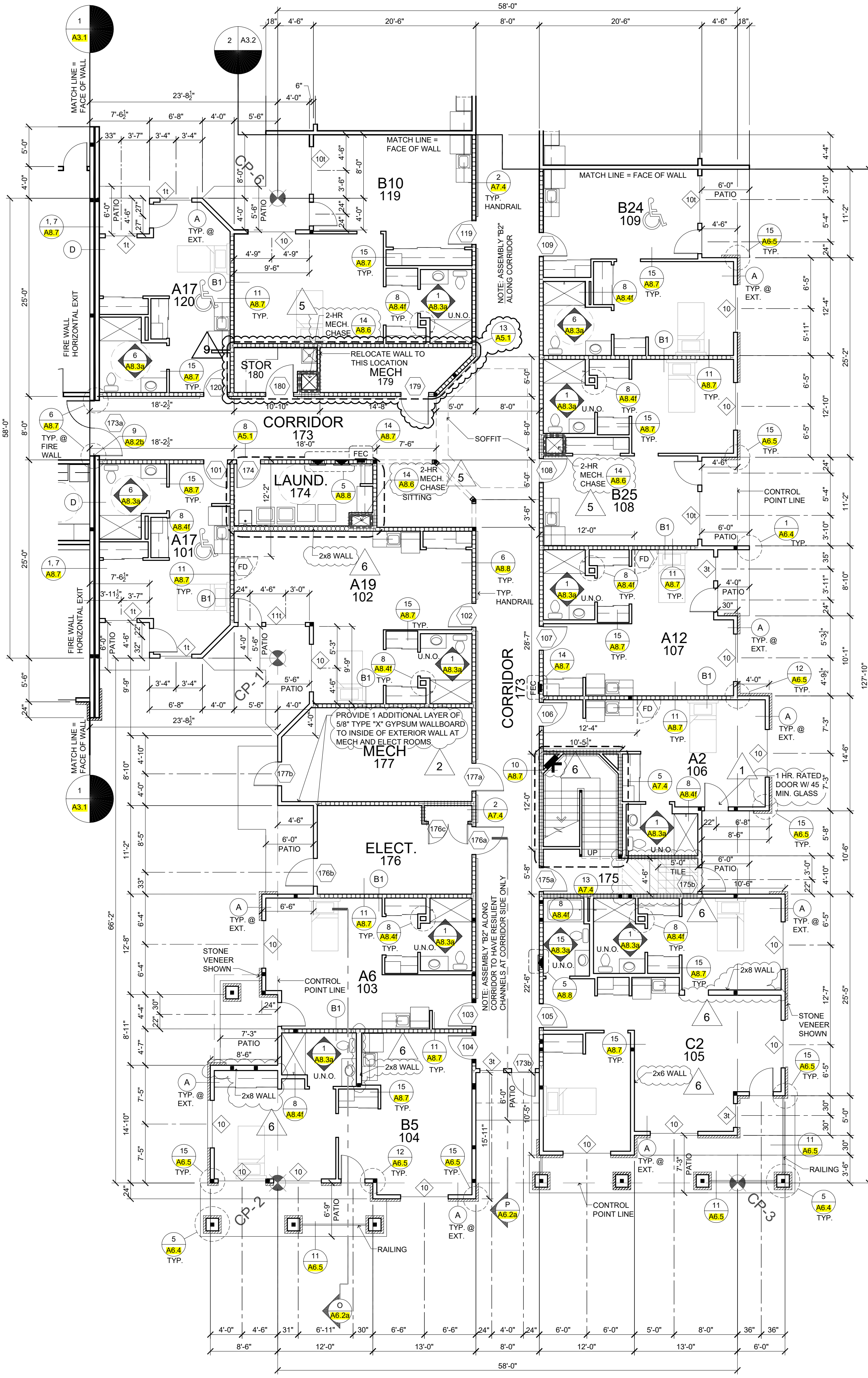

WING 'B'

- LEGEND**
- ACCESSIBLE SUITE
  - TUB/SHOWER
  - ROLL-IN SHOWER
  - CONTROL POINT
  - DESIGNATED WALL TYPES SHOWN SHEETS **A7.10 & A7.10 & A7.10**
  - DOOR DESIGNATION, SEE **A8.2a**
  - LOCATION OF FRAMING FOR FUTURE DOOR, SEE **10.3.3.3**
  - WINDOW DESIGNATION, SEE **A8.0a**  
1 = WINDOW GLAZING DESIGNATION (TEMPERED)
  - AREA SEPARATION WALL  
2 HR FIRE WALL/HORIZONTAL EXIT SEE SHEET **A8.7** FOR DETAILS
  - 1 HR RATED WALL, SEE SHEET **A7.10**
  - SILICA
  - CERAMIC TILE
  - FIRE PARTITION WALL, SEE DEFINITION ON EGRESS SHEETS
  - 1 HR FIRE BARRIER SEE CHASE DETAIL ON **9.A8.9** AND EGRESS SHEETS
  - 2 HR FIRE BARRIER SEE CHASE DETAIL ON **14.A8.6**, STAIR DETAILS ON **A7.4**, ELEVATOR DETAIL **9.A8.1**, AND EGRESS SHEETS

- GENERAL NOTES:**
1. PROVIDE DRYWALL EXPANSION JOINTS AT CORRIDOR FACE OF ALL INTERIOR DOOR JAMBS
  2. INSTALL BACKING AT ALL HOLD OPENS, FUTURE GRAB BARS
  3. REFER TO ROOF PLAN FOR DOWNSPOUT LOCATIONS.
  4. REFER TO 1/4" AS SHEETS FOR ENLARGED SUITE PLANS.
  5. REFER TO **A7.10** AND **A7.10** FOR TYPICAL WALL ASSEMBLIES.
  6. ALL EXTERIOR, PARTY, CORRIDOR AND PLUMBING WALLS TO BE 2x6 STUDS AT 16" oc UNLESS OTHERWISE NOTED.
  7. ALL JAMB FRAMING AT HINGE SIDE TO BE 4" U.O.N.
  8. REFER TO SHEETS **A7.6**, **A7.7** AND **A8.7**, **A8.8** FOR FIRE RATED CONSTRUCTION DETAILS AND INFO.
  9. ELEVATOR EQUIPMENT ROOMS SHALL BE 2 HR RATED CONSTRUCTION
  10. SEE DETAIL **12.A8.2b** FOR MINIMUM ACCESSIBLE FLOOR CLEARANCE AT DOORS.

NOTE:  
FUTURE DOOR DIMENSIONS ADDED TO A3 SHEETS

NOTE:  
DIMENSIONS OF SOFFITS ON 1ST FLOOR ARE TAKEN FROM FINISH FLOOR. DIMENSIONS OF SOFFITS ON 2ND FLOOR AND ABOVE ARE TAKEN FROM TOP OF PLYWOOD.

NOTE:  
ALL SLOPED CEILINGS TO BE SKIM COATED.  
• SEE SHEET **A2.1** FOR CONTROL POINT DIMENSIONS  
• SEE DETAIL 1 AND 3 ON **S2.3** FOR ALLOWABLE BORING/NOTCHING OF MEMBERS.

NOTE:  
FIRE EXTINGUISHERS SHALL BE INSTALLED IN ACCORDANCE WITH SECTION 908 OF THE 2009 IFC AND NFPA 10:2007 EDITION, IN ACCORDANCE WITH NFPA 10: TABLE 5.2.1, FIRE EXTINGUISHERS PLACED NOT TO EXCEED A MAXIMUM OF 75 FEET OF TRAVEL DISTANCE. ALL EXTINGUISHERS SHALL BE RATED AT A MINIMUM OF 2A:10BC, UNLESS OTHERWISE NOTED. ADDITIONAL FIRE EXTINGUISHERS ARE REQUIRED IN THE FOLLOWING COMMON AREAS:

1. ONE 40BC IN THE ELEVATOR EQUIPMENT ROOM. A CLEAN AGENT IS RECOMMENDED, BUT NOT REQUIRED.
2. ONE 2A:10BC IN THE KITCHEN.
3. ONE K CLASS IN THE KITCHEN.

JOINTS BETWEEN GYPSUM BOARDS IN SYSTEMS RATED FOR FIRE, SOUND, OR SHEAR MUST BE CONSTRUCTED WITH THE GYPSUM BOARD EDGES IN MODERATE CONTACT. MODERATE CONTACT MEANS THAT THE EDGES ARE ESSENTIALLY TOUCHING EACH OTHER. IT IS POSSIBLE FOR THE GYPSUM BOARD EDGES TO BE IN MODERATE CONTACT YET NOT TOUCH ALONG THE ENTIRE LENGTH OF THE JOINT. THEREFORE, IN GYPSUM BOARD SYSTEMS RATED FOR FIRE, SOUND, OR SHEAR, SMALL GAPS SPACED SPORADICALLY ALONG THE JOINT ARE ACCEPTABLE AS LONG AS THE BOARD EDGES ARE ESSENTIALLY TOUCHING ONE ANOTHER. GAPS UP TO 1/8" MUST BE FILLED WITH A THROUGH-PENETRATION SEALANT (FIRE CAULK). GAPS OVER 1/8" ARE NOT ACCEPTABLE.

**lenity architecture**  
3150 Kettle Court SE, Salem, Oregon 97301  
PHONE (503) 399-0565

**COLSON AND COLSON**  
GENERAL CONTRACTOR, INC.  
2280 MCGIL CHRIST STREET SE, SUITE 200  
SALEM, OREGON, 97302  
PHONE (503) 586-7401

**PORTLAND**  
RETIREMENT RESIDENCE  
802 OCEAN AVE., PORTLAND, MAINE 04103

**1ST FLOOR**  
WING 'B' PLAN

DATE: 8/28/2015  
REVISED DATE: 9/22/2015  
2/2/2016

SHEET  
A3.2