

NOTE: DOWNSPOUTS HAVE BEEN ADDED AND ADJUSTED ON ROOF PLAN

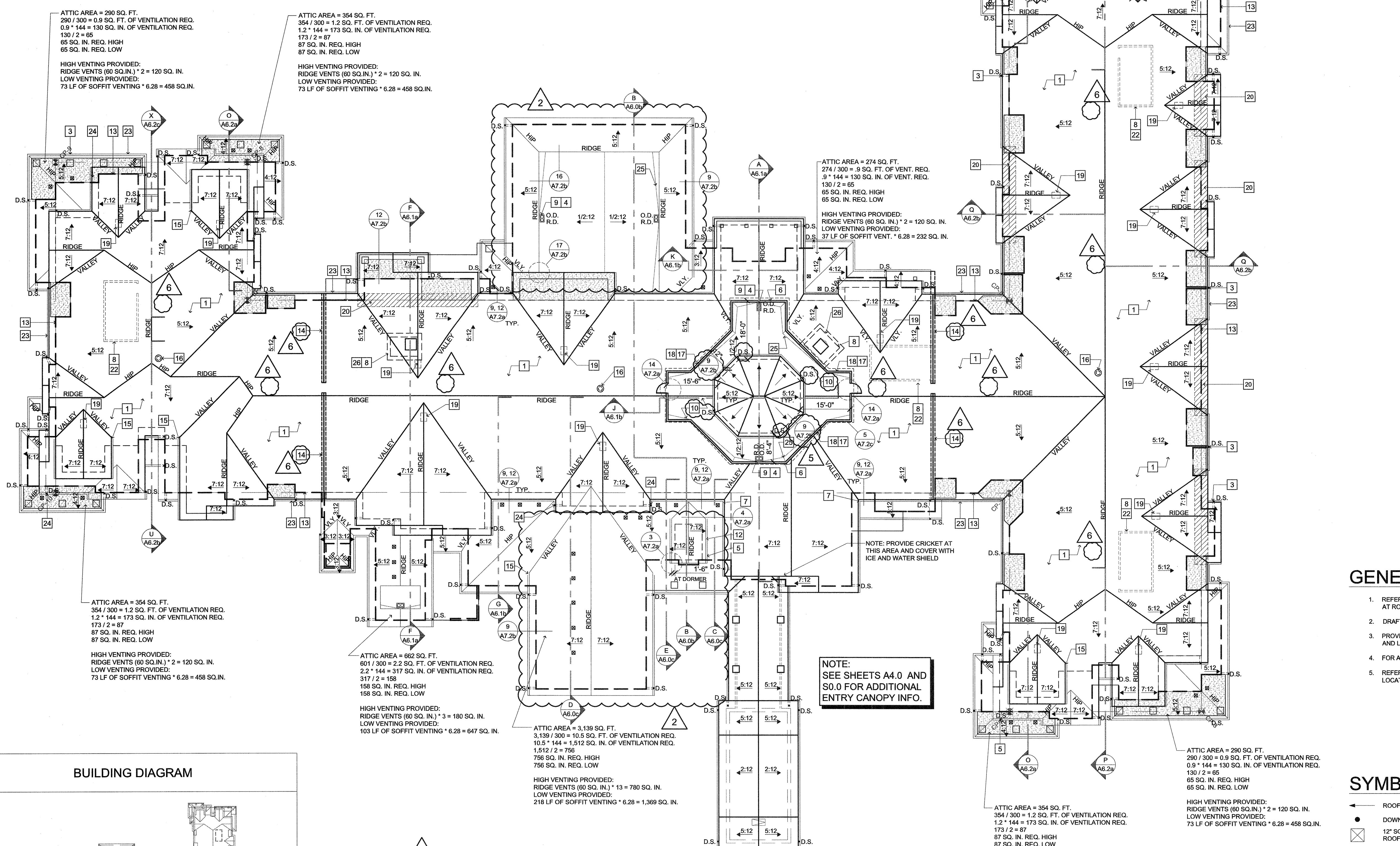

KEY NOTES

- 1 CLASS "A" ARCH. COMP ASPHALT SHINGLE ROOFING. SEE DETAIL 10A7.2a
- 2 BUILT UP SHAFT FOR MECHANICAL LOUVER. SEE DETAIL 6/A7.2c
- 3 OUTLINE OF COLUMN BELOW
- 4 MOUNT DRAINS INTO 2" DEEP WELL CANT ALL EDGES TYP. SEE DETAIL 6/A7.2a
- 5 DOWNSPOUT TO RUN DOWN ROOF ALONG DORMER TO EDGE, TYP.
- 6 PARAPET WALL 8" ABOVE RIDGE W/ 24 GA. CAP FLASHING (TYP.)
- 7 SPLASH BLOCK
- 8 2 HR WALL TO UNDERSIDE OF ROOF SHGT.
- 9 ROOF DRAINS HARD PIPED TO STORM SEWER, 3" DIA. OVERFLOW DRAINS TO DAYLIGHT AT SOFFIT TRIM OPENING W/ G.I. ESCUTCHEON.
- 10 FLAT ROOF WITH "TPO" ROOFING COLOR: WHITE
- 11 MECH. EQUIPMENT ON ROOF SEE M4.2
- 12 HEAT TAPE THIS AREA.
- 13 (1) LAYER 5/8" TYPE "C" EXT. GYP. SHGT. OVER RC, ASSEMBLY "G"
- 14 FIREWALL BELOW SEE DETAIL 13/A8.8
- 15 OPEN END GUTTERS.
- 16 POWER VENTS SEE MECHANICAL
- 17 CANT STRIP (TYP.) SEE DETAIL 2/A7.2a
- 18 RAKE, SEE DETAILS 12,17/A7.2a AND 11/A7.2b
- 19 PROVIDE 22"x30" CUT OUT AT EACH HIGH POINT OF GABLE FOR VENTING. TYPICAL OF ALL GABLES.
- 20 ROOF SHEATHING THIS AREA TO BE CONT. TO EXTERIOR WALL UNDER OVER-FRAMING SEE DETAIL 10A7.2b
- 21 8'-1" TOP OF PLATE ABV. F.F. AT TOP FLOOR
- 22 LINE OF STAIR WALL BELOW
- 23 SEE DETAIL 9/A6.5 FOR GUTTER TERMINATION. (AT DECK LOCATION)
- 24 D.S. TO ROOF BELOW.
- 25 CRICKET
- 26 LINE OF ELEVATOR BELOW

KEYNOTES INDICATED ABOVE ARE APPLICABLE FOR THE ROOF PLAN SHEET ONLY

GENERAL NOTES:

1. REFER TO DETAIL 10A7.2a FOR VENT PIPE PENETRATIONS AT ROOF.
2. DRAFT STOPS NOT REQUIRED.
3. PROVIDE FALL ARREST HOOKS PER MANUF. SPECIFICATIONS AND LOCAL CODES O.S.H.A.
4. FOR ATTIC LIGHTING AND POWER LAYOUT, SEE "E" SHEETS.
5. REFER TO MECH. AND ELEC. PLANS FOR POWER ATTIC FAN LOCATIONS.

SYMBOLS LEGEND:

- ROOF SLOPE INDICATED ON PLAN
- DOWN SPOUT: 3" x 4" TYPICAL
- ⊠ 12" SQUARE ROOF VENT W/ 9" Ø OPENING. COLOR TO MATCH ROOFING
- POWER VENT LOCATION - SEE DETAIL 8/E2.2b AND EQUIPMENT SCHEDULE ON M4.2 FOR EF-9 SPECS.

LEGEND

- ♿ ACCESSIBLE SUITE
- 🚿 TUB/SHOWER
- 🚿 ROLL-IN SHOWER
- ⊙ CONTROL POINT
- ▬ RATED FIRE WALL SEE SHEET A6.7 FOR DETAILS
- ▬ WALL, SEE SHEET A7.1a

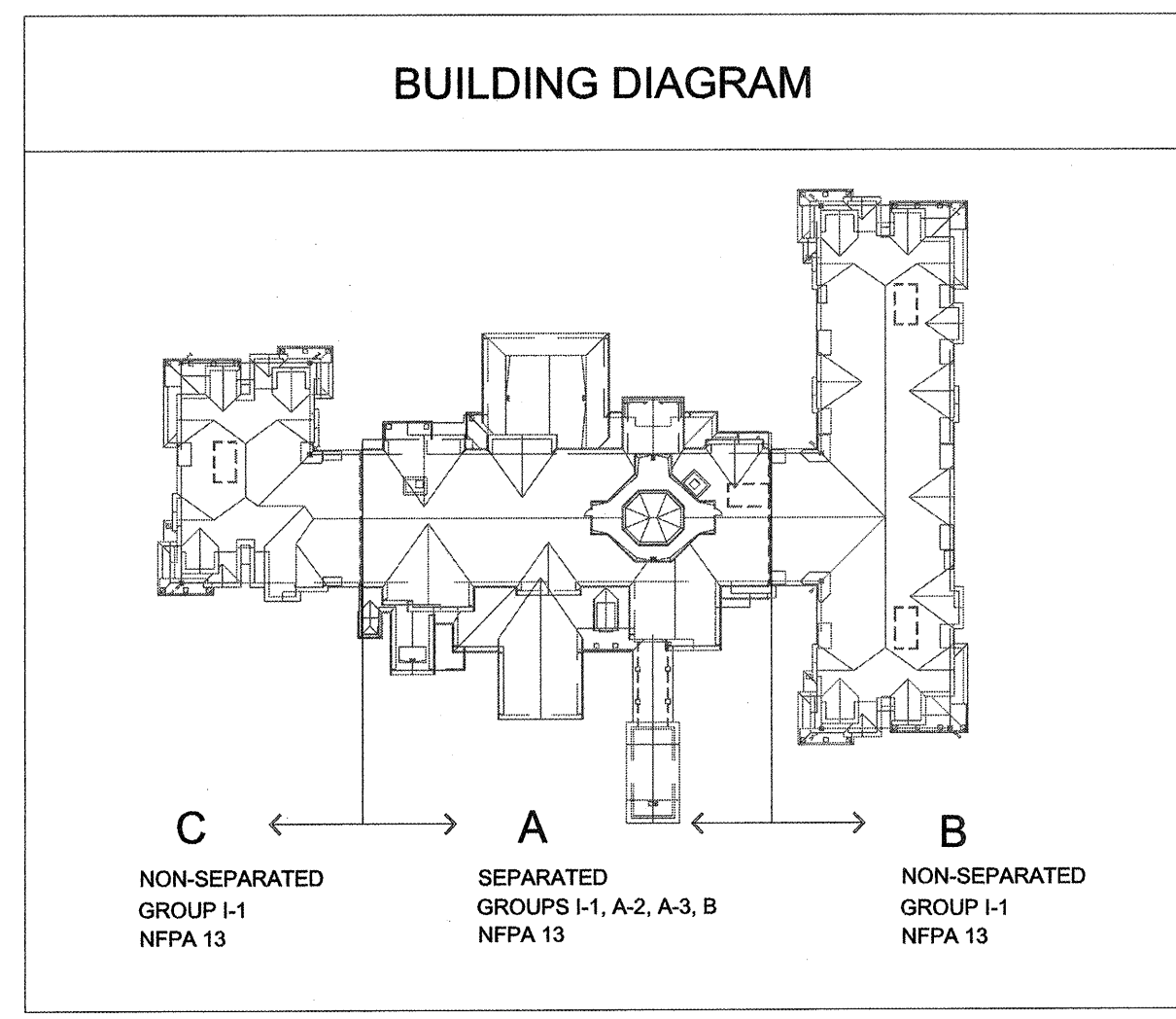

| ATTIC VENTING CALCULATIONS | | | | | |
|--|------------------|--|------------------|--|-------------------|
| BUILDING C | | BUILDING A | | BUILDING B | |
| Venting | | Venting | | Venting | |
| Building 'C' Attic Area = | 5,925 SQ. FT. | Building 'A' Attic Area = | 12,816 SQ. FT. | Building 'B' Attic Area = | 13,445 SQ. FT. |
| 0.02 CFM Required per IMC | | 0.02 CFM Required per IMC | | 0.02 CFM Required per IMC | |
| Building 'C' CFM required = | 119 CFM | Building 'A' CFM required = | 256 CFM | Building 'B' CFM required = | 269 CFM |
| Power Cool 12 Vents required | 1 | Power Cool 12 Vents required | 1 | Power Cool 12 Vents required | 1 |
| Power Cool 12 Vents Provided | 1 | Power Cool 12 Vents Provided | 1 | Power Cool 12 Vents Provided | 1 |
| Make-Up Air | | Make-Up Air | | Make-Up Air | |
| Make-Up Air Required Based On 1 Power Vents | 1,170 CFM | Make-Up Air Required Based On 1 Power Vents | 1,170 CFM | Make-Up Air Required Based On 1 Power Vents | 1,170 CFM |
| CFM Provided by 399 L/F of Soffit Venting (6.28 SQ IN Per L/F) | 5,223 CFM* | CFM Provided by 520 L/F of Soffit Venting (6.28 SQ IN Per L/F) | 6,807 CFM* | CFM Provided by 768 L/F of Soffit Venting (6.28 SQ IN Per L/F) | 10,053 CFM* |
| CFM Provided by Ridge Vents (60 SQ IN Per Vent) | 0 CFM* | CFM Provided by Ridge Vents (60 SQ IN Per Vent) | 0 CFM* | CFM Provided by Ridge Vents (60 SQ IN Per Vent) | 0 CFM* |
| Total Make-Up Air Provided | 5,223 CFM | Total Make-Up Air Provided | 6,807 CFM | Total Make-Up Air Provided | 10,053 CFM |
| * Based on 300 FPM face velocity | | * Based on 300 FPM face velocity | | * Based on 300 FPM face velocity | |

ROOF PLAN
1/16"=1'-0"

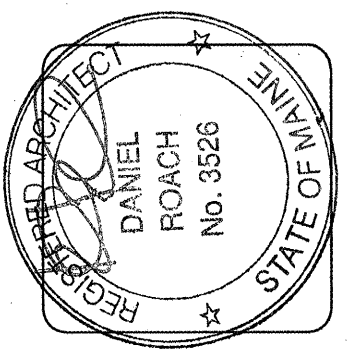

lenity architecture
350 Kennebec St. SE, Salem, Oregon 97301
P 503.399.1090 F 503.399.0585

COLSON AND COLSON
GENERAL CONTRACTOR, INC.
2280 McGLICHRIST STREET SE, SUITE 200
SALEM, OREGON 97302
PHONE (503) 586-7401

PORTLAND RETIREMENT RESIDENCE
802 OCEAN AVE. PORTLAND, MAINE 04103

ROOF PLAN

DATE: 8/28/2015
REVISED DATE: 2/2/2016
SHEET: A2.5

6/7/18/2016 6/31/2017