

- ### KEY NOTES
- CLASS "A" ARCH. COMP ASPHALT SHINGLE ROOFING. SEE DETAIL 1/A7.2c
  - BUILT UP SHAFT FOR MECHANICAL LOUVER. SEE DETAIL 6/A7.2c
  - ROOF DRAINS HARD PIPED TO STORM SEWER. OVERFLOW DRAINS TO BOTTOM OF SOFFIT.
  - MOUNT DRAINS INTO 2" DEEP WELL CANT ALL EDGES TYP. SEE DETAIL 6/A7.2a
  - DOWNSPOUT TO RUN DOWN ROOF ALONG DORMER TO EDGE. TYP.
  - PARAPET WALL 8" ABOVE RIDGE W 24 GA. CAP FLASHING (TYP).
  - SPLASH BLOCK
  - 2 HR WALL TO UNDERSIDE OF ROOF SHGT'G.
  - 3" DIA. OVERFLOW TO DAYLIGHT AT SOFFIT TRIM OPENING W G.I. ESCUTCHEON TYPICAL AT ROOF DRAINS.
  - RANGE EXHAUST SEE DETAIL 3/M4.1.
  - MECH. EQUIPMENT ON ROOF SEE M4.2
  - HEAT TAPE THIS AREA.
  - (1) LAYER 5/8" TYPE "C" EXT. GYP. SHGT'G. OVER RC. ASSEMBLY "G"
  - BUILT-UP ROOFING. SEE DETAIL 2/A7.2a
  - OPEN END GUTTERS.
  - POWER VENTS SEE MECHANICAL
  - CANT STRIP (TYP.) SEE DETAIL 2/A7.2a
  - RAKE. SEE DETAILS 12, 17/A7.2a AND 1/A7.2b-6/A7.2b
  - PROVIDE 22"x30" CUT OUT AT EACH HIGH POINT OF GABLE FOR VENTING. TYPICAL OF ALL GABLES.
  - ROOF SHEATHING THIS AREA TO BE CONT. TO EXTERIOR WALL UNDER OVER-FRAMING SEE DETAIL 10/A7.2b
  - 8'-1" TOP OF PLATE ABV. F.F. AT TOP FLOOR
  - LINE OF STAIR WALL BELOW
  - SEE DETAIL 9/A6.5 FOR GUTTER TERMINATION. (AT DECK LOCATION)
  - D.S. TO ROOF BELOW.
  - CRICKET
  - LINE OF ELEVATOR BELOW
  - FIREWALL BELOW
- KEYNOTES INDICATED ABOVE ARE APPLICABLE FOR THE ROOF PLAN SHEET ONLY

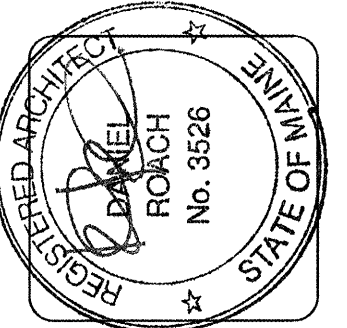

**lenity architecture**  
 3150 Veneta Court, SE, Salem, Oregon 97301  
 P 503.399.1090 F 503.399.0585 W lenityarchitecture.com

**COLSON AND COLSON GENERAL CONTRACTOR, INC.**  
 2280 MacGILCHRIST STREET, SE, SUITE 200 SALEM, OREGON, 97302  
 PHONE (503) 586-7401

**PORTLAND RETIREMENT RESIDENCE**  
 802 OCEAN AVE. PORTLAND, MAINE 04103

**ROOF PLAN**

### GENERAL NOTES:

- REFER TO DETAIL 10/A7.2a FOR VENT PIPE PENETRATIONS AT ROOF.
- DRAFT STOPS NOT REQUIRED.
- PROVIDE FALL ARREST HOOKS PER MANUF. SPECIFICATIONS AND LOCAL CODES O.S.H.A.
- FOR ATTIC LIGHTING AND POWER LAYOUT, SEE "E" SHEETS.
- REFER TO MECH. AND ELEC. PLANS FOR POWER ATTIC FAN LOCATIONS.

### SYMBOLS LEGEND:

- ROOF SLOPE INDICATED ON PLAN
- DOWN SPOUT: 3" x 4" TYPICAL
- WALL TYPE DESIGNATION - SEE A7.1 SHEETS.
- 12" SQUARE ROOF VENT W 9" Ø OPENING. COLOR TO MATCH ROOFING
- POWER VENT LOCATION - SEE DETAIL 8/E2.2b AND EQUIPMENT SCHEDULE ON M4.2 FOR EF-9 SPECS.

### LEGEND

- ACCESSIBLE SUITE
- TUB/SHOWER
- ROLL-IN SHOWER
- CONTROL POINT
- RATED FIRE WALL/FIRE BARRIER (SEE SHEET A8.7 FOR DETAILS)
- ONE HOUR PARTITION

### ROOF PLAN

1/16"=1'-0"

### BUILDING DIAGRAM

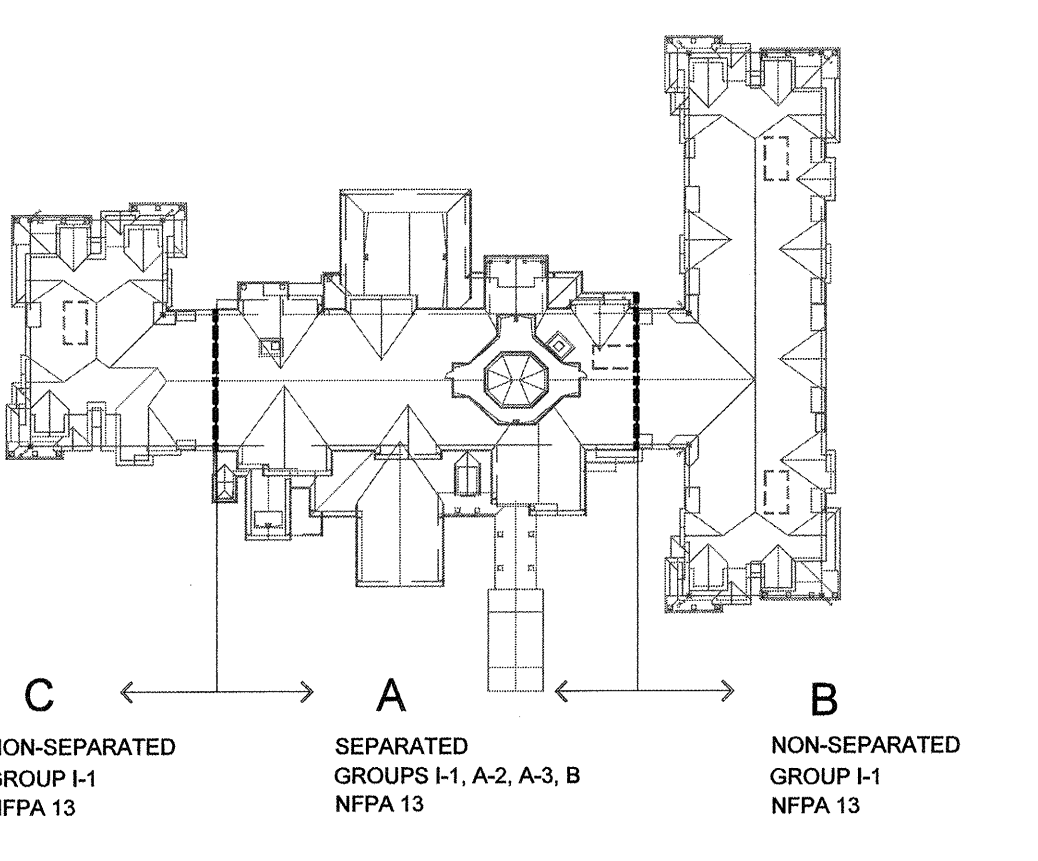

BUILDING C			BUILDING A			BUILDING B		
Venting			Venting			Venting		
Building 'C' Attic Area =	5,925 SQ FT	0.2 CFM Required per IMC	Building 'A' Attic Area =	12,816 SQ FT	0.2 CFM Required per IMC	Building 'B' Attic Area =	13,445 SQ FT	0.2 CFM Required per IMC
Building 'C' CFM required =	1,185 CFM		Building 'A' CFM required =	2,563 CFM		Building 'B' CFM required =	2,689 CFM	
Power Cool 12 Vents required	2		Power Cool 12 Vents required	3		Power Cool 12 Vents required	3	
Power Cool 12 Vents Provided	4		Power Cool 12 Vents Provided	4		Power Cool 12 Vents Provided	8	
Make-Up Air			Make-Up Air			Make-Up Air		
Make-Up Air Required Based On 4 Power Vents	4,680 CFM		Make-Up Air Required Based On 4 Power Vents	4,680 CFM		Make-Up Air Required Based On 8 Power Vents	9,360 CFM	
CFM Provided by 399 L/F of Soffit Venting (6.28 SQ IN Per L/F)	5,223 CFM*		CFM Provided by 520 L/F of Soffit Venting (6.28 SQ IN Per L/F)	6,807 CFM*		CFM Provided by 768 L/F of Soffit Venting (6.28 SQ IN Per L/F)	10,053 CFM*	
CFM Provided by Ridge Vents (60 SQ IN Per Vent)	0 CFM*		CFM Provided by Ridge Vents (60 SQ IN Per Vent)	0 CFM*		CFM Provided by Ridge Vents (60 SQ IN Per Vent)	0 CFM*	
<b>Total Make-Up Air Provided</b>	<b>5,223 CFM</b>		<b>Total Make-Up Air Provided</b>	<b>6,807 CFM</b>		<b>Total Make-Up Air Provided</b>	<b>10,053 CFM</b>	
* Based on 300 FPM face velocity			* Based on 300 FPM face velocity			* Based on 300 FPM face velocity		

2016/04/20/16 02:11 AM Job: 1604252016 4:17 PM User: rjcolson\robert.colson@lenity.com 7:23 reference: plan.dwg A2.5