

ELECTRICAL MOUNTING HEIGHTS	
ITEM	HEIGHT A.F.F. TO CENTER LINE
THERMOSTATS	48"
DOOR HOLDERS	75" TO CENTER
EMERGENCY CALL	40"
SPEAKERS & PULL STATIONS	42"
WALL LIGHTS IN CORRIDORS	80" TO CENTER LINE
EXTERIOR WALL LIGHTS	96" TO CENTER LINE (U.N.O.)
OUTLETS (COMMON AREAS)	17"
OUTLETS (SUITE AREAS)	24"
LIGHT SWITCH	44"
COUNTER OUTLETS	44" TO BOTTOM
STAIR LIGHTS	2" TO BOTTOM, ABOVE TREAD
ELECTRICAL PANEL	80" TO TOP OF PANEL
BATHROOM WALL VANITY LIGHT	6'-11" TO CENTER (SEE NOTE #1)

- NOTES:**
1. CENTER OVER CABINET BASE PROVIDE BACKING IF REQUIRED.
  2. INFORMATION SHOWN FOR REFERENCE. CONFORM TO ARCH, ADA, AND CODE REQUIREMENTS.

### GENERAL NOTES:

SEE ELECTRICAL ES.X SHEETS FOR TYPICAL ELECTRICAL IN RESIDENTIAL SUITES. BASEBOARD AND WALL HEATERS TO BE WHITE. CONNECT SUITES TO PANELS AS INDICATED ON POWER PLANS. CONSULT FINISH SCHEDULE FOR CEILING TYPE IN COMMON AREAS. COORDINATE FIXTURE TYPE AND MOUNTING WITH CEILING TYPE.

SEE LIGHT FIXTURE PROTECTION DETAIL ON 6/E2.2b AND TYPICAL FOR RECESSED LIGHT FIXTURES AND EXHAUST FANS IN FIRE RATED CEILINGS. MODIFY DETAIL AS NEEDED TO MATCH UNIT INSTALLED.

PENETRATIONS OF FIRE RATED CONSTRUCTION OR DRAFT STOP CONSTRUCTION TO BE INSTALLED AND PROTECTED AS REQUIRED BY LOCAL CODES AND BUILDING AUTHORITY. SEE ARCH. FOR REQUIREMENTS.

ELECTRICAL CONTRACTOR RESPONSIBLE FOR DETERMINING NUMBER AND SIZE OF CONDUCTORS, GROUND, AND NEUTRAL WIRES. SEE PANEL SCHEDULES FOR MIN. SIZES. COORDINATE MECHANICAL EQUIPMENT ELECTRICAL CONNECTIONS WITH MECHANICAL DRAWINGS AND EQUIPMENT FURNISHED. VERIFY LOCATIONS, CHARACTERISTICS AND LOADS, AND ADJUST WIRE AND BREAKER SIZES AS NEEDED. CONNECT PERIPHERALS AND INTERLOCK WITH OTHER MECHANICAL EQUIPMENT AS SHOWN ON MECHANICAL DRAWINGS OR AS REQUIRED.

PROVIDE DUCT SMOKE (PHOTO TYPE) DETECTORS AT RETURN OF AIR HANDLING EQUIPMENT IF REQUIRED BY LOCAL CODE.

CONNECT DUCT SMOKE DETECTORS TO SHUT DOWN AIR HANDLING UNIT AND PROVIDE REMOTE RESET LIGHT/ALARM IN CORRIDOR WALL CLOSEST TO UNIT. CONNECT SMOKE DETECTOR OUTPUT TO FIRE ALARM PANEL.

CONNECT CORRIDOR NON-EMERGENCY LIGHTING THROUGH AUTOMATIC LIGHTING CONTROLLER LOCATED IN MECHANICAL ROOM.

PROVIDE LINK SEAL LINK SLEEVE AT BUILDING ELECTRICAL PENETRATIONS IN FOUNDATION OR WHERE EXPOSED TO EARTH/ELEMENTS.

PROVIDE WARNING SIGN AT DISCONNECTS THAT SERVE EQUIPMENT LOCATIONS WITH MORE THAN ONE DISCONNECT. EQUIPMENT WITH MORE THAN ONE DISCONNECT SHALL HAVE LOCKABLE DISCONNECTS.

DO NOT USE HAMMERS OR BLUNT FORCE DEVICES TO "KNOCK-OUT" WIREWAYS IN BUILDING MATERIALS MAINTAIN NOT LESS THAN 18" FROM EDGE OF JOISTS. SEE DETAIL #1/E2.2b AND #1/E2.2b FOR ALLOWABLE BENDING/NOTCHING OF MEMBERS. SEE ARCH FOR REQUIREMENTS. CIRCUIT "E" DESIGNATED LIGHT AND RECEPTACLE FIXTURES TO EMERGENCY PANEL.

### ELECTRICAL KEY NOTES:

1. CONNECT 120 VOLT SINGLE PHASE WASHING MACHINE. PROVIDE ONE CIRCUIT FOR EACH MACHINE. (MOUNT 40" A.F.F.)
2. CONNECT 120 VOLT SINGLE PHASE GAS CLOTHES DRYER. PROVIDE ONE CIRCUIT FOR EACH MACHINE. RUN 3/4" EMT FROM 1ST FLOOR LAUNDRY ROOM TO ATTIC FOR FUTURE DRYER BOOSTER FAN. (MOUNT 40" A.F.F.)
3. ELECTRIC RANGE. PROVIDE NEMA 14-60R 50 AMP 120/208 VOLT SINGLE PHASE RANGE RECEPTACLE AT 6" A.F.F.
4. ENTRY CANOPY / EXIT LIGHTS. CONNECT TO EXTERIOR LIGHTING CONTROL. SEE DETAIL 3/E2.2b
5. NOT USED
6. PROVIDE TYPE "V" FIXTURE AND GFI RECEPTACLE IN ELEVATOR PIT. DO NOT CONNECT ON SAME CIRCUIT. MOUNT SWITCH IN PIT. MOUNT FIXTURES TO AVOID CAR.
7. PROVIDE 20 AMP ELEVATOR CAB LIGHT FUSED DISCONNECT IN EQUIPMENT ROOM CIRCUITED TO EMERGENCY PANEL. FUSE SIZE PER MANUFACTURER.
8. TO EXTERIOR PARKING AREA, PATHWAY AND LANDSCAPE LIGHTING. CIRCUIT TO PANEL VIA EXTERIOR LIGHTING CONTROL. SEE SITE PLAN DRAWING(S) FOR LOCATIONS AND QUANTITIES.
9. ELECTRICAL MAIN DISTRIBUTION PANEL. SEE ONE-LINE.
10. DOMESTIC COLD WATER AND FIRE SPRINKLER SERVICE ENTRANCES FOR GROUNDING. COORDINATE WITH PLUMBING CONTRACTOR.
11. EMERGENCY STANDBY ENGINE GENERATOR. SEE SPECIFICATIONS. SEE SITE (E1.0/A1.1) PLAN FOR LOCATION.
12. AUTOMATIC TRANSFER SWITCH FURNISHED AS PART OF ENGINE GENERATOR PACKAGE. SEE SPECIFICATIONS AND ONE-LINE.
13. PROVIDE FUSED DISCONNECT ELEVATOR MODULE WITH INTEGRAL SHUNT-TRIP FOR ELEVATOR MACHINE. COORDINATE FUSE REQUIREMENTS WITH ELEVATOR MANUFACTURER. CONNECT TO FIRE ALARM AND REMOTE SHUNT-TRIP SWITCH. COOPER BUSMAN, EATON ELEVATOR CONTROL SWITCH ES SERIES, OR APPROVED.
14. TELEPHONE TERMINAL BOARD. SEE TELEPHONE SECTION OF SPECIFICATIONS. PROVIDE DOUBLE DUPLEX RECEPTACLE MOUNTED ON BACKBOARD AND TWO DEDICATED CIRCUITS AND #6 EQUIPMENT GROUND CONNECTED TO GROUND BUS AT MOP.
15. TELEVISION TERMINAL BOARD. SEE TELEVISION SECTION OF SPECIFICATIONS. PROVIDE DOUBLE DUPLEX RECEPTACLE MOUNTED ON BACKBOARD AND TWO DEDICATED CIRCUITS AND #6 EQUIPMENT GROUND CONNECTED TO GROUND BUS AT MOP.
16. IRRIGATION CONTROL PANEL. PROVIDE RECEPTACLE ON DEDICATED CIRCUIT. STUB OUT A 2" PVC CONDUIT TO EXTERIOR OF BUILDING. COORDINATE LOCATION AND REQUIREMENTS WITH IRRIGATION CONTRACTOR.
17. POWER DOOR CONNECTED TO ATRIUM SMOKE CONTROL SYSTEM. SEE DETAIL 15/E2.2b AND SEQUENCE OF OPERATION ON E1.7P. SEE SPECIFICATION SECTION 16100 FOR ADDITIONAL WIRING REQUIREMENTS.
18. INSTALL RECEPTACLE HORIZONTALLY.
19. LOCATE FIXTURES IN ATTIC SPACE FOR EACH WING. MOUNT IN AREAS TO PROVIDE LIGHT FOR MAINTENANCE USE. PROVIDE PILOT LIGHT SWITCH AT EACH ACCESS INSIDE OF STAIR DOOR.
20. PROVIDE WEATHERPROOF LIGHT FIXTURE AND WEATHERPROOF GFI RECEPTACLE WITHIN 10 FEET OF MECHANICAL EQUIPMENT. COORDINATE LOCATION WITH MECHANICAL.
21. KITCHEN MAKE-UP AIR UNIT. ROUTE FAN POWER CONDUCTORS THROUGH SUPPLY VFD#1 LOCATED IN ENERGY MANAGEMENT SYSTEM (EMS) CONTROL PANEL LOCATED ON THE SIDE OF THE KITCHEN HOOD. PROVIDE ONE 3/4" CONDUIT FOR CONTROL WIRING FROM EMS CONTROL PANEL TO MAKE-UP AIR UNIT. PROVIDE TWO SETS OF 2-WIRE 16 AWG SHIELDED MULTI-CONDUCTOR CABLES BETWEEN MAU AND EMS PANEL. DO NOT ROUTE CONTROL CABLE ADJACENT TO HIGH POWER WIRING. COORDINATE WITH KITCHEN HOOD VENTILATION CONTROL. CONSULTANT DRAWINGS H-3 AND H-4. ACTIVATION OF ANSUL SYSTEM SHALL SHUT DOWN MAU. FUSE SIZE PER MANUFACTURER.
22. THRU-WALL HVAC UNIT. SEE MECHANICAL SPECIFICATION. FURNISHED BY OWNER. INSTALLED BY MECHANICAL CONTRACTOR. CONNECTED BY ELECTRICAL CONTRACTOR.
23. GAS FIRED WATER HEATERS. CIRCUIT ELECTRICAL GAS WATER HEATER CONNECTIONS TO BACK-UP POWER PANEL.
24. HOT WATER RECIRCULATING PUMPS. FRACTIONAL HORSEPOWER 120V SINGLE PHASE. CIRCUIT TO BACK-UP POWER PANEL.
25. AC-1 PACKAGED ROOFTOP GAS PACK AIR CONDITIONING EQUIPMENT. SEE MECHANICAL EQUIPMENT SCHEDULE. SEE DETAIL 17/E2.2b.
26. KITCHEN RANGE HOOD EXHAUST FAN. ROUTE FAN POWER CONDUCTORS THROUGH EXHAUST VFD#2 LOCATED IN ENERGY MANAGEMENT SYSTEM (EMS) CONTROL PANEL LOCATED ON THE SIDE OF THE KITCHEN HOOD. COORDINATE WITH KITCHEN HOOD VENTILATION CONTROL. CONSULTANT DRAWINGS H-2 AND H-4. FUSE SIZE PER MANUFACTURER.
27. NOT USED
28. #8-60B. CONNECT TO EMERGENCY PANEL. SEE DETAILS ON M4.2. FUSE PER MANUFACTURER AND MECH. SEE SPECIFICATION FOR ADDITIONAL REQUIREMENTS SPECIFIC TO THIS EQUIPMENT. SEE DETAIL 15/E2.2b.
29. AC-2 PACKAGED ROOFTOP GASPACK AIR CONDITIONING EQUIPMENT. SEE MECHANICAL EQUIPMENT SCHEDULE. FUSE PER MANUFACTURER. SEE DETAIL 17/E2.2b.
30. COORDINATE LIGHTING WITH EQUIPMENT. CHAIN OR SURFACE MOUNT.
31. MOUNT LIGHTS, RECEPT. SWITCHES AND TIMERS ON WALL NEXT TO CATWALK.
32. SF-2 SUPPLY FAN FOR COOLING AND HEATING CORRIDORS. SEE MECHANICAL EQUIPMENT SCHEDULE FOR DESCRIPTION. SEE DETAIL 17/E2.2b.
33. 1/12 HP ATTIC FAN ON ROOF. PROVIDE INDIVIDUAL DISCONNECTS. MOUNT FAN CONTROL 12" BELOW ROOF SHEATHING ON WALL NEXT TO CATWALK. SEE DETAIL 9/E2.2b.
34. QMARK MJH-03-81 RATED 3KW AT 208 VOLT 1 PHASE. SUSPENDED FROM CEILING. CONTROLLED BY REMOTE WALL THERMOSTAT.
35. 30 AMP 2 POLE CIRCUIT FOR COMBO WASHER & DRYER UNIT.
36. PROVIDE POWER FOR GAS FIRE PLACE PER MANUFACTURER REQUIREMENTS. PROVIDE SWITCH FOR FAN AND IGNITOR.
37. LOCATION OF FUTURE DOOR (DO NOT CIRCUIT (WIRE) IN THIS LOCATION).
38. NOT USED
39. AREA OF RESCUE ASSISTANCE ANNUNCIATOR. CORNELL 4200 SERIES. WIRE PER MANUFACTURER REQUIREMENTS. NOT LESS THAN #12 ALC. COPPER FOR POWER. PROVIDE BATTERY BACKUP BY MANUFACTURER AND LOCATE ABOVE CEILING IN OFFICE 151. SEE 1/E3.1. LABEL ANNUNCIATOR PER AHJ REQUIREMENTS. SYSTEM PROVIDED BY OWNER.
40. AREA OF RESCUE CALL STATION. CORNELL 4200 SERIES. CONNECT TO ANNUNCIATOR PANEL IN FOYER. PER MANUFACTURER REQUIREMENTS. SYSTEM PROVIDED BY OWNER.
41. EMERGENCY CALL REMOTE HEAD END. VERIFY LOCATION AND ELECTRICAL REQUIREMENTS WITH GENERAL CONTRACTOR.
42. SHUTDOWN KITCHEN EQUIPMENT AND RECEPTACLE POWER UNDER HOOD UPON ACTIVATION OF ANSUL SYSTEM. SEE KITCHEN DRAWINGS.
43. GFI RECEPTACLE @ 48 FOR WATER SOFTENER. CONNECT TO DEDICATED 120V CIRCUIT. OWNER SUPPLIED WATER SOFTENER. CONTRACTOR TO INSTALL.
44. FRACTIONAL HP FAN MOTOR. 120V. CONNECT TO SWITCHED LEG OF LIGHTING CIRCUIT.
45. PROVIDE GFI BREAKER.
46. KITCHEN WALK-IN FREEZER & COOLER CONDENSING UNITS. REFER TO KITCHEN PLANS.
47. FIRE/SMOKE DAMPER CONNECTION. CIRCUIT TO BACK-UP POWER PANEL. SEE DETAIL 12/E2.2b. DO NOT CONNECT MORE THAN SEVEN PPSIS TO EACH CIRCUIT.
48. EMERGENCY CALL SYSTEM BACK BOARD. PROVIDE RECEPTACLE ON DEDICATED CIRCUIT.
49. NOT USED
50. BROAN MODEL 154 LOW PROFILE CEILING HEATER. 120 VOLT, 1,250 WATTS. WITH MODEL 86W LINE-VOLTAGE THERMOSTAT.
51. PROVIDE UN-SWITCHED/UNCONTROLLED HOT TO EXIT SIGNS. TYPICAL.
52. WIRE ATTIC LIGHTS TO EMERGENCY CIRCUIT.
53. PROVIDE #6 CU GROUND WIRE FOR P.A. SYSTEM TO BUILDING GROUND IN MECHANICAL ROOM.
54. ELECTRIC DRYER-VERIFY ELEC. REQUIREMENTS.
55. WIRE FOR FUTURE THRU-WALL PTAC UNIT TO REPLACE BASEBOARD IN "C" UNIT BEDROOMS. SEE DETAIL "C"-UNIT, TYPICAL" ON E5.X SERIES. DO NOT CIRCUIT (WIRE) IN THIS LOCATION.
56. PROVIDE EMERGENCY POWER SWITCH/DIMMER BYPASS RELAY. SEE DETAIL 5/E2.2b.
57. PROVIDE SEPARATE BOX FOR EMERGENCY CIRCUIT.
58. CONNECT VIA LIGHTING CONTROLLER. SEE DETAIL 3/E2.2b.
59. SINGLE POINT POWER CONNECTION. PROVIDE CONNECTION TO EXTERIOR CONDENSING UNIT. SEE MECHANICAL.
60. PROVIDE CONDUCTORS FOR BASEBOARD CONNECTIONS. INCLUDE REMOTE THERMOSTAT WIRING.
61. ONLY HEAT AND FAN TO OPERATE WHEN EMERGENCY POWER IS IN OPERATION. PROVIDE DUAL CONNECTION TO UNIT. MECHANICAL UNIT MODIFICATIONS IS NOT ACCEPTABLE. SEE MECHANICAL.
62. PROVIDE CF-1 CEILING FAN WITH SEPARATE SWITCH FOR FAN AND LIGHT. SEE E5 SHEETS.

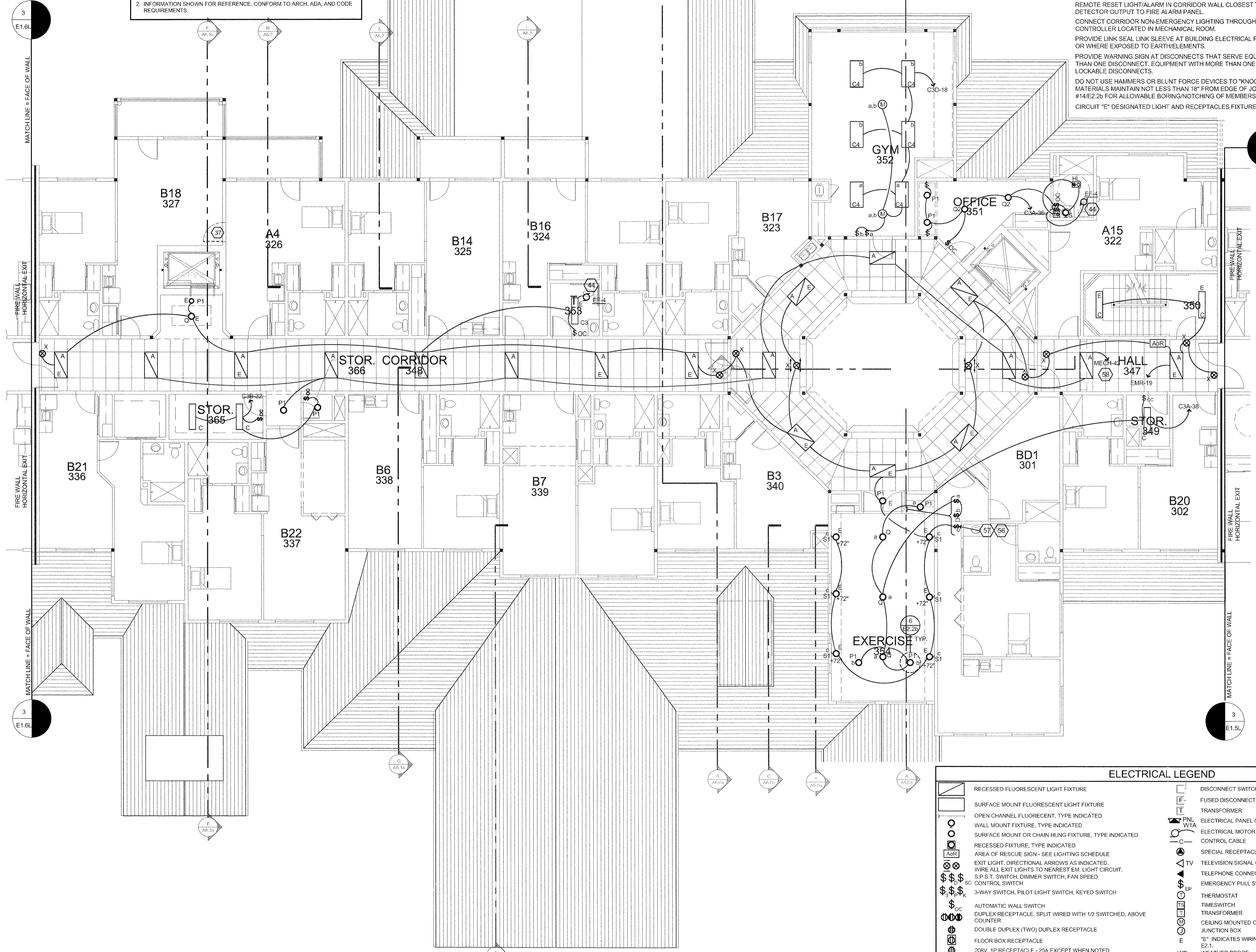

ELECTRICAL LEGEND			
[Symbol]	RECESSED FLUORESCENT LIGHT FIXTURE	[Symbol]	DISCONNECT SWITCH
[Symbol]	SURFACE MOUNT FLUORESCENT LIGHT FIXTURE	[Symbol]	FUSED DISCONNECT SWITCH
[Symbol]	OPEN CHANNEL FLUORESCENT. TYPE INDICATED	[Symbol]	TRANSFORMER
[Symbol]	WALL MOUNT FIXTURE. TYPE INDICATED	[Symbol]	ELECTRICAL PANEL OR ENCLOSURE. DESIGNATION NOTED
[Symbol]	SURFACE MOUNT OR CHAIN HUNG FIXTURE. TYPE INDICATED	[Symbol]	ELECTRICAL MOTOR LOAD
[Symbol]	RECESSED FIXTURE. TYPE INDICATED	[Symbol]	CONTROL CABLE
[Symbol]	AREA OF RESCUE SIGN - SEE LIGHTING SCHEDULE	[Symbol]	SPECIAL RECEPTACLE
[Symbol]	EXIT LIGHT. DIRECTIONAL ARROWS AS INDICATED.	[Symbol]	TELEVISION SIGNAL CONNECTION
[Symbol]	WIRE ALL EXIT LIGHTS TO NEAREST EM. LIGHT CIRCUIT.	[Symbol]	TELEPHONE CONNECTION
[Symbol]	S.P.S.T. SWITCH, DIMMER SWITCH, FAN SPEED CONTROL SWITCH	[Symbol]	EMERGENCY PULL SWITCH
[Symbol]	3-WAY SWITCH, PILOT LIGHT SWITCH, KEYED SWITCH	[Symbol]	THERMOSTAT
[Symbol]	AUTOMATIC WALL SWITCH	[Symbol]	TIMESWITCH
[Symbol]	DUPLEX RECEPTACLE, SPLIT WIRED WITH 1/2 SWITCHED, ABOVE COUNTER	[Symbol]	TRANSFORMER
[Symbol]	DOUBLE DUPLEX (TWO) DUPLEX RECEPTACLE	[Symbol]	CEILING MOUNTED OCCUPANCY SENSOR
[Symbol]	FLOOR BOX RECEPTACLE	[Symbol]	JUNCTION BOX
[Symbol]	208V. 1P RECEPTACLE - 20A EXCEPT WHEN NOTED	[Symbol]	"E" INDICATES WIRING TO EMERGENCY POWER. SEE SCHEDULE ON E2.1.
[Symbol]	THROUGH WALL PTAC UNIT. SEE MECHANICAL.	[Symbol]	WP WEATHER PROOF
		[Symbol]	GFI GROUND FAULT CURRENT INTERRUPTING RECEPTACLE
		[Symbol]	CVO CONVENIENCE OUTLET

### THIRD FLOOR - LIGHTING

SCALE: 1/8"=1'-0"

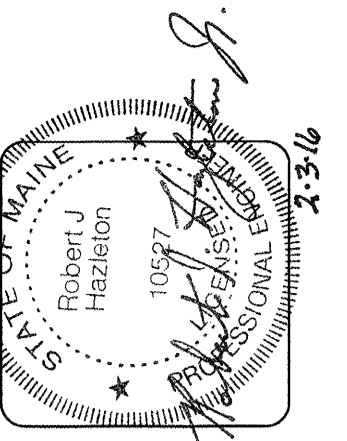

**lenity**  
architecture  
3150 Kellee Court, SE, Salem, Oregon 97301  
P 503.399.1090 F 503.399.0585 wlenityarchitecture.com

**COLSON AND COLSON**  
GENERAL CONTRACTOR, INC.  
2280 MCGILCHRIST STREET, SUITE 200  
SALEM, OREGON, 97302  
PHONE (503) 586-7401

**PORTLAND**  
RETIREMENT RESIDENCE  
802 OCEAN AVE., PORTLAND, MAINE 04103

**THIRD FLOOR**  
LIGHTING  
CORE PLAN

DATE: 8/28/2015  
REVISED DATE: 9/22/2015  
SHEET: E1.3L

sheet: 11/20/15 11:58 AM Note: s:\c\112021182.dwg AML:banb M:\projects\main\3rd\3rd\3rd\lighting E1.3L