

NOTE:
THIS IS ANI-1OCCUPANCY FACILITY AND IS NOT REQUIRED TO BE LICENSED. STAFF DOES NOT PROVIDE RESIDENTS WITH ASSISTANCE WITH BATHING, OR MEDICATION DISPENSING.

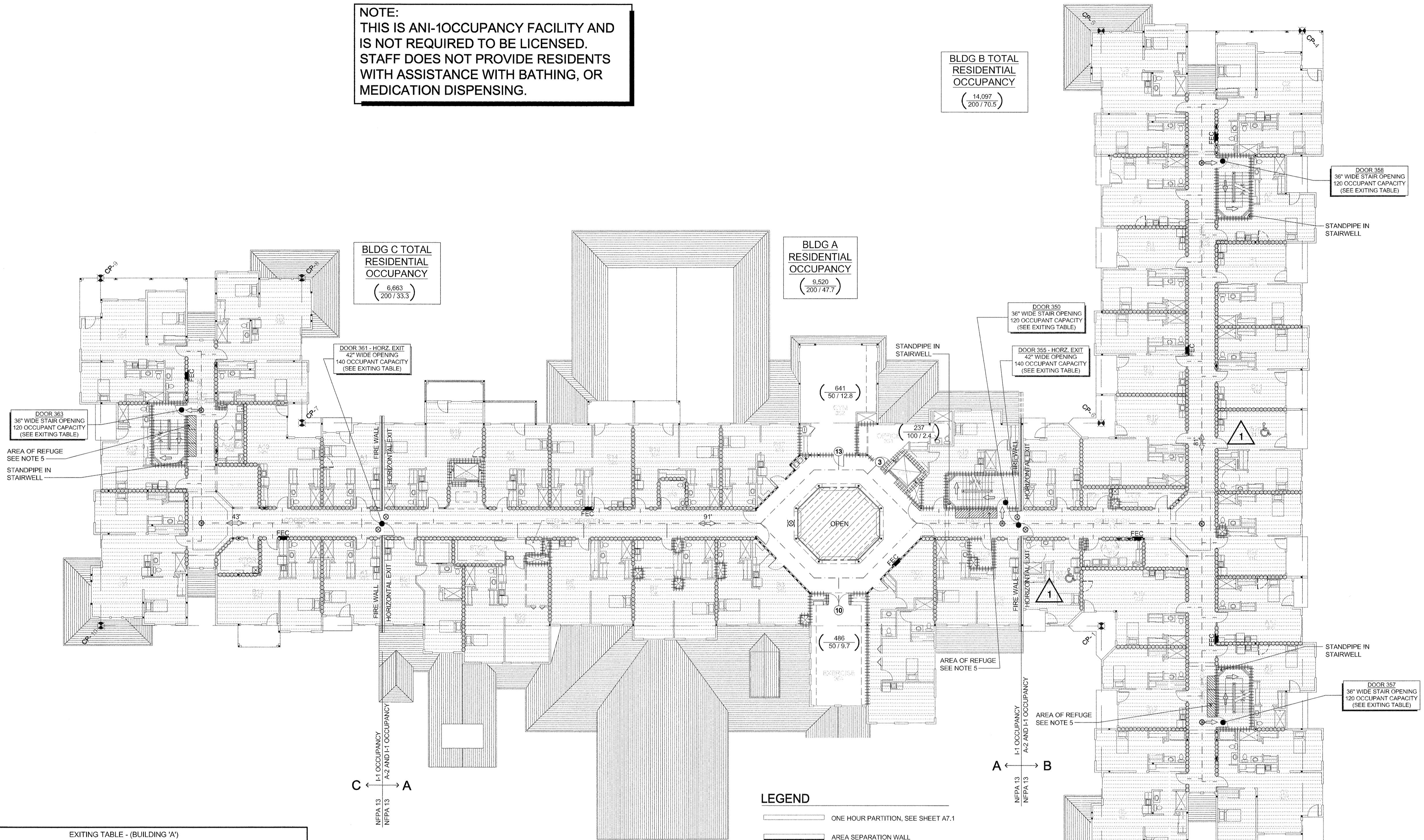

BLDG C TOTAL RESIDENTIAL OCCUPANCY
(6,663 / 200 / 33.3)

BLDG A RESIDENTIAL OCCUPANCY
(9,520 / 200 / 47.7)

BLDG B TOTAL RESIDENTIAL OCCUPANCY
(14,097 / 200 / 70.5)

- LEGEND**
- ONE HOUR PARTITION, SEE SHEET A7.1
 - AREA SEPARATION WALL RATED FIRE WALL - HORIZONTAL EXIT, SEE SHEET A7.1
 - PATH OF EGRESS
 - EXIT TO PUBLIC WAY (SHOWING OCCUPANT LOAD AT EXIT AND EXITING DIM. REQ'D)
 - OCCUPANT LOAD EXITING FROM SPACE OR BUILDING
 - FIRE EXTINGUISHER CABINET. FIRE EXTINGUISHERS PLACED NOT TO EXCEED A MAXIMUM OF 75 FEET OF TRAVEL DISTANCE.
 - EXIT ROUTE w/ ARROWS POINTING TOWARD EXITS (TRAVEL DISTANCE TO EXIT IS LABELED ABOVE ARROW)
 - EXIT LIGHT. DIRECTIONAL ARROWS AS INDICATED. EXIT SIGN PLACEMENT SHALL BE NO MORE THAN 100 FEET.

SEE SHEET A0.5 FOR FULL CODE SUMMARY

OCCUPANT LOAD CALCULATIONS PER TABLE 1004.1.1

THIRD FLOOR

| Room Number | Room | SqFt | Floor Area Per Occupant | Occupant Load | Occupant Load |
|-------------|------------------|--------|-------------------------|-----------------------------|---------------|
| BLDG "A" | Residential Area | 9,520 | 200 | 47.60 | 48 |
| 351 | Office | 237 | 100 | 2.37 | 3 |
| 352 | Gym | 641 | 50 | 12.82 | 13 |
| 354 | Exercise | 486 | 50 | 9.72 | 10 |
| BLDG "B" | All Spaces | 14,097 | 200 | 70.49 | 71 |
| BLDG "C" | All Spaces | 6,663 | 200 | 33.32 | 34 |
| | | | | Building 'A' Total = | 71 |
| | | | | Building 'B' Total = | 71 |
| | | | | Building 'C' Total = | 34 |
| | | | | Grand Total = | 179 |

| EXITING TABLE - (BUILDING 'A') - EGRESS OCCUPANT LOADS PER TABLE 1004.1.1 - | | |
|--|------------------------------------|----------------------------------|
| 4TH FLOOR LOAD - | | |
| TOTAL BUILDING 'A' 4TH FLOOR OCCUPANT LOAD | EGRESS WIDTH REQ. PER TABLE 1005.1 | # OF EXITS REQ. PER TABLE 1019.1 |
| 74 | 74 x .3 = 22.2" | 2 |
| EXIT | | |
| | EGRESS WIDTH | MAX. OCC. LOAD CAPACITY |
| STAIR EXIT DOOR 350 | 36" | 120 |
| HORIZONTAL EXIT DOOR 361 | 42" | 140 |
| TOTALS PROVIDED: | 78" | 260 |
| EXITING TABLE - (BUILDING 'B') - EGRESS OCCUPANT LOADS PER TABLE 1004.1.1 - | | |
| 4TH FLOOR LOAD - | | |
| TOTAL BUILDING 'B' 4TH FLOOR OCCUPANT LOAD | EGRESS WIDTH REQ. PER TABLE 1005.1 | # OF EXITS REQ. PER TABLE 1019.1 |
| 71 | 71 x .3 = 21.3" | 2 |
| EXIT | | |
| | EGRESS WIDTH | MAX. OCC. LOAD CAPACITY |
| HORIZONTAL EXIT DOOR 355 | 42" | 140 |
| STAIR EXIT DOOR 357 | 36" | 120 |
| STAIR EXIT DOOR 358 | 36" | 120 |
| TOTALS PROVIDED: | 114" | 380 |
| EXITING TABLE - (BUILDING 'C') - EGRESS OCCUPANT LOADS PER TABLE 1004.1.1 - | | |
| 4TH FLOOR LOAD - | | |
| TOTAL BUILDING 'C' 4TH FLOOR OCCUPANT LOAD | EGRESS WIDTH REQ. PER TABLE 1005.1 | # OF EXITS REQ. PER TABLE 1019.1 |
| 34 | 34 x .3 = 10.2" | 2 |
| EXIT | | |
| | EGRESS WIDTH | MAX. OCC. LOAD CAPACITY |
| HORIZONTAL EXIT DOOR 361 | 42" | 140 |
| STAIR EXIT DOOR 363 | 36" | 120 |
| TOTALS PROVIDED: | 78" | 260 |

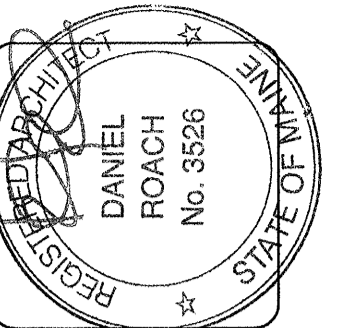
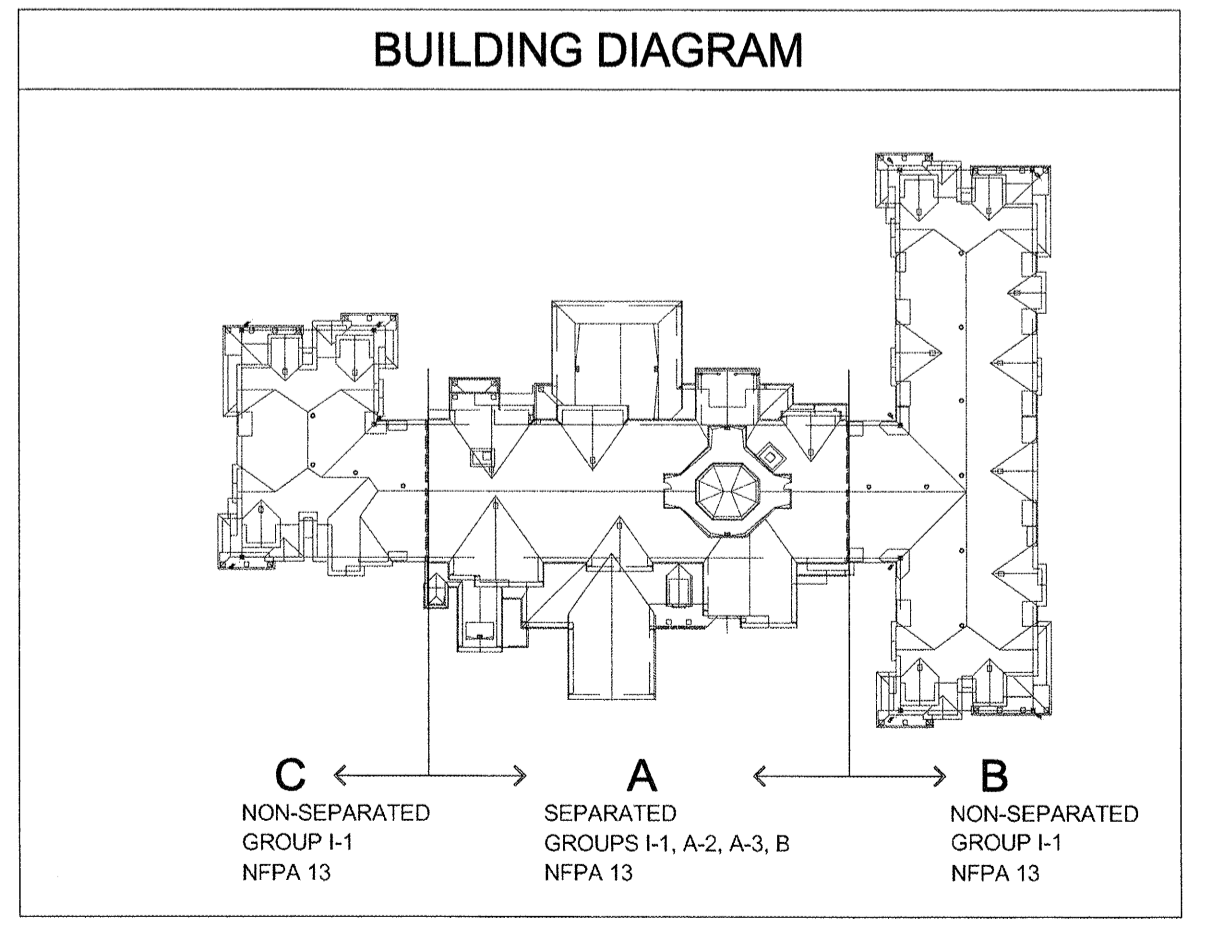

lenity architecture
3150 Kettle Court SE, Salem, Oregon 97301
P: 503 399 1090 F: 503 399 0585

COLSON AND COLSON
GENERAL CONTRACTOR, INC.
2280 McGill CHRIST STREET SE, SUITE 200
SALEM, OREGON, 97302
PHONE (503) 586-7401

PORTLAND RETIREMENT RESIDENCE
802 OCEAN AVE., PORTLAND, MAINE 04103

THIRD FLOOR EGRESS PLAN

DATE: 8/28/2015
REVISED DATE: 9/22/2015

SHEET A0.3

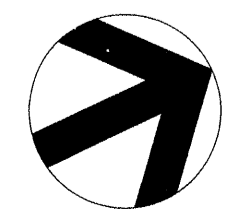

THIRD FLOOR EGRESS PLAN
SCALE: 1/16" = 1'-0"