

**APPLICATION FOR PERMIT** *New* **PERMIT ISSUED**

B.O.C.A. USE GROUP .....  
 B.O.C.A. TYPE OF CONSTRUCTION ..... *789*  
 ZONING LOCATION ..... PORTLAND, MAINE .. *Apr 11-13, 1984* **CITY of PORTLAND**

JUL 5 1984

To the CHIEF OF BUILDING & INSPECTION SERVICES, PORTLAND, MAINE

The undersigned hereby applies for a permit to erect, alter, repair, demolish, move or install the following building, structure, equipment or change use in accordance with the Laws of the State of Maine, the Portland B.O.C.A. Building Code and Zoning Ordinance of the City of Portland with plans and specifications, if any, submitted herewith and the following specifications:

LOCATION .. *Lot 13-14 1/2 of 15 Baygett St., Assessors 410-C* .. Fire District #1  #2   
 1. Owner's name and address .. *L. C. Andrew Custom Homes 24 Depot St.,* Telephone .. *892-3149*  
 2. Lessee's name and address .. *So. Windham* .. Telephone ..  
 3. Contractor's name and address *Owner* .. Telephone ..

Proposed use of building *dwelling* .. No. of stories ..  
 Last use .. No. families .. *1*  
 Material .. No. stories .. Heat .. Style of roof .. Roofing ..  
 Other buildings on same lot ..

Estimated contractual cost \$ *35,000* .. Appeal Fees \$ ..  
 FIELD INSPECTOR—Mr. .. Base Fee .. *185.00*  
 @ 775-5451 .. Lic Fee ..  
 TOTAL \$ ..

To construct single family dwelling, 24' x 40' no garage as per plans. 4 sheets of plans.

Stamp of Special Conditions

NOTE TO APPLICANT: Separate permits are required by the installers and subcontractors of heating, plumbing, electrical and mechanicals.

**DETAILS - NEW WORK**

Is any plumbing involved in this work? .. *yes* .. Is any electrical work involved in this work? .. *yes* ..  
 Is connection to be made to public sewer? .. *yes* .. If not, what is proposed for sewage? ..  
 Has septic tank, notice been sent? .. Form notice sent? ..  
 Height average grade to top of plate .. *10'* .. Height average grade to highest point of roof .. *15'*  
 Size, front .. *40'* .. depth .. *24'* .. No. stories .. *1* .. solid or filled land? .. *solid* .. earth or rock? .. *earth*  
 Material of foundation .. *concrete* .. Thickness, top .. *10"* .. bottom .. *10"* .. cellar .. *yes*  
 Kind of roof .. *pitched* .. Rise per foot .. *5/12* .. Roof covering .. *asphalt shingles*  
 No. of chimneys .. *1* .. Material of chimneys .. *brick* .. of lining .. *clay* .. Kind of heat .. *elec* .. fuel ..  
 Framing Lumber—Kind .. *spruce* .. Dressed or full size? .. *2x6* .. Corner posts .. *2.4 x 6* .. Sills .. *2 x 6*  
 Size Girder .. *3 - 2 x 10* .. Column, under girders .. Size .. Max. on centers ..  
 Studs (outside walls and carrying partitions) 2x4-16" O. C. Bridging in every floor and flat roof span over 8 feet.  
 Joists and rafters: 1st floor .. *2 x 8* .. 2nd .. 3rd .. roof .. *trusses*  
 On centers: 1st floor .. *16* .. 2nd .. 3rd .. roof .. *24*  
 Maximum span. 1st floor .. 2nd .. 3rd .. roof ..  
 If one story building with masonry walls, thickness of walls? .. height? ..

**IF A GARAGE**

No. cars now accommodated on same lot .., to be accommodated .. number commercial cars to be accommodated ..  
 Will automobile repairing be done other than minor repairs to cars habitually stored in the proposed building? ..

APPROVALS BY: .. DATE ..  
 BUILDING INSPECTION—PLAN EXAMINER ..  
 ZONING: ..  
 BUILDING CODE: ..  
 Fire Dept.: ..  
 Health Dept.: ..  
 Others: ..

MISCELLANEOUS  
 Will work require disturbing of any tree on a public street? .. *no*  
 Will there be in charge of the above work a person competent to see that the State and City requirements pertaining thereto are observed? .. *yes* ..

Signature of Applicant .. *L. C. Andrew* .. Phone # .. *none*  
 Type Name of above .. *Rep. So. Windham for L. C. Andrew Co.* .. 1  2  3  4   
 Other ..  
 and Address ..

FIELD INSPECTOR'S COPY .. APPLICANT'S COPY .. OFFICE FILE COPY



CITY OF PORTLAND, MAINE  
Department of Building Inspection

# Certificate of Occupancy

LOCATION **Lot # 13, 14, 15 Daggett Street**

Issued to **L. C. Andrew Company**

Date of Issue **Jan. 28, 1965**

This is to certify that the building, premises, or part thereof, at the above location, built—altered—changed as to use under Building Permit No. **4-749**, has had final inspection, has been found to conform substantially to requirements of Zoning Ordinance and Building Code of the City, and is hereby approved for occupancy or use, limited or otherwise, as indicated below.

PORTION OF BUILDING OR PREMISES

APPROVED OCCUPANCY

**Entire**

**Single family dwelling  
no garage**

Limiting Conditions:

This certificate supersedes  
certificate issued

Approved:

*1-28-65*  
(Date) *H. ...*  
Inspector

*[Signature]*  
Inspector of Buildings

Notice: This certificate identifies lawful use of building or premises, and ought to be transferred from owner to owner when property changes hands. Copy will be furnished to owner or lessee for one dollar.

3



CITY OF PORTLAND, MAINE  
Department of Building Inspector

# Certificate of Occupancy

Issued to **L. C. Andrew Company** LOCATION **lot # 13, 14, 15 Daggett Street**  
Date of Issue **Jan. 28, 1985**

This is to certify that the building, premises, or part thereof, at the above location, built—altered—changed as to use under Building Permit No. **84-769**, has had final inspection, has been found to conform substantially to requirements of Zoning Ordinance and Building Code of the City, and is hereby approved for occupancy or use, limited or otherwise, as indicated below.

PORTION OF BUILDING OR PREMISES

APPROVED OCCUPANCY

**Entire**

Limiting Conditions:

**Singla family dwelling  
no garage**

This certificate supersedes certificate issued

Approved: *[Signature]*  
1-28-85  
(Date) Inspector

*[Signature]*  
Inspector of Buildings

Notice: This certificate identifies lawful use of building or premises, and ought to be transferred from owner to owner when property changes hands. Copy will be furnished to owner or lessee for one dollar.

L.C. ADAMS Date: 4/19/84

ors No.: 410-C - 13, 14, 1/2 OF 15

CHECK LIST AGAINST ZONING ORDINANCE

- Date - NEW
- Zone Location - R-3
- Interior or ~~corner~~ lot -
- Use - 40' x 24' DWELLING
- Sewage Disposal - PUBLIC
- Rear Yards - 25' - 25' MIN.
- Side Yards - 23' - 12' - 8' - 8' MIN.
- Front Yards - 35' - 25' MIN.
- Projections - NONE
- Height - 1 STORY - 35' MAX.
- Lot Area - 17500 $\phi$  - 6500 $\phi$  MIN.
- Building Area - 960 $\phi$  - 1875 $\phi$  MAX.
- Area per Family - 11500 $\phi$  - 6500 $\phi$  MIN.
- Width of Lot - 75' - 65' MIN.
- Lot Frontage - 75' - 50' MIN.
- Off-street Parking - YES

Leading Bays -

- Site Plan -
- Shoreland Zoning -
- Flood Plains -

PROPOSED HOME ON LOTS 13, 14, 1/2-15

410-C

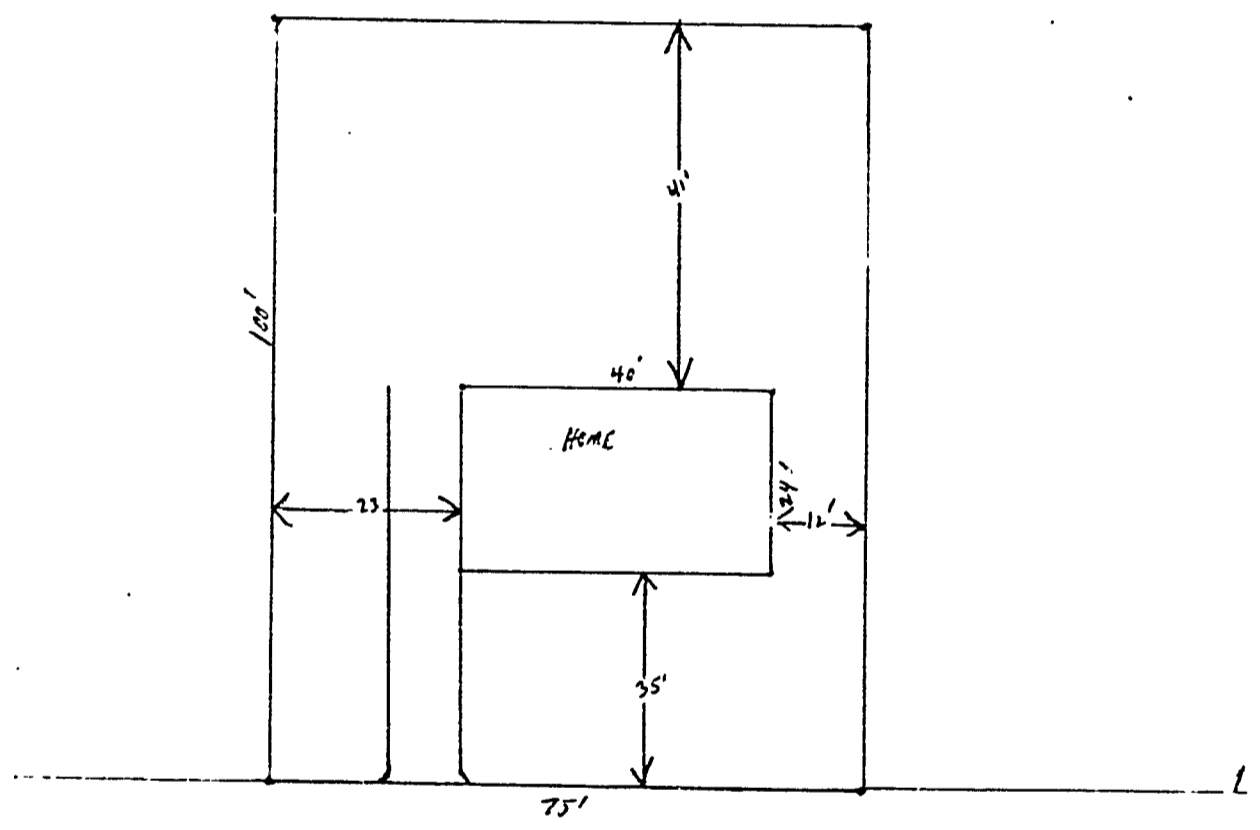

DAGGERS ST.



## CITY OF PORTLAND

DEPARTMENT OF PLANNING & URBAN DEVELOPMENT  
INSPECTION SERVICES DIVISION

July 3, 1984

L.C. Andrew Custom Homes  
28 Depot St.,  
So. Windham, Me

Ref: 40 9-E-Lot # 13-14½ Daggett St.

Dear Sir:

Your application to construct a single family dwelling has been reviewed and a building permit is herewith issued subject to following requirements.

1. Every sleeping room below the fourth story in building; of Use Group R shall have at least one operable window or exterior door approved for emergency egress or rescue. The units must be operable from the inside opening with the use of separate tools. Where window are provided as a means of egress or rescue, they shall have a sill height not more than 44 inches above the floor. All egress or rescue window from sleeping rooms must have a minimum net clear opening of 5.7 sq. ft. The minimum net clear opening height dimension shall be 24 inches. The minimum net clear opening width dimension shall be 20 inches.

2. A minimum of one single station smoke detector, shall be installed within buildings of Use Group R-3. It shall be installed in a manner and location approved by the authority having jurisdiction. When actuated, the detector shall provide an alarm suitable to warn the occupants within the individual building. In buildings having basements or cellars an additional smoke detector shall be installed in the basement or cellar in a location approved by the authority having jurisdiction.

3. No work is to be started until you have contacted Mr. George Flaherty of the Parks and Public Work Dept. for requirements on sewer and road access.

If you have any questions on these requirements please call this office.

Sincerely,

P. Samuel Hoffses  
Chief of Insp. Services

cc George Flaherty P.P.W.

APPLICATION FOR PERMIT

PERMIT ISSUED

B.O.C. USE GROUP ..... 789

B.O.C.A. TYPE OF CONSTRUCTION .....

ZONING LOCATION ..... 2-3 ..... PORTLAND, MAINE .. April 18, 1984

JUL 5 1984

CITY of PORTLAND

To the CHIEF OF BUILDING & INSPECTION SERVICES, PORTLAND, MAINE

The undersigned hereby applies for a permit to erect, alter, repair, demolish, move or install the following building, structure, equipment or change use in accordance with the Laws of the State of Maine, the Portland B.O.C.A. Building Code and Zoning Ordinance of the City of Portland with plans and specifications, if any, submitted herewith and the following specifications.

LOCATION .. Lot 13-14 .. of 15 Daggett St. Assessors 410-C .. Fire District #1  #2

1. Owner's name and address .. L. C. Andrew Custom Homes - 28 Depot St. Telephone .. 892-3149

2. Lessee's name and address .. So. Windham .. Telephone ..

3. Contractor's name and address Owner .. Telephone ..

Proposed use of building dwelling .. No. of sheets .. No. families .. 1

Last use .. No. families ..

Material .. stories .. Heat .. Style of roof .. Roofing ..

Other buildings on same lot ..

Estimated contractual cost \$ 35,000 .. Appeal Fees \$ ..

FIELD INSPECTOR - Mr. DAVID .. Base Fee .. 185.00 ..

@ 775-5451

Late Fee ..

TOTAL \$ ..

To construct single family dwelling, 24' x 40' no garage as per plans. 4 sheets of plans.

Stamp of Special Conditions PERMIT ISSUED WITH LETTER

NOTE TO APPLICANT: Separate permits are required by the installers and subcontractors of heating, plumbing, electrical and mechanicals.

DETAILS OF NEW WORK

Is any plumbing involved in this work? .. yes .. Is any electrical work involved in this work? .. yes ..
Is connection to be made to public sewer? .. yes .. If not, what is proposed for sewage? ..
Has septic tank notice been sent? .. Form notice sent? ..
Height average grade to top of plate .. 10' .. Height average grade to highest point of roof .. 15' ..
Size, front .. 40' .. depth .. 24' .. No. stories .. 1 .. solid or filled land? .. solid .. earth or rock? .. earth ..
Material of foundation .. concrete .. Thickness, top .. 10" .. bottom .. 10" .. cellar .. yes ..
Kind of roof .. pitched .. Rise per foot .. 5/12 .. Roof covering .. asphalt shingles ..
No. of chimneys .. 1 .. Material of chimneys .. blk .. of lining .. clay .. Kind of heat .. elec .. fuel ..
Framing Lumber - Kind .. spruce .. Dressed or full size .. brick .. Corner posts .. 2 x 4 x 6 .. Sills .. 2 x 6 ..
Size Girder .. 2 x 10 .. Columns under girders .. Size .. Max. centers ..
Studs (outside walls and carrying partitions) 2x4-16" O. C. Bridging in every floor and flat roof span over 8 feet.
Joists and rafters: 1st floor .. 2 x 8 .. 2nd .. 3rd .. roof trusses ..
On centers: 1st floor .. 16' .. 2nd .. 3rd .. roof 24' ..
Maximum span: 1st floor .. 2nd .. 3rd .. roof ..
If one story building with masonry walls, thickness of walls? .. height? ..

IF A GARAGE

No. cars now accommodated on same lot .. to be accommodated .. number commercial cars to be accommodated ..
Will automobile repairing be done other than minor repairs to cars habitually stored in the proposed building? ..

APPROVALS BY: BUILDING INSPECTION - PLAN EXAMINER .. DATE .. MISCELLANEOUS ..
ZONING: .. Will work require disturbing of any tree on a public street? .. no ..
BUILDING CODE: .. Will there be in charge of the above work a person competent to see that the State and City requirements pertaining thereto are observed? .. yes ..
Fire Dept.: ..
Health Dept.: ..
Others: ..

Signature of Applicant .. Ron Smith for L. C. Andrew Co. Phone # .. same ..

Type Name of above .. Ron Smith for L. C. Andrew Co. 1  2  3  4

Other .. and Address ..

FIELD INSPECTOR'S COPY APPLICANT'S COPY OFFICE FILE COPY

Signature of Field Inspector: DAVID

Their Lot No 3:

NOTES

7/3/84 OKed to place  
foundation as per stakes  
showing lot lines;

8/30/84 - Deck completed;

10/10/84 Progressing as per  
plans.

1-3-85 Started drywalling;

1-28-85 - Final - OK to issue this copy of [unclear]  
[unclear]

3

Permit No. 84/989

Location 1314 15

Owner C. [unclear]

Date of permit 9-18-84

Approved 9-5-84

Dwelling [unclear]

Garage [unclear]

Alteration [unclear]

