



APPLICATION FOR PERMIT

PERMIT ISSUED

B.O.C.A. USE GROUP

B.O.C.A. TYPE OF CONSTRUCTION 785

JUL 5 1984

ZONING LOCATION PORTLAND, MAINE April 18, 1984

CITY of PORTLAND

To the CHIEF OF BUILDING & INSPECTION SERVICES, PORTLAND, MAINE

The undersigned hereby applies for a permit to erect, alter, repair, demolish, move or install the following building, structure, equipment or change use in accordance with the Laws of the State of Maine, the Portland B.O.C.A. Building Code and Zoning Ordinance of the City of Portland with plans and specifications if any, submitted herewith and the following specifications:

LOCATION A09-R - Lot # 25-264 OF 27 Daggett Street File District #1 #2

1. Owner's name and address L. C. Andrew Custom Homes-28 Depot St. Telephone ... 892-3149

2. Lessee's name and address So. Windham Telephone

3. Contractor's name and address Owner Telephone

..... No. of sheets

Proposed use of building Dwelling No. families ... 1

..... No. families

Material No. stories Heat Style of roof Roofing

Other buildings on same lot

Estimated contractual cost \$ 35,000

Appeal Fees \$

FIELD INSPECTOR - Mr.

Base Fee 165.00

@ 775-5451

Late Fee

TOTAL \$ 165.00

To construct single family dwelling, 24' x 34' no garage as per plans, 4 sheets of plans

Stamp of Special Conditions

NOTE TO APPLICANT: Separate permits are required by the installers and subcontractors of heating, plumbing, electrical and mechanicals.

DETAILS OF NEW WORK

Is any plumbing involved in this work? YES is any electrical work involved in this work? YES

Is connection to be made to public sewer? YES If not, what is proposed for sewage?

Has septic tank notice been sent? Form notice sent?

Height average grade to top of plate Height average grade to highest point of roof

Size, front depth No. stories solid or filled land? earth or rock?

Material of foundation Thickness, top bottom cellar

Kind of roof Rise per foot Roof covering

No. of chimneys Material of chimneys of lining Kind of heat fuel

Framing Lumber—Kind Dressed or full size? Corner posts Sills

Size Girder Columns under girders Size Max. on centers

Studs (outside walls and carrying partitions) 2x4-16" O. C. Bridging in every floor and flat roof span over 8 feet.

Joists and rafters: 1st floor 2nd 3rd roof

On centers: 1st floor 2nd 3rd roof

Maximum span: 1st floor 2nd 3rd roof

If one story building with masonry walls, thickness of walls? height?

IF A GARAGE

No. cars now accommodated on same lot to be accommodated number commercial cars to be accommodated

Will automobile repairing be done other than minor repairs to cars habitually stored in the proposed building?

APPROVALS BY: DATE

MISCELLANEOUS

BUILDING INSPECTION—PLAN EXAMINER

Will work require disturbing of any tree on a public street? NO

ZONING:

BUILDING CODE:

Will there be in charge of the above work a person competent

Fire Dept.:

to see that the State and City requirements pertaining thereto

Health Dept.:

are observed? YES

Others:

Signature of Applicant Phone # 880

Type Name of above Ron Smith for L. C. Andrew Co. 1 2 3 4

Other

and Address

4

FIELD INSPECTOR'S COPY

APPLICANT'S COPY

OFFICE FILE COPY



CITY OF PORTLAND, MAINE
Department of Building Inspection

Certificate of Occupancy

LOCATION 405-E-25, 26 1/2 or 27 Daggett St.

Issued to L. C. Andrew Custor homes

Date of Issue Jan. 4, 1965

This is to certify that the building, premises, or part thereof, at the above location, built—altered—changed as to use under Building Permit No. 04/705, has had final inspection, has been found to conform substantially to requirements of Zoning Ordinance and Building Code of the City, and is hereby approved for occupancy or use, limited or otherwise, as indicated below.

PORTION OF BUILDING OR PREMISES

APPROVED OCCUPANCY

Entire

Single Family

Limiting Conditions:

This certificate supersedes
certificate issued

Approved:

1-4-65
(Date) *[Signature]*
Inspector

[Signature]
Inspector of Buildings

[Signature]

Notice: This certificate identifies lawful use of building or premises, and ought to be transferred from owner to owner when property changes hands. Copy will be furnished to owner or lessee for one dollar.

5



CITY OF PORTLAND, MAINE
Department of Building Inspection

Certificate of Occupancy

LOCATION 409-E-25, 26 1/2 of 27 Daggett St.

Issued to L. C. Andrew Custom Homes

Date of Issue Jan. 4, 1985

This is to certify that the building, premises, or part thereof, at the above location, built—altered—changed as to use under Building Permit No. 34/785, has had final inspection, has been found to conform substantially to requirements of Zoning Ordinance and Building Code of the City, and is hereby approved for occupancy or use, limited or otherwise, as indicated below.

PORTION OF BUILDING OR PREMISES

APPROVED OCCUPANCY

Entire

Single Family

Limiting Conditions:

This certificate supersedes certificate issued

Approved:

1-4-85

(Date)

[Signature]

Inspector

[Signature]
Inspector of Buildings

Notice: This certificate identifies lawful use of building or premises and ought to be transferred from owner to owner when property changes hands. Copy will be furnished to owner or lessee for one dollar.

PROPOSED HOME ON LOTS 25, 26, 1/2 27
DAGGETT ST.

485-E

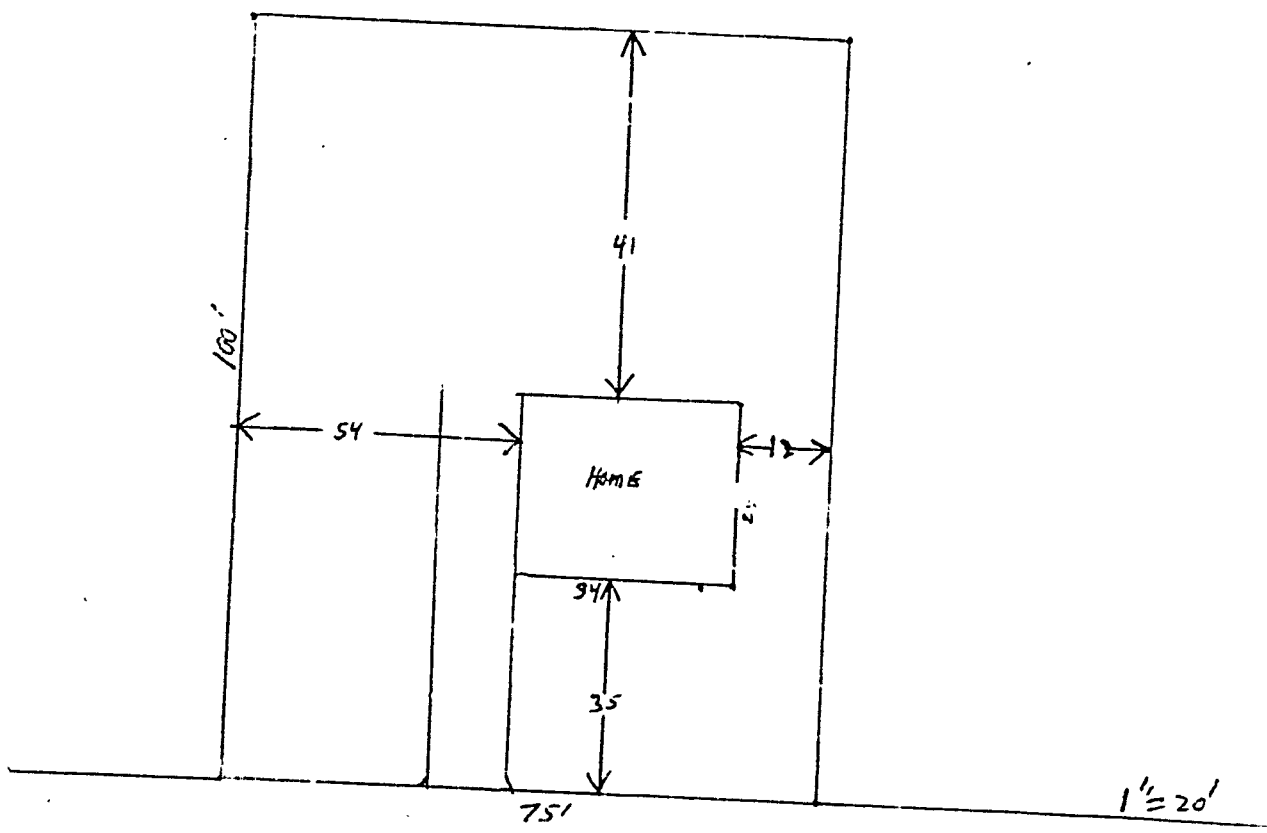

DAGGETT ST.



CITY OF PORTLAND

DEPARTMENT OF PLANNING & URBAN DEVELOPMENT
INSPECTION SERVICES DIVISION

July 3, 1984

L.C. Andrew Custom Homes
28 Depot St.,
So. Windham, Me.

Ref: 40 9-E-Lot # 25-26½ Daggett St.

Dear Sir:

Your application to construct a single family dwelling has been reviewed and a building permit is herewith issued subject to following requirements.

1. Every sleeping room below the fourth story in building of Use Group R shall have at least one operable window or exterior door approved for emergency egress or rescue. The units must be operable from the inside opening with the use of separate tools. Where window are provided as a means of egress or rescue, they shall have a sill height not more than 4' inches above the floor. All egress or rescue window from sleeping rooms must have a minimum net clear opening of 5.7 sq. ft. The minimum net clear opening height dimension shall be 24 inches. The minimum net clear opening width dimension shall be 20 inches.

2. A minimum of one single station smoke detector, shall be installed within buildings of Use Group R-3. It shall be installed in a manner and location approved by the authority having jurisdiction. When actuated, the detector shall provide an alarm suitable to warn the occupants within the individual building. In buildings having basements or cellars an additional smoke detector shall be installed in the basement or cellar in a location approved by the authority having jurisdiction.

3. No work is to be started until you have contacted Mr. George Flaherty of the Parks and Public Work Dept. for requirements on sewer and road access.
If you have any questions on these requirements please call this office.

Sincerely,

P. Samuel Hoffses
Chief of Insp. Services

cc George Flaherty P.P.W.

Applicant: *L.C. ANDREWS* Date: *4/19/84*
Address: *MAGGETT ST.*
Assessors No.: *409-E-25,26, 1/2 OF 27*

CHECK LIST AGAINST ZONING ORDINANCE

- Date - *NEW*
- Zone Location - *R-3*
- Interior or corner lot -
- Use - *24' x 34' DWELLING*
- Sewage Disposal - *PUBLIC*
- Rear Yards - *25' ± - 25' MIN.*
- Side Yards - *54' - 12' - 20' - 8'*
- Front Yards - *35' - 25' MIN.*
- Projections - *NONE*
- Height - *TWO STORY - 35' MAX.*
- Lot Area - *7,500 ± 6,500 ± MIN.*
- Building Area - *8,169 - 18,750 ± MAX.*
- Area per Family - *7,500 ± - 6,500 ± MIN.*
- Width of Lot - *75' - 65' MIN.*
- Lot Frontage - *45' - 50' MIN.*
- Off-street Parking - *YES*
- Loading Bays -

Site Plan
 Shoreland Zoning -
 Flood Plains -

APPLICATION FOR PERMIT

PERMIT ISSUED

B.O.C.A. USE GROUP 785

B.O.C.A. TYPE OF CONSTRUCTION

ZONING LOCATION 2-3 PORTLAND, MAINE April 18, 1984

JUL 5 1984

CITY of PORTLAND

To the CHIEF OF BUILDING & INSPECTION SERVICES, PORTLAND, MAINE

The undersigned hereby applies for a permit to erect, alter, repair, demolish, move or install the following building, structure, equipment or change use in accordance with the Laws of the State of Maine, the Portland B.O.C.A. Building Code and Zoning Ordinance of the City of Portland with plans and specifications, if any, submitted herewith and the following specifications:

LOCATION 409-E Lot # 25-26 1/2 of 27 Daggett Street

- 1. Owner's name and address L. C. Andrew Custom Homes-28 Lepot St. Telephone 892-3149
2. Lessee's name and address So, Windham Telephone
3. Contractor's name and address Owner Telephone

Proposed use of building dwelling No. of sheets
Past use No. families 1

Material No. stories Heat Style of roof Roofing

Other buildings on same lot

Estimated contractual cost \$ 35,000

FIELD INSPECTOR-Mr. FAVIA @ 775-5451 Appeal Fees Base Fee 185.00 Late Fee TOIA \$ 185.00

To construct single family dwelling, 24' x 34' no garage as per plans. 4 sheets of plans

Stamp of Special Conditions

NOTE TO APPLICANT: Separate permits are required by the installers and subcontractors of heating, plumbing, electrical and mechanicals.

DETAILS OF NEW WORK

Is any plumbing involved in this work? Yes Is any electrical work involved in this work? Yes
Is connection to be made to public sewer? Yes If not, what is proposed for sewage?
Has septic tank notice been sent? Form notice sent?
Height average grade to top of plate Height average grade to highest point of roof
Size, front depth No. stories solid or filled land? earth or rock?
Material of foundation Thickness, top bottom cellar
Kind of roof Rise per foot Roof covering
No. of chimneys Material of chimneys of lining Kind of heat fuel
Framing Lumber-Kind Dressed or full size? Corner posts Sills
Size Girder Columns under girders Size Max. on centers
Studs (outside walls and carrying partitions) 2x4-16" O. C. Bridging in every floor and flat roof span over 8 feet.
Joists and rafters: 1st floor 2nd 3rd roof
On centers: 1st floor 2nd 3rd roof
Maximum span: 1st floor 2nd 3rd roof
If one story building with masonry walls, thickness of walls? height?

IF A GARAGE

No. cars now accommodated on same lot to be accommodated number commercial cars to be accommodated
Will automobile repairing be done other than minor repairs to cars habitually stored in the proposed building?

APPROVALS BY: DATE MISCELLANEOUS
BUILDING INSPECTION-PLAN EXAMINER Will work require disturbing of any tree on a public street?
ZONING: C.A. Mac 4/19/84
BUILDING CODE: Will there be in charge of the above work a person competent to see that the State and City requirements pertaining thereto are observed? Yes
Fire Dept.:
Health Dept.:
Others:

Signature of Applicant Ron Smith for L. C. Andrew Co. Phone # same
Type Name of above Ron Smith for L. C. Andrew Co. 1 2 3 4
Other and Address

FIELD INSPECTOR'S COPY APPLICANT'S COPY OFFICE FILE COPY

PERMIT ISSUED WITH LETTER

5

Tree Plan Lot 5 -
 7/3/84 OK to place
 foundation: ~~horizontal~~ ~~vertical~~
 OK as per ~~plans~~ ~~plans~~
 8/30/84 ~~work completed~~
 10/10/84 Progressing as
 per plans

Permit No. 84/ 785
 Location 4th & 26 1/2 St
 Owner ~~Franklin~~ ~~Franklin~~
 Date of permit 1-18-84
 Approved 7:55
 Design - ~~Franklin's~~ ~~family~~
 Carriage
 Alteration

12/3/84 ~~Final~~
 OK to issue ~~the~~ ~~the~~

Co of O;

