



DISPLAY THIS CARD ON PRINCIPAL FRONTAGE OF WORK



CITY OF PORTLAND

BUILDING

PERMIT

This is to certify that REEO INC VAN

Located At 1223 WASHINGTON

Job ID: 2011-01-295-HVAC

CBL: 408 - - B - 023 - 001 - - - -

has permission to Install (2) 120 Gallon Propane Tanks

provided that the person or persons, firm or corporation accepting this permit shall comply with all of the provisions of the Statutes of Maine and of the Ordinances of the City of Portland regulating the construction, maintenance and use of the buildings and structures, and of the application on file in the department.

Notification of inspection and written permission procured before this building or part thereof is lathed or otherwise closed-in. 48 HOUR NOTICE IS REQUIRED.

A final inspection must be completed by owner before the building or part thereof is occupied. If a certificate of occupancy is required, it must be procured prior to occupancy.

Fire Prevention Officer

Code Enforcement Officer / Plan Reviewer

THIS CARD MUST BE POSTED ON THE STREET SIDE OF THE PROPERTY.
PENALTY FOR REMOVING THIS CARD

PERMIT ISSUED

JAN 31 2011

City of Portland

City of Portland, Maine - Building or Use Permit Application

389 Congress Street, 04101 Tel: (207) 874-8703, FAX: (207) 8716

Job No: 2011-01-295-HVAC	Date Applied: 1/19/2011	CBL: 408 - - B - 023 - 001 - - - - -	
Location of Construction: 1223 WASHINGTON	Owner Name: REEO INC VAN	Owner Address: 189 US SCARBOROUGH, ME - MAINE 04074	Phone:
Business Name:	Contractor Name: DOWNEAST, ENERGY CO	Contractor Address: PO BOX 250 BRUNSWICKMAINE04011	Phone:
Lessee/Buyer's Name:	Phone:	Permit Type: HVAC - HVAC	Zone: R-3
Past Use: Retail establishment - "China Taste"	Proposed Use: Retail Establishment - "China Taste"	Cost of Work: 30.00	CEO District:
		Fire Dept: <input checked="" type="checkbox"/> Approved w/ conditions <input type="checkbox"/> Denied <input type="checkbox"/> N/A Signature: <i>[Signature]</i>	Inspection: Use Group: Type: NFA 58 Signature: <i>[Signature]</i>
Proposed Project Description: 1223 Washington Ave China Taste - HVAC - two 120 gallon gas tanks		Pedestrian Activities District (P.A.D.)	

Permit Taken By:	Zoning Approval		
1. This permit application does not preclude the Applicant(s) from meeting applicable State and Federal Rules. 2. Building Permits do not include plumbing, septic or electrical work. 3. Building permits are void if work is not started within six (6) months of the date of issuance. False information may invalidate a building permit and stop all work. PERMIT ISSUED JAN 31 2011	Special Zone or Reviews <input type="checkbox"/> Shoreland <input type="checkbox"/> Wetlands <input type="checkbox"/> Flood Zone <input type="checkbox"/> Subdivision <input type="checkbox"/> Site Plan <input type="checkbox"/> Maj <input type="checkbox"/> Min <input type="checkbox"/> MM Date: 1/20/11 <i>OR ABM</i>	Zoning Appeal <input type="checkbox"/> Variance <input type="checkbox"/> Miscellaneous <input type="checkbox"/> Conditional Use <input type="checkbox"/> Interpretation <input type="checkbox"/> Approved <input type="checkbox"/> Denied Date:	Historic Preservation <input type="checkbox"/> Not in Dist or Landmark <input type="checkbox"/> Does not Require Review <input type="checkbox"/> Requires Review <input type="checkbox"/> Approved <input type="checkbox"/> Approved w/Conditions <input type="checkbox"/> Denied Date:
	CERTIFICATION		

I hereby certify that I am the owner of record of the named property, or that the proposed work is authorized by the owner of record and that I have been authorized by the owner to make this application as his authorized agent and I agree to conform to all applicable laws of this jurisdiction. In addition, if a permit for work described in the application is issued, I certify that the code official's authorized representative shall have the authority to enter all areas covered by such permit at any reasonable hour to enforce the provision of the code(s) applicable to such permit.

SIGNATURE OF APPLICANT	ADDRESS	DATE	PHONE
RESPONSIBLE PERSON IN CHARGE OF WORK, TITLE		DATE	PHON



FILL IN AND SIGN WITH INK

APPLICATION FOR PERMIT HEATING OR POWER EQUIPMENT

PERMIT ISSUED

JAN 31 2011

To the INSPECTOR OF BUILDINGS, PORTLAND, ME.

City of Portland

The undersigned hereby applies for a permit to install the following heating, cooking or power equipment in accordance with the Laws of Maine, the Building Code of the City of Portland, and the following specifications:

Location / CBL 408 B023001 Use of Building retail Date 1-19-2011
 Name and address of owner of appliance China Taste 1223 Washington Ave Portland ME 917-650-4254
 Installer's name and address Downeast Energy 172 Main Street So. Portland ME 04106 00 Telephone 799-5585

Location of appliance:

- Basement
- Attic
- Floor
- Roof

Type of Fuel:

- Gas
- Oil
- Solid

Appliance Name: _____

U.L. Approved Yes No

Will appliance be installed in accordance with the manufacture's installation instructions? Yes No

IF NO Explain: _____

The Type of License of Installer:

- Master Plumber # _____
- Solid Fuel # _____
- Oil # _____
- Gas # PNT 1665
- Other _____

Type of Chimney:

- Masonry Lined
Factory built _____
- Metal
Factory Built U.L. Listing # _____
- Direct Vent
Type _____ UL# _____

Type of Fuel Tank

- Oil
- Gas

Size of Tank 2-120 gallon tanks

Number of Tanks 2

Distance from Tank to Center of Flame 20' feet.

Cost of Work: \$ 94.00

Permit Fee: \$ 30

Approved

Fire: _____

Ele.: _____

Bldg.: _____

Approved with Conditions

- See attached letter or requirement

Signature of Installer Andrea Karass / Steve Trudeau Inspector's Signature _____ Date Approved _____

White - Inspection Yellow - File Pink - Applicant's Gold - Assessor's Copy

Assessor's Office | 389 Congress Street | Portland, Maine 04101 | Room 115 | (207) 874-8486

[City](#) [Home](#) [Departments](#) [City Council](#) [E-Services](#) [Calendar](#) [Jobs](#)

This page contains a detailed description of the Parcel ID you selected. Press the **New Search** button at the bottom of the screen to submit a new query.

Current Owner Information:

Services	CBL 408 B023001
Applications	Land Use Type RETAIL & PERSONAL SERVICE
Doing Business	Property Location 1223 WASHINGTON AVE
Maps	Owner Information SHI GUO SEN 80 YANKEE DR YARMOUTH ME 04096
Tax Relief	Book and Page 28059/143
Tax Roll	Legal Description 408-B-23-24 WASHINGTON AVE 1221 MAINE AVE 10285 SF
	Acres 0.236

Current Assessed Valuation:

Q & A	TAX ACCT NO. 42264	OWNER OF RECORD AS OF APRIL 2010 VAN REEO INC
browse city services a-z	LAND VALUE \$177,500.00	189 US ROUTE ONE SCARBOROUGH ME 04074
browse facts and links a-z	BUILDING VALUE \$61,200.00	
	NET TAXABLE - REAL ESTATE \$238,700.00	
	TAX AMOUNT \$4,277.50	

Any information concerning tax payments should be directed to the Treasury office at 874-8490 or [e-mailed](#).



Best viewed at 800x600, with Internet Explorer

Building Information:

	Card 1 of 1
Year Built	1927
Style/Structure Type	RETAIL - SINGLE OCCUPANCY
# Units	1
Building Num/Name	1 - DONATELLI'S VARIETY
Square Feet	2244

[View Sketch](#) [View Map](#) [View Picture](#)



Exterior/Interior Information:

	Card 1
Levels	B1/B1
Size	1122
Use	SUPPORT AREA
Height	8
Heating	HW/STEAM
A/C	NONE

	Card 1
Levels	01/01
Size	1122
Use	CONVENIENCE STORE
Height	10
Walls	FRAME
Heating	HW/STEAM
A/C	UNIT

Outbuildings/Yard Improvements:

	Card 1
Year Built	1960
Structure	ASPHALT PARKING
Size	1X7500
Units	1
Grade	C
Condition	3

Sales Information:

Sale Date	Type	Price	Book/Page
9/8/2010	LAND + BUILDING	\$150,000.00	28059/143
7/13/2010	LAND + BUILDING	\$0.00	27912/031

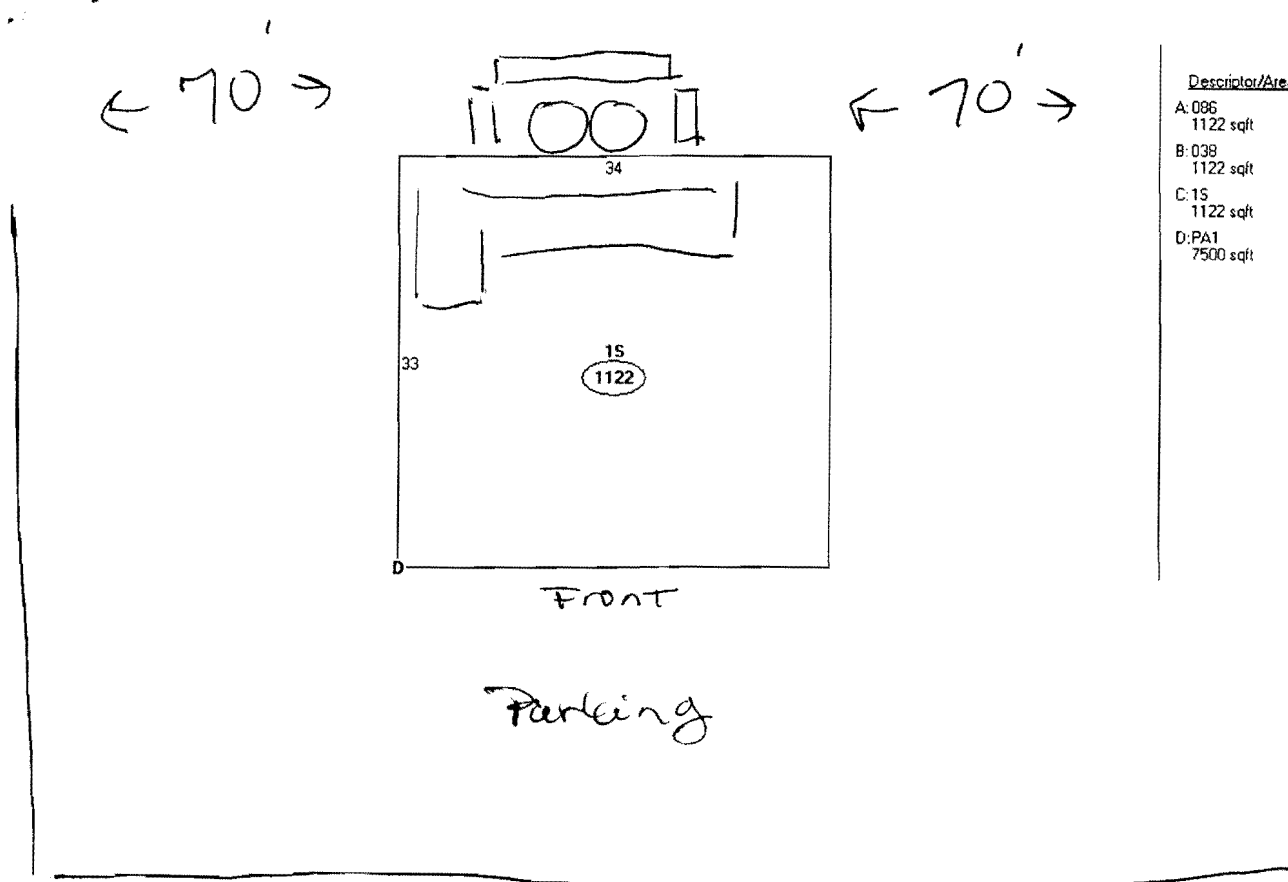

Job Summary Report
Job ID: 2011-01-295-HVAC

Report generated on Jan 19, 2011 3:41:17 PM

Job Type:	HVAC	Job Description:	1223 Washington Ave China Taste	Job Year:	2011
Building Job Status Code:	Initiate Plan Review	Pin Value:	481	Tenant Name:	China Taste
Job Application Date:		Public Building Flag:	N	Tenant Number:	
Estimated Value:	30	Square Footage:			
Related Parties:		REEO VAN		<i>Property Owner</i>	
		Downeast Energy - ENERGY DOWNEAST		<i>GENERAL CONTRACTOR</i>	

Job Charges

Fee Code Description	Charge Amount	Permit Charge Adjustment	Net Charge Amount	Payment Date	Receipt Number	Payment Amount	Payment Adjustment Amount	Net Payment Amount	Outstanding Balance
Tanks Under 300	\$30.00		\$30.00						\$30.00

Location ID: 42264

Location Details

Alternate Id	Parcel Number	Census Tract	GIS X	GIS Y	GIS Z	GIS Reference	Longitude	Latitude
D29815	408 B 023 001		M				-70.283944	43.695068
		Location Type	Subdivision Code	Subdivision Sub Code	Related Persons	Address(es)		
		1				1223 WASHINGTON AVENUE NORTH		
Location Use Code	Variance Code	Use Zone Code	Fire Zone Code	Inside Outside Code	District Code	General Location Code	Inspection Area Code	Jurisdiction Code
RETAIL & PERSONAL SERVICE		NOT APPLICABLE	R-3				DISTRICT 5	NORTH DEERING

Structure Details

Structure: Retail Establishment "China Taste" - Tenant fit-up

Occupancy Type Code:

Structure Type Code	Structure Status Type	Square Footage	Estimated Value	Address			
Stores & Customer Services (Mercantile)	0			1223 WASHINGTON AVENUE NORTH			
				<i>Retail Establishment</i>			
Longitude	Latitude	GIS X	GIS Y	GIS Z	GIS Reference	User Defined Property	Value
						Alarms Commercial	0
						Alarms Commercial	1
						Fire Repairs	0
						Fixtures-Fluorescent	0

