

City of Portland, Maine - Building or Use Permit Application

389 Congress Street, 04101 Tel: (207) 874-8703, Fax: (207) 874-8716

Permit No: 06-1167	Issue Date: PERMIT ISSUED AUG 15 2006	CBL: 07 D001001
-----------------------	--	--------------------

Location of Construction: 181 RAY ST	Owner Name: SQUIRE CABOT R	Owner Address: 181 RAY ST	Phone: 207 799 5585
Business Name:	Contractor Name: Down East Energy	Contractor Address: 172 Main Street South Portland	Phone: 207 799 5585
Lessee/Buyer's Name	Phone:	Permit Type: Tanks - Dwellings	Zone:

Past Use: Single Family	Proposed Use: Single Family install a 57 gal tank	Permit Fee:	Cost of Work: \$0.00	CEO District: 4
----------------------------	--	-------------	-------------------------	--------------------

Proposed Project Description: Install a 57 gal tank	FIRE DEPT: <input type="checkbox"/> Approved <input type="checkbox"/> Denied	INSPECTION: Use Group: <i>Tanks</i> Type: <i>1</i> Signature: <i>[Signature]</i> Date: <i>8/14/06</i>
Signature: _____ PEDESTRIAN ACTIVITIES DISTRICT (P.A.D.) Action: <input type="checkbox"/> Approved <input type="checkbox"/> Approved w/Conditions <input type="checkbox"/> Denied Signature: _____ Date: _____		

Permit Taken By: dmartin	Date Applied For: 08/04/2006	Zoning Approval
-----------------------------	---------------------------------	------------------------

1. 2. Building permits do not include plumbing, septic or electrical work. 3. Building permits are void if work is not started within six (6) months of the date of issuance. False information may invalidate a building permit and stop all work..	Special Zone or Reviews <input type="checkbox"/> Shoreland <input type="checkbox"/> Wetland <input type="checkbox"/> Flood Zone <input type="checkbox"/> Subdivision <input type="checkbox"/> Site Plan Maj <input type="checkbox"/> Minor <input type="checkbox"/> MM <input type="checkbox"/> Date: _____	Zoning Appeal <input type="checkbox"/> Variance <input type="checkbox"/> Miscellaneous <input type="checkbox"/> Conditional Use <input type="checkbox"/> Interpretation <input type="checkbox"/> Approved <input type="checkbox"/> Denied Date: _____	Historic Preservation <input type="checkbox"/> Not in District or Landmark <input type="checkbox"/> Does Not Require Review <input type="checkbox"/> Requires Review <input type="checkbox"/> Approved <input type="checkbox"/> Approved w/Conditions <input type="checkbox"/> Denied Date: _____
--	---	---	---

CERTIFICATION

I hereby certify that I am the owner of record of the named property, or that the proposed work is authorized by the owner of record and that I have been authorized by the owner to make this application as his authorized agent and I agree to conform to all applicable laws of this jurisdiction. In addition, if a permit for work described in the application is issued, I certify that the code official's authorized representative shall have the authority to enter all areas covered by such permit at any reasonable hour to enforce the provision of the code(s) applicable to such permit.

SIGNATURE OF APPLICANT	ADDRESS	DATE	PHONE
RESPONSIBLE PERSON IN CHARGE OF WORK, TITLE		DATE	PHONE



FILL IN AND SIGN WITH INK

407 D 001
CITY OF PORTLAND

APPLICATION FOR PERMIT HEATING OR POWER EQUIPMENT

To the INSPECTOR OF BUILDINGS, PORTLAND, ME.

The undersigned hereby applies for a permit to install the following heating, cooking or power equipment in accordance with the Laws of Maine, the Building Code of the City of Portland, and the following specifications:

Location / CBL 181 Ray St Portland Use of Building Private Date _____

Name and address of owner of appliance Cabot Square 181 Ray St Portland

Installer's name and address Dawn East Energy 122 Main St South Portland Telephone 799-5585

Location of appliance:

- Basement
- Attic
- Floor
- Roof

Type of Fuel:

- Gas
- Oil
- Solid

Appliance Name:

U.L. Approved Yes No

Will appliance be installed in accordance with the manufacture's installation instructions? Yes No

IF **NO** Explain: _____

The Type of License of Installer:

- ~~Master~~ Plumber # _____
- Solid Fuel # _____
- Oil # _____
- Gas # PVT 1445
- Other _____

Type of Chimney:

- Masonry Lined
Factory built _____
- Metal
Factory Built U.L. Listing # _____
- Direct Vent
Type _____ UL# _____

Type of Fuel Tank

- Oil
- Gas

Size of Tank 57

Number of Tanks 1

Distance from Tank to Center of Flame _____ feet.

Cost of Work: \$ _____

Permit Fee: \$ 30.00

Approved

Approved with Conditions

Fire: _____
Ele.: _____
Bldg.: _____

See attached letter or requirement

Inspector's Signature

Date Approved

Signature of Installer [Signature]

City of Portland, Maine - Building or Use Permit

389 Congress Street, 04101 Tel: (207) 874-8703, Fax: (207) 874-8716

Permit No: 06-1167	Date Applied For: 08/04/2006	CBL: 407 D001001
------------------------------	--	----------------------------

Location of Construction: 181 RAY ST	Owner Name: SQUIRE CABOT R	Owner Address: 181 RAY ST	Phone:
Business Name:	Contractor Name: Down East Energy	Contractor Address: 172 Main Street South Portland	Phone (207) 799-5585
Lessee/Buyer's Name	Phone:	Permit Type: Tanks - Dwellings	

Proposed Use: Single Family install a 57 gal tank	Proposed Project Description: Install a 57 gal tank
---	---

Dept: Building **Status:** Approved with Conditions **Reviewer:** Mike Nugent **Approval Date:** 08/14/2006
Note: **Ok to Issue:**
1) Must comply with NFPA regs.

Ray Street
111'

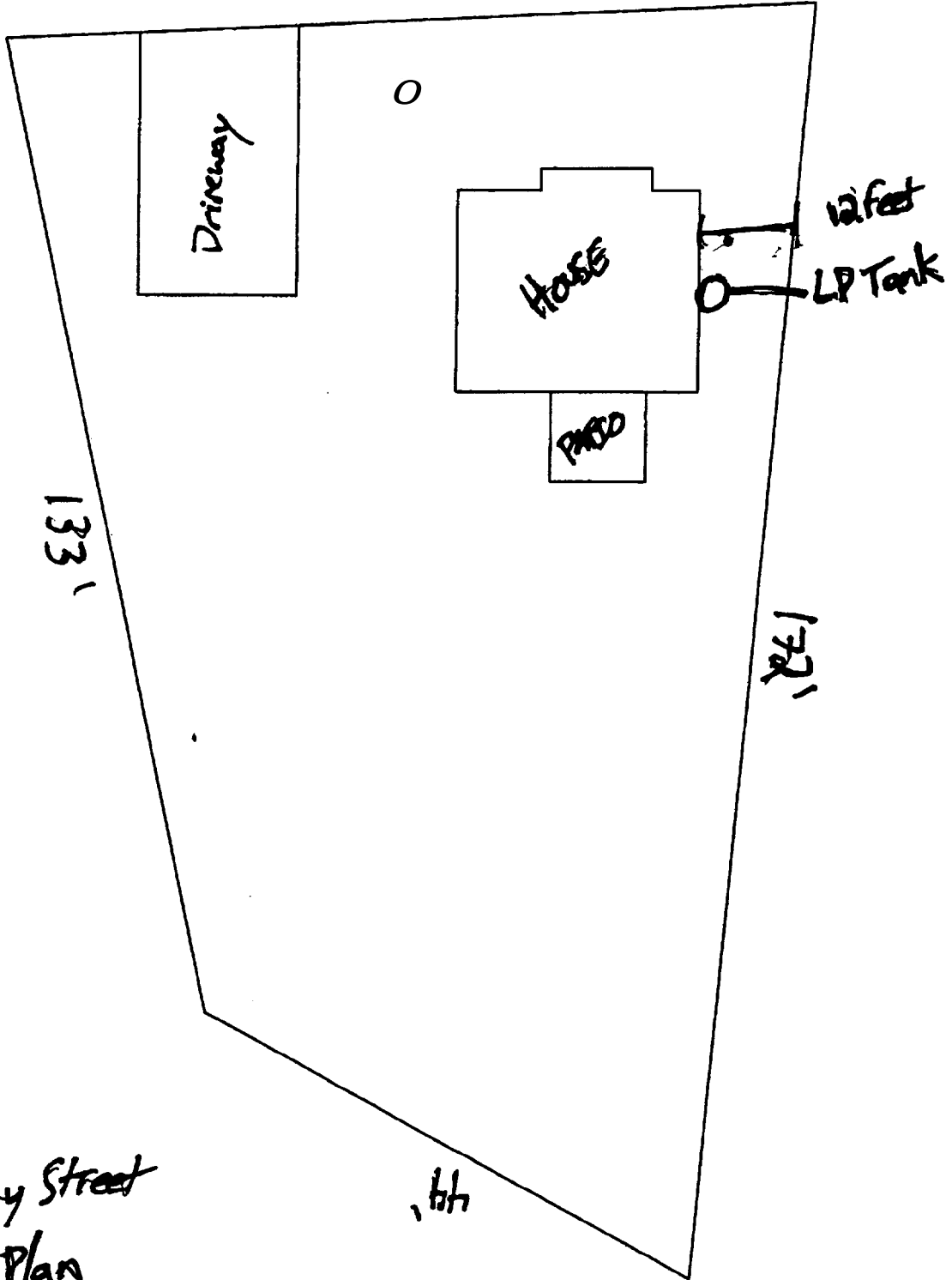

181 Ray Street
Plot Plan

Steve, Here is 181 Ray Plot Plan
w/ LP Tank Location
-Cabot Squire