

DISPLAY THIS CARD ON PRINCIPAL FRONTAGE OF WORK CITY OF PORTLAND

Please Read Application And Notes, If Any, Attached

BUILDING PERMIT PERMIT ISSUED

Permit Number: 100891

JUL 30 2010

This is to certify that NGUYEN TUANH
has permission to Amend permit#100724 to moved to different location
AT 19 STEPPING STONE LN CB# 406 F054001 City of Portland

provided that the person or persons, firm or corporation accepting this permit shall comply with all of the provisions of the Statutes of Maine and of the Ordinances of the City of Portland regulating the construction, maintenance and use of buildings and structures, and of the application on file in this department.

Apply to Public Works for street line and grade if nature of work requires such information.

Notification of inspection must be given and written permission procured before this building or part thereof is lathed or otherwise red-in. 24 HOUR NOTICE IS REQUIRED.

A certificate of occupancy must be procured by owner before this building or part thereof is occupied.

OTHER REQUIRED APPROVALS

Fire Dept. _____
Health Dept. _____
Appeal Board _____
Other _____
Department Name

Director, Building & Inspection Services

PENALTY FOR REMOVING THIS CARD

City of Portland, Maine - Building or Use Permit Application

389 Congress Street, 04101 Tel: (207) 874-8703, Fax: (207) 874-8716

Permit No: 10-0891	Issue Date:	CBL: 406 F054001
-----------------------	-------------	---------------------

Location of Construction: 19 STEPPING STONE LN	Owner Name: NGUYEN TUANH	Owner Address: 19 STEPPING STONE LN	Phone:
Business Name:	Contractor Name:	Contractor Address:	Phone:
Lessee/Buyer's Name	Phone:	Permit Type: Amendment to Single Family	Zone: R-3

Past Use: Single Family Home	Proposed Use: Single Family Home - Amend permit#100724 to move shed to different location - 10'x14'	Permit Fee: \$30.00	Cost of Work: \$489.00	CEO District: 4
Proposed Project Description: Amend permit#100724 to move shed to different location 10'x14'		FIRE DEPT: <input type="checkbox"/> Approved <input type="checkbox"/> Denied Signature: <i>[Signature]</i>		INSPECTION: Use Group: <i>R-3/U</i> Type: <i>513</i> <i>TRC 2003</i> Signature: <i>[Signature]</i>
		PEDESTRIAN ACTIVITIES DISTRICT (P.A.D.) Action: <input type="checkbox"/> Approved <input type="checkbox"/> Approved w/Conditions <input type="checkbox"/> Denied Signature: _____ Date: _____		

Permit Taken By: ldobson	Date Applied For: 07/26/2010	Zoning Approval	
-----------------------------	---------------------------------	------------------------	--

1. This permit application does not preclude the Applicant(s) from meeting applicable State and Federal Rules. 2. Building permits do not include plumbing, septic or electrical work. 3. Building permits are void if work is not started within six (6) months of the date of issuance. False information may invalidate a building permit and stop all work..	Special Zone or Reviews <input type="checkbox"/> Shoreland <input type="checkbox"/> Wetland <i>Shed must be 5' from side! rear property lines</i> <input type="checkbox"/> Flood Zone <input type="checkbox"/> Subdivision <input type="checkbox"/> Site Plan Maj <input type="checkbox"/> Minor <input type="checkbox"/> MM <input type="checkbox"/> Date: <i>7/30/10 AFM</i>	Zoning Appeal <input type="checkbox"/> Variance <input type="checkbox"/> Miscellaneous <input type="checkbox"/> Conditional Use <input type="checkbox"/> Interpretation <input type="checkbox"/> Approved <input type="checkbox"/> Denied Date: _____	Historic Preservation <input checked="" type="checkbox"/> Not in District or Landmark <input type="checkbox"/> Does Not Require Review <input type="checkbox"/> Requires Review <input type="checkbox"/> Approved <input type="checkbox"/> Approved w/Conditions <input type="checkbox"/> Denied Date: <i>[Signature]</i>
--	---	--	--

PERMIT ISSUED

JUL 30 2010

City of Portland

CERTIFICATION

I hereby certify that I am the owner of record of the named property, or that the proposed work is authorized by the owner of record and that I have been authorized by the owner to make this application as his authorized agent and I agree to conform to all applicable laws of this jurisdiction. In addition, if a permit for work described in the application is issued, I certify that the code official's authorized representative shall have the authority to enter all areas covered by such permit at any reasonable hour to enforce the provision of the code(s) applicable to such permit.

SIGNATURE OF APPLICANT	ADDRESS	DATE	PHONE
------------------------	---------	------	-------

RESPONSIBLE PERSON IN CHARGE OF WORK, TITLE	DATE	PHONE
---	------	-------



CITY OF PORTLAND, MAINE

Department of Building Inspections

Original Receipt

7-26-2010

Received from Le

Location of Work 19 Stepping

Cost of Construction \$ _____ Building Fee: _____

Permit Fee \$ _____ Site Fee: _____

Certificate of Occupancy Fee: _____

Total: 30

Building (B) _____ Plumbing (P) _____ Electrical (E) _____ Site Plan (U) _____

Other _____

CBL: 406-F54

Check #: cash Total Collected \$ 30

**No work is to be started until permit issued.
Please keep original receipt for your records.**

Taken by: P. J.

WHITE - Applicant's Copy
YELLOW - Office Copy
PINK - Permit Copy

City of Portland, Maine - Building or Use Permit

389 Congress Street, 04101 Tel: (207) 874-8703, Fax: (207) 874-8716

Permit No: 10-0891	Date Applied For: 07/26/2010	CBL: 406 F054001
------------------------------	--	----------------------------

Location of Construction: 19 STEPPING STONE LN	Owner Name: NGUYEN TUANH	Owner Address: 19 STEPPING STONE LN	Phone:
Business Name:	Contractor Name:	Contractor Address:	Phone:
Lessee/Buyer's Name	Phone:	Permit Type: Amendment to Single Family	

Proposed Use: Single Family Home - Amend permit#100724 to move shed (10' x 14') to different location	Proposed Project Description: Amend permit#100724 to move shed (10' x 14') to different location
---	--

Dept: Zoning **Status:** Approved with Conditions **Reviewer:** Ann Machado **Approval Date:** 07/30/2010

Note: **Ok to Issue:** ✓

- 1) The shed must be located a minimum of 5' from the rear property line and 5' from the side property line.
- 2) This property shall remain a single family dwelling. Any change of use shall require a separate permit application for review and approval.
- 3) This permit is being approved on the basis of plans submitted. Any deviations shall require a separate approval before starting that work.

Dept: Building **Status:** Approved **Reviewer:** **Approval Date:**
Note: **Ok to Issue:**

PERMIT ISSUED

JUL 30 2010

City of Portland

BUILDING PERMIT INSPECTION PROCEDURES

**Please call 874-8703 or 874-8693 (ONLY)
or email: buildinginspections@portlandmaine.gov**

With the issuance of this permit, the owner, builder or their designee is required to provide adequate notice to the City of Portland Inspection Services for the following inspections. Appointments must be requested 48 to 72 hours in advance of the required inspection. The inspection date will need to be confirmed by this office.

- **Please read the conditions of approval that is attached to this permit!! Contact this office if you have any questions.**
- **Permits expire in 6 months, if the project is not started or ceases for 6 months.**
- **If the inspection requirements are not followed as stated below additional fees may be incurred due to the issuance of a "Stop Work Order" and subsequent release to continue with construction.**

 X **Building Location Inspection: Prior to pouring concrete or setting precast piers**

 X **Final inspection required at completion of work.**

The project cannot move to the next phase prior to the required inspection and approval to continue, REGARDLESS OF THE NOTICE OR CIRCUMSTANCES.

IF THE PERMIT REQUIRES A CERTIFICATE OF OCCUPANCY, IT MUST BE PAID FOR AND ISSUED TO THE OWNER OR DESIGNEE BEFORE THE SPACE MAY BE OCCUPIED.

PERMIT ISSUED

JUL 30 2010



General Building Permit Application

If you or the property owner owes real estate or personal property taxes or user charges on any property within the City, payment arrangements must be made before permits of any kind are accepted.

Location/Address of Construction: <u>19 Stepping Stone Lane Portland ME 04103</u>		
Total Square Footage of Proposed Structure/Area	Square Footage of Lot <u>.174 AC 7581²'</u>	Number of Stories <u>2</u>
Tax Assessor's Chart, Block & Lot Chart# Block# Lot# <u>406 F 54</u>	Applicant * <u>must</u> be owner, Lessee or Buyer* Name <u>Phy P LE</u> Address <u>19 Stepping Stone Lane</u> City, State & Zip <u>Portland ME 04103</u>	Telephone:
Lessee/DBA (If Applicable)	Owner (if different from Applicant) Name Address <u>Macl</u> City, State & Zip	Cost Of Work: \$ <u>489⁰⁰</u> C of O Fee: \$ _____ Total Fee: \$ _____
Current legal use (i.e. single family) <u>Single Family</u> Number of Residential Units _____ If vacant, what was the previous use? _____ Proposed Specific use: <u>10x14 Shed</u> Is property part of a subdivision? <u>NO</u> If yes, please name _____ Project description: <u>Amed, permit #100724 Move Shed Different Location</u>		
Contractor's name: <u>Lowe's Metal Shed</u>		
Address: _____		
City, State & Zip _____		Telephone: <u>409-3055</u>
Who should we contact when the permit is ready: _____		Telephone: _____
Mailing address: <u>409-3055</u>		

Please submit all of the information outlined on the applicable Checklist. Failure to do so will result in the automatic denial of your permit.

In order to be sure the City fully understands the full scope of the project, the Planning and Development Department may request additional information prior to the issuance of a permit. For further information or to download copies of this form and other applications visit the Inspections Division on-line at www.portlandmaine.gov, or stop by the Inspections Division office, room 315 City Hall or call 874-8703.

I hereby certify that I am the Owner of record of the named property, or that the owner of record authorizes the proposed work and that I have been authorized by the owner to make this application as his/her authorized agent. I agree to conform to all applicable laws of this jurisdiction. In addition, if a permit for work described in this application is issued, I certify that the Code Official's authorized representative shall have the authority to enter all areas covered by this permit at any reasonable hour to enforce the provisions of the codes applicable to this permit.

Signature: [Signature]

Date: 7/25/10

This is not a permit; you may not commence ANY work until the permit is issued

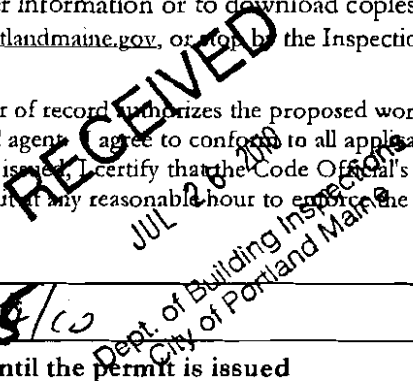

LX1014-C 1

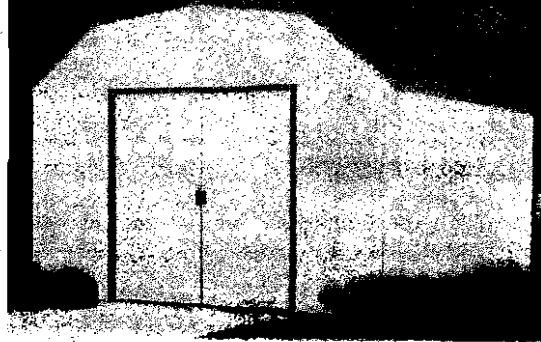

S P E C I F I C A T I O N S

Building Size:	10'W 3,0M	14'D 4,0M	
Interior Size:	118 $\frac{1}{4}$ "W 300cm	157 $\frac{1}{2}$ "D 400cm	86 $\frac{5}{8}$ "H 220cm
Door Opening:	55 $\frac{1}{2}$ "W 141cm	60"H 152cm	
Foundation Size:	121"W 307cm	160 $\frac{1}{4}$ "D 407cm	

B U I L D I N G C O L O R S

Walls, Doors & Gables: Eggshell Roof, Jambs & Trim: Taupe



69620-075

0 26862 10024 5

C1

STEPPING STONE LANE

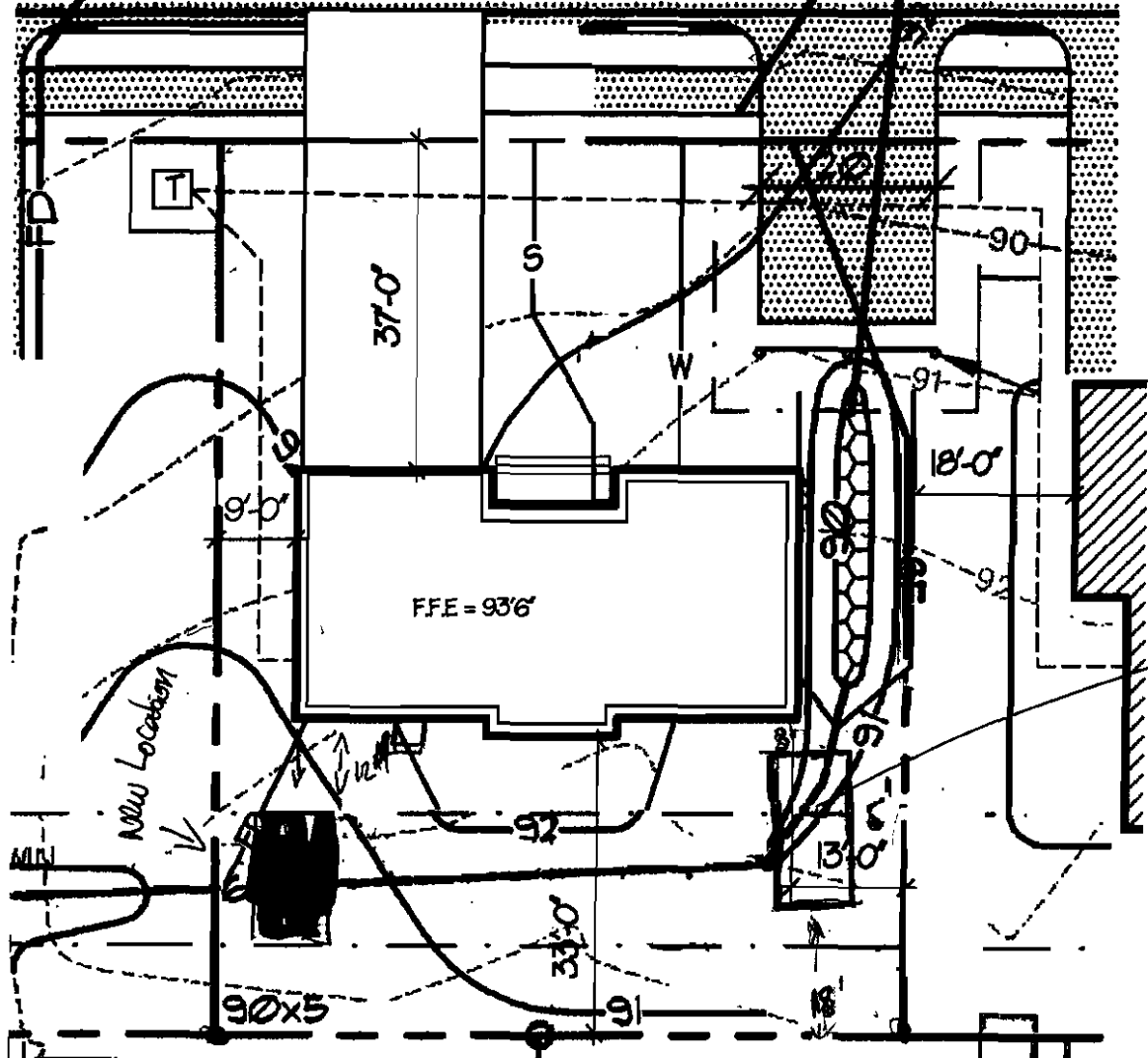

* must be 5' from
side line
property line.

10' x 14'
shed

406 FS4

City of Portland Maine
Dept. of Building Inspections

RECEIVED
THOMPSON
85227238
N/F
JUN 23 2010



N/F
DAYLE & VICKI
SMITH
4494/30

Windemere
Homes

WILTSHIRE MANOR

LOT 4 STEPPING STONE LANE
AUTUMN GLEN SUBDIVISION
PORTLAND, ME

SITE PLAN

DATE
8/13/04
SCALE
1" = 20'

A-2