

see sheet 8 for 3-d view

### horizontal cross section X-X

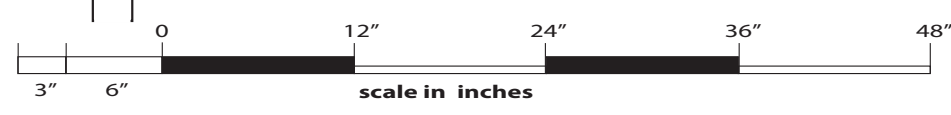
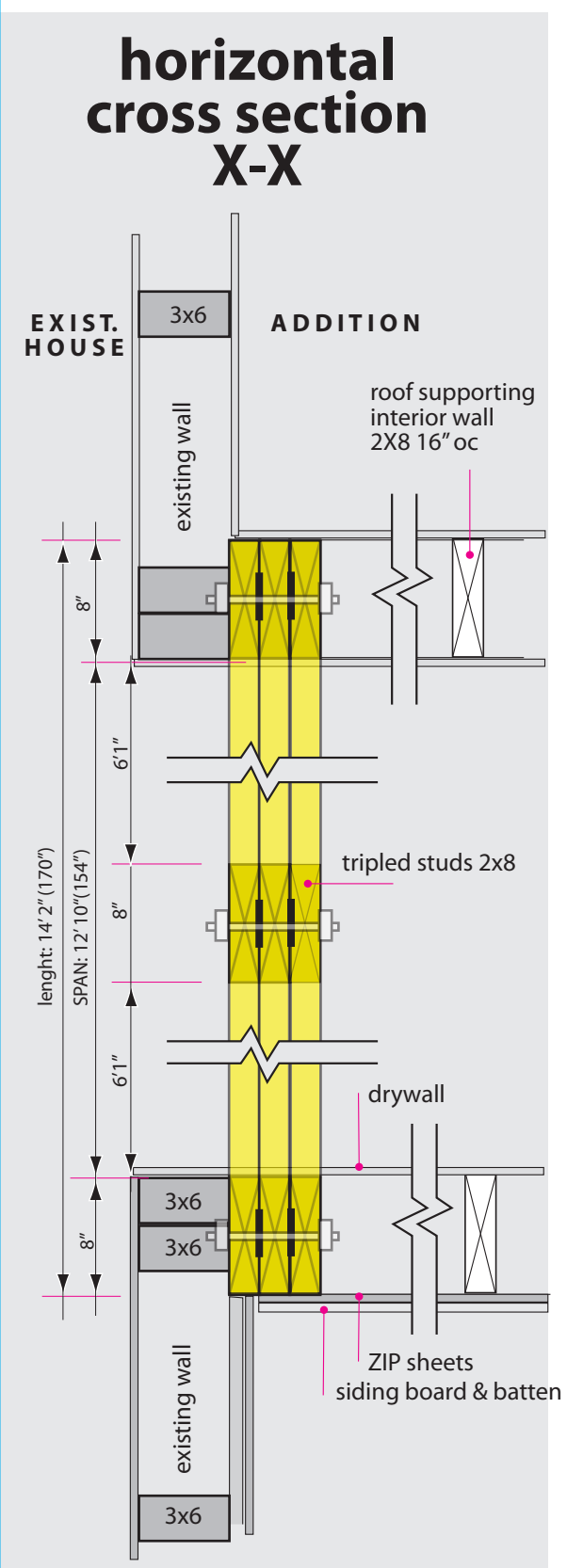

## DETAILS addition - garage

DEED BOOK: 3191, PAGE 488  
 PLAN BOOK: 17, PAGE 6  
 COUNTY: CUMBERLAND  
 LOT: 1103 & 1104 + part of 1106 & 1107  
 DIVISION 4 R-3 RESIDENTIAL ZONE

January 2015  
 131 Virginiastreet, Portland, Maine  
 PROPERTY OF: STONE-RUKS

SCALE: 1" = 10"

**SHEET 9**