

INSTALL 4" PVC POSTIVE  
DOWN RUN-OFF IF SITE ALLOWS

NOTE: 44" HIGH  
FOUNDATION WALL TO BE  
MINIMUM, & EXTENDED IF REQUIRED SO  
THAT CONC. FOOTINGS BEAR DIRECTLY  
ON STRUCTURAL SOUND SOIL AND ARE  
LOCATED BELOW FROST LINE.

NOTE:

STEEL BEAM IRON  
BE INSTALLED IN  
PLANE OF 3"x12"  
GIRDER. SIZE OF  
BEAM TO BE  
DETERMINED BY  
STRUCTURAL ENGINEER.  
BEAM TO BE DESIGNED  
TO CARRY 1<sup>ST</sup> FLOOR  
AND POINT LOAD  
FROM SECOND FLOOR.

exact  
location  
to be determined

NOTE: 7'-9" HIGH  
FOUNDATION WALL TO BE  
MINIMUM, & EXTENDED IF REQUIRED SO  
THAT CONC. FOOTINGS BEAR DIRECTLY  
ON STRUCTURAL SOUND SOIL AND ARE  
LOCATED BELOW FROST LINE.

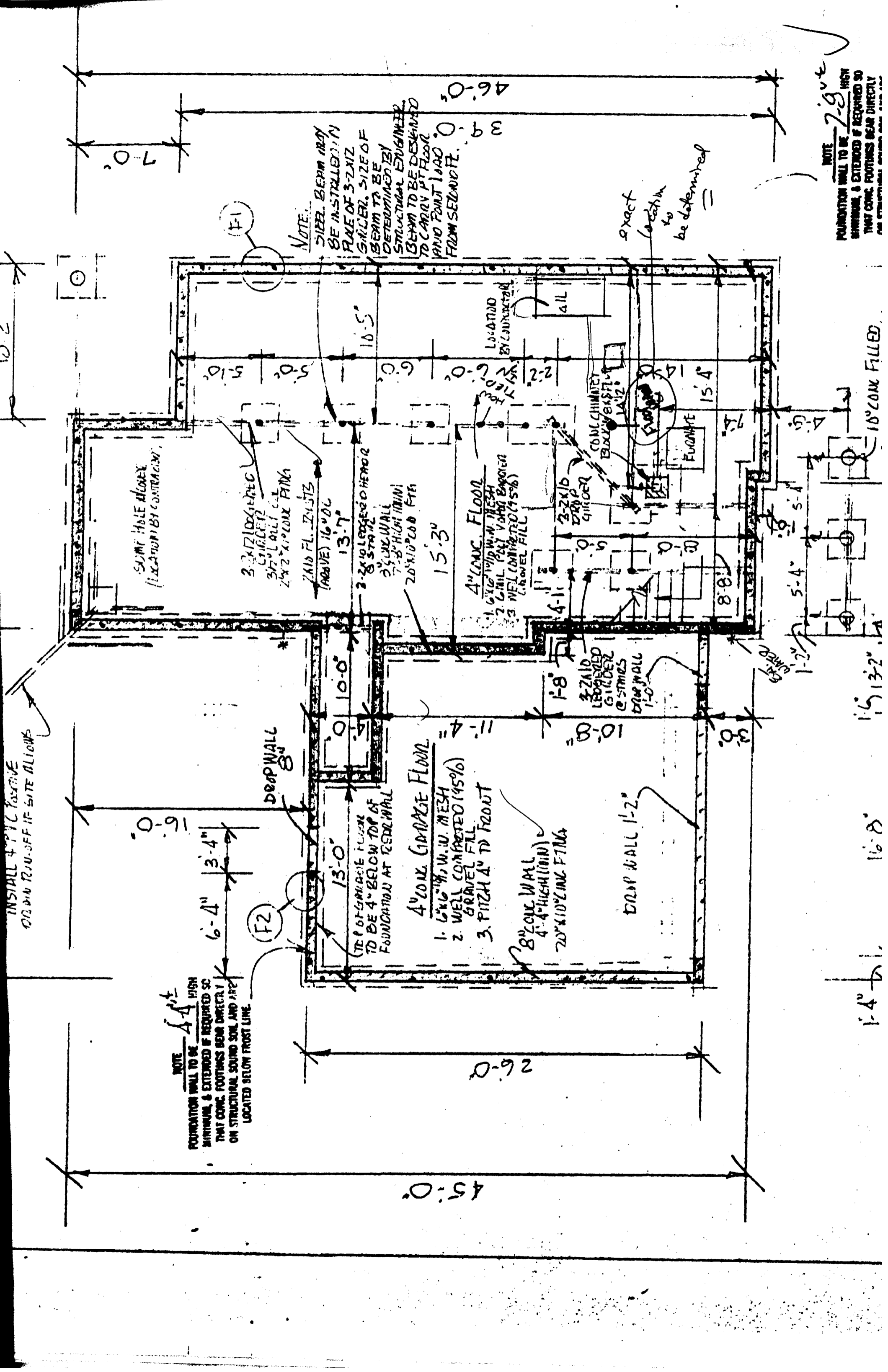

SUMP HOLE ALONG  
LOCATION BY CONTRACTOR

3"x12" LOGGED  
GIRDER  
3"x12" ALL CL  
2"x2" X 10' LONG FTNG

2"x10" FL. JOISTS  
(ABOVE) 16" O.C.

3"x12" LOGGED HEAR  
3"x12" STAIR  
8" CONC. WALL  
4" HIGH (MIN)  
20"x10" CONC FTNG

4" CONC. FLOOR  
1. 6"x16" W.W. W. MESH  
2. 2" MIN. CONC. (45%)  
3. WELL COMPACTED (15%)  
GRAVEL FILL

3"x12" LOGGED  
LEADED  
GIRDER  
@ STAIRS  
DRAIN WALL  
1'-0"

4" CONC. GARAGE FLOOR  
1. 6"x16" W.W. W. MESH  
2. WELL COMPACTED (45%)  
GRAVEL FILL  
3. PITCH 4" TO FRONT

8" CONC. WALL  
4" HIGH (MIN)  
20"x10" CONC FTNG

DRAIN WALL 1'-2"

18" CONC FILLED

7'-0"

46'-0"

45'-0"

26'-0"

10'-9"

6'-4" 3'-4"

13'-0"

10'-0"

15'-3"

6'-0"

5'-0"

5'-10"

4'-11"

1'-8"

8'-0"

11'-4"

15'-4"

8'-8"

5'-4"

1'-2"

1'-2"

16'-8"

13'-2"