

**City of Portland, Maine - Building or Use Permit Application**  
 389 Congress Street, 04101 Tel: (207) 874-8703, Fax: (207) 874-8716

**PERMIT ISSUED**  
 Permit No: 02-0916 Issue Date: AUG 15 2002  
**CITY OF PORTLAND**

GBL: 403 D018001

<b>Location of Construction:</b> 43 Jersey Ave	<b>Owner Name:</b> Vassar Herbert &	<b>Owner Address:</b> 8 Wellington St CITY OF PORTLAND	<b>Phone:</b> 297-4190
<b>Business Name:</b>	<b>Contractor Name:</b> Sheds, U.S.A.	<b>Contractor Address:</b> P.O.Box 6622 Porthsmouth	<b>Phone:</b> 6038681300
<b>Lessee/Buyer's Name</b>	<b>Phone:</b>	<b>Permit Type:</b> Additions - Dwellings	<b>Zone:</b>

<b>Past Use:</b> Single Family	<b>Proposed Use:</b> Single Family	<b>Permit Fee:</b> \$37.00	<b>Cost of Work:</b> \$1,967.00	<b>CEO District:</b> 2
-----------------------------------	---------------------------------------	-------------------------------	------------------------------------	---------------------------

<b>FIRE DEPT:</b> <input type="checkbox"/> Approved <input checked="" type="checkbox"/> Denied N/A	<b>INSPECTION:</b> Use Group: U 5B Type: Shed BOCA 99 Signature: [Signature]
---	--

**Proposed Project Description:**  
Construct an 8' x 12' Wood Shed

**PEDESTRIAN ACTIVITIES DISTRICT (P.A.D.)**  
 Action:  Approved  Approved w/Conditions  Denied  
 Signature: \_\_\_\_\_ Date: \_\_\_\_\_

<b>Permit Taken By:</b> gad	<b>Date Applied For:</b> 08/13/2002	<b>Zoning Approval</b>
--------------------------------	--	------------------------

1. This permit application does not preclude the Applicant(s) from meeting applicable State and Federal Rules. 2. Building permits do not include plumbing, septic or electrical work. 3. Building permits are void if work is not started within six (6) months of the date of issuance. False information may invalidate a building permit and stop all work..	<b>Special Zone or Reviews</b> <input type="checkbox"/> Shoreland <input type="checkbox"/> Wetland <input type="checkbox"/> Flood Zone <input type="checkbox"/> Subdivision <input type="checkbox"/> Site Plan Maj <input type="checkbox"/> Minor <input type="checkbox"/> MM <input type="checkbox"/> Date: 8/14/02	<b>Zoning Appeal</b> <input type="checkbox"/> Variance <input type="checkbox"/> Miscellaneous <input type="checkbox"/> Conditional Use <input type="checkbox"/> Interpretation <input type="checkbox"/> Approved <input type="checkbox"/> Denied Date:	<b>Historic Preservation</b> <input checked="" type="checkbox"/> Not in District or Landmark <input type="checkbox"/> Does Not Require Review <input type="checkbox"/> Requires Review <input type="checkbox"/> Approved <input type="checkbox"/> Approved w/Conditions <input type="checkbox"/> Denied Date: 8/14/02
--	---	---	--

**CERTIFICATION**

I hereby certify that I am the owner of record of the named property, or that the proposed work is authorized by the owner of record and that I have been authorized by the owner to make this application as his authorized agent and I agree to conform to all applicable laws of this jurisdiction. In addition, if a permit for work described in the application is issued, I certify that the code official's authorized representative shall have the authority to enter all areas covered by such permit at any reasonable hour to enforce the provision of the code(s) applicable to such permit.

SIGNATURE OF APPLICANT	ADDRESS	DATE	PHONE
RESPONSIBLE PERSON IN CHARGE OF WORK, TITLE		DATE	PHONE

2-0916

Zoning

Approved with Conditions

Tammy Munson



08/14/2002

08/14/2002



Tammy Munson

08/14/2002



08/14/2002

gad

08/14/2002

tmm

02-0916

# All Purpose Building Permit Application

If you or the property owner owes real estate or personal property taxes or user charges on any property within the City, payment arrangements must be made before permits of any kind are accepted.

Location/Address of Construction: <u>43 Jersey Avenue</u>		
Total Square Footage of Proposed Structure <u>8' x 12' = 96 SF</u>	Square Footage of Lot <u>6000 SF</u>	
Tax Assessor's Chart, Block & Lot Chart# <u>403</u> Block# <u>D</u> Lot# <u>018-001</u>	Owner: <u>Herbert + Jeannette Vassar</u>	Telephone: <u>978-562-7088</u>
Lessee/Buyer's Name (if applicable) <u>Dianne + Valerie Vassar</u>	Applicant name, address & telephone: <u>Dianne + Valerie Vassar</u> <u>43 Jersey Ave, Portland, ME</u> <u>797-4190-home, 791-1143-work</u>	Cost Of Work: \$ <u>1,967<sup>00</sup></u> Fee: \$ <u>37.00</u>
Current use: <u>residential lot</u>		
If the location is currently vacant, what was prior use: _____		
Approximately how long has it been vacant: _____		
Proposed use: <u>Shed</u>		
Project description: <u>8 x 12 shed</u>		
Contractor's name, address & telephone: <u>Sheds USA, 603-868-1300</u>		
Who should we contact when the permit is ready: <u>Dianne Vassar x x</u>		
Mailing address: <u>43 Jersey Avenue</u> work phone: <u>791-1143</u> , Home phone <u>797-4190 x x call</u>		
We will contact you by phone when the permit is ready. You must come in and pick up the permit and review the requirements before starting any work, with a Plan Reviewer. A stop work order will be issued and a \$100.00 fee if any work starts before the permit is picked up. PHONE: Home - <u>797-4190</u> work phone - <u>791-1143</u>		

**IF THE REQUIRED INFORMATION IS NOT INCLUDED IN THE SUBMISSIONS THE PERMIT WILL BE AUTOMATICALLY DENIED AT THE DISCRETION OF THE BUILDING/PLANNING DEPARTMENT, WE MAY REQUIRE ADDITIONAL INFORMATION IN ORDER TO APPROVE THIS PERMIT.**

I hereby certify that I am the Owner of record of the named property, or that the owner of record authorizes the proposed work and that I have been authorized by the owner to make this application as his/her authorized agent. I agree to conform to all applicable laws of this jurisdiction. In addition, if a permit for work described in this application is issued, I certify that the Code Official's authorized representative shall have the authority to enter all areas covered by this permit at any reasonable hour to enforce the provisions of the codes applicable to this permit.

Signature of applicant: <u>Dianne Vassar</u>	Date: <u>8/2/02</u>
--	---------------------

This is NOT a permit, you may not commence ANY work until the permit is issued. If you are in a Historic District you may be subject to additional permitting and fees with the Planning Department on the 4th floor of City Hall.

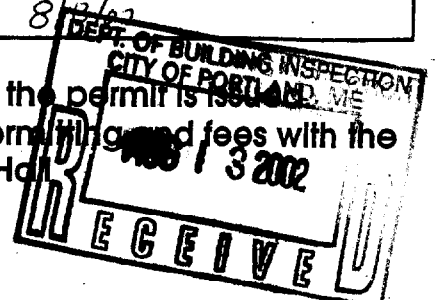

# DISPLAY THIS CARD ON PRINCIPAL FRONTAGE OF WORK CITY OF PORTLAND

BUILDING INSPECTION

## PERMIT

Permit Number: 020916

Please Read Application And Notes, If Any, Attached

This is to certify that Vassar Herbert &/Sheds, U.S.  
has permission to Construct an 8' x 12' Wood S  
AT 43 Jersey Ave 403 D018001

provided that the person or persons, firm or corporation accepting this permit shall comply with all of the provisions of the Statutes of Maine and of the ordinances of the City of Portland regulating the construction, maintenance and use of buildings and structures, and of the application on file in this department.

Apply to Public Works for street line and grade if nature of work requires such information.

Notification of inspection must be given and written permission procured before this building or part thereof is laid or closed-in. HEAVY NOTICE IS REQUIRED.

A certificate of occupancy must be procured by owner before this building or part thereof is occupied.

### OTHER REQUIRED APPROVALS

Fire Dept. \_\_\_\_\_  
Health Dept. \_\_\_\_\_  
Appeal Board \_\_\_\_\_  
Other \_\_\_\_\_  
Department Name

  
Director - Building & Inspection Services

**PENALTY FOR REMOVING THIS CARD**

Prmt	Text93	41546	Constr Type	New	Num1	20916
Permit Nbr	02-0916	Location of Construction	43	Jersey Ave	Appl. Date	08/13/2002
Status	Pending	Permit Type	Additions - Dwellings		Issue Date	
CP2	403 D018001	Territory Nbr	2	Estimated Cost	\$1,967.00	Date Closed

Comment Date	Comment	Name	Follow Up Date	Completed
08/14/2002	left message for owner - cited shown 3' from rear line - must be 9' - gave them file into data - asked them to call if they had questions.	imm		<input type="checkbox"/>

CreatedBy	gad	CreateDate	08/14/2002	ModBy	gad	ModDate	08/14/2002
-----------	-----	------------	------------	-------	-----	---------	------------

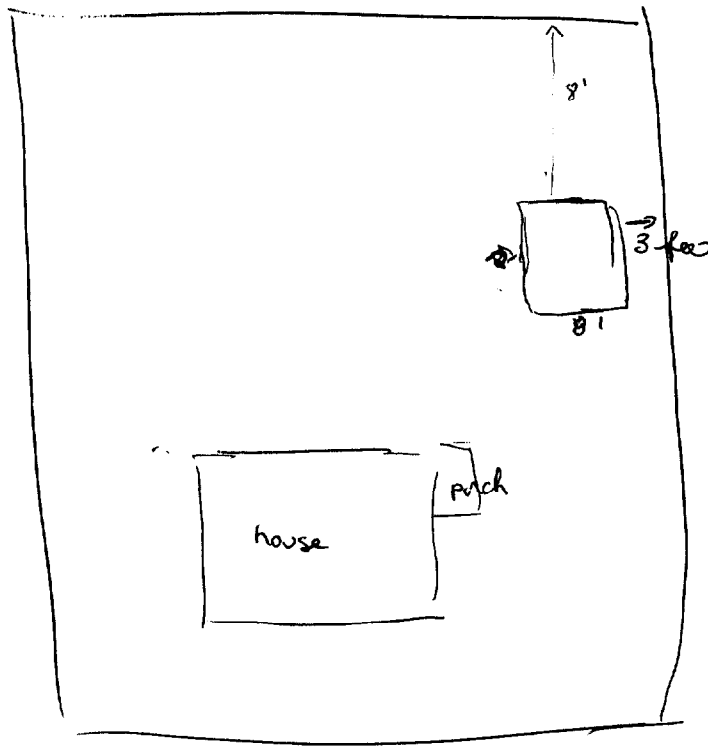

Must be  
5' from  
Lines.

---



# THE BOSTONIAN STYLE

8 x 12 pre-shed Shown, with shingles, pine roof and black siding.

®

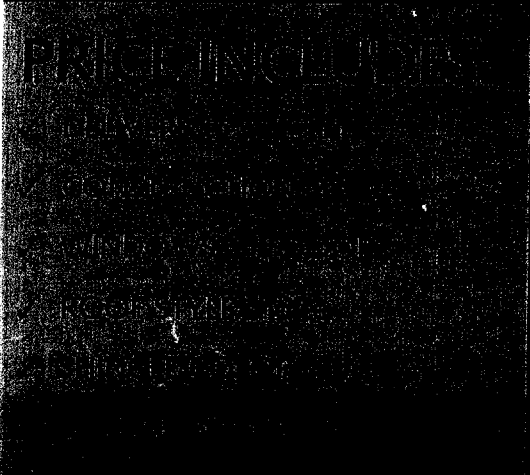

Vinyl Colors



Available in your choice of siding:

VINYL*	CEDAR	PINE	SMART PANEL II
--------	-------	------	----------------

ROOF STYLES	SHINGLE COLORS	SIZES
		8x14
		10x12
		10x16
		12x14
		12x20

	\$2,085.00	\$1,765.00
	\$2,275.00	\$1,919.00
	\$2,925.00	\$2,435.00
	\$3,029.00	\$2,429.00
	\$4,249.00	\$3,439.00

## DELIVERED

## BUILT ON SITE,



# Options & Upgrades for All Sheds

Note: Options and upgrades are an additional cost to the standard pricing.

2" x 6" floor joists for 6' or 8' wide sheds <i>(2"x6" floor joists are standard on all 10' x12' wide sheds)</i>	\$ .92 sq ft	\$ .92 sq ft
Pressure treated plywood floor	\$1.20 sq ft	\$1.20 sq ft
4' storage loft for 8' wide sheds	\$65.00	\$65.00
4' storage loft for 10' wide sheds	\$80.00	\$80.00
4' storage loft for 12' wide sheds <i>(loft storage space will vary with roof style, and 4' storage loft for 6' wide sheds is not available)</i>	\$95.00	\$95.00
8' shelf <i>(All sheds except cedar models)</i>	\$45.00	\$45.00
Enlarge Standard 40" Door to 54" Door	\$44.00	\$79.00
Enlarge Standard 40" Door to 66" Door	\$84.00	\$99.00
Enlarge Standard 40" Door to 78" Door	\$114.00	\$129.00
4' pressure-treated ramp	\$44.00	\$44.00
Vinyl shed window upgrade <i>(functional)</i>	n/a	\$49.00 each
Window screen	\$13.00 each	\$13.00 each

Note: 54" double doors not available on any 6' wide or 8x8 New Yorker. 66" & 78" double door not available on any New Yorker or any of the following Bostonian sizes - 8x12, 10x12 or 12x12 due to space restrictions..

## Product Warranty

- Sheds USA warrants the structural soundness of all its sheds for a period of 10 years from the date of delivery with proper maintenance. A detailed warranty and registration will be sent by mail to all new customers.

### VINYL

- 100% maintenance free
- Variety of colors available
- Beautiful
- Durable
- Economical
- Maintenance free white trim

### CEDAR

### PINE

- Most popular material
- Withstands all types of weather
- Classic tongue-and-groove construction
- Affordably priced

### SMART PANEL II

SKU #471-897 (SKU represents Sheds USA's Bostonian, Portsmouth and New Yorker sheds only)

## THE BOSTONIAN

Shed Siding Material

Shed Size

Roof Style

Roof Shingle Color

Options & Upgrades

## Site Requirements

- Clearance** Shed site must be located at least 3' from any fences, trees, etc. Please remove tree branches, brush or other obstacles 3' around perimeter of shed and 12' above ground.
- Land Grade** Must be less than 6" slope from highest to lowest point, with no protruding rocks or stumps in the area.
- Access** Shed is delivered in prefab panels; clear access to site is necessary—stairs, narrow walkways, fences, gates, shrubs, carports, awnings, arbors, etc. may present difficulties and should be brought to the attention of Sheds USA prior to delivery.
- Land Quality** Consider all factors when choosing your site, including proper drainage, firmness of earth, etc.
- Permits** Responsibility of the homeowner. Please contact your local town office soon after ordering your shed to determine any restrictions or setback requirements.
- Shed site** must be 150' or less from where a large tractor-trailer can park. Shed sites 150' - 300' from truck parking area will incur a \$50.00 fee payable to the delivery crew. If your site is farther than 300' please contact our main office.

The above site requirements allow us to build a safe, sturdy shed for our customers. If any of these requirements are not met, your shed may not be built and a fee of \$150.00 will be charged for our crew to return and construct your shed once conditions are met. If this occurs, delivery of your shed materials must be completed and placed on your property, in a location accessible to the final shed site to avoid a 20% re-delivery fee. It is the customer's responsibility to cover the materials with a non-transparent, waterproof material to prevent unnecessary weathering and/or discoloration. All fees are due at time of notification.

## Delivery

- Sheds USA** will acknowledge the receipt of your order by phone or by mail. Please provide a daytime phone number at time of purchase.
- Delivery schedule** will be established by Sheds USA. You will be contacted by phone 1 to 2 weeks in advance.
- Delivery time** will fluctuate based on seasonal volume, weather conditions, etc.
- Delivery date** and installation date may differ.
- Rescheduling** of the delivery/install date will only occur if Sheds USA is forced to do so by events out of our control (weather concerns, illness, mechanical or other difficulties). Sheds USA crews deliver/install several sheds per day; therefore the status of one customer's order affects many others. To provide the best service for all of our customers, once a delivery/install date has been agreed to and scheduled by the customer and Sheds USA, postponement or cancellation by the customer will result in a 20% restocking fee.

## Standard Features & Materials

- 7/16" OSB
- 2"x4" construction, 24" on center
- Self-sealing shingles with 20-year warranty available in black, brown or white/gray
- 6' wide peak = 8'
- 8' wide peak = 8' 3"
- 10' wide peak = 8' 11"
- 12' wide peak = 9' 6"
- 8' wide gambrel = 9'
- 10' wide gambrel = 9' 5"
- 12' wide gambrel = 9' 10"
- 2"x4" construction, 24" on center
- Smart Panel II: pre-primed siding (vertical)
- Pine: 6" tongue & groove (horizontal)
- Cedar: 6" or 8" tongue & groove (vertical)
- Wall height = 71"; Extended front gable, front wall = 75"
- Maintenance free vinyl siding applied over 1/2" plywood

- 5/8" OSB tongue and groove
  - Pressure treated floor joists standard
  - Optional pressure treated plywood available
  - 2"x4" construction, 16" on center for 6' & 8' wide units
  - Optional 2"x6" floor joists available for 6' & 8' wide units
  - 2"x6" construction, 16" on center for 10' & 12' wide units
  - Concrete block supports—4 corners, front & back center of outside frame
  - Pressure treated 4x4 center beam on all 12' wide sheds
- If preparing your own foundation/footing, please call Sheds USA for exact outside floor dimensions.

- All windows come with flower boxes and shutters
- Wooden sheds come standard with functional windows.
- Vinyl sheds come standard with non-functional windows (functional windows available as an option)

- 40" double door standard

Note: All shed dimensions are approximate and door and window locations cannot be changed.