

PERMIT ISSUED

City of Portland, Maine - Building or Use Permit Application

389 Congress Street, 04101 Tel: (207) 874-8703, Fax: (207) 874-8716

Permit No: 03-0277	Issue Date: APR 02 2003	CBL: 403 D033001
-----------------------	-----------------------------------	---------------------

Location of Construction: 26 Penn Ave	Owner Name: Brown Robert A &	Owner Address: 28 Penn Ave	Phone: 878*4410
Business Name:	Contractor Name: no contractor / self	Contractor Address: Portland	Phone:
Lessee/Buyer's Name	Phone:	Permit Type: Alterations - Dwellings	Zone: R-3

Past Use: single family	Proposed Use: single family - build 12' x 26' deck w/hot tub	Permit Fee: \$44.00	Cost of Work: \$2,500.00	CEO District: 2
----------------------------	---	------------------------	-----------------------------	--------------------

FIRE DEPT: <i>N/A</i> <input type="checkbox"/> Approved <input checked="" type="checkbox"/> Denied Signature:	INSPECTION: Use Group: R-3 Type: SB BOCA 99 Signature:
---	--

Proposed Project Description: build 12' x 26' deck w/hot tub

PEDESTRIAN ACTIVITIES DISTRICT (P.A.D.) Action: <input type="checkbox"/> Approved <input type="checkbox"/> Approved w/Conditions <input type="checkbox"/> Denied Signature: _____ Date: _____

Permit Taken By: gg	Date Applied For: 04/02/2003	Zoning Approval	
------------------------	---------------------------------	------------------------	--

- This permit application does not preclude the Applicant(s) from meeting applicable State and Federal Rules.
- Building permits do not include plumbing, septic or electrical work.
- Building permits are void if work is not started within six (6) months of the date of issuance. False information may invalidate a building permit and stop all work..

Special Zone or Reviews <input type="checkbox"/> Shoreland <input type="checkbox"/> Wetland <input type="checkbox"/> Flood Zone <input type="checkbox"/> Subdivision <input type="checkbox"/> Site Plan Maj <input type="checkbox"/> Minor <input checked="" type="checkbox"/> MM <input type="checkbox"/> Date: 4/2/03	Zoning Appeal <input type="checkbox"/> Variance <input type="checkbox"/> Miscellaneous <input type="checkbox"/> Conditional Use <input type="checkbox"/> Interpretation <input type="checkbox"/> Approved <input type="checkbox"/> Denied Date: _____	Historic Preservation <input checked="" type="checkbox"/> Not in District or Landmark <input type="checkbox"/> Does Not Require Review <input type="checkbox"/> Requires Review <input type="checkbox"/> Approved <input type="checkbox"/> Approved w/Conditions <input type="checkbox"/> Denied Date: 4/2/03
--	---	--

CERTIFICATION

I hereby certify that I am the owner of record of the named property, or that the proposed work is authorized by the owner of record and that I have been authorized by the owner to make this application as his authorized agent and I agree to conform to all applicable laws of this jurisdiction. In addition, if a permit for work described in the application is issued, I certify that the code official's authorized representative shall have the authority to enter all areas covered by such permit at any reasonable hour to enforce the provision of the code(s) applicable to such permit.

SIGNATURE OF APPLICANT	ADDRESS	DATE	PHONE
RESPONSIBLE PERSON IN CHARGE OF WORK, TITLE		DATE	PHONE

BUILDING PERMIT INSPECTION PROCEDURES

Please call 874-8703 or 874-8693 to schedule your inspections as agreed upon

Permits expire in 6 months, if the project is not started or ceases for 6 months.

The Owner or their designee is required to notify the inspections office for the following inspections and provide adequate notice. Notice must be called in 48-72 hours in advance in order to schedule an inspection:

By initializing at each inspection time, you are agreeing that you understand the inspection procedure and additional fees from a "Stop Work Order" and "Stop Work Order Release" will be incurred if the procedure is not followed as stated below.

Pre-construction Meeting: Must be scheduled with your inspection team upon receipt of this permit. Jay Reynolds, Development Review Coordinator at 874-8632 must also be contacted at this time, before any site work begins on any project other than single family additions or alterations.

Footing/Building Location Inspection: Prior to pouring concrete

N/A **Re-Bar Schedule Inspection:** Prior to pouring concrete

N/A **Foundation Inspection:** Prior to placing ANY backfill

Framing/Rough Plumbing/Electrical: Prior to any insulating or drywalling

Final/Certificate of Occupancy: Prior to any occupancy of the structure or use. NOTE: There is a \$75.00 fee per inspection at this point.

Certificate of Occupancy is not required for certain projects. Your inspector can advise you if your project requires a Certificate of Occupancy. All projects DO require a final inspection

 If any of the inspections do not occur, the project cannot go on to the next phase, REGARDLESS OF THE NOTICE OR CIRCUMSTANCES.

CERIFICATE OF OCCUPANICES MUST BE ISSUED AND PAID FOR, BEFORE THE SPACE MAY BE OCCUPIED

Alaine Brown
Signature of applicant/designee

Date 4/2/03

[Signature]
Signature of Inspections Official

Date

CBL: 403-D-33 Building Permit #: 03-0277

DISPLAY THIS CARD ON PRINCIPAL FRONTAGE OF WORK CITY OF PORTLAND

Please Read Application And Notes, If Any, Attached

BUILDING INSPECTION PERMIT

Permit Number: 030277

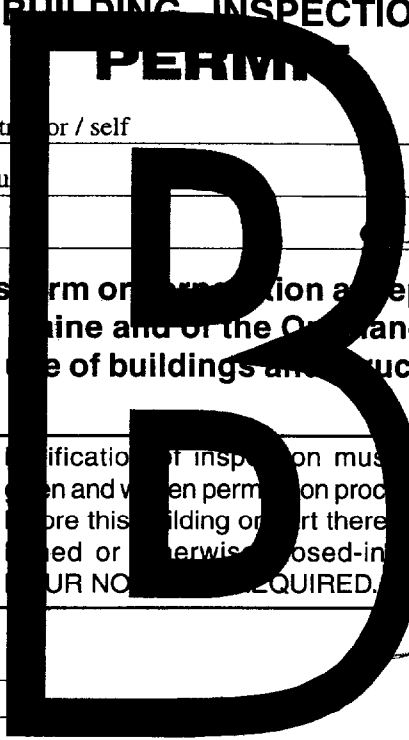

This is to certify that Brown Robert A & /no contractor / self
has permission to build 12' x 26' deck w/hot tub
AT 26 Penn Ave 403 D033001

provided that the person or persons who perform or supervise the construction accepting this permit shall comply with all of the provisions of the Statutes of the State and of the Ordinances of the City of Portland regulating the construction, maintenance and use of buildings and structures, and of the application on file in this department.

Apply to Public Works for street line and grade if nature of work requires such information.

Classification of inspection must be given and when permission procedure before this building or part thereof is closed or otherwise closed-in. YOUR NO. REQUIRED.

A certificate of occupancy must be procured by owner before this building or part thereof is occupied.

OTHER REQUIRED APPROVALS

Fire Dept. **PERMIT ISSUED**
Health Dept.
Appeal Board **APR 02 2003**
Other _____
Department Name

[Signature]
Director - Building & Inspection Services

CITY OF PORTLAND PENALTY FOR REMOVING THIS CARD

All Purpose Building Permit Application

If you or the property owner owes real estate or personal property taxes or user charges on any property within the City, payment arrangements must be made before permits of any kind are accepted.

Location/Address of Construction: <u>28 Penn Ave Portland, Maine 04103</u>		
Total Square Footage of Proposed Structure <u>312 Square Feet</u>	Square Footage of Lot <u>6500 Square Feet</u>	
Tax Assessor's Chart, Block & Lot Chart# <u>403</u> Block# <u>D</u> Lot# <u>33</u>	Owner: <u>Robert and Valarie Brown</u>	Telephone: <u>1-207-878-4410</u>
Lessee/Buyer's Name (If Applicable)	Applicant name, address & telephone: <u>Robert A. Brown</u> <u>28 Penn Ave</u> <u>Portland, ME 04103 878-4410</u>	Cost Of Work: <u>\$2500.00</u> Fee: \$ <u>\$37.00</u>
Current use: <u>Single Family Dwelling</u>		
If the location is currently vacant, what was prior use: _____		
Approximately how long has it been vacant: _____		
Proposed use: <u>Family Deck with Hot Tub</u>		
Project description: <u>12x26 Deck located at back of home</u>		
Contractor's name, address & telephone: <u>NA</u>		
Who should we contact when the permit is ready: <u>Robert Brown</u>		
Mailing address: _____		
We will contact you by phone when the permit is ready. You must come in and pick up the permit and review the requirements before starting any work, with a Plan Reviewer. A stop work order will be issued and a \$100.00 fee if any work starts before the permit is picked up. PHONE: _____		

IF THE REQUIRED INFORMATION IS NOT INCLUDED IN THE SUBMISSIONS THE PERMIT WILL BE AUTOMATICALLY DENIED AT THE DISCRETION OF THE BUILDING/PLANNING DEPARTMENT, WE MAY REQUIRE ADDITIONAL INFORMATION IN ORDER TO APPROVE THIS PERMIT.

APR 2 2003

I hereby certify that I am the Owner of record of the named property, or that the owner of record authorizes the proposed work and that I have been authorized by the owner to make this application as his/her authorized agent. I agree to conform to all applicable laws of this jurisdiction. In addition, if a permit for work described in this application is issued, I certify that the Code Official's authorized representative shall have the authority to enter all areas covered by this permit at any reasonable hour to enforce the provisions of the codes applicable to this permit.

Signature of applicant: <u>Robert A. Brown</u>	Date: <u>04/24/03</u>
--	-----------------------

This is NOT a permit, you may not commence ANY work until the permit is issued. If you are in a Historic District you may be subject to additional permitting and fees with the Planning Department on the 4th floor of City Hall

1625

CUSTOM VIEW
CUSTOMER -- GENERIC CUSTOMER
DATE 03/27/03 REF Deck03086

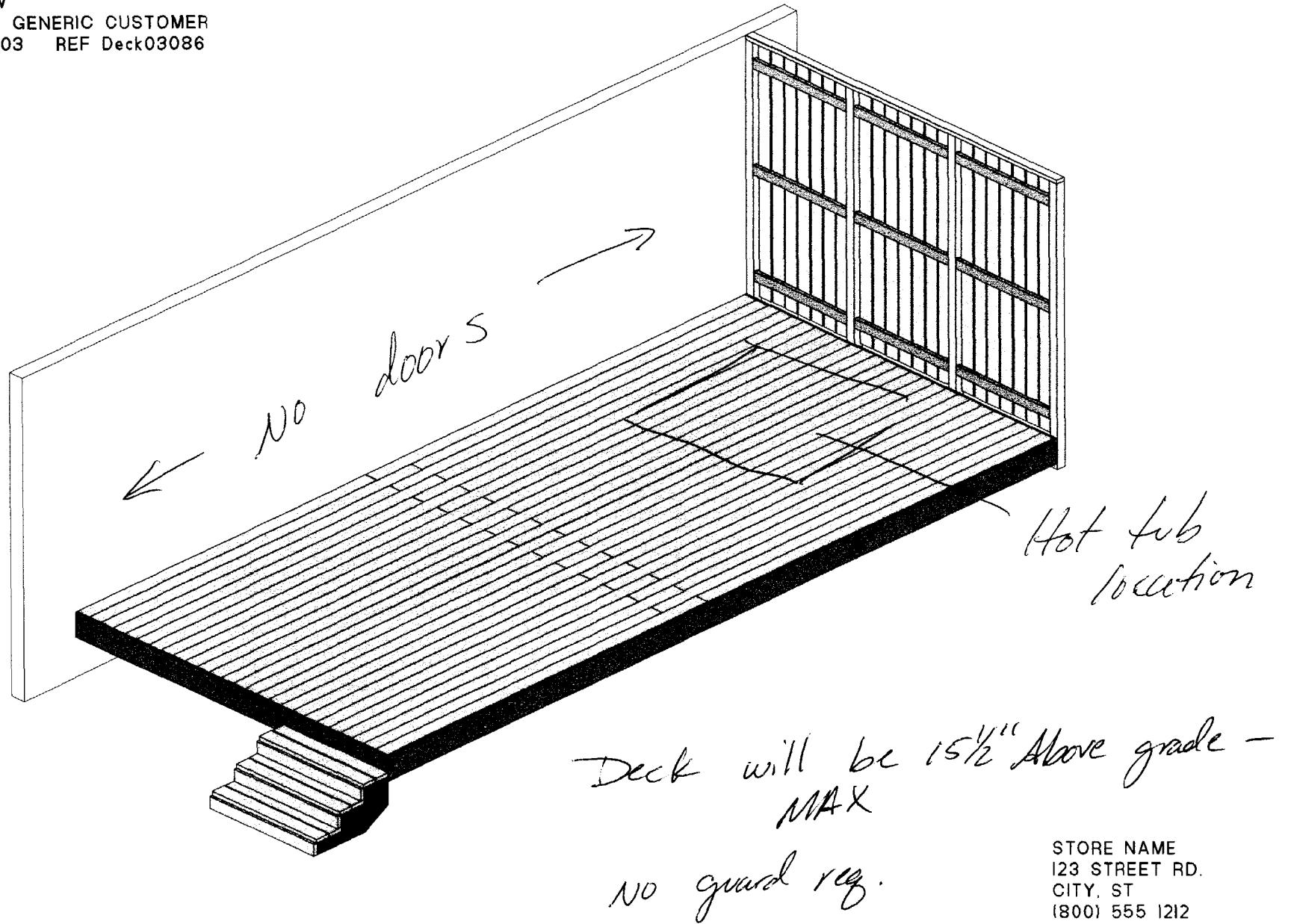

STORE NAME
123 STREET RD.
CITY, ST
(800) 555 1212

BEAM LAYOUT
 CUSTOMER -- GENERIC CUSTOMER
 DATE 03/27/03 REF Deck03086

STORE NAME
 123 STREET RD.
 CITY, ST
 (800) 555 1212

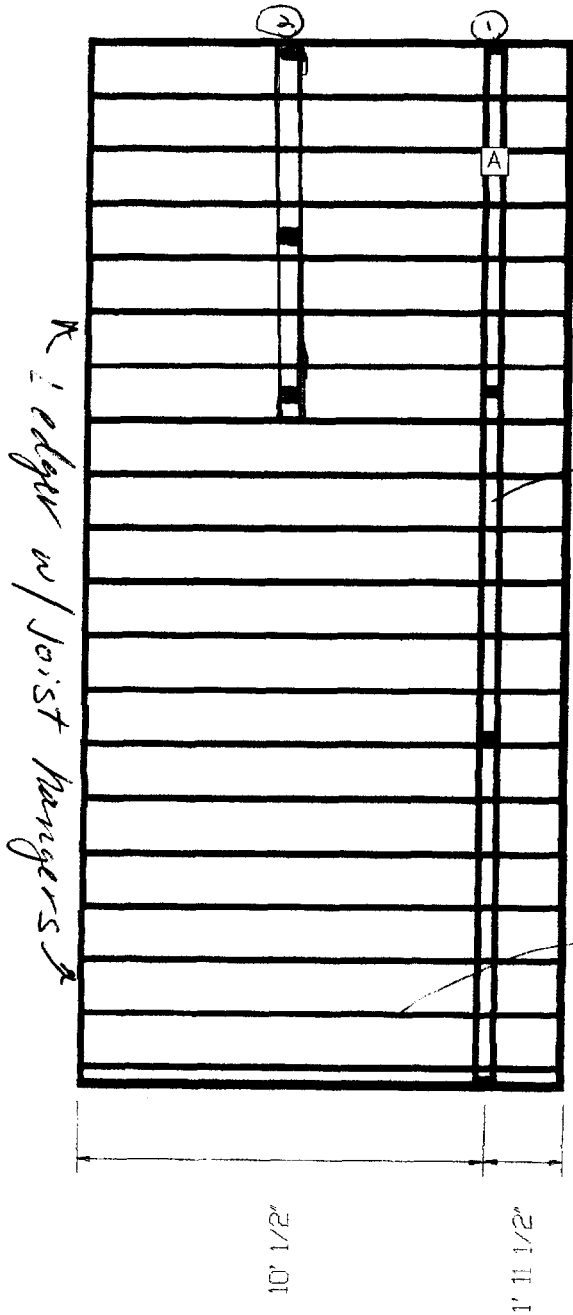

- = 4' Tapered Frost Post - 4' deep in ground
- ① - Beam 2x8x12 + 2x8x16
- ② - Beam - 2x8x12

2-2x10 Beams
 8'-6" span

2x8 - 16" OC

Edge w/ Joist Runners

BEAM LABEL	BEAM LENGTH	POST COUNT	POST SPACING
A	25' 10 1/2"	4	8' 6 1/4"
B	10'	3	

Post spacing is measured center-to-center.

Depth of concrete piers --- 0 inches.

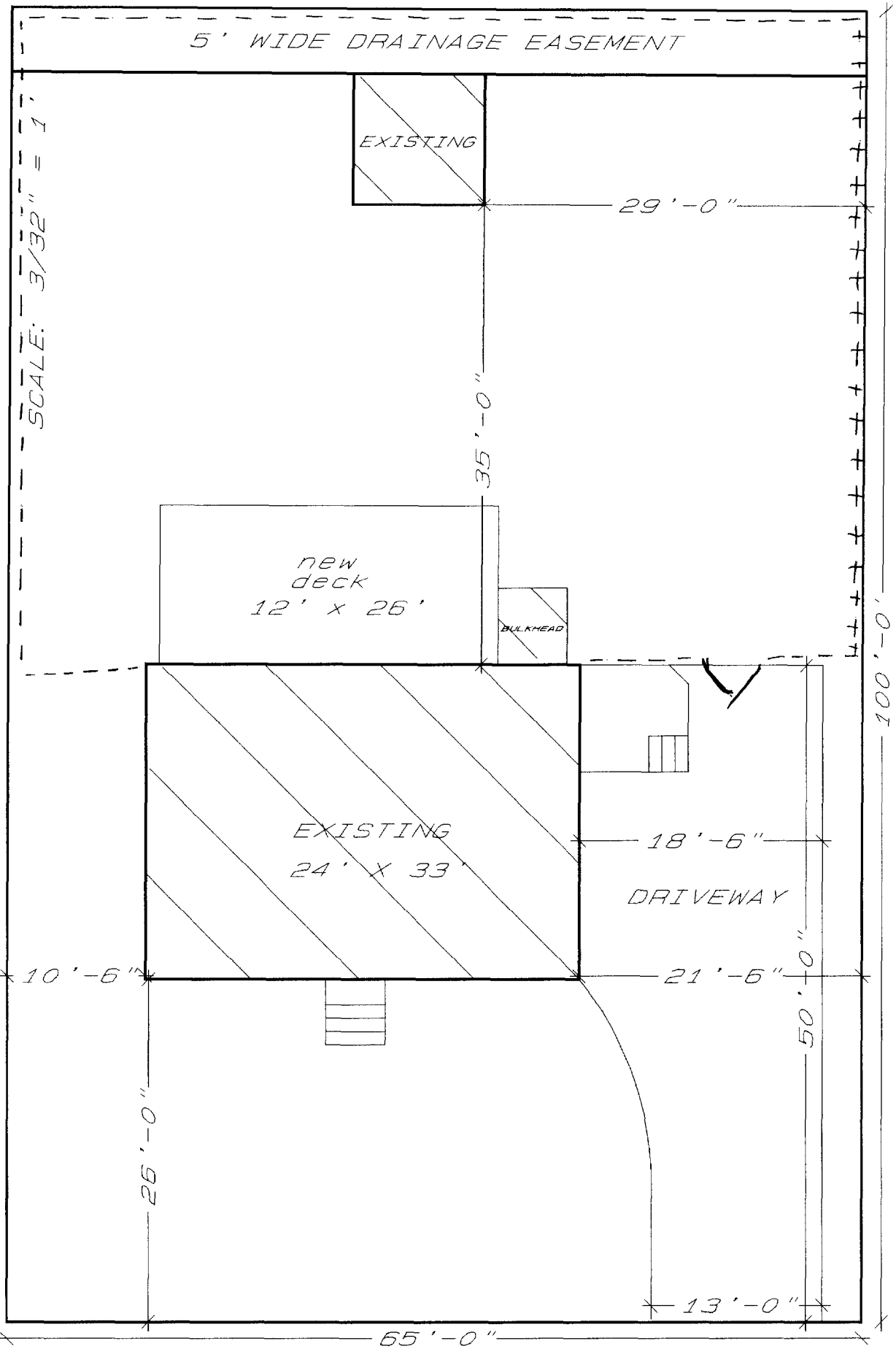

No door
accessing
back yard

--- denotes 6' stockade fencing
 +++ denotes 6' existing stockade fence

Latch will 54" from bottom of fence
 on outside facing driveway
 self closing & self latching

CUSTOM VIEW
CUSTOMER -- GENERIC CUSTOMER
DATE 03/27/03 REF Deck03086

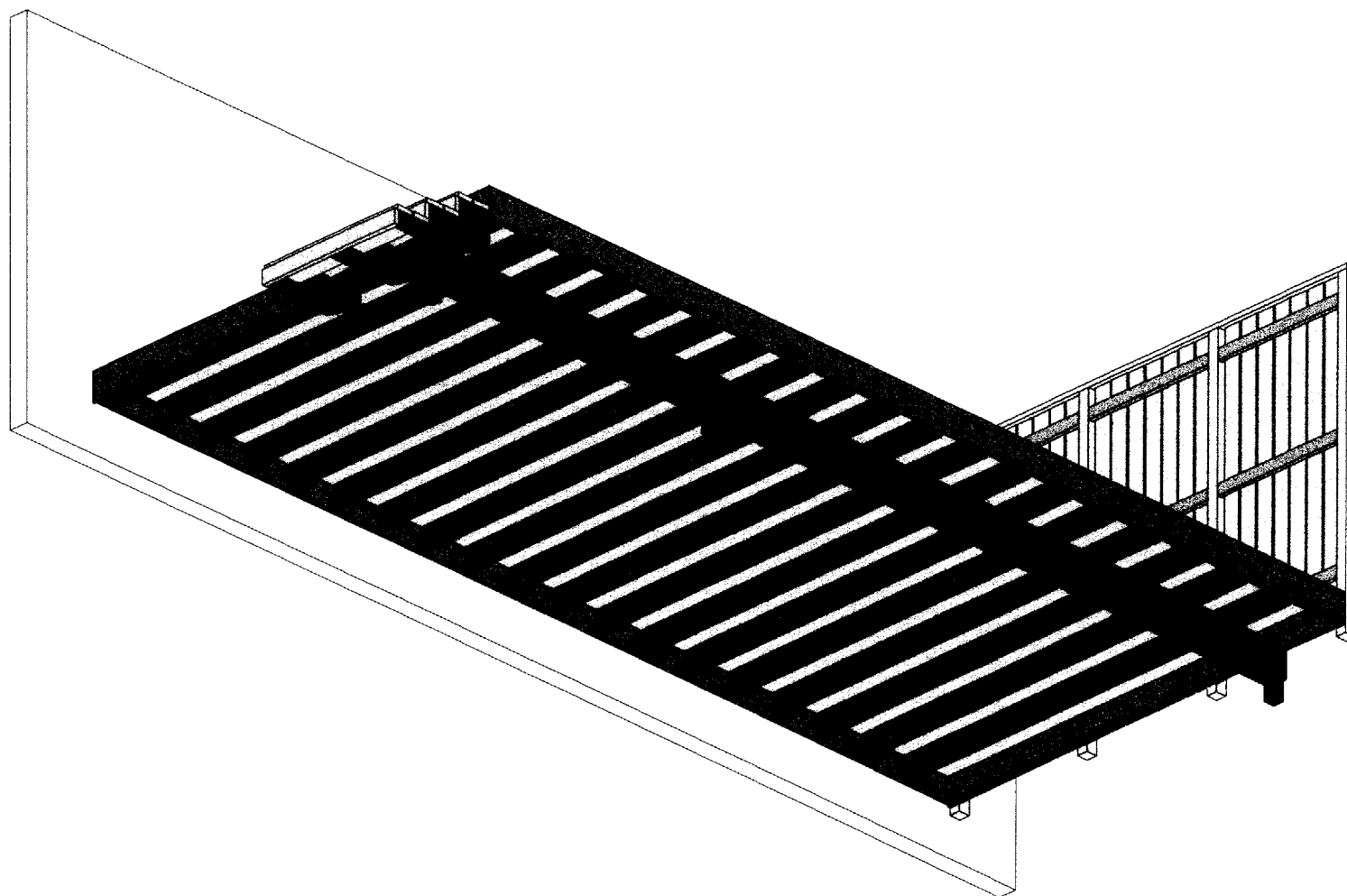

STORE NAME
123 STREET RD.
CITY, ST
(800) 555 1212