

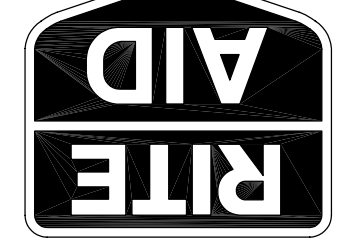

BRUCE
ROMANNE
HAMILTON
ARCHITECTS

ARCHITECTS
INTERIOR DESIGN
LAND PLANNING
300 STATE ST.
PORTLAND, ME 04101
TEL: 603.761.1100
WWW.BRURHAM.COM

RITE AID STORE #4122
WASHINGTON & ALLEN AVENUE
PORTLAND, MAINE



ISSUED FOR BUILDING PERMIT/CC BIDDING
10-27-06

Drawn: RCK
Checked: RCK
Approved: RCK
Project No: 0525
Date: 10-27-06

Electrical
Diagrams
and Details

Sheet No.

E-301

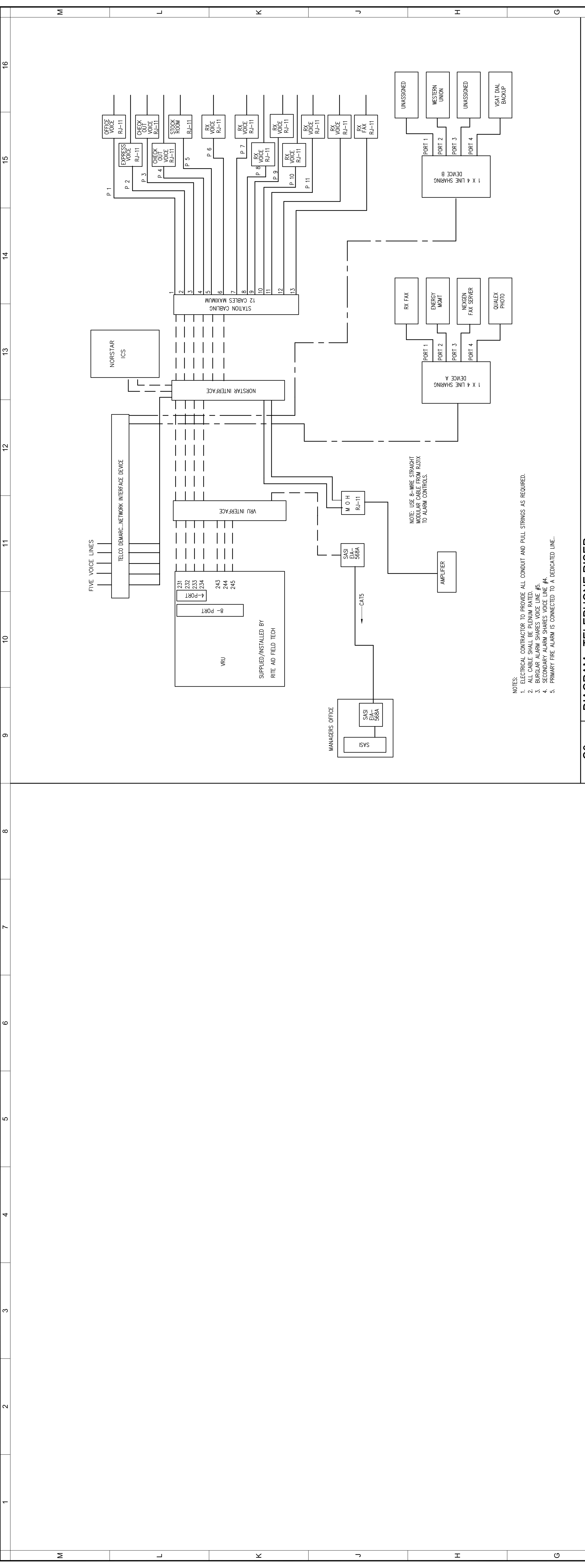

- NOTES:
1. ELECTRICAL CONTRACTOR TO PROVIDE ALL CONDUIT AND PULL STRINGS AS REQUIRED.
 2. ALL CABLE SHALL BE FEMURATED.
 3. ALL CABLE SHALL BE IDENTIFIED.
 4. SECONDARY ALARM SHARES VOICE LINE #4.
 5. PRIMARY FIRE ALARM IS CONNECTED TO A DEDICATED LINE.

G9 DIAGRAM - TELEPHONE RISER

N.T.S.

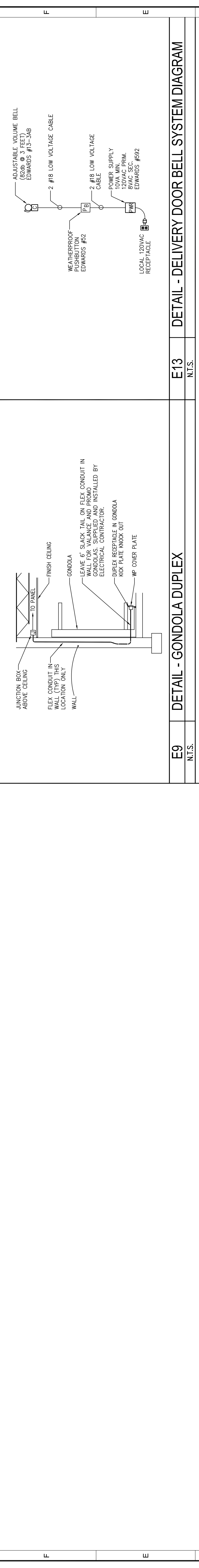

E9 DETAIL - GONDOLA DUPLEX

N.T.S.

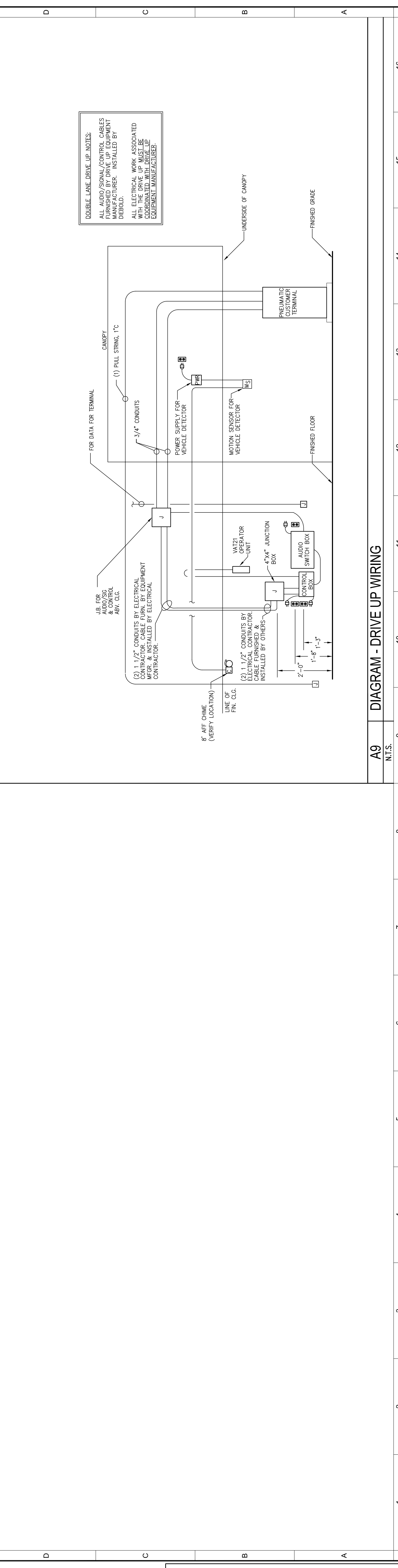

E13 DETAIL - DELIVERY DOOR BELL SYSTEM DIAGRAM

N.T.S.

A9 DIAGRAM - DRIVE UP WIRING

N.T.S.

DOUBLE LANE DRIVE UP NOTES:
ALL AUDIO/SIGNAL/CONTROL CABLES
FINISHED BY DRIVE UP EQUIPMENT
MANUFACTURER. INSTALLED BY
DEBARD.
ALL ELECTRICAL WORK ASSOCIATED
WITH THE DRIVE UP MUST BE
COORDINATED WITH DRIVE UP
EQUIPMENT MANUFACTURER.

REVISIONS

Drawn: RCK
Checked: RCK
Approved: RCK
Project No: 0525
Date: 10-27-06

Electrical
Diagrams
and Details

Sheet No.

E-301