

REVISIONS:		
No.	DATE	REVISIONS PER CITY COMMENTS
1	04/11/05	REVISED PARCEL B LAYOUT
3	07/18/06	ADDITIONAL INTERIOR SIDEWALKS
4	08/22/06	ISSUED FOR GENERAL CONTRACTOR
5	11/21/06	BID & BUILDING PERMIT

**GENERAL NOTES:**

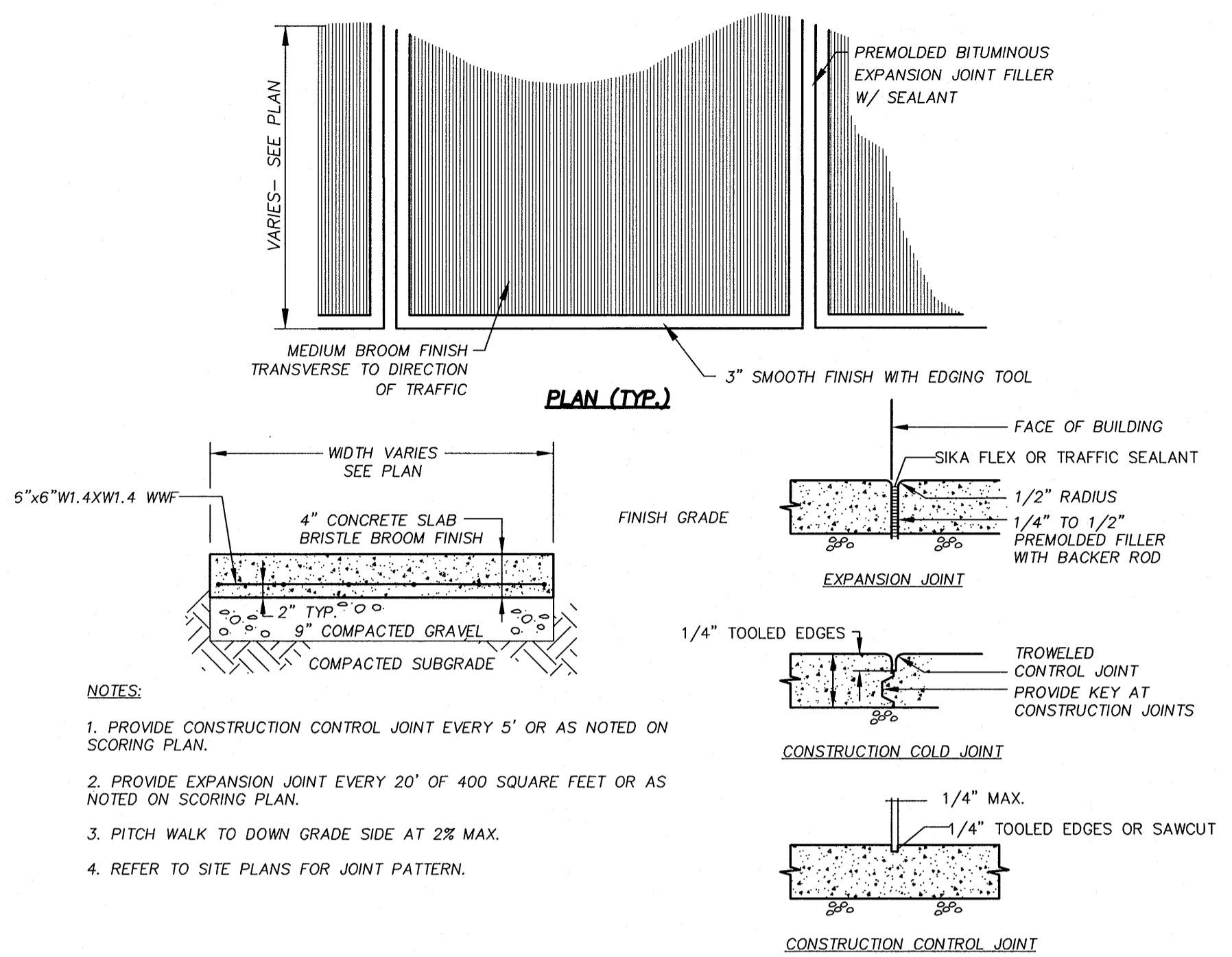

**1 CONCRETE SIDEWALK**  
D-5 NOT TO SCALE

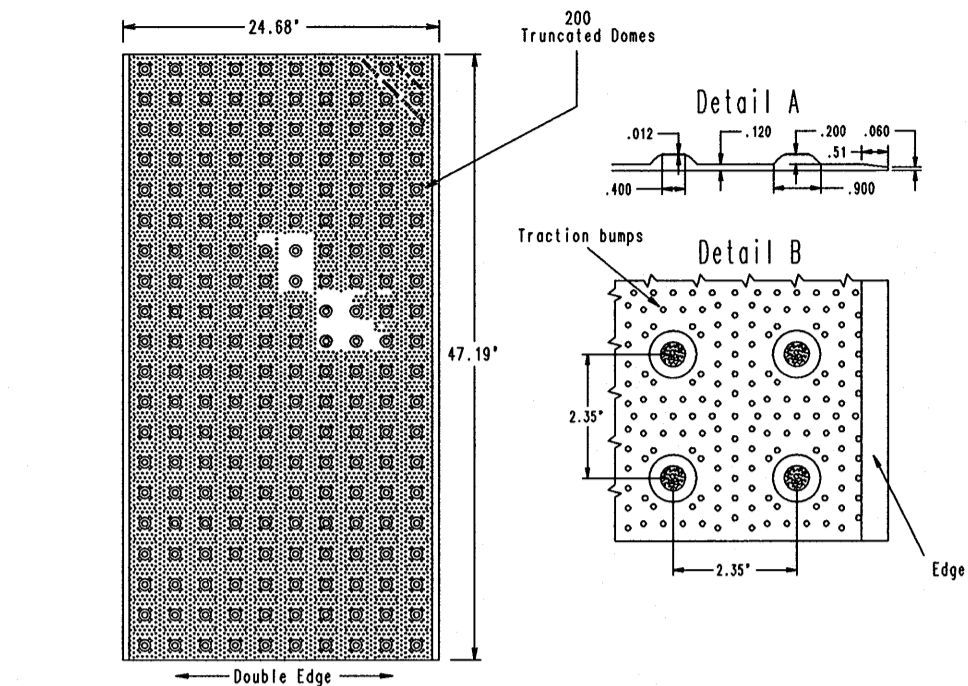

**NOTES:**

1. DETECTABLE WARNING MATS SHALL BE PROVIDED BY 'DETECTABLE WARNING SYSTEMS, INC.' (866) 999-7452 WWW.DETECTABLE-WARNING.COM OR EQUAL. COLORS AVAILABLE YELLOW, BRICK RED, BLACK. CONTRACTOR TO COORDINATE COLOR WITH ARCHITECT.
2. DETECTABLE WARNINGS ON CURB RAMPS SHALL CONFORM TO ADAAG SECTION 4.29.2 DETECTABLE WARNINGS ON WALKWAY SURFACES.
3. DETECTABLE WARNINGS SHALL CONSIST OF TRUNCATED DOMES AND SHALL CONTRAST VISUALLY WITH ADJOINING SURFACES, EITHER LIGHT-ON-DARK OR DARK-ON-LIGHT.

**2 DETECTABLE WARNINGS AT RAMPS**  
D-5 NOT TO SCALE

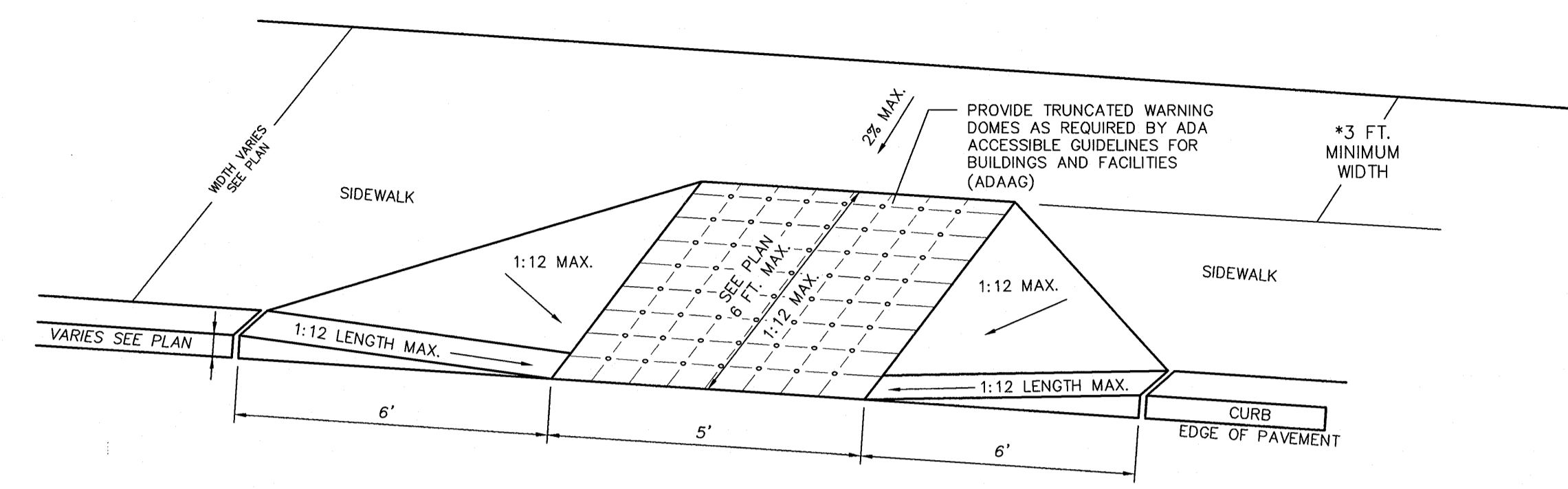

**3 CONCRETE WHEELCHAIR RAMP TYPE I**  
D-5 NOT TO SCALE

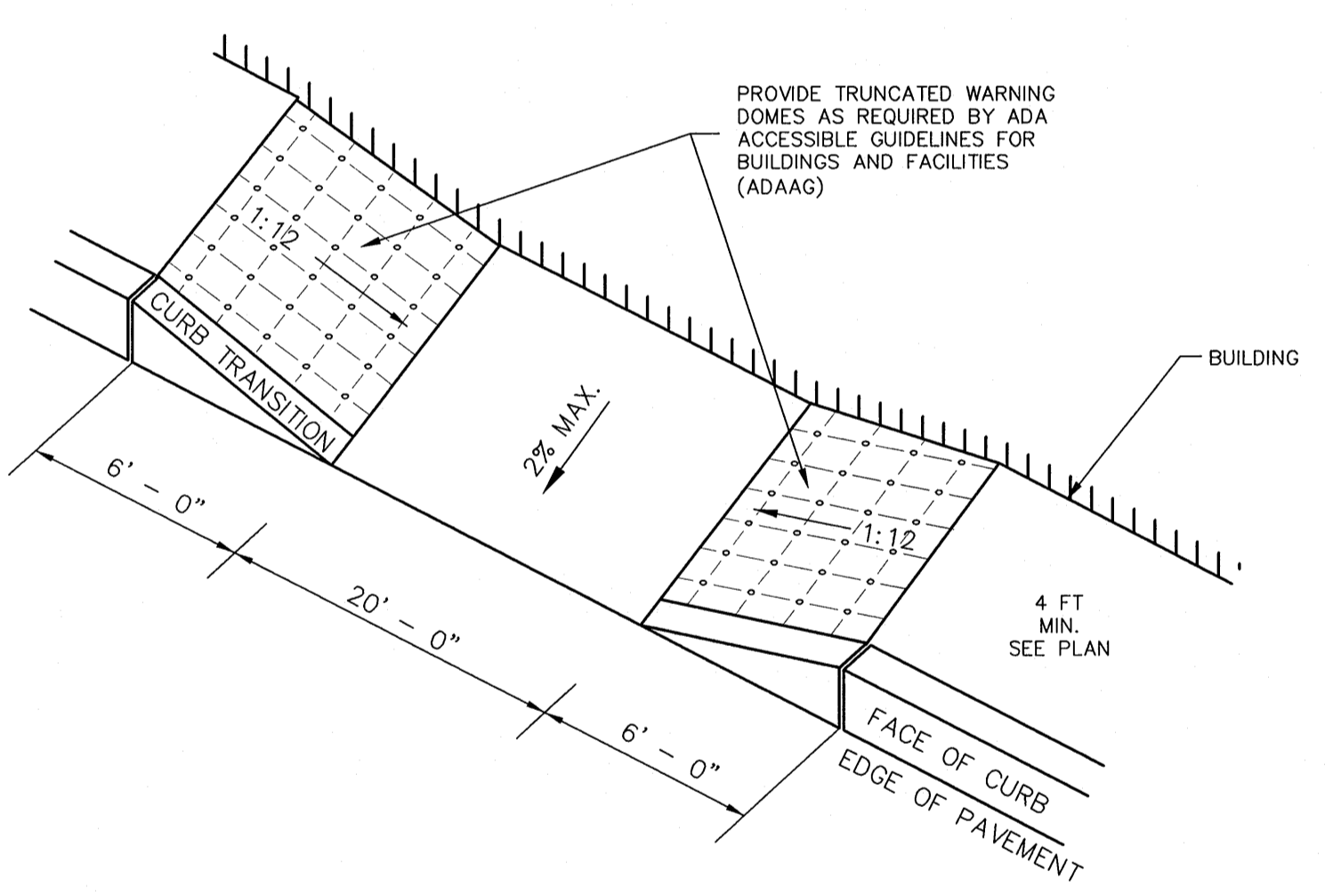

**4 CONCRETE WHEELCHAIR RAMP TYPE II**  
D-5 NOT TO SCALE

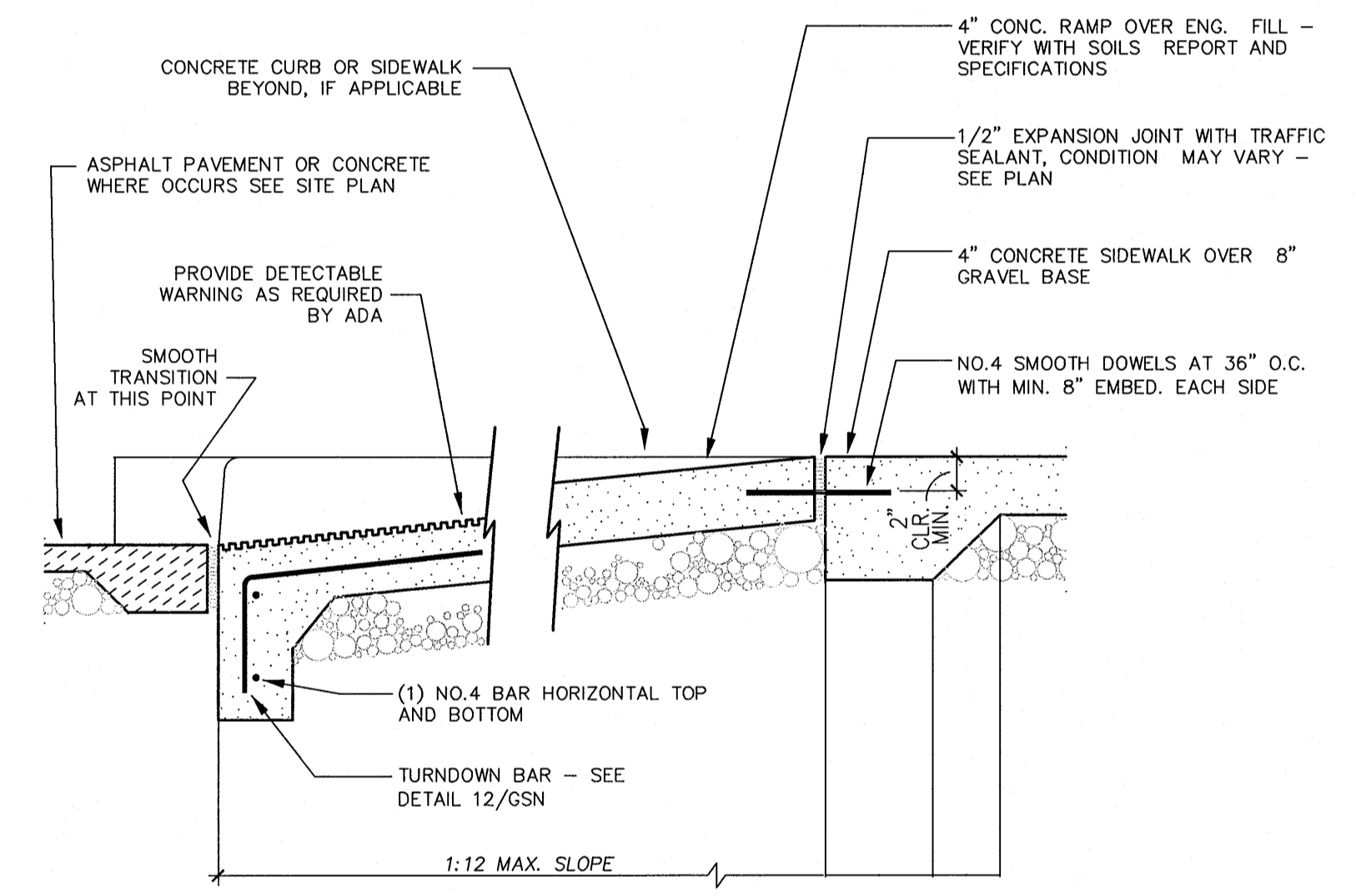

**5 RAMP SECTION**  
D-5 NOT TO SCALE

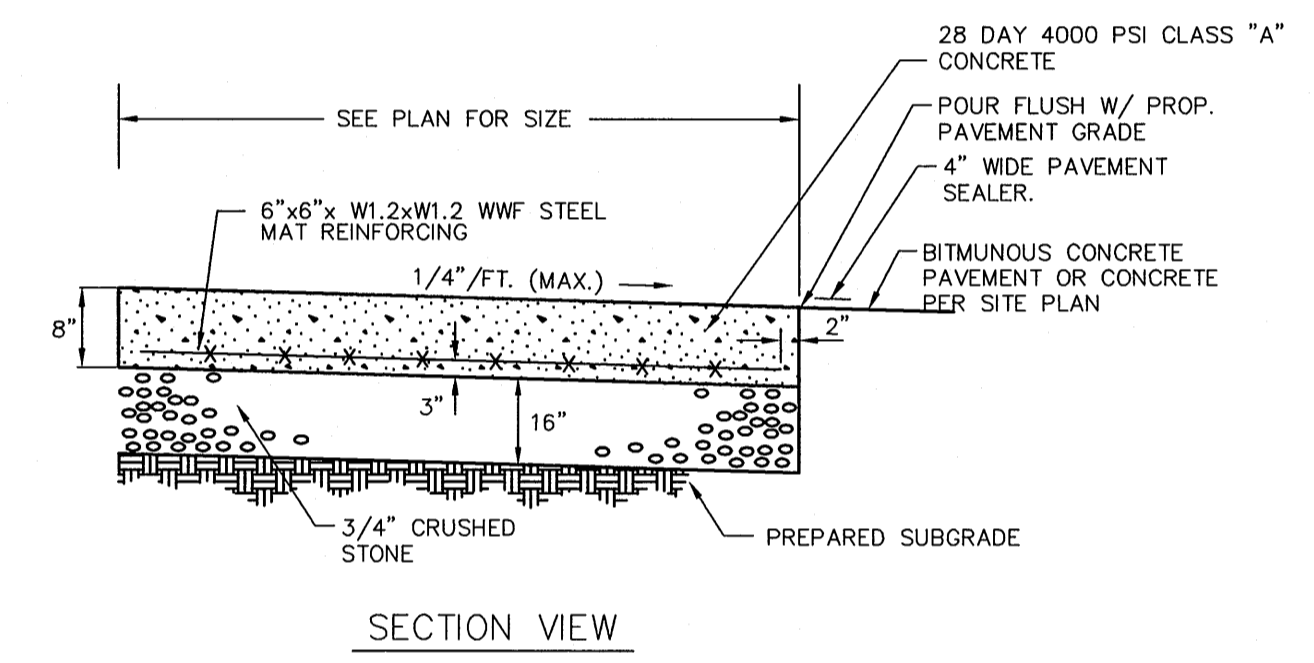

**6 CONCRETE PAVING**  
D-5 NOT TO SCALE

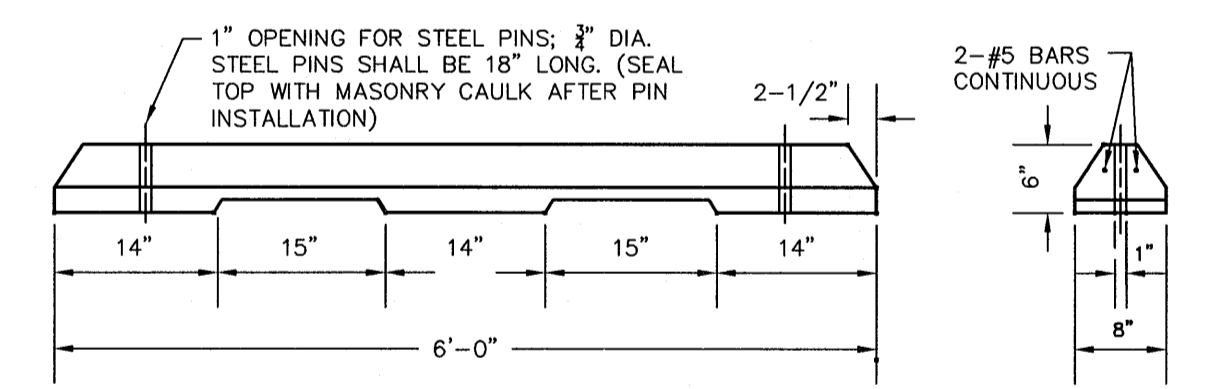

**7 CONCRETE WHEELSTOP**  
D-5 NOT TO SCALE

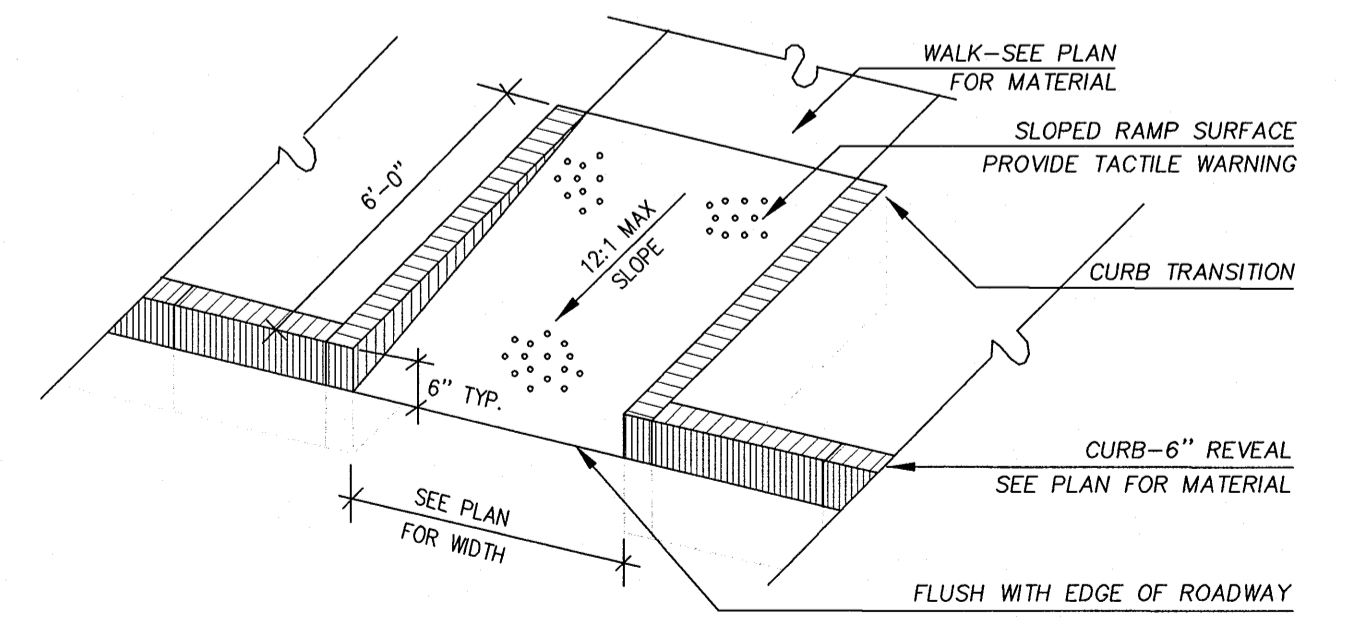

**8 HANDICAP RAMP WITH RETURNED CURBS TYPE III**  
D-5 NOT TO SCALE

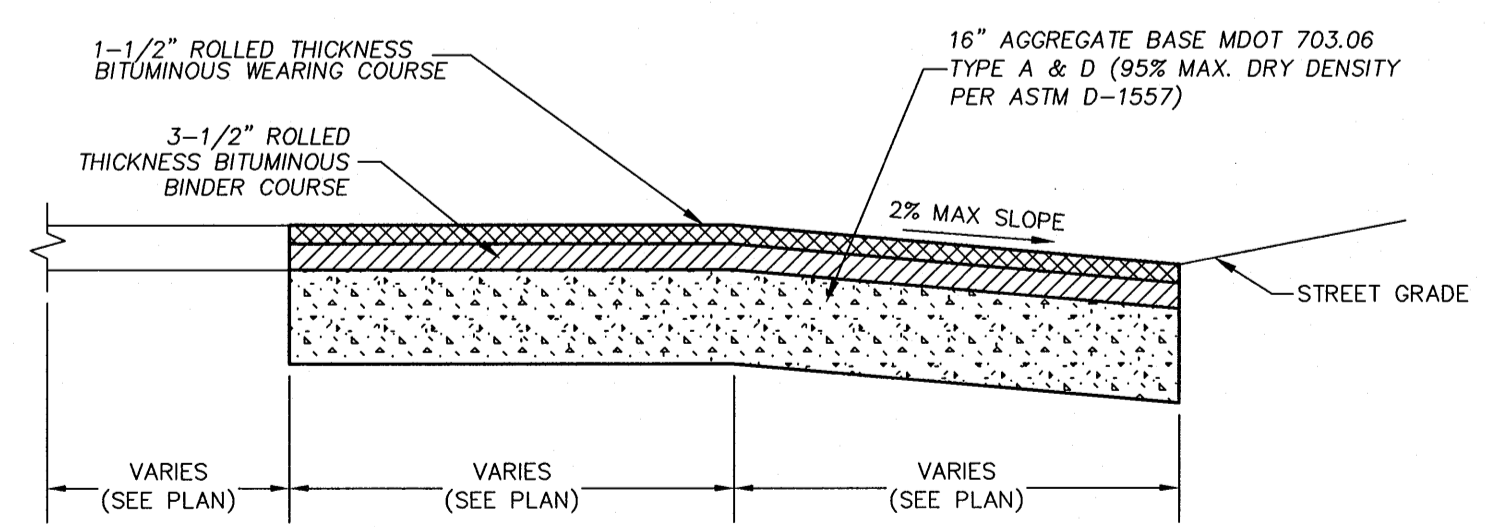

**9 DRIVEWAY DETAIL W/ CURVED RADII**  
D-5 N.T.S.

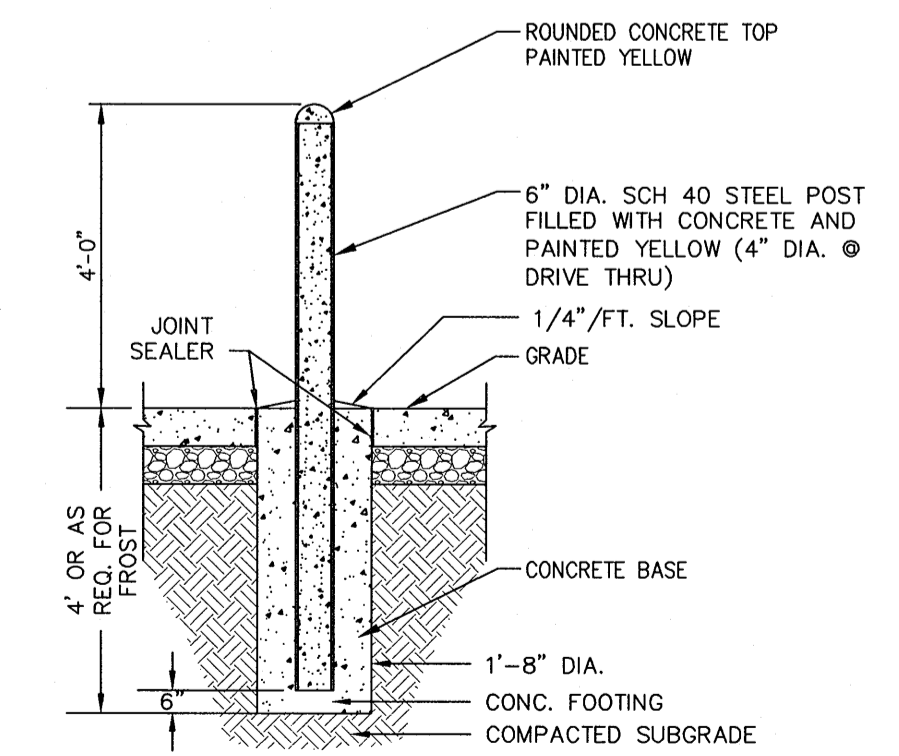

**10 PROTECTIVE BOLLARD DETAIL**  
D-5 N.T.S.

**COLER & COLANTONIO**  
ENGINEERS AND SCIENTISTS

413-313-0100  
Fax: 413-313-0190  
www.col-col.com

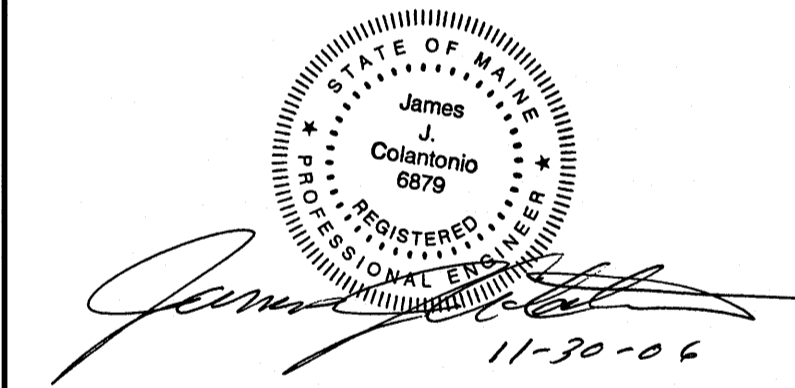

TITLE:

**CONSTRUCTION DETAILS  
PROPOSED SITE DESIGN  
RITE AID PHARMACY  
365 ALLEN AVENUE  
PORTLAND, ME**

PREPARED FOR:  
**RITE AID CORPORATION  
P. O. BOX 3165  
HARRISBURG, PA 17105**

DATE: OCT. 19, 2004	<b>D-5</b>
COMP./DESIGN: STAFF	
CHECK: KK	
DRAWN: ELM	
SCALE: NONE	
JOB NO.: 60-61	
DWG NO.: 60-61 Details	