

BRUCE ROMANNE HAMILTON ARCHITECTS  
 100 WASHINGTON & ALLEN AVENUE  
 PORTLAND, MAINE 04102  
 TEL: 603.761.1100  
 FAX: 603.761.1101  
 WWW.BRHR.COM

RITE AID STORE #4122  
 WASHINGTON & ALLEN AVENUE  
 PORTLAND, MAINE

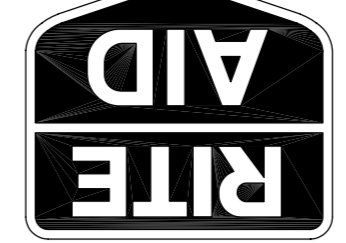

ISSUED FOR BUILDING PERMIT/CC BUILDING  
 10-27-06  
 REVISIONS

Drawn: [Blank]  
 Checked: [Blank]  
 Approved: [Blank]  
 Project No.: 0525  
 Date: 10-27-06  
 Title: WALL SECTIONS  
 Sheet No.: [Blank]

A-401

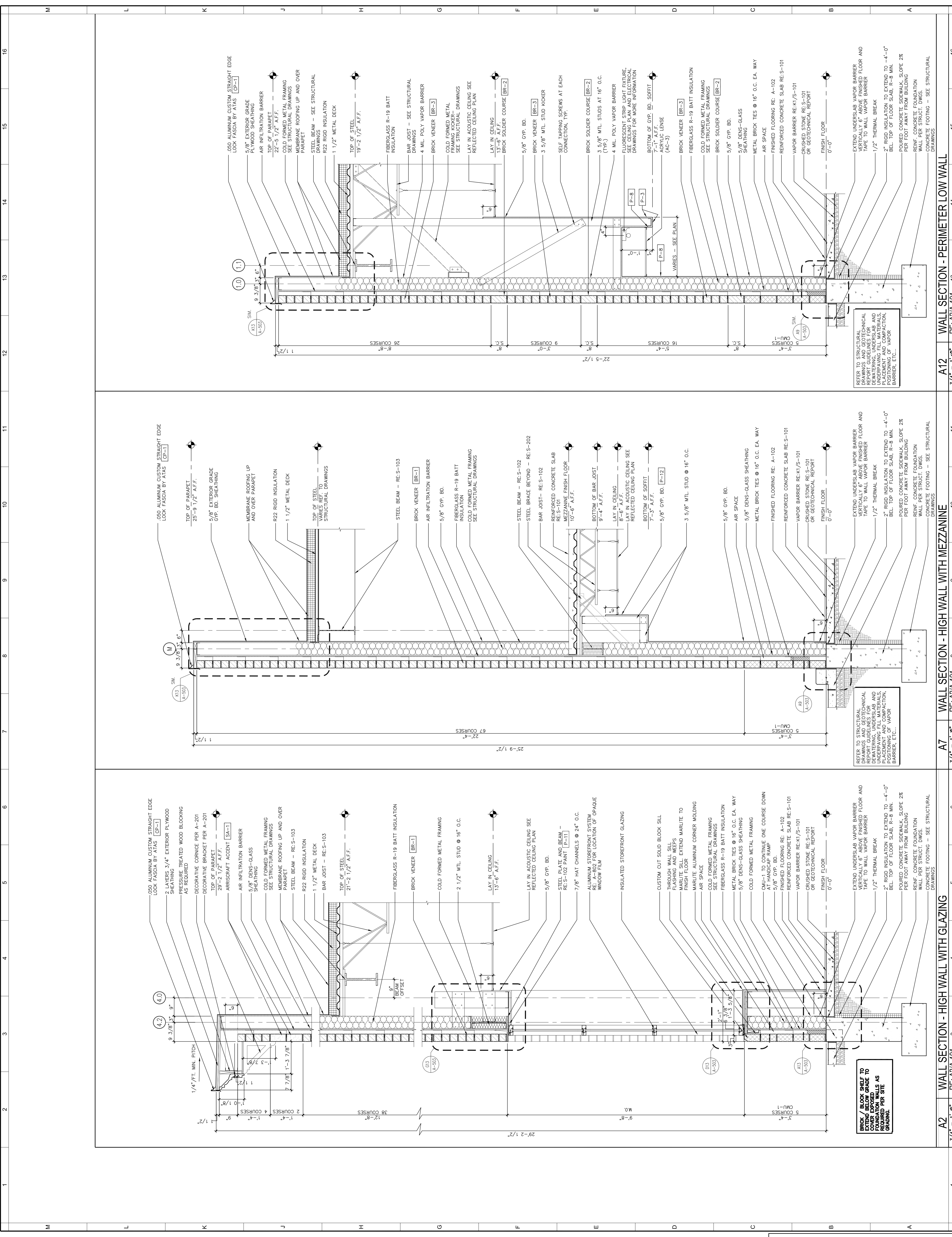

M 16  
15  
14  
13  
12  
11  
10  
9  
8  
7  
6  
5  
4  
3  
2  
1

L  
K  
J  
H  
G  
F  
E  
D  
C  
B  
A

050 ALUMINUM CUSTOM STRAIGHT EDGE LOCK FASCIA BY ATAS [CP-1]  
 2 LAYERS 3/4" EXTERIOR PLYWOOD SHEATHING  
 PRESSURE TREATED WOOD BLOCKING AS REQUIRED  
 DECORATIVE CORNICE PER A-201  
 DECORATIVE BRACKET PER A-201  
 TOP OF PARAPET  
 29'-2 1/2" A.F.F.  
 ARRISCRIFT ACCENT [SA-1]  
 AIR INFILTRATION BARRIER  
 5/8" DENS-GLASS SHEATHING  
 COLD FORMED METAL FRAMING SEE STRUCTURAL DRAWINGS  
 MEMBRANE ROOFING UP AND OVER PARAPET  
 STEEL BEAM - RE-S-103  
 R22 RIGID INSULATION  
 1 1/2" METAL DECK  
 BAR JOIST - RE-S-103  
 TOP OF STEEL  
 21'-5 1/2" A.F.F.  
 FIBERGLASS R-19 BATT INSULATION  
 BRICK VENEER [BR-1]  
 COLD FORMED METAL FRAMING  
 2 1/2" MTL. STUD @ 16" O.C.  
 LAY IN CEILING  
 13'-6" A.F.F.  
 LAY IN ACOUSTIC CEILING SEE REFLECTED CEILING PLAN  
 5/8" GYP. BD.  
 STEEL PLATE AND BEAM - RE-S-102 PAINT [P-11]  
 7/8" HAT CHANNELS @ 24" O.C.  
 ALUMINUM STOREFRONT SYSTEM RE-S-202 FOR LOCATION OF OPAGUE WINDOW FILM  
 INSULATED STOREFRONT GLAZING  
 CUSTOM CUT SOLID BLOCK SILL THROUGH WALL SILL FLASHING AND WEEPS MARLITE SILL EXTEND MARLITE TO FINISH FLOOR  
 AIR SPACE  
 MARLITE ALUMINUM CORNER MOLDING  
 COLD FORMED METAL FRAMING SEE STRUCTURAL DRAWINGS  
 FIBERGLASS R-19 BATT INSULATION  
 METAL BRICK TIES @ 16" O.C. EA. WAY  
 5/8" DENS-GLASS SHEATHING  
 COLD FORMED METAL FRAMING  
 CAU-1 TO CONTINUE ONE COURSE DOWN AT HANDICAP RAMP  
 5/8" GYP. BD.  
 FINISHED FLOORING RE: A-102  
 REINFORCED CONCRETE SLAB RE-S-101  
 VAPOR BARRIER RE-K1/S-101  
 CRUSHED STONE RE-S-101 OR GEOTECHNICAL REPORT  
 FINISH FLOOR  
 0'-0"

050 ALUMINUM CUSTOM STRAIGHT EDGE LOCK FASCIA BY ATAS [CP-1]  
 25'-9 1/2" A.F.F.  
 5/8" EXTERIOR GRADE GYP. BD. SHEATHING  
 MEMBRANE ROOFING UP AND OVER PARAPET  
 R22 RIGID INSULATION  
 1 1/2" METAL DECK  
 TOP OF STEEL  
 STRUCTURAL DRAWINGS  
 STEEL BEAM - RE-S-103  
 BRICK VENEER [BR-1]  
 AIR INFILTRATION BARRIER  
 5/8" GYP. BD.  
 FIBERGLASS R-19 BATT INSULATION  
 COLD FORMED METAL FRAMING SEE STRUCTURAL DRAWINGS  
 STEEL BEAM - RE-S-102  
 STEEL BRACE BEYOND - RE-S-202  
 BAR JOIST - RE-S-102  
 REINFORCED CONCRETE SLAB RE-S-101  
 CRUSHED STONE FINISH FLOOR 10'-6" A.F.F.  
 BOTTOM OF BAR JOIST  
 9'-4" A.F.F.  
 LAY IN CEILING  
 8'-6" A.F.F.  
 LAY IN ACOUSTIC CEILING SEE REFLECTED CEILING PLAN  
 BOTTOM OF SOFFIT  
 7'-3" A.F.F.  
 5/8" GYP. BD. [P-12]  
 3 5/8" MTL. STUD @ 16" O.C.  
 5/8" GYP. BD.  
 AIR SPACE  
 5/8" DENS-GLASS SHEATHING  
 METAL BRICK TIES @ 16" O.C. EA. WAY  
 FINISHED FLOORING RE: A-102  
 REINFORCED CONCRETE SLAB RE-S-101  
 VAPOR BARRIER RE-K1/S-101  
 CRUSHED STONE RE-S-101 OR GEOTECHNICAL REPORT  
 FINISH FLOOR  
 0'-0"

050 ALUMINUM CUSTOM STRAIGHT EDGE LOCK FASCIA BY ATAS [CP-1]  
 9 3/8" x 3 1/2" x 6"  
 AIR INFILTRATION BARRIER  
 5/8" EXTERIOR GRADE GYP. BD. SHEATHING  
 TOP OF PARAPET  
 22'-5 1/2" A.F.F.  
 COLD FORMED METAL FRAMING SEE STRUCTURAL DRAWINGS  
 MEMBRANE ROOFING UP AND OVER PARAPET  
 STEEL BEAM - SEE STRUCTURAL DRAWINGS  
 R22 RIGID INSULATION  
 1 1/2" METAL DECK  
 TOP OF STEEL  
 19'-2 1/2" A.F.F.  
 FIBERGLASS R-19 BATT INSULATION  
 BAR JOIST - SEE STRUCTURAL DRAWINGS  
 4 MIL POLY VAPOR BARRIER  
 BRICK VENEER [BR-3]  
 COLD FORMED METAL FRAMING KICKER SEE STRUCTURAL DRAWINGS  
 LAY IN ACOUSTIC CEILING SEE REFLECTED CEILING PLAN  
 LAY IN CEILING  
 17'-5" A.F.F.  
 BRICK SOLDIER COURSE [BR-2]  
 5/8" GYP. BD.  
 BRICK VENEER [BR-3]  
 3 5/8" MTL. STUD AT 16" O.C.  
 SELF TAPPING SCREWS AT EACH CONNECTION, TYP.  
 BRICK SOLDIER COURSE [BR-2]  
 3 5/8" MTL. STUDS AT 16" O.C. (TYP.)  
 4 MIL POLY VAPOR BARRIER  
 FLUORESCENT STRIP LIGHT FIXTURE SEE CEILING PLAN AND ELECTRICAL DRAWINGS FOR MORE INFORMATION  
 BOTTOM OF GYP. BD. SOFFIT  
 17'-5" A.F.F.  
 4 MIL POLY VAPOR BARRIER  
 3 5/8" MTL. STUDS AT 16" O.C. (TYP.)  
 ACRYLIC LENSE (AC-3)  
 BRICK VENEER [BR-3]  
 FIBERGLASS R-19 BATT INSULATION  
 COLD FORMED METAL FRAMING SEE STRUCTURAL DRAWINGS  
 BRICK SOLDIER COURSE [BR-2]  
 5/8" GYP. BD.  
 5/8" DENS-GLASS SHEATHING  
 METAL BRICK TIES @ 16" O.C. EA. WAY  
 AIR SPACE  
 FINISHED FLOORING RE: A-102  
 REINFORCED CONCRETE SLAB RE-S-101  
 VAPOR BARRIER RE-K1/S-101  
 CRUSHED STONE RE-S-101 OR GEOTECHNICAL REPORT  
 FINISH FLOOR  
 0'-0"

REFER TO STRUCTURAL MECHANICAL AND ELECTRICAL REPORT GUIDELINES FOR DEWATERING, UNDERSLAB AND VAPOR BARRIER INSTALLATION, PLACEMENT AND COMPACTION, POSITIONING OF VAPOR BARRIER, ETC...  
 EXTEND UNDERSLAB VAPOR BARRIER VERTICALLY 6" ABOVE FINISHED FLOOR AND TAPE TO WALL VAPOR BARRIER  
 1/2" THERMAL BREAK  
 2" RIGID INSULATION TO EXTEND TO BELT TOP OF FLOOR SLAB, R-8 MIN.  
 FINISHED CONCRETE RESPAWK, SLOPE 2% PER FOOT AWAY FROM BUILDING  
 REINFC. CONCRETE FOUNDATION WALL PER STRUCT. DWGS.  
 CONCRETE FOOTING - SEE STRUCTURAL DRAWINGS

REFER TO STRUCTURAL MECHANICAL AND ELECTRICAL REPORT GUIDELINES FOR DEWATERING, UNDERSLAB AND VAPOR BARRIER INSTALLATION, PLACEMENT AND COMPACTION, POSITIONING OF VAPOR BARRIER, ETC...  
 EXTEND UNDERSLAB VAPOR BARRIER VERTICALLY 6" ABOVE FINISHED FLOOR AND TAPE TO WALL VAPOR BARRIER  
 1/2" THERMAL BREAK  
 2" RIGID INSULATION TO EXTEND TO BELT TOP OF FLOOR SLAB, R-8 MIN.  
 FINISHED CONCRETE RESPAWK, SLOPE 2% PER FOOT AWAY FROM BUILDING  
 REINFC. CONCRETE FOUNDATION WALL PER STRUCT. DWGS.  
 CONCRETE FOOTING - SEE STRUCTURAL DRAWINGS

REFER TO STRUCTURAL MECHANICAL AND ELECTRICAL REPORT GUIDELINES FOR DEWATERING, UNDERSLAB AND VAPOR BARRIER INSTALLATION, PLACEMENT AND COMPACTION, POSITIONING OF VAPOR BARRIER, ETC...  
 EXTEND UNDERSLAB VAPOR BARRIER VERTICALLY 6" ABOVE FINISHED FLOOR AND TAPE TO WALL VAPOR BARRIER  
 1/2" THERMAL BREAK  
 2" RIGID INSULATION TO EXTEND TO BELT TOP OF FLOOR SLAB, R-8 MIN.  
 FINISHED CONCRETE RESPAWK, SLOPE 2% PER FOOT AWAY FROM BUILDING  
 REINFC. CONCRETE FOUNDATION WALL PER STRUCT. DWGS.  
 CONCRETE FOOTING - SEE STRUCTURAL DRAWINGS

A12 WALL SECTION - PERIMETER LOW WALL  
 RE-A3/A-101  
 3/4" = 1'-0"

A7 WALL SECTION - HIGH WALL WITH MEZZANINE  
 RE-A3/A-101  
 3/4" = 1'-0"

A2 WALL SECTION - HIGH WALL WITH GLAZING  
 RE-A3/A-101  
 3/4" = 1'-0"