

BRUCE ROMANNE HAMILTON ARCHITECTS
 ARCHITECTS
 LAND PLANNING
 INTERIOR DESIGN
 VISUALIZATION
 400 N. WASHINGTON
 PORTLAND, ME 04101
 NEW HAMPSHIRE 03011

RITE AID STORE #4122
 WASHINGTON & ALLEN AVENUE
 PORTLAND, MAINE

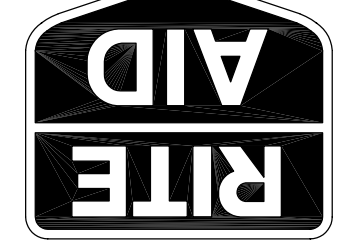

ISSUED FOR BUILDING PERMIT/CC BUILDING
 10-27-06
 REVISIONS

Drawn: [Blank]
 Checked: [Blank]
 Approved: [Blank]
 Project No: 0525
 Date: 10-27-06
 Title: REFLECTED CEILING PLAN

Sheet No. A-103

- SHEET NOTES**
- GYP. BD. SOFFIT
 - OPEN TO STRUCTURE ABOVE.
 - ALIGN FINISH FACE OF SOFFIT WITH FINISH FACE OF WINDOW OPENING.
 - LINE OF MEZZANINE ABOVE.
 - ROOF HATCH.
 - OVERHEAD COILING GRILLE.
 - RECESSED LIGHT FIXTURES IN SOFFIT TO BE CENTERED OVER FIXTURES BELOW (TYP.).
 - LINE OF WALL ABOVE.
 - LINE OF MEZZANINE ABOVE.
 - MANUFACTURER'S SPEC.
 - 30"x30" ACCESS HATCH IN DRIVE THRU PAINT TO MATCH SFT-1.
 - 30" x 30" ACCESS PANEL IN SOFFIT. INSTALL THE ACCESS PANEL IN THE CENTER OF THE SOFFIT. THE INSIDE CORNER WHERE THE TWO SOFFITS MEET.
 - 24" x 24" ACCESS HATCH IN CANOPY. CEILING G.C. TO COORDINATE LOCATION PAINT TO MATCH SFT-1.
 - DIFFUSERS, TILES, AND GRID TO BE PAINTED P-2.
 - 18" x 18" ACCESS HATCH IN CANOPY. CEILING G.C. TO COORDINATE LOCATION PAINT TO MATCH SFT-1.

- GENERAL NOTES**
- TRACK LIGHTS TO BE CENTERED ON GRAPHIC LOCATIONS. SEE GRAPHIC PLACEMENT PLAN FOR MORE INFORMATION.
 - FINAL POSITION OF WALLWASH FIXTURES TO BE VERIFIED WITH GRAPHICS PLAN.
 - CEILING GRID TO BE INSTALLED IN ACCORDANCE W/ ASTM C-636-96. HANGER WIRES TO BE PLUMB TO WITHIN 1/8" OF SQUARE. HANGER WIRES TO BE ATTACHED ACCORDINGLY.
 - REFER TO SHEET A-803 FOR FINISH MATERIAL SCHEDULE.
 - REFER TO SHEET A-803 FOR FINISH MATERIAL SCHEDULE. REFER TO SHEET A-803 FOR FINISH MATERIAL SCHEDULE. REFER TO SHEET A-803 FOR FINISH MATERIAL SCHEDULE.
 - SPRINKLER HEAD LOCATIONS ARE FOR COORDINATION PURPOSE ONLY.
 - FINAL POSITION OF WALLWASH FIXTURES TO BE VERIFIED WITH GRAPHICS PLAN.
 - CEILING GRID TO BE INSTALLED IN ACCORDANCE W/ ASTM C-636-96. HANGER WIRES TO BE PLUMB TO WITHIN 1/8" OF SQUARE. HANGER WIRES TO BE ATTACHED ACCORDINGLY.

LEGEND

- | ROOM NAME | ROOM NUMBER | CEILING HEIGHT | CEILING MATERIAL | CEILING FINISH |
|--|-------------|----------------|------------------|----------------|
| 2x4 CEILING MOUNTED FLUORESCENT LIGHT FIXTURE | | | | |
| 1x8 CEILING MOUNTED RECESSED FLUORESCENT LIGHT FIXTURE | | | | |
| 6"x8 CHAIN HUNG FLUORESCENT LIGHT FIXTURE | | | | |
| 1x8 SURFACE MOUNTED FLUORESCENT LIGHT FIXTURE | | | | |
| 6"x4 AND 6"x8 CEILING SURFACE MOUNTED RECESSED FLUORESCENT LIGHT FIXTURE | | | | |
| CEILING MOUNTED RECESSED DOWN LIGHT | | | | |
| CEILING MOUNTED TRACK LIGHTING | | | | |
| ILLUMINATED EXIT SIGN | | | | |
| CEILING MOUNTED EMERGENCY LIGHT FIXTURE | | | | |
| WALL MOUNTED EMERGENCY LIGHT FIXTURE | | | | |
| EXTERIOR WALL PACK LIGHT FIXTURE MOUNTED MIN. OF 12" ABOVE DOOR | | | | |
| EXTERIOR EMERGENCY LIGHT FIXTURE MOUNTED MIN. OF 24" ABOVE DOOR | | | | |
| SUSPENDED ACOUSTICAL CEILING | | | | |
| GYP. BD. CEILING | | | | |
| MECHANICAL DIFFUSER | | | | |
| MECHANICAL RETURN GRILLE | | | | |
| SPRINKLER HEAD - FINAL LOCATION BY SPRINKLER CONTRACTOR | | | | |
| UP RISE SPRINKLER HEADS - FINAL LOCATION BY SPRINKLER CONTRACTOR | | | | |
| POWERED EXHAUST FAN | | | | |
| UNIT HEATER | | | | |
| SMOKED SECURITY CEILING PANEL | | | | |
| SOUND SYSTEM | | | | |
| AC UNIT | | | | |

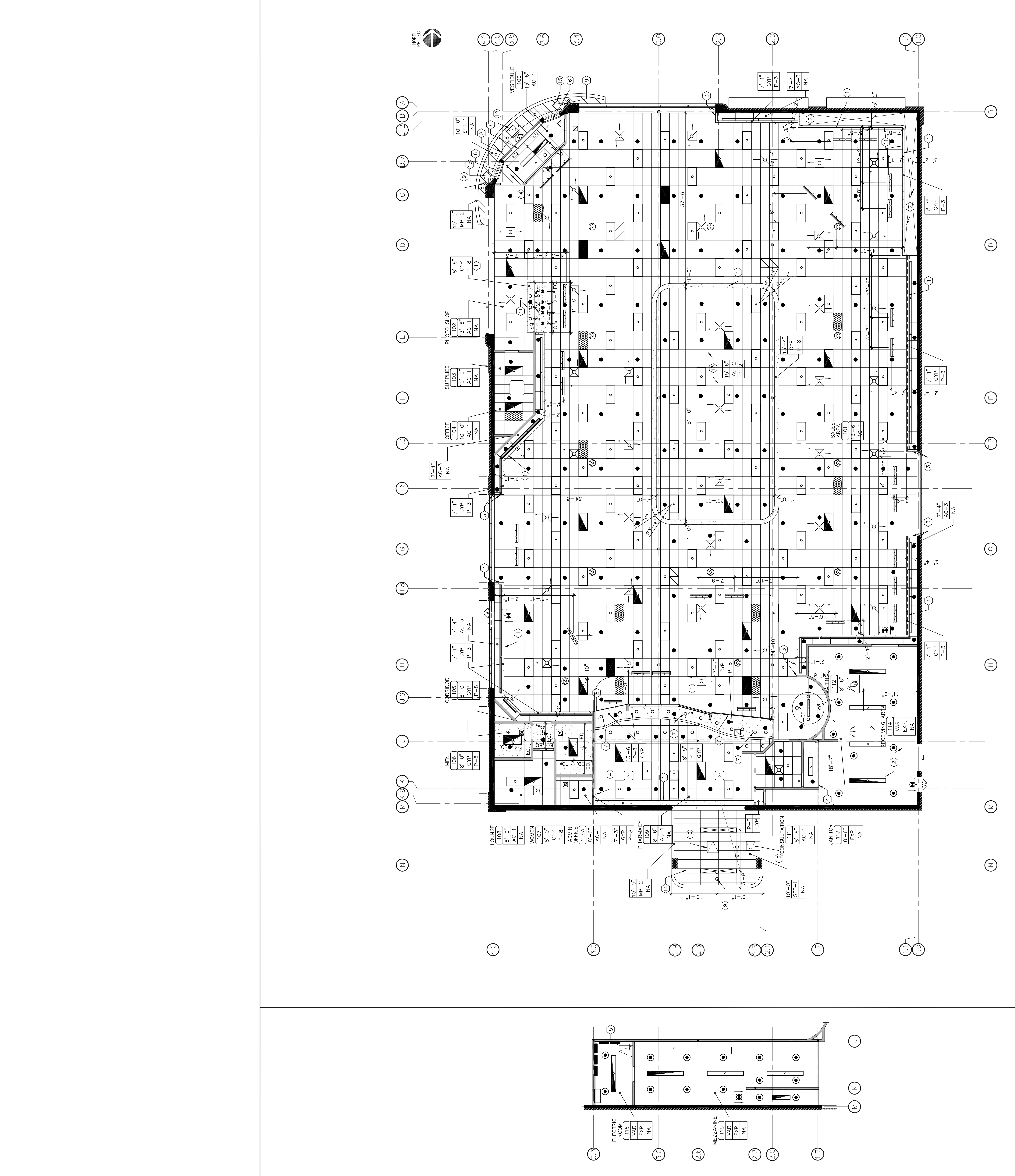

A1 MEZZANINE 1/8" = 1'-0"
A3 REFLECTED CEILING PLAN 1/8" = 1'-0"