

1 PROPOSED FINISH PLAN
 SCALE: 1/8"=1'-0"

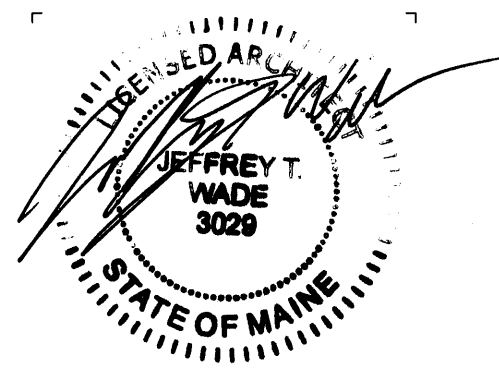
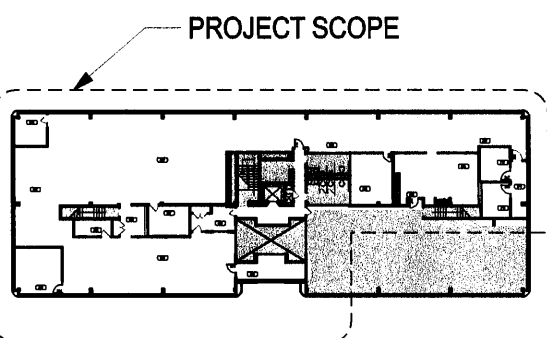

FINISH MATERIAL SCHEDULE

CODE	ITEM	MFR	SPEC.	COLOR	FINISH/INSTALLATION	CONTACT INFO	PRICING
C-1	CARPET BROADLOOM (ETR)	SHAW CONTRACT GROUP	STYLE: 66928	EMPIRE		BUSINESS INTERIORS FLOOR COVERING, INC. 16 EVERBERG ROAD WOBURN, MA 01801 TEL: 781-938-9994 FAX: 781-938-8833 ATTN: PAUL FERRARO	
C-1	CARPET BROADLOOM (PATCH WITH MATCHING ETR CARPET)	SHAW CONTRACT GROUP	STYLE: 66928	EMPIRE	ADHERE CARPET DIRECTLY TO SUB FLOOR W/ GREEN LABEL ADHESIVES IN ACCORDANCE W/ CARPET MANUFACTURER'S INSTALLATION SPECIFICATIONS.	BUSINESS INTERIORS FLOOR COVERING, INC. 16 EVERBERG ROAD WOBURN, MA 01801 TEL: 781-938-9994 FAX: 781-938-8833 ATTN: PAUL FERRARO	CARPET TO BE PURCHASED DIRECTLY BY LIBERTY MUTUAL GROUP THROUGH BUSINESS INTERIORS. INSTALLER RESPONSIBLE TO RECEIVE, STORE, CUT, REDELIVER CARPET TO SITE AND SUPPLY ADHESIVE.
C-2	CARPET BROADLOOM (PO225)	SHAW CONTRACT GROUP	STYLE: 52850	DOVER	ADHERE CARPET DIRECTLY TO SUB FLOOR W/ GREEN LABEL ADHESIVES IN ACCORDANCE W/ CARPET MANUFACTURER'S INSTALLATION SPECIFICATIONS.	BUSINESS INTERIORS FLOOR COVERING, INC. 16 EVERBERG ROAD WOBURN, MA 01801 TEL: 781-938-9994 FAX: 781-938-8833 ATTN: PAUL FERRARO	CARPET TO BE PURCHASED DIRECTLY BY LIBERTY MUTUAL GROUP THROUGH BUSINESS INTERIORS. INSTALLER RESPONSIBLE TO RECEIVE, STORE, CUT, REDELIVER CARPET TO SITE AND SUPPLY ADHESIVE.
VCT-1	VINYL COMP. TILE (ETR)	ETR	STYLE: ETR	ETR		ETR	
VCT-2	VINYL COMP. TILE	THE MOHWAK GROUP	STYLE: STN-840 12X12	BEIGE TAN		MOHAWK VCT: STONELAND ALEX GASBARRO TEL: 508-277-8392	
P-1	POLOMYX	POLOMYX BY ZOLATONE	P2L-C1177	P2L-C1177	WALLS: PATCH WITH MATCHING ETR POLOMYX	POLOMYX BY ZOLATONE 888-ZOLATONE	
P-2	PAINT	BENJAMIN MOORE	AURA	LOUISBURG GREEN HC-113	WALLS: EGGSHELL	BENJAMIN MOORE DIRECT ORDER LINE 877-626-5676 NATIONAL ACCOUNT # 182 (LIBERTY MUTUAL) ACCOUNT REPRESENTATIVE - HOWARD SKELTON 410-409-4074	BIDDERS ARE INSTRUCTED TO BUDGET \$47.00/GALLON PLUS TAX FOR BENJAMIN MOORE AURA PRODUCTS. THIS BUDGET PRICE IS BASED ON LIBERTY MUTUAL GROUP NEGOTIATED RATES W/ BENJAMIN MOORE.
P-3	PAINT	BENJAMIN MOORE	AURA	FOSSIL AF-65	WALLS: EGGSHELL	BENJAMIN MOORE DIRECT ORDER LINE 877-626-5676 NATIONAL ACCOUNT # 182 (LIBERTY MUTUAL) ACCOUNT REPRESENTATIVE - HOWARD SKELTON 410-409-4074	BIDDERS ARE INSTRUCTED TO BUDGET \$47.00/GALLON PLUS TAX FOR BENJAMIN MOORE AURA PRODUCTS. THIS BUDGET PRICE IS BASED ON LIBERTY MUTUAL GROUP NEGOTIATED RATES W/ BENJAMIN MOORE.
PLAM-1	PLASTIC LAMINATE (EXISTING: COPY)	WILSONART LAMINATE	4822-60	BERYL BRUSH		WILSONART LAMINATE 1-800-433-3222	
PLAM-2	PLASTIC LAMINATE	FORMICA LAMINATE	7813-58	CARDBOARD SOLIDZ		FORMICA	
VB-1	VINYL BASE (MATCH EXISTING)	ROPPE	MATCH EXISTING	MATCH EXISTING		ROPPE BRIAN DUBOIS TEL: 1800-537-9527	FOR ALL QUESTIONS/PROBLEMS, CONTACT BRIAN DUBOIS.
CG-1	CORNER GUARD (MATCH EXISTING)	CS GROUP	MATCH EXISTING	CLEAR		CS GROUP	
TS-1	TRANSITION STRIP	JOHNSONITE	MATCH EXISTING	MATCH EXISTING		JOHNSONITE ROXANNE SPEZZAFERRI TEL: 781-258-2837	

FINISH PLAN KEYNOTES

- ① GC TO PROVIDE ONE COAT OF PRIMER ON THIS WALL
- ② INSTALL SALVAGED CARPET TO MATCH & ALIGN WITH EXISTING IN PATTERN & LAYOUT
- ③ GC TO SALVAGE CARPET FROM OFFICE 204, TO EXTENTS OF NEW OFFICE LAYOUT, FOR USE IN NEW CARPET C-1 LOCATIONS

FINISH PLAN NOTES

1. WALLS TO BE PAINTED AS INDICATED.
2. DOORS TO BE STAINED TO MATCH EXISTING. FRAMES TO BE PAINTED AS INDICATED ON DOOR SCHEDULE IN SEMI-GLOSS FINISH.
3. ALL CARPET TO BE AS INDICATED.
4. ALL BASE TO MATCH EXISTING.
5. ALL FLOORING TRANSITIONS AT DOOR OPENING TO OCCUR UNDERNEATH DOOR, U.O.N.
6. FLOOR FINISHES AND WALL BASE TO CONTINUE UNDER COUNTER TOPS, ANY MILLWORK OPENINGS, AND HC KITCHEN SINK CABINETS.
7. PROVIDE TRANSITIONS STRIPS AT ALL LOCATIONS WHERE CARPET AND TILE/SHEET FLOORING MEET. VERIFY COLOR WITH ARCHITECT PRIOR TO INSTALLATION.
8. RESILIENT BASE TO BE STRAIGHT AT CARPETED AREAS AND COVE AT VCT/SHEET FLOORING AREAS.
9. VERIFY FLOOR FINISH LAYOUT WITH ARCHITECT PRIOR TO INSTALLATION. (TILE LAYOUT, SEAMING DIAGRAMS, ETC.)
10. ALL CABINETS SHALL BE PLAM-2, U.O.N. ALL COUNTER TOPS SHALL BE PLAM-1, U.O.N. ALL BACK SPLASHES SHALL BE PLAM-2, U.O.N.
11. REFER TO POWER & SIGNAL PLAN FOR DEVICE & COVER PLATE FINISHES
12. REFER TO REFLECTED CEILING PLAN FOR CEILING FINISHES
13. IN AREAS WHERE NEW PAINT DOESN'T EXTEND FULL LENGTH OF WALL, GC TO FEATHER OUT TRANSITION BETWEEN OLD & NEW TO MAKE SEAM INDISTINGUISHABLE.

ADD Inc

311 SUMMER STREET BOSTON, MA 02210 617.234.1100

ISSUANCES

No.	Description	Date
1	ISSUED FOR PERMIT	12/23/08

Checked by: JE

**Proposed
 Finish
 Plan
 Floor 2**

Drawing Scale: 1/8"=1'-0"

Job No. 08121.00

IA-402