

**1** PROPOSED POWER & SIGNAL PLAN  
 SCALE: 1/8"=1'-0"

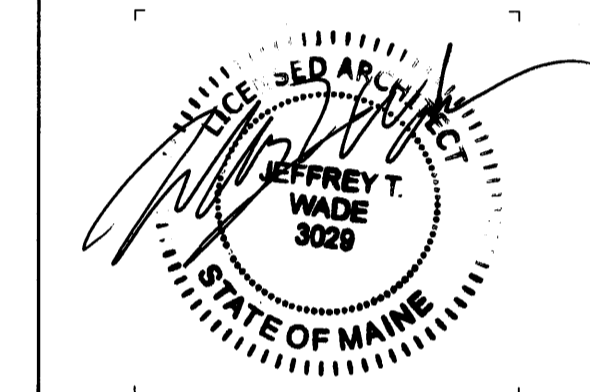
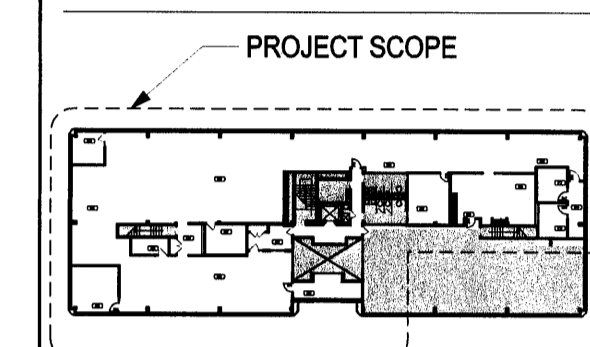

**POWER & SIGNAL PLAN KEYNOTES**

- 1 PROVIDE ADD ALTERNATE PRICE TO INSTALL FLOOR CORES. SEE SPECIFICATIONS FOR FURTHER INFORMATION

**POWER & SIGNAL PLAN LEGEND**

TYPICAL SYMBOL NOMENCLATURE			
"R" DENOTES RELOCATED DEVICE "N" DENOTES NEW DEVICE			
	OUTLET - DEDICATED DUPLEX		DOOR RELEASE BUTTON
	OUTLET - DUPLEX		BUZZER
	OUTLET - QUADRAPLEX		CARD READER
	OUTLET - SPECIAL PURPOSE		ELECTRIC STRIKE
	OUTLET - VOICE		OCCUPANCY SENSOR WALL MOUNTED
	OUTLET - VOICE WALL MOUNTED		ELECTRIC HOLD OPEN
	OUTLET - VOICE/DATA		THERMOSTAT
	EXISTING FEED TO BE RE-WIRED AS INDICATED WALL: POWER # INDICATES FINAL QTY. OF POWERED WORKSTATIONS		OUTLET - QUAD FLOOR MOUNTED
	EXISTING FEED TO BE RE-WIRED AS INDICATED WALL: SIGNAL # INDICATES FINAL QTY. OF POWERED WORKSTATIONS		OUTLET - VOICE/DATA FLOOR MOUNTED
	FIRE ALARM DEVICE, EXISTING TO REMAIN		SWITCH
	CARD READER, EXISTING TO REMAIN		FIRE PULL STATION
			N.I.C.

**POWER & SIGNAL PLAN NOTES**

1. MOUNTING HEIGHTS OF ALL DEVICES ARE SHOWN ON POWER & SIGNAL DEVICE ELEVATION, U.O.N. REFER TO IA-301.
2. ALL OUTLETS AND JACKS TO BE CENTERED ON WALL, U.O.N.
3. LOCATION OF ALL POWER & SIGNAL DEVICES ARE TO BE COORDINATED FROM ARCHITECTURAL DRAWINGS. NOTIFY ARCHITECT OF ANY DISCREPANCIES BETWEEN ARCHITECTURAL AND ELECTRICAL DRAWING PRIOR TO INSTALLATION. REFER TO ENGINEER'S DRAWINGS FOR OTHER REQUIREMENTS.
4. ALL DIMENSIONS ARE FROM FACE OF FINISHED WALL TO CENTERLINE OF SINGLE DEVICE OR CENTER OF GROUP OF DEVICES.
5. ALL OUTLETS TO BE LOCATED AS INDICATED ON PLANS, U.O.N. PROVIDE BRIDGE RACKS AS NEEDED TO ACHIEVE INDICATED LOCATIONS. STAGGER ALL DEVICES SHOWN BACK TO BACK ON OPPOSITE SIDES OF SHARED PARTITIONS. DEVICE SHALL NOT OCCUPY THE SAME STUD CAVITY.
6. COORDINATE ALL FLOOR CORE LOCATIONS WITH ARCHITECT, FURNITURE VENDOR, AND OWNER PRIOR TO CORING. COORDINATE LOCATION SO AS NOT TO INTERFERE WITH STRUCTURAL BEAMS (DO NOT CUT THROUGH BEAMS).
7. ALL OUTLETS LOCATED ABOVE OR BELOW THE COUNTER TOPS IN KITCHEN, COFFEE AREAS, TOILET ROOMS, ETC (WET AREAS) SHALL BE GFI AS PER CODE (REFER TO ELECTRICAL DRAWINGS).
8. GROUP MULTIPLE DEVICES (POWER/SIGNAL) ON WALL TO BE GROUPED NOT MORE THAN 6" APART.
9. MULTIPLE SWITCH OR OUTLET DEVICES IN ONE LOCATION SHALL BE INSTALLED IN A COMMON MULTI-GANG BOX WITH A COMMON FACEPLATE, AS ALLOWED BY CODE.
10. REFER TO ENGINEERING DRAWINGS FOR THERMOSTAT, FIRE HORN, STROBE LIGHT, AND PULL STATION LOCATIONS AND REQUIREMENTS, U.O.N. VERIFY LOCATIONS WITH ARCHITECT PRIOR TO CONSTRUCTION.
11. LOCATE SWITCHES 6" CLEAR OF THE EDGE OF DOOR FRAME, U.O.N. AT DOUBLE DOORS OR DOORS WITH SIDELIGHTS, LOCATE SWITCHES 3'-6" FROM DOOR AT SIDE WALL, U.O.N.
12. ALL MEP-FP DEVICES AND FIRE EXTINGUISHER CABINETS ARE TO BE ALIGNED ON CENTERLINE, U.O.N.
13. WHERE SWITCHES FOR DEVICES OTHER THAN LIGHTS (I.E. EXHAUST FAN, PROJECTION SCREEN) ARE ADJACENT TO LIGHT SWITCHES, LOCATE LIGHT SWITCHES CLOSEST TO THE ENTRY DOOR.
14. FIELD ADJUST ALL WHIPS FOR SYSTEM'S FURNITURE FEEDS TO MINIMIZE EXCESS WHIP TO A MAXIMUM OF 6" BEYOND REQUIRED LENGTH.
15. FINISHES FOR COVER PLATES TO BE S.S. U.O.N. FINISHES FOR DEVICES TO BE WHITE TO MATCH EXISTING

**POWER & SIGNAL TYPICAL MOUNTING HEIGHTS**

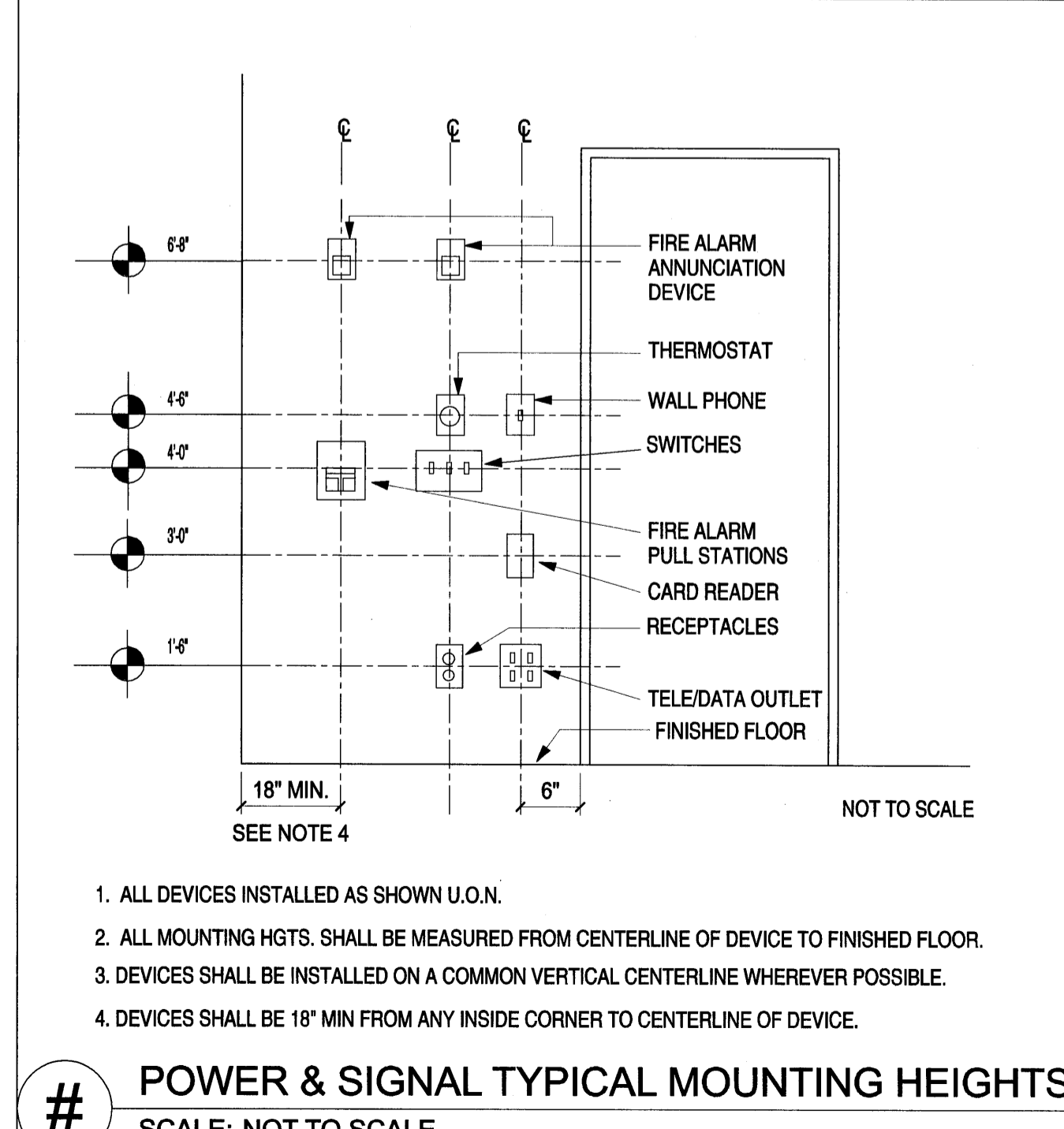

1. ALL DEVICES INSTALLED AS SHOWN U.O.N.
2. ALL MOUNTING HGTS. SHALL BE MEASURED FROM CENTERLINE OF DEVICE TO FINISHED FLOOR.
3. DEVICES SHALL BE INSTALLED ON A COMMON VERTICAL CENTERLINE WHEREVER POSSIBLE.
4. DEVICES SHALL BE 18" MIN FROM ANY INSIDE CORNER TO CENTERLINE OF DEVICE.

**#** POWER & SIGNAL TYPICAL MOUNTING HEIGHTS  
 SCALE: NOT TO SCALE

**ADD Inc**  
 311 SUMMER STREET BOSTON, MA 02210 617.234.3100

**ISSUANCES**

No.	Description	Date
1	ISSUED FOR PERMIT	12/23/08

Checked by: JE

**Proposed Power & Signal Plan Floor 2**

Drawing Scale: 1/8"=1'-0"  
 Job No. 08121.00