

DISPLAY THIS CARD ON PRINCIPAL FRONTAGE OF WORK



CITY OF PORTLAND BUILDING PERMIT

This is to certify that 1321 ASSOCIATES, LLC

Located At 15 NORTHPORT DR

Job ID: 2011-11-2776-SIGN

CBL: 401-A-005-015

has permission to New wall sign & panel replacement

provided that the person or persons, firm or corporation accepting this permit shall comply with all of the provisions of the Statutes of Maine and of the Ordinances of the City of Portland regulating the construction, maintenance and use of the buildings and structures, and of the application on file in the department.

Notification of inspection and written permission procured before this building or part thereof is lathed or otherwise closed-in. 48 HOUR NOTICE IS REQUIRED.

A final inspection must be completed by owner before this building or part thereof is occupied. If a certificate of occupancy is required, it must be

J/A
Fire Prevention Officer

[Signature] 11/29/11
Code Enforcement Officer / Plan Reviewer

THIS CARD MUST BE POSTED ON THE STREET SIDE OF THE PROPERTY
PENALTY FOR REMOVING THIS CARD

BUILDING PERMIT INSPECTION PROCEDURES

Please call 874-8703 or 874-8693 (ONLY)

or email: buildinginspections@portlandmaine.gov

With the issuance of this permit, the owner, builder or their designee is required to provide adequate notice to the city of Portland Inspections Services for the following inspections. Appointments must be requested 48 to 72 hours in advance of the required inspection. The inspection date will need to be confirmed by this office.

- **Please read the conditions of approval that is attached to this permit!! Contact this office if you have any questions.**
- **Permits expire in 6 months. If the project is not started or ceases for 6 months.**
- **If the inspection requirements are not followed as stated below additional fees may be incurred due to the issuance of a "Stop Work Order" and subsequent release to continue.**

Final Inspection

The project cannot move to the next phase prior to the required inspection and approval to continue, REGARDLESS OF THE NOTICE OF CIRCUMSTANCES.

IF THE PERMIT REQUIRES A CERTIFICATE OF OCCUPANCY, IT MUST BE PAID FOR AND ISSUED TO THE OWNER OR DESIGNEE BEFORE THE SPACE MAY BE OCCUPIED.



PORTLAND MAINE

Strengthening a Remarkable City, Building a Community for Life • www.portlandmaine.gov

Director of Planning and Urban Development

Penny St. Louis

Job ID: 2011-11-2776-SIGN

Located At: 15 NORTHPORT DR

CBL: 401- A-005-015

Conditions of Approval:

Building

1. Signage Installation to comply with Chapters 31 & 32 of the IBC 2009 building code.

City of Portland, Maine - Building or Use Permit Application

389 Congress Street, 04101 Tel: (207) 874-8703, FAX: (207) 8716

Job No: 2011-11-2776-SIGN	Date Applied: 11/15/2011	CBL: 401- A-005-015	
Location of Construction: 15 NORTHPORT DR	Owner Name: 1321 ASSOCIATES, LLC	Owner Address: 1976 Washington Avenue Portland, ME 04103	Phone:
Business Name:	Contractor Name: Sign Design, Inc, Roger	Contractor Address: 207 P.O. Box WESTBROOK ME 04098	Phone: (207) -856-2600
Lessee/Buyer's Name:	Phone:	Permit Type: SIGN - PERM - Signage - Permanent	Zone: B-2
Past Use: Offices	Proposed Use: Same - offices - install 3' x 12' building sign & replace panel (11" x 48") in free standing sign "Maine Orthodoxes"	Cost of Work:	CEO District:
		Fire Dept: <input type="checkbox"/> Approved <input type="checkbox"/> Denied <input checked="" type="checkbox"/> N/A Signature:	Inspection: Use Group: Type: Sisa Signature: <i>ABM 11/21/11</i>
Proposed Project Description: New wall sign & panel replacements		Pedestrian Activities District (P.A.D.)	
Permit Taken By:		Zoning Approval	

1. This permit application does not preclude the Applicant(s) from meeting applicable State and Federal Rules.
2. Building Permits do not include plumbing, septic or electrical work.
3. Building permits are void if work is not started within six (6) months of the date of issuance. False informatin may invalidate a building permit and stop all work.

Special Zone or Reviews

- ☐ Shoreland
☐ Wetlands
☐ Flood Zone
☐ Subdivision
☐ Site Plan
☐ Maj ☐ Min ☐ MM

Date: OK
11/21/11 *ABM*

Zoning Appeal

- ☐ Variance
☐ Miscellaneous
☐ Conditional Use
☐ Interpretation
☐ Approved
☐ Denied

Date:

Historic Preservation

- ☒ Not in Dist or Landmark
☐ Does not Require Review
☐ Requires Review
☐ Approved
☐ Approved w/Conditions
☐ Denied

Date: *ABM*

CERTIFICATION

I hereby certify that I am the owner of record of the named property, or that the proposed work is authorized by the owner of record and that I have been authorized by the owner to make this application as his authorized agent and I agree to conform to all applicable laws of this jurisdiction. In addition, if a permit for work described in the appication is issued, I certify that the code official's authorized representative shall have the authority to enter all areas covered by such permit at any reasonable hour to enforce the provision of the code(s) applicable to such permit.

SIGNATURE OF APPLICANT

ADDRESS

DATE

PHONE

RESPONSIBLE PERSON IN CHARGE OF WORK, TITLE

DATE

PHONE



Signage/Awning Permit Application

If you or the property owner owes real estate or personal property taxes or user charges on any property within the City, payment arrangements must be made before permits of any kind are accepted.

Location/Address of Construction: 1321 Washington Ave. (15 North Portland)		
Tax Assessor's Chart, Block & Lot Chart# 402 Block# A Lot# 22	Owner: 1321 Associates LLC 1976 Washington Portland 04103	Telephone:
Lessee/Buyer's Name (If Applicable) 401 - A - 005 015	Contractor name, address & telephone: SIGN DESIGN, INC. P.O. Box 207 WESTBROOK, ME 04098	Total s.f. of signage x \$2.00 Per s.f. plus \$30.00/\$65.00 For H.D. signage= Total Fee: \$ Awning Fee= cost of work Total Fee: \$
Who should we contact when the permit is ready: DIANA/ROGER phone: 856-2600		
Tenant/allocated building space frontage (feet): Length: 65' Height: 25'		
Lot Frontage (feet) Single Tenant or Multi Tenant Lot		
Current Specific use: OFFICES		
If vacant, what was prior use:		
Proposed Use:		
Information on proposed sign(s):		
Freestanding (e.g., pole) sign? Yes No Dimensions proposed: Height from grade:		
Bldg. wall sign? (attached to bldg) Yes <input checked="" type="checkbox"/> No Dimensions proposed: 3' x 12' 36 s.f.		
2 5/8 panel replacements 11" x 48" 3.67 s.f.		
Proposed awning? Yes No <input checked="" type="checkbox"/> Is awning backlit? Yes No		
Height of awning: Length of awning: Depth:		
Is there any communication, message, trademark or symbol on it? Yes No		
If yes, total s.f. of panels w/communications, message, trademark or symbol: s.f.		
Information on existing and previously permitted sign(s):		
Freestanding (e.g., pole) sign? Yes No Dimensions:		
Bldg. wall sign? (attached to bldg) Yes No Dimensions:		
Awning? Yes No Sq. ft. area of awning w/communication:		
A site sketch and building sketch showing exactly where existing and new signage is located must be provided.		
Sketches and/or pictures of proposed signage and existing building are also required.		

Please submit all of the information outlined in the Sign/Awning Application Checklist.
Failure to do so may result in the automatic denial of your permit.

In order to be sure the City fully understands the full scope of the project, the Planning and Development Department may request additional information prior to the issuance of a permit. For further information visit us on-line at www.portlandmaine.gov, stop by the Building Inspections office, room 315 City Hall or call 874-8703.

I hereby certify that I am the Owner of record of the named property, or that the owner of record authorizes the proposed work and that I have been authorized by the owner to make this application as his/her authorized agent. I agree to conform to all applicable laws of this jurisdiction. In addition, if a permit for work described in this application is issued, I certify that the Code Official's authorized representative shall have the authority to enter all areas covered by this permit at any reasonable hour to enforce the provisions of the codes applicable to this permit.

Signature of applicant: Diana Olmstead

Date: 11/15/11

This is not a permit; you may not commence ANY work until the permit is issued.

B-2

65x-15= 97.5'

36' proposed

010

11-28-11
36 x 2+30 102

RECEIVED
NOV 15 2011
Dept. of Building Inspections
City of Portland Maine



CITY OF PORTLAND, MAINE

Department of Building Inspections

Original Receipt

11 / 15 20 11

Received from _____

Location of Work

867 Riverside
26-B-2

1-21-2011
402122

Cost of Construction \$ _____

Building Fee: _____

Permit Fee \$ _____

Site Fee: _____

Certificate of Occupancy Fee: _____

Total: 271

Building (IL) _____ Plumbing (IS) _____ Electrical (I2) _____ Site Plan (U2) _____

Other

Signs x2

CBL: _____

Check #: 600

Total Collected \$ 271

**No work is to be started until permit issued.
Please keep original receipt for your records.**

Taken by: [Signature]

WHITE - Applicant's Copy

YELLOW - Office Copy

PINK - Permit Copy

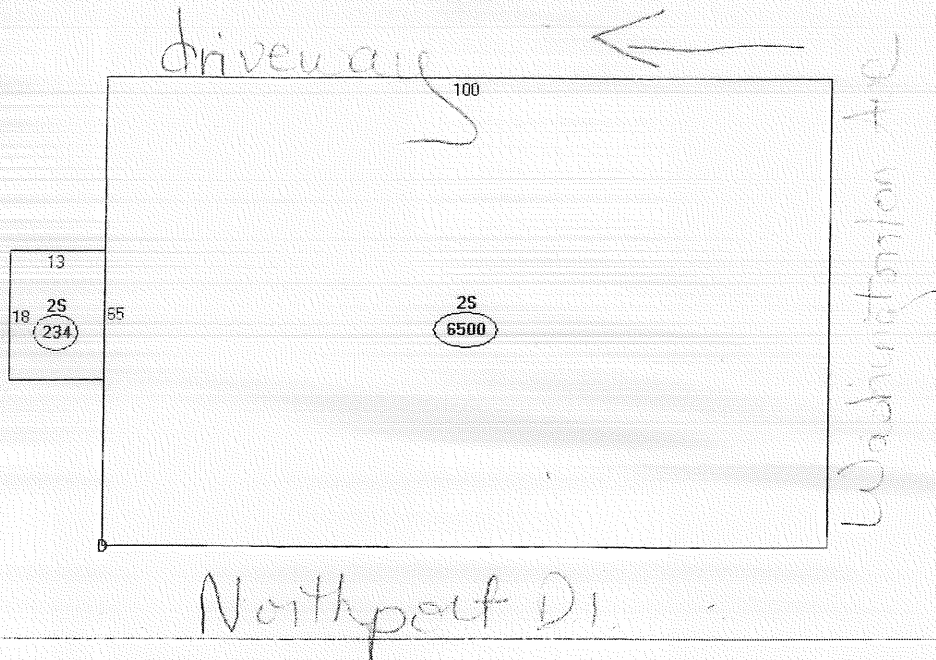

Descriptor/Area	
A: 053	6500 sqft
B: 053	6734 sqft
C: 053	6734 sqft
D: ELEVATOR ELECTRIC PASNGR	312500 sqft
E: 25	6500 sqft
F: 25	234 sqft

RECEIVED

NOV 29 2011

Dept. of Building Inspections
City of Portland Maine



Address **Fobes Street / Washington Avenue**

Address is approximate

Save trees. Go green!

Download Google Maps on your phone at google.com/gmm



↑
parking lot →

Drive

← Washington Ave →

This Design Is Provided By **Sign Design Inc.**

306 Warren Ave. Portland, ME

Phone: 207.856.2600 Fax: 207.856.7600

signdesi@maine.rr.com

Single Sided, Interior Illuminated Sign Cabinet With Lexan Facce And Vinyl Graphics



Double Sided 1/2" Thick Logo Panel



This proof may reflect color shifts due to the color conversion from ink to paint and or vinyl. Also, PMS colors will be approximated to the best of our ability.

Customer supplied artwork files (300 dpi required) will be used as is, and Sign Design Inc. is not responsible for any faults in the design.

Any black outlines appearing on this proof are for representation only. They are to distinguish sign components such as borders, retainers, faces and reveals. Unless otherwise specified, they are not considered as part of the sign graphics.

Sign Design Inc. is not responsible for errors occuring due to improper review of this submitted proof.

Client: Maine Orthodontics Rev. 1

File: maine ortho

Date: 10.28.11

Approval:

Design By: E.F.C. Comp. 1

Customer approval is a signed confirmation that dimensions, colors, spelling, graphics and all other job specifics are correct.

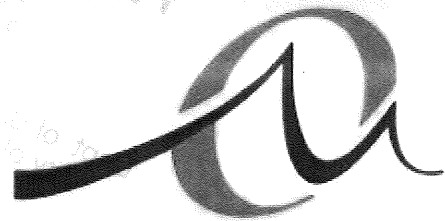

Maine
Orthodontics

STEGEMANN • SHUMAN • RAZZAGHI

left side of en-
trance-Washing-
ton Ave. side

1321

Washington Avenue

T.A. Stegemann D.M.D. Orthodontist

J.B. Shuman D.M.D. Orthodontist

Dr. J. Fazeli & Assoc. Maine Geriatrics

Dr. Joseph M. Hayes Intergrated Chiropractic

Glacial Multimedia, Inc.

First Portland Mortgage Corp.



Sign Contractors

P.O. Box 20
Westbrook, ME 04092
207-858-1500 • FAX (207) 846-1500
• 800-442-1037
Signage • Signs • 2011
A Full Service Sign Company

RE:

To Whom It May Concern:

As the owner (or owner representative) of the property located at:

321 Washington Ave
Portland, Maine 04101

I authorize Sign Design Inc. to install signs/sign face replacements
as detailed on attached paperwork.

Peter Haglund
Signature

11-22-11
Date

Peter Haglund
Print Name

RECEIVED

NOV 29 2011

Dept. of Building Inspections
City of Portland Maine