

1

SIGN SPECIFICATIONS

- OVERALL DIMENSIONS OF SIGN :
HEIGHT : 104.750'
WIDTH : 91.250'
DEPTH : 7.5'
- AREA OF SIGN - SQUARED : 66.37 SQ.FT.
- LUMENS:
MENU BOARD: 7,095
- LEDS :
MENU BOARD: 33-FT 4100K
- POWER SUPPLY : (2) 60-WATT (0.96 AMPS EA)
- TOTAL LINE LOAD: 1.92 AMPS @ 120VAC
- (1) 15 AMP CIRCUIT, 60HZ UL 48 & NEC COMPLIANT
- SIGN IS MANUFACTURED TO UL 48 SPECIFICATIONS.
- PAINT SPECIFICATIONS : (SIGN)
INTERIOR : MILL FINISH
EXTERIOR CABINET : BRONZE, TIGER DRY-LAC 49/66230_33
EXTERIOR DOORS AND FRONT : SATIN BLACK
- MAXIMUM DESIGN WIND LOAD :
100 MPH WIND SPEED -EXPOSURE C.
- CRATED WEIGHT: 745 LBS
- SIGN WILL BE SERVICEABLE BY OPENING DOOR PANELS TO SERVICE LEDS AND POWER SUPPLY.
- DESIGN SPECIFICATION:
3,000 P.S.I. CONCRETE 0.61 CU. YDS.

INSTALLATION INSTRUCTIONS

- OPEN PACKAGING CAREFULLY AND INSPECT FOR DAMAGE. IF DAMAGE IS FOUND, CLAIM MUST BE FILED WITHIN 15-DAYS WITH SHIPPING AGENT.
- MARK FOUNDATION AREA AND RECEIVE CONFIRMATION FROM CLIENT OR CONTRACTOR.
- EXCAVATE FOUNDATION AREA.
- ALL DESIGN AND CONSTRUCTION OF FOUNDATION MUST BE ACCORDING TO ACI 318-99 REQUIREMENTS.
- SET COLUMN AND ANCHOR BOLTS PLUMB IF REQUIRED, INSTALL CONDUIT STUB AND POUR CONCRETE.
- ALLOW CONCRETE TO CURE; EXCAVATIONS MUST CURE UNDER PROPER CONDITIONS FOR 7-DAYS PRIOR TO ANY INSTALLATION. COMPRESSIVE STRENGTH AT 28 DAYS, F'c= 3,000 PSI MINIMUM.
- INSTALL POLE AND / OR SIGN.
- MAKE FINAL ELECTRICAL HOOK UP TO PRIMARY WIRING INTO WEATHER PROOF BOX, SUPPLIED BY INSTALLER.
- ELECTRICAL NOTE: ALL WIRING AND ELECTRICAL CONNECTIONS ON THIS SIGN MUST BE INSTALLED IN ACCORDANCE WITH THE REQUIREMENTS OF ARTICLE 600 OF THE NATIONAL ELECTRICAL CODES AND/OR OTHER APPLICABLE LOCAL CODES. THIS INCLUDES PROPER GROUNDING AND BONDING OF THE SIGN.
- PAINT THE POLE AND/OR ANY OTHER APPLICABLE AREAS, AS STATED ON THE PURCHASE ORDER, PERFORM ANY OTHER TOUCH UP AS REQUIRED.
- REMOVE LIFTING BRACKETS FROM TOP OF SIGN.
- TEST LIGHT THE SIGN AND CHECK FOR PROPER ILLUMINATION
- CLEAN UP! CLEAN INSTALLATION WORK SITE OF ALL EXCESS MATERIALS AND DEBRIS.
CLEAN UP NOTE: DO NOT DISCARD ANY MATERIAL OR DIBRIS INTO ON SITE DUMPSTERS.

x=0.85/DESIGN NOTE:
CONCRETE BASE DESIGN IS BASED ON 100 MPH, EXPOSURE-C GUST DESIGN WIND SPEED PER IBC 2006, EXPOSURE C. CONCRETE FOUNDATION DESIGNED USING A LATERAL SOIL BEARING PRESSURE OF 150 PSF/LF IF THESE SOIL CONDITIONS DO NOT EXIST AT THE FOUNDATION LOCATION, IT IS THE ERECTOR'S RESPONSIBILITY TO NOTIFY EVERBRITE, LLC PRIOR TO PERFORMING ADDITIONAL EXCAVATION OR ANY CONCRETE PLACEMENT.

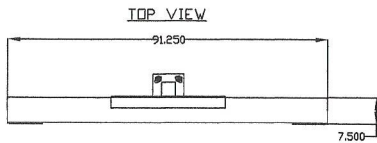

TOP VIEW

INSTALLATION NOTE: ASSURE THE DRIVE THRU MENU BOARD IS LEVEL BOTH VERTICALLY AND HORIZONTALLY DURING THE INSTALLATION PROCESS.

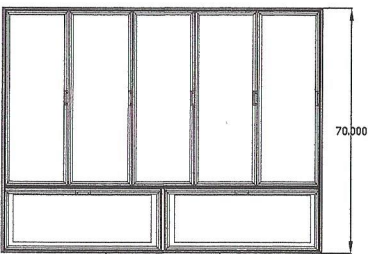

FRONT VIEW

LED LAYOUT AND WIRING DIAGRAM

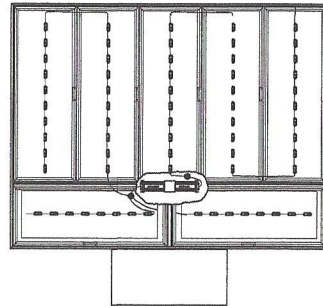

LED LAYOUT AND WIRING DIAGRAM

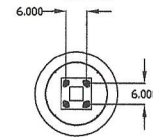
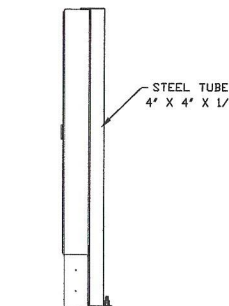

FOUNDATION WITH BASE PLATE

FOUNDATION KIT SOLD SEPARATELY:



(4) 3/4"X36" ANCHOR BOLTS

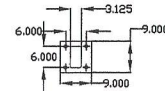

(1) PLYWOOD ANCHOR BOLT MOUNTING TEMPLATE

TO ORDER USE ITEM# KT01723P

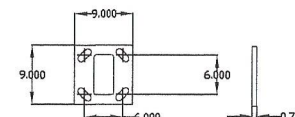

BASE PLATE

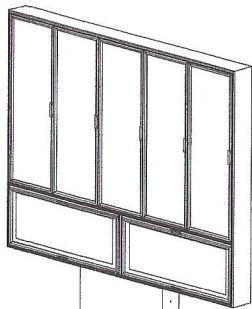

ISO VIEW

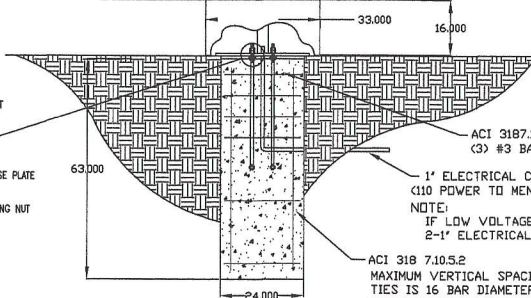
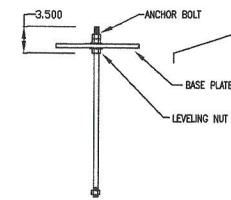

1" ELECTRICAL CONDUIT (110 POWER TO MENU BOARD)

NOTE: IF LOW VOLTAGE WIRING IS REQUIRED, 2-1" ELECTRICAL CONDUITS MUST RUN

ACI 318 7.10.5.2

MAXIMUM VERTICAL SPACING OF TIES IS 16 BAR DIAMETERS OR 8" COULD GO TO 10" IF YOU USE #5 BARS VERTICAL

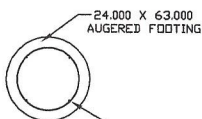

24.000 X 63.000 AUGERED FOOTING

3' COVER REQUIRED BETWEEN REBAR AND SOIL, NEED 18" CIRCLE



THIS IS AN ORIGINAL UNPUBLISHED DRAWING CREATED FOR YOUR PERSONAL USE IN CONNECTION WITH A PROJECT PLANNED FOR YOU BY CUMMINGS. IT IS NOT TO BE SHOWN OUTSIDE YOUR ORGANIZATION NOR USED, REPRODUCED, COPIED OR EXHIBITED IN ANY FASHION UNLESS AUTHORIZED IN WRITING BY AN OFFICER OF CUMMINGS.

CUSTOMER APPROVAL: _____

DATE: _____

Rev. #1	DATE	BY
Rev. #2	2-13-17	T. Pickel
Rev. #3	2-23-17	T. Pickel

Rev. #4	DATE	BY
Rev. #5	2-24-17	T. Pickel
Rev. #6		



1363 WASHINGTON AVE.,
PORTLAND, ME

DRAWING NO:
81840.04

ARTIST: T. Pickel DATE: 1-22-16
SHEET: 12 OF 13