

ROUGH OPENINGS ARE NOT NECESSARILY TO STUD. SEE DETAILS ON SHEET A6.1 FOR R.O. LOCATIONS.

FLOOR PLAN 1/4"=1'-0" **A**

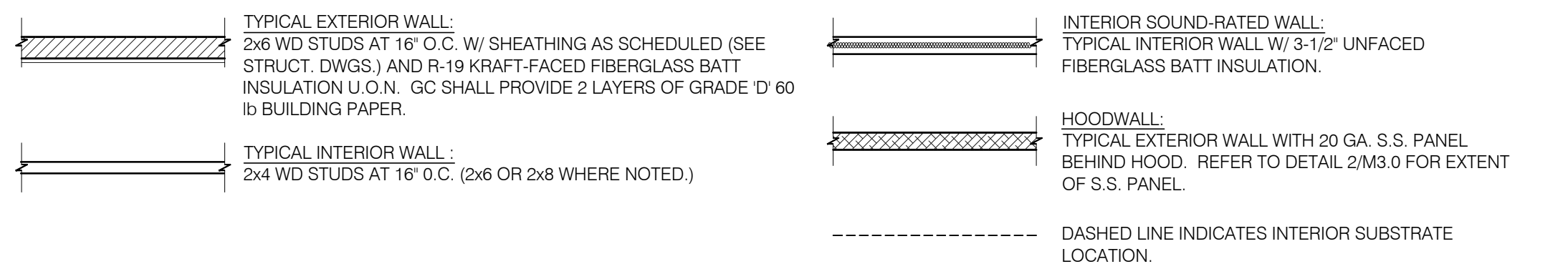

WALL LEGEND **E**

DIMENSIONS:
 A. ALL DIMENSIONS ARE TO FACE OF STUD U.O.N. REFER TO FOUNDATION PLAN FOR FACE OF CONC. DIMENSIONS.
 B. DIMENSIONS NOTED AS "CLEAR" OR "HOLD" ARE MIN. REQ'D. NET CLEARANCE FROM FACE OF WALL / WAINSCOT FINISH. VERIFY FINAL EQUIPMENT SIZES W/ VENDOR PRIOR TO INT. WALL FRAMING.
WINDOWS / DOORS:
 A. SEE SHT. A1.1 FOR WINDOW TYPES AND DOOR SCHEDULE.
 B. ALL DOOR AND WINDOW OPENING DIMENSIONS ARE TO ROUGH OPENING.
FINISH SUBSTRATES:
 A. PROVIDE 1/2" THICK CEMENTITIOUS BD. FROM FLOOR SLAB TO 12" A.F.F. MIN. IN LIEU OF GYP. BD. AT ALL WALLS EXCEPT SHEARWALL SURFACES. U.O.N.
 B. ALL JOINTS, GAPS OR SPACES LEADING TO ALL HOLLOW OR INACCESSIBLE SPACES SHALL BE SEALED WITH "NSF INTERNATIONAL" APPROVED SEALANTS.
 C. ALL BACK OF HOUSE AND OFFICE WALLS SHALL HAVE 1/2" CDX PLYWOOD SUBSTRATE. U.O.N.
DECOR:
 A. SEE A2.0 FOR SEATING PLAN AND DETAILS.
 B. SEE A7.0 FOR FLOOR FINISHES.
 C. SEE A8.0 - A8.3 FOR WALL FINISHES.
 D. SEE A7.1 FOR CEILING FINISHES.
GENERAL:
 A. PROVIDE THREE FIRE EXTINGUISHERS - (2) 10 lb. BC and (1) 10 lb. ABC - TO COMPLY WITH LOCAL FIRE CODE. LOCATE PER DIRECTION OF FIRE MARSHALL OR LOCAL AUTHORIZING AGENT.
 B. DRAWINGS ARE BASED UPON WOOD FRAMING. UTILIZATION OF METAL STUDS ON NON-BEARING INTERIOR PARTITIONS, BULKHEADS AND SOFFITS IS ACCEPTABLE.
 C. ALL ATTACHMENTS MADE THROUGH E.I.F.S. SHALL BE BUSHED TO PREVENT DAMAGE TO THE FINISH. PER 9/A6.2
 D. ALL PENETRATIONS THROUGH E.I.F.S. SHALL BE SEALED USING MFRS. APPROVED METHOD.

FLOOR PLAN NOTES **D**

- 1 STARTING POINT. ALL SUB-TRADES SHALL USE THIS POINT AS A BEGINNING LAY-OUT (INSIDE FACE OF EXT. WALL STUDS).
- 2 NO FRP BEHIND WALK-IN COOLER/FREEZER.
- 3 PIPE BOLLARD. SEE DETAIL 8/C1.0.
- 4 HOOD WALL. SEE WALL LEGEND.
- 5 ELECTRICAL MAIN SWITCH BOARD. REFER TO ELECT. DWGS.
- 6 CO2 FILL BOX LOCATION. SEE DETAIL 5/A6.2.
- 7 TILE TO CONCRETE METAL THRESHOLD.
- 8 KEEP CLEAR FOR UTILITIES & SYRUP LINES. SEE DETAIL 14 & 19/A6.4 FOR STUD LAYOUT REQUIREMENTS.
- 9 MOP SINK. REFER TO SHEET A2.0 & A2.1.
- 10 S.S. CORNER GUARD / WALL CAP. TYP. ALL CORNERS IN BACK-OF-HOUSE FROM REAR WALL TO THE KITCHEN SIDE OF THE SERVICE COUNTER. SEE DETAIL 19/A6.3.
- 11 ELECT. PANELS RECESSED IN 2x6 WALL.
- 12 LIGHTING CONTROL PANEL SURFACE MOUNTED. REFER TO ELECT. DWGS.
- 13 SYRUP LINE CHASE (ABOVE). SEE DETAIL 19/A6.4.
- 14 6"x6" HORIZONTAL OPENING FOR SYRUP TUBES. COORDINATE WALL PENETRATION WITH COUNTER INSTALLER. SEAL CHASE TO COUNTER. SEE 11/A6.4.
- 15 ROOF LADDER SEE 7/A6.0.
- 16 NOT USED.
- 17 METAL STUDS REQUIRED PER LOCAL CODES.
- 18 GC SHALL PROVIDE 20GA STAINLESS STEEL PANEL - EXTEND 18" ON BOTH SIDES OF HOOD FROM BASE TO BOTTOM OF HOOD.
- 19 INDICATES WATER HEATER LOCATION. COMES WITH METAL STAND.
- 20 SPLASHGUARD. SEE DETAIL 9/A6.3. INSTALLATION SHALL BE COORDINATED WITH INSTALLATION OF MOP SINK.
- 21 NOT USED.
- 22 NOT USED.
- 23 CASED OPENING. REFER TO DETAIL 6/A6.4. DOOR OPTIONAL. REFER TO DOOR SCHEDULE ON A1.1 (DOOR #6).

KEY NOTES **B**



MARK D. MCCLUGGAGE AIA, CCS
 1525 E. Douglas Wichita, KS 67211
 Tel: (316) 265-5846
 Fax: (316) 265-5846
 www.dmv.com
 MAINE LIC # RRC02323

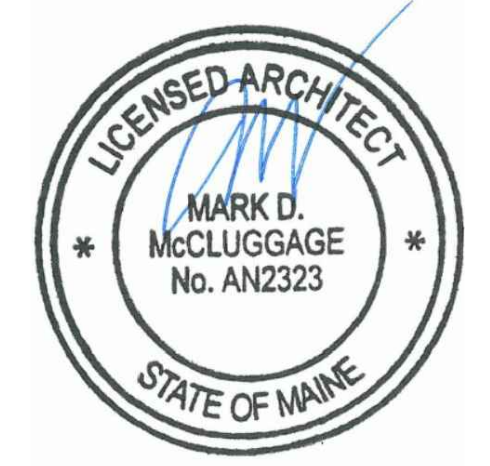

07/14/16

15034.000

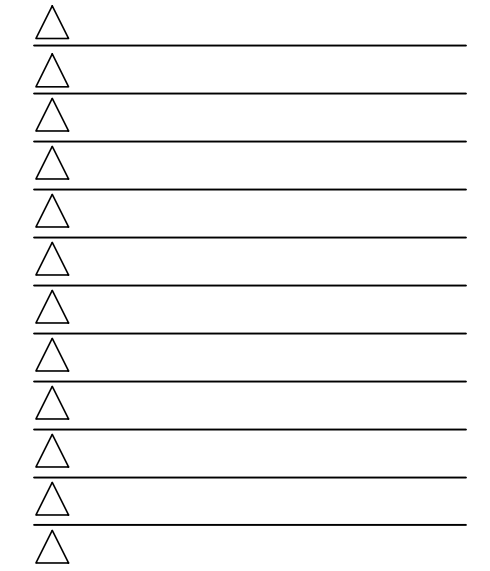

CONTRACT DATE: 07.06.2016
 BUILDING TYPE: CONVERSION
 PLAN VERSION: FEBRUARY 2015
 SITE NUMBER: XXX-XXX
 STORE NUMBER: XXXXX

TACO BELL
 1363 WASHINGTON AVE.
 PORTLAND, ME



FLOOR PLAN
A1.0

PLOT DATE: