

**ROUGH OPENINGS ARE NOT NECESSARILY TO STUD. SEE DETAILS ON SHEET A6.1 FOR R.O. LOCATIONS.**

**FLOOR PLAN** 1/4"=1'-0" **A**

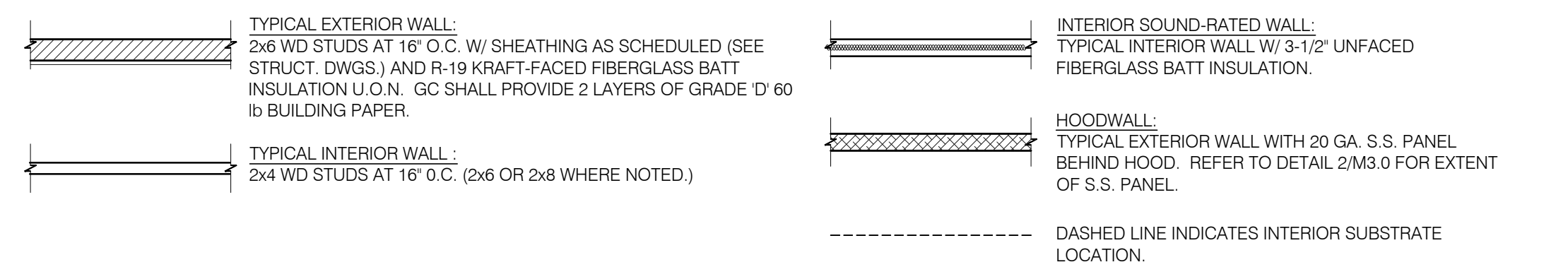

**WALL SUBSTRATES:**  
 - DINING ROOM:  
 1/2" GYPSUM WALLBOARD FROM T.O. CURB TO 6" ABOVE CEILING HEIGHT U.O.N. SEE 6, 8 & 16 / A6.3. (NOTE: THE CEMENT BOARD SPECIFICATION IS DESIGNED TO ALLOW THE G.C. FLEXIBILITY.)  
 - KITCHEN WALLS AND DINING ROOM CLOSET:  
 1/2" CEMENT WALLBOARD FROM T.O. SLAB TO 12" A.F.F. WITH 1/2" CDX PLYWOOD W/FRP SURFACE FINISH FROM T.O. CEMENT BOARD TO 6" ABOVE CEILING HEIGHT U.O.N. IF DOUBLE SIDED SHEAR WALL PLYWD IS SPECIFIED THE PLYWOOD SHALL BE CONTINUOUS FROM SILL PLATE TO TOP PLATE. SEE 4, 11 & 20 / A6.3.  
 - RESTROOM WALLS:  
 5/8" CEMENT WALLBOARD FROM T.O. SLAB OR T.O. CONCRETE CURB TO 48" A.F.F. WITH 5/8" HI-IMPACT BRAND XP WALLBOARD, TYPE X CORE FROM T.O. CEMENT BOARD TO 6" ABOVE CEILING HEIGHT U.O.N.. NO SUBSTITUTIONS ALLOWED. FINISH AS SCHEDULED. SEE 11 (SIM), 12 / A6.3.  
 - ALL OTHER FRAME WALL CONDITIONS:  
 1/2" CEMENT WALLBOARD FROM T.O. SLAB OR T.O. CONCRETE CURB TO 48" A.F.F., WITH 1/2" GYPSUM WALLBOARD FROM T.O. CEMENT BOARD TO 6" ABOVE CEILING HEIGHT U.O.N. FINISH AS SCHEDULED.

**WALL LEGEND** **E**

**DIMENSIONS:**  
 A. ALL DIMENSIONS ARE TO FACE OF STUD U.O.N. REFER TO FOUNDATION PLAN FOR FACE OF CONC. DIMENSIONS.  
 B. DIMENSIONS NOTED AS "CLEAR" OR "HOLD" ARE MIN. REQ'D. NET CLEARANCE FROM FACE OF WALL / WAINSCOT FINISH. VERIFY FINAL EQUIPMENT SIZES W/ VENDOR PRIOR TO INT. WALL FRAMING.  
**WINDOWS / DOORS:**  
 A. SEE SHT. A1.1 FOR WINDOW TYPES AND DOOR SCHEDULE.  
 B. ALL DOOR AND WINDOW OPENING DIMENSIONS ARE TO ROUGH OPENING.  
**FINISH SUBSTRATES:**  
 A. PROVIDE 1/2" THICK CEMENTITIOUS BD. FROM FLOOR SLAB TO 12" A.F.F. MIN. IN LIEU OF GYP. BD. AT ALL WALLS EXCEPT SHEARWALL SURFACES. U.O.N.  
 B. ALL JOINTS, GAPS OR SPACES LEADING TO ALL HOLLOW OR INACCESSIBLE SPACES SHALL BE SEALED WITH "NSF INTERNATIONAL" APPROVED SEALANTS.  
 C. ALL BACK OF HOUSE AND OFFICE WALLS SHALL HAVE 1/2" CDX PLYWOOD SUBSTRATE. U.O.N.  
**DECOR:**  
 A. SEE A2.0 FOR SEATING PLAN AND DETAILS.  
 B. SEE A7.0 FOR FLOOR FINISHES.  
 C. SEE A8.0 - A8.3 FOR WALL FINISHES.  
 D. SEE A7.1 FOR CEILING FINISHES.  
**GENERAL:**  
 A. PROVIDE THREE FIRE EXTINGUISHERS - (2) 10 lb. BC and (1) 10 lb. ABC - TO COMPLY WITH LOCAL FIRE CODE. LOCATE PER DIRECTION OF FIRE MARSHALL OR LOCAL AUTHORIZING AGENT.  
 B. DRAWINGS ARE BASED UPON WOOD FRAMING. UTILIZATION OF METAL STUDS ON NON-BEARING INTERIOR PARTITIONS, BULKHEADS AND SOFFITS IS ACCEPTABLE.  
 C. ALL ATTACHMENTS MADE THROUGH E.I.F.S. SHALL BE BUSHED TO PREVENT DAMAGE TO THE FINISH. PER 9/A6.2.  
 D. ALL PENETRATIONS THROUGH E.I.F.S. SHALL BE SEALED USING MFRS. APPROVED METHOD.

**FLOOR PLAN NOTES** **D**

- 1 STARTING POINT. ALL SUB-TRADES SHALL USE THIS POINT AS A BEGINNING LAY-OUT (INSIDE FACE OF EXT. WALL STUDS.)
- 2 NO FRP BEHIND WALK-IN COOLER/FREEZER.
- 3 PIPE BOLLARD. SEE DETAIL 8/C1.0.
- 4 HOOD WALL. SEE WALL LEGEND.
- 5 ELECTRICAL MAIN SWITCH BOARD. REFER TO ELECT. DWGS.
- 6 CO2 FILL BOX LOCATION. SEE DETAIL 5/A6.2.
- 7 TILE TO CONCRETE METAL THRESHOLD.
- 8 KEEP CLEAR FOR UTILITIES & SYRUP LINES. SEE DETAIL 14 & 19/A6.4 FOR STUD LAYOUT REQUIREMENTS.
- 9 MOP SINK. REFER TO SHEET A2.0 & A2.1.
- 10 S.S. CORNER GUARD / WALL CAP. TYP. ALL CORNERS IN BACK-OF-HOUSE FROM REAR WALL TO THE KITCHEN SIDE OF THE SERVICE COUNTER. SEE DETAIL 19/A6.3.
- 11 ELECT. PANELS RECESSED IN 2x6 WALL.
- 12 LIGHTING CONTROL PANEL SURFACE MOUNTED. REFER TO ELECT. DWGS.
- 13 SYRUP LINE CHASE (ABOVE). SEE DETAIL 19/A6.4.
- 14 6"x6" HORIZONTAL OPENING FOR SYRUP TUBES. COORDINATE WALL PENETRATION WITH COUNTER INSTALLER. SEAL CHASE TO COUNTER. SEE 11/A6.4.
- 15 ROOF LADDER SEE 7/A6.0.
- 16 NOT USED.
- 17 METAL STUDS REQUIRED PER LOCAL CODES.
- 18 GC SHALL PROVIDE 20GA STAINLESS STEEL PANEL - EXTEND 18" ON BOTH SIDES OF HOOD FROM BASE TO BOTTOM OF HOOD.
- 19 INDICATES WATER HEATER LOCATION. COMES WITH METAL STAND.
- 20 SPLASHGUARD. SEE DETAIL 9/A6.3. INSTALLATION SHALL BE COORDINATED WITH INSTALLATION OF MOP SINK.
- 21 NOT USED.
- 22 NOT USED.
- 23 CASED OPENING, REFER TO DETAIL 6/A6.4. DOOR OPTIONAL. REFER TO DOOR SCHEDULE ON A1.1 (DOOR #6).

**KEY NOTES** **B**



07/14/16

15034.000

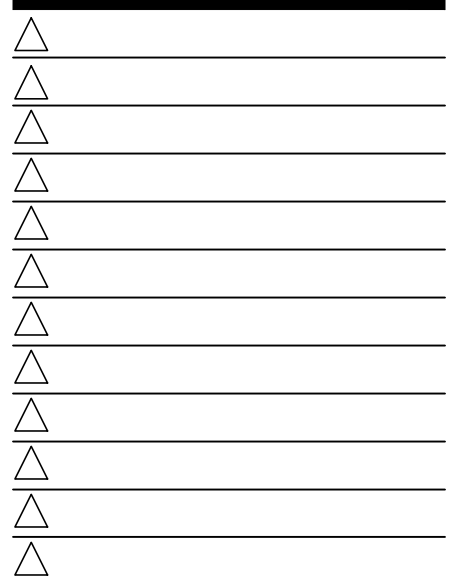

CONTRACT DATE: 07.06.2016  
 BUILDING TYPE: CONVERSION  
 PLAN VERSION: FEBRUARY 2015  
 SITE NUMBER: XXX-XXX  
 STORE NUMBER: XXXXX

**TACO BELL**  
 1363 WASHINGTON AVE.  
 PORTLAND, ME



**FLOOR PLAN**  
**A1.0**

PLOT DATE: