

BLACK SYMBOL AND BORDER
RED CIRCLE AND DIAGONAL
ON WHITE BACKGROUND

SIGN SHALL CONFORM TO MUTCD
STANDARDS

R3-2

"NO LEFT TURN" SIGN

N.T.S.

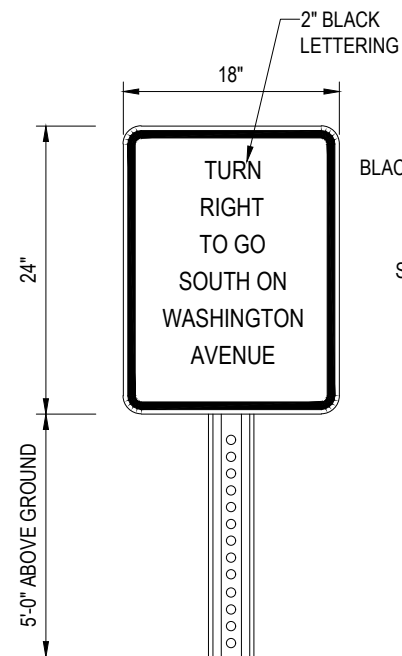

2" BLACK LETTERING

BLACK LETTERING ON REFLECTIVE WHITE
BACKGROUND

SIGN SHALL CONFORM TO MUTCD
STANDARDS

"TURN RIGHT TO GO SOUTH ON
WASHINTON AVENUE" SIGN

N.T.S.

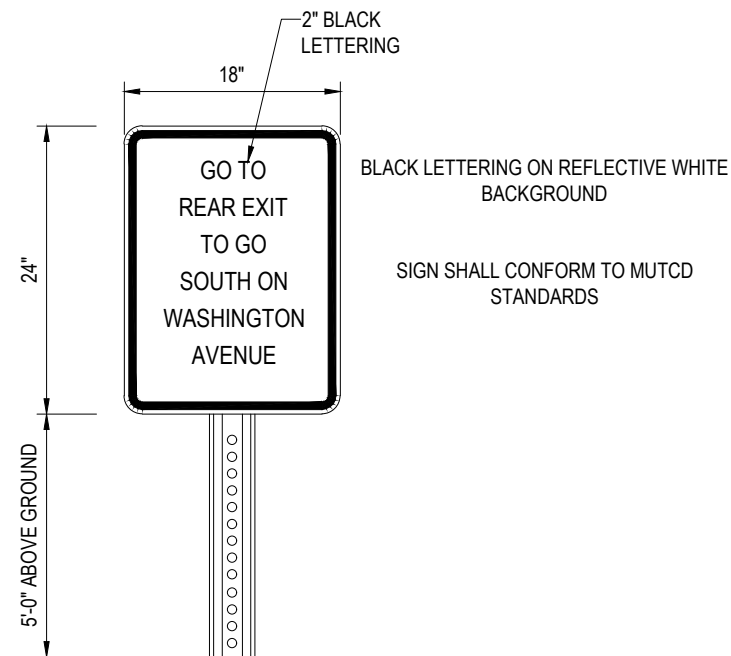

2" BLACK LETTERING

BLACK LETTERING ON REFLECTIVE WHITE
BACKGROUND

SIGN SHALL CONFORM TO MUTCD
STANDARDS

"GO TO REAR EXIT TO GO SOUTH
ON WASHINGTON AVENUE" SIGN

N.T.S.

CONCEPT PLAN

1363 WASHINGTON AVENUE
PORTLAND, ME

DATED: 03/13/2019

PREPARED FOR:
LISCIOTTI DEVELOPMENT CORP.



PREPARED BY:
352 TURNPIKE ROAD
SOUTHBOROUGH, MA 01772
(508) 480-9900
www.bohlerengineering.com

2 OF 2

PLAN NOTES:

1. THIS CONCEPT PLAN AS BEEN PREPARED TO REFLECT POTENTIAL SITE IMPROVEMENTS AS RECOMMENDED BY THE CITY OF PORTLAND AND THE PROJECT TEAM. IMPROVEMENTS SHOWN HEREON ARE APPROXIMATE ONLY AND NOT FOR CONSTRUCTION.
2. EXISTING CONDITIONS INFORMATION SHOWN HEREON IS BASED UPON AVAILABLE RECORD PLANS AND GIS INFORMATION, AND IS APPROXIMATE ONLY.

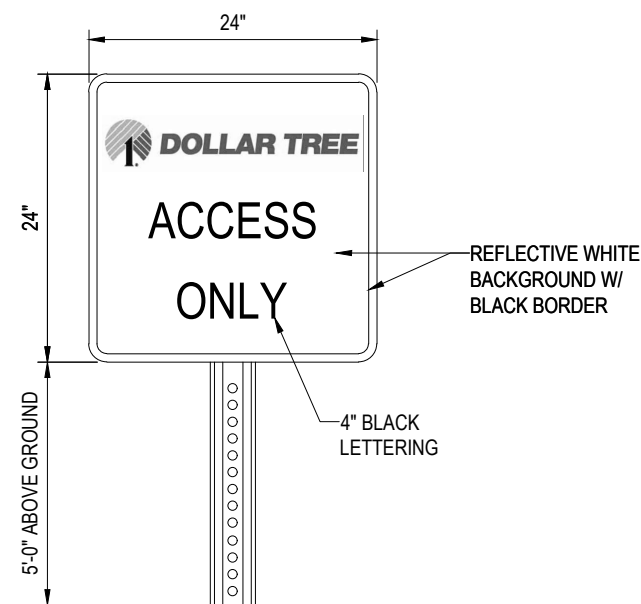

SIGN SHALL CONFORM TO MUTCD
STANDARDS

"DOLLAR TREE ACCESS
ONLY" SIGN

N.T.S.

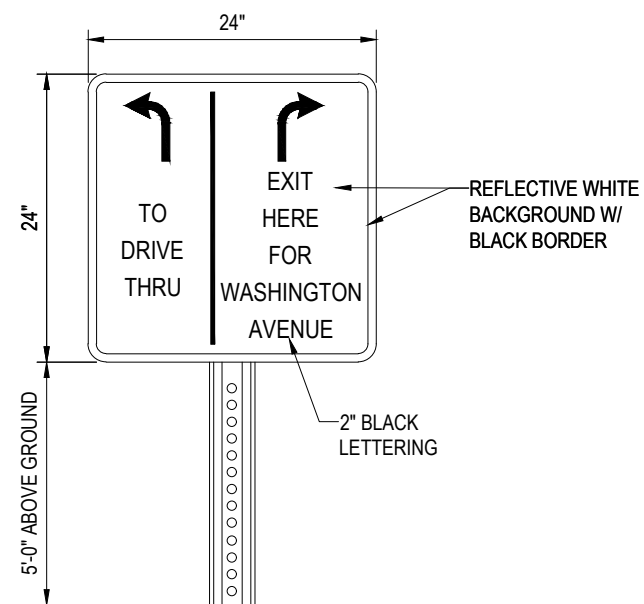

SIGN SHALL CONFORM TO MUTCD
STANDARDS

"TO DRIVE THROUGH / EXIT HERE FOR
WASHINGTON AVENUE" DIRECTIONAL SIGN

N.T.S.

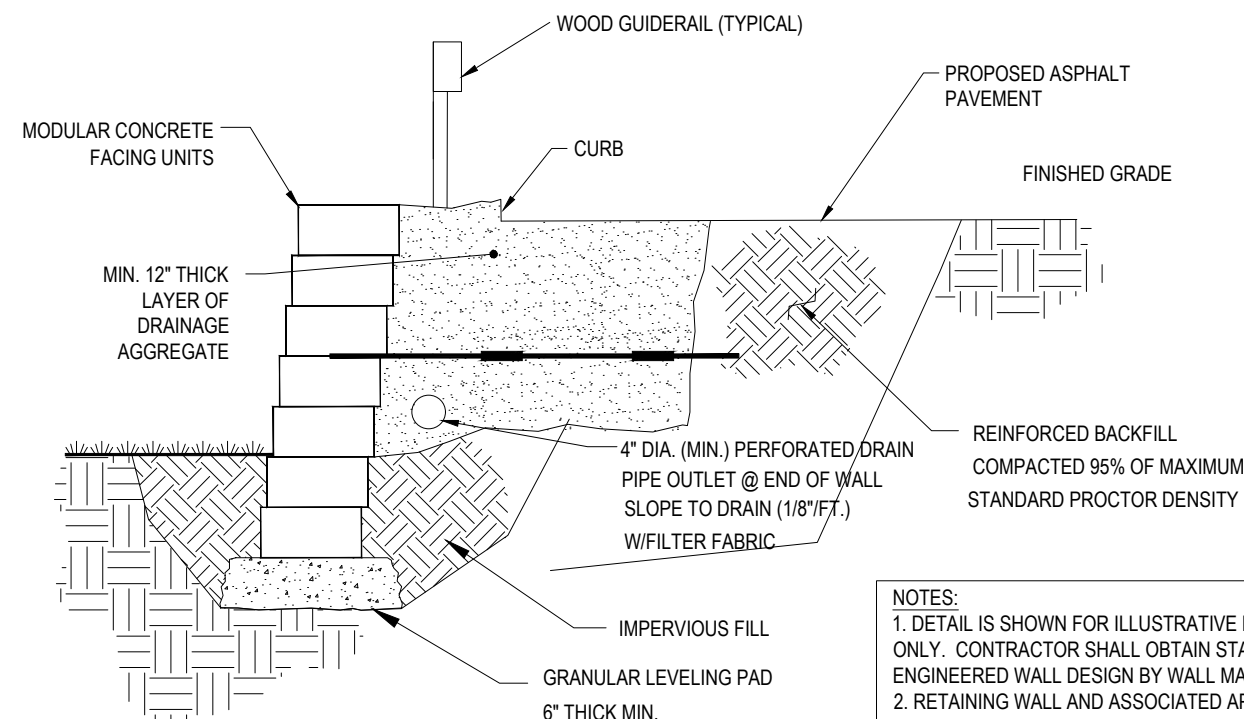

NOTES:

1. DETAIL IS SHOWN FOR ILLUSTRATIVE PURPOSES ONLY. CONTRACTOR SHALL OBTAIN STAMPED ENGINEERED WALL DESIGN BY WALL MANUFACTURER.
2. RETAINING WALL AND ASSOCIATED APPURTENANCES TO BE DESIGNED IN ACCORDANCE WITH ALL APPLICABLE RESTRICTIONS GOVERNING SAME AND TO ACCOMMODATE VEHICULAR LOADS.

TYPICAL RETAINING WALL /
GUIDE RAIL SECTION

N.T.S.