

2004-6013

04169

SUBSURFACE WASTEWATER DISPOSAL SYSTEM APPLICATION

Maine Department of Human Services
Division of Health Engineering, 10 SHS
(207) 287-5672 Fax: (207) 287-3165

PROPERTY LOCATION		>> CAUTION: PERMIT REQUIRED - ATTACH IN SPACE BELOW <<	
City, Town, or Plantation	Portland		
Street or Road	Ray Street		
Subdivision, Lot #			

OWNER/APPLICANT INFORMATION		PORTLAND Date Permit Issued: <u>7/7/04</u> PERMIT # <u>6989</u> STATE COPY \$ <u>100.00</u> <input type="checkbox"/> If Double Fee Charged <u>Jeanie Baube</u> L.P.I. # <u>017312</u> Local Plumbing Inspector Signature
Name (last, first, MI)	<u>Jordan, John</u> <input checked="" type="checkbox"/> Owner <input type="checkbox"/> Applicant	
Mailing Address of Owner/Applicant	<u>426 Forest Avenue</u> <u>Portland, ME 04101</u>	

Daytime Tel. #	<u>(207) 318-6931</u>	Municipal Tax Map # <u>400</u> Lot # <u>D 008</u>
----------------	-----------------------	---

OWNER OR APPLICANT STATEMENT I state and acknowledge that the information submitted is correct to the best of my knowledge and understand that any falsification is reason for the Department and/or Local Plumbing Inspector to deny a Permit. <u>John Jordan</u> <u>4/22/04</u> Signature of Owner or Applicant Date	CAUTION: INSPECTION REQUIRED I have inspected the installation authorized above and found it to be in compliance with the Subsurface Wastewater Disposal Rules Application. _____ (1st) date approved _____ Local Plumbing Inspector Signature _____ (2nd) date approved
--	--

PERMIT INFORMATION

TYPE OF APPLICATION <input checked="" type="checkbox"/> 1. First Time System <input type="checkbox"/> 2. Replacement System Type replaced: _____ Year installed: _____ <input type="checkbox"/> 3. Expanded System <input type="checkbox"/> a. Minor Expansion <input type="checkbox"/> b. Major Expansion <input type="checkbox"/> 4. Experimental System <input type="checkbox"/> 5. Seasonal Conversion	THIS APPLICATION REQUIRES <input type="checkbox"/> 1. No Rule Variance <input type="checkbox"/> 2. First Time System Variance <input type="checkbox"/> a. Local Plumbing Inspector Approval <input type="checkbox"/> b. State & Local Plumbing Inspector Approval <input type="checkbox"/> 3. Replacement System Variance <input type="checkbox"/> a. Local Plumbing Inspector Approval <input type="checkbox"/> b. State & Local Plumbing Inspector Approval <input checked="" type="checkbox"/> 4. Minimum Lot Size Variance <input type="checkbox"/> 5. Seasonal Conversion Permit	DISPOSAL SYSTEM COMPONENTS <input checked="" type="checkbox"/> 1. Complete Non-engineered System <input type="checkbox"/> 2. Primitive System (graywater & alt. toilet) <input type="checkbox"/> 3. Alternative Toilet, specify: _____ <input type="checkbox"/> 4. Non-engineered Treatment Tank (only) <input type="checkbox"/> 5. Holding Tank, _____ gallons <input type="checkbox"/> 6. Non-engineered Disposal Field (only) <input type="checkbox"/> 7. Separated Laundry System <input type="checkbox"/> 8. Complete Engineered System (2000 gpd or more) <input type="checkbox"/> 9. Engineered Treatment Tank (only) <input type="checkbox"/> 10. Engineered Disposal Field (only) <input type="checkbox"/> 11. Pre-treatment, specify: _____ <input type="checkbox"/> 12. Miscellaneous Components
SIZE OF PROPERTY <u>3000</u> <input checked="" type="checkbox"/> SQ. FT. <input type="checkbox"/> ACRES	DISPOSAL SYSTEM TO SERVE <input checked="" type="checkbox"/> 1. Single Family Dwelling Unit, No. of Bedrooms: <u>3</u> <input type="checkbox"/> 2. Multiple Family Dwelling, No. of Units: _____ <input type="checkbox"/> 3. Other: _____ (specify) Current Use <input type="checkbox"/> Seasonal <input type="checkbox"/> Year Round <input checked="" type="checkbox"/> Undeveloped	TYPE OF WATER SUPPLY <input type="checkbox"/> 1. Drilled Well <input type="checkbox"/> 2. Dug Well <input type="checkbox"/> 3. Private <input checked="" type="checkbox"/> 4. Public <input type="checkbox"/> 5. Other
SHORELAND ZONING <input type="checkbox"/> Yes <input checked="" type="checkbox"/> No		

DESIGN DETAILS (SYSTEM LAYOUT SHOWN ON PAGE 3)

TREATMENT TANK <input checked="" type="checkbox"/> 1. Concrete <input checked="" type="checkbox"/> a. Regular <input type="checkbox"/> b. Low Profile <input type="checkbox"/> 2. Plastic <input type="checkbox"/> 3. Other: _____ CAPACITY: <u>1000</u> GAL.	DISPOSAL FIELD TYPE & SIZE <input type="checkbox"/> 1. Stone Bed <input type="checkbox"/> 2. Stone Trench <input checked="" type="checkbox"/> 3. Proprietary Device <input checked="" type="checkbox"/> a. cluster array <input type="checkbox"/> c. Linear <input type="checkbox"/> b. regular load <input type="checkbox"/> d. H-20 load <input type="checkbox"/> 4. Other: _____ SIZE: <u>900</u> sq. ft. <input type="checkbox"/> lin. ft.	GARBAGE DISPOSAL UNIT <input checked="" type="checkbox"/> 1. No <input type="checkbox"/> 2. Yes <input type="checkbox"/> 3. Maybe If Yes or Maybe, specify one below: <input type="checkbox"/> a. multi-compartment tank <input type="checkbox"/> b. _____ tanks in series <input type="checkbox"/> c. Increase in tank capacity <input type="checkbox"/> d. Filter on Tank Outlet	DESIGN FLOW <u>270</u> gallons per day BASED ON: <input checked="" type="checkbox"/> 1. Table 501.1 (dwelling unit(s)) <input type="checkbox"/> 2. Table 501.2 (other facilities) SHOW CALCULATIONS --- for other facilities --- 3 bedrooms @ 90 gpd = 270 gpd
SOIL DATA & DESIGN CLASS PROFILE CONDITION DESIGN <u>2 / C/III / 1</u> at Observation Hole # <u>TP-1</u> Depth <u>19</u> " of Most Limiting Soil Factor	DISPOSAL FIELD SIZING <input type="checkbox"/> 1. Small---2.0 sq. ft. / gpd <input type="checkbox"/> 2. Medium---2.6 sq. ft. / gpd <input checked="" type="checkbox"/> 3. Medium---Large 3.3 sq. ft. / gpd <input type="checkbox"/> 4. Large---4.1 sq. ft. / gpd <input type="checkbox"/> 5. Extra Large---5.0 sq. ft. / gpd	EFFLUENT/EJECTOR PUMP <input type="checkbox"/> 1. Not Required <input checked="" type="checkbox"/> 2. May Be Required <input type="checkbox"/> 3. Required Specify only for engineered systems: DOSE: _____ gallons	<input type="checkbox"/> 3. Section 503.0 (meter readings) ATTACH WATER METER DATA

SITE EVALUATOR STATEMENT

I certify that on 4-7-04 (date) I completed a site evaluation on this property and state that the data reported are accurate and that the proposed system is in compliance with the State of Maine Subsurface Wastewater Disposal Rules (10-144A CMR 241).

<u>[Signature]</u> Site Evaluator Signature	<u>355</u> SE #	<u>4-8-04</u> Date	Sebago Technics Engineering Experience You Can Build On
<u>Gary M. Fullerton</u> Site Evaluator Name Printed	<u>(207) 856-0271</u> Telephone Number	<u>gfullerton@sebagotechnics.com</u> E-mail Address	

Note: Changes to or deviations from the design should be confirmed with the Site Evaluator. HHE-200 Rev. 10/02

SUBSURFACE WASTEWATER DISPOSAL SYSTEM APPLICATION

Maine Department of Human Services
 Division of Health Engineering, 10 SHS
 (207) 287-5672 FAX (207) 287-3165

Town, City, Plantation
Portland

Street, Road, Subdivision
Ray Street

Owner or Applicant Name
John Jordan

SITE PLAN

Scale 1" = 30 Ft.
 or as shown

SITE LOCATION PLAN

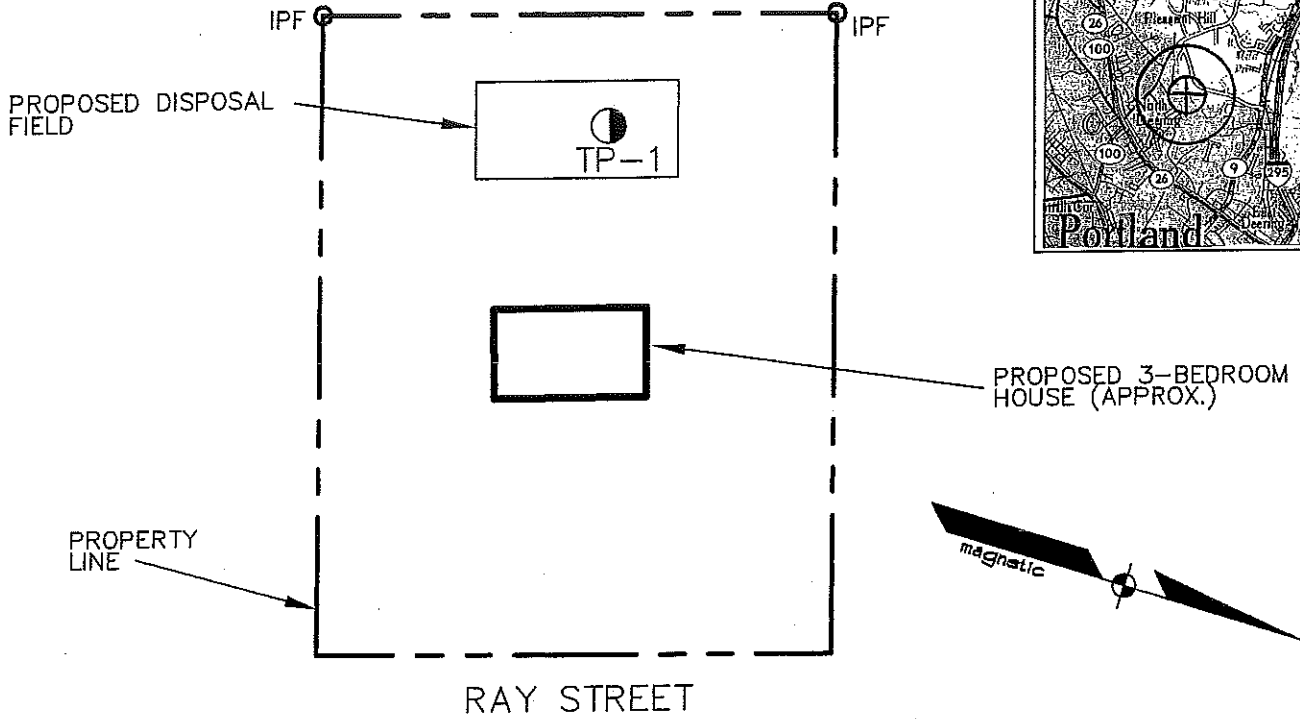
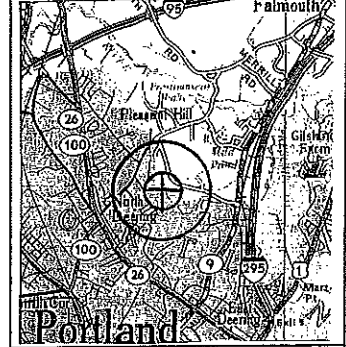

SOIL DESCRIPTION AND CLASSIFICATION (Location of Observation Holes Shown Above)

Observation Hole TP-1 Test pit Boring
1-2 " Depth of Organic Horizon Above Mineral Soil

DEPTH BELOW MINERAL SOIL SURFACE (inches)	Texture	Consistency	Color	Mottling
0	SANDY LOAM	FRIABLE	DARK BROWN	
10	FINE SANDY LOAM		BROWN	COMMON & DISTINCT
20		LEDGE @ 19"		
30				
40			BROWN	
50				

Soil Classification <u>2</u> <u>C/AIII</u> Profile Condition	Slope <u>0-3</u> %	Limiting Factor <u>19</u> "	<input type="checkbox"/> Ground Water <input type="checkbox"/> Restrictive Layer <input checked="" type="checkbox"/> Bedrock <input type="checkbox"/> Pit Depth
--	-----------------------	--------------------------------	--

Observation Hole _____ Test pit Boring
 _____ " Depth of Organic Horizon Above Mineral Soil

DEPTH BELOW MINERAL SOIL SURFACE (inches)	Texture	Consistency	Color	Mottling
0				
10				
20				
30				
40				
50				

Soil Classification Profile Condition	Slope %	Limiting Factor "	<input type="checkbox"/> Ground Water <input type="checkbox"/> Restrictive Layer <input type="checkbox"/> Bedrock <input type="checkbox"/> Pit Depth
--	------------	----------------------	---

Ray M. Lill
 Site Evaluator Signature

355
 SE #

4-8-04
 Date

SUBSURFACE WASTEWATER DISPOSAL SYSTEM APPLICATION		Maine Department of Human Services Division of Health Engineering, 10 SHS (207) 287-5672 FAX (207) 287-3165
Town, City, Plantation Portland	Street, Road, Subdivision Ray Street	Owner or Applicant Name John Jordan

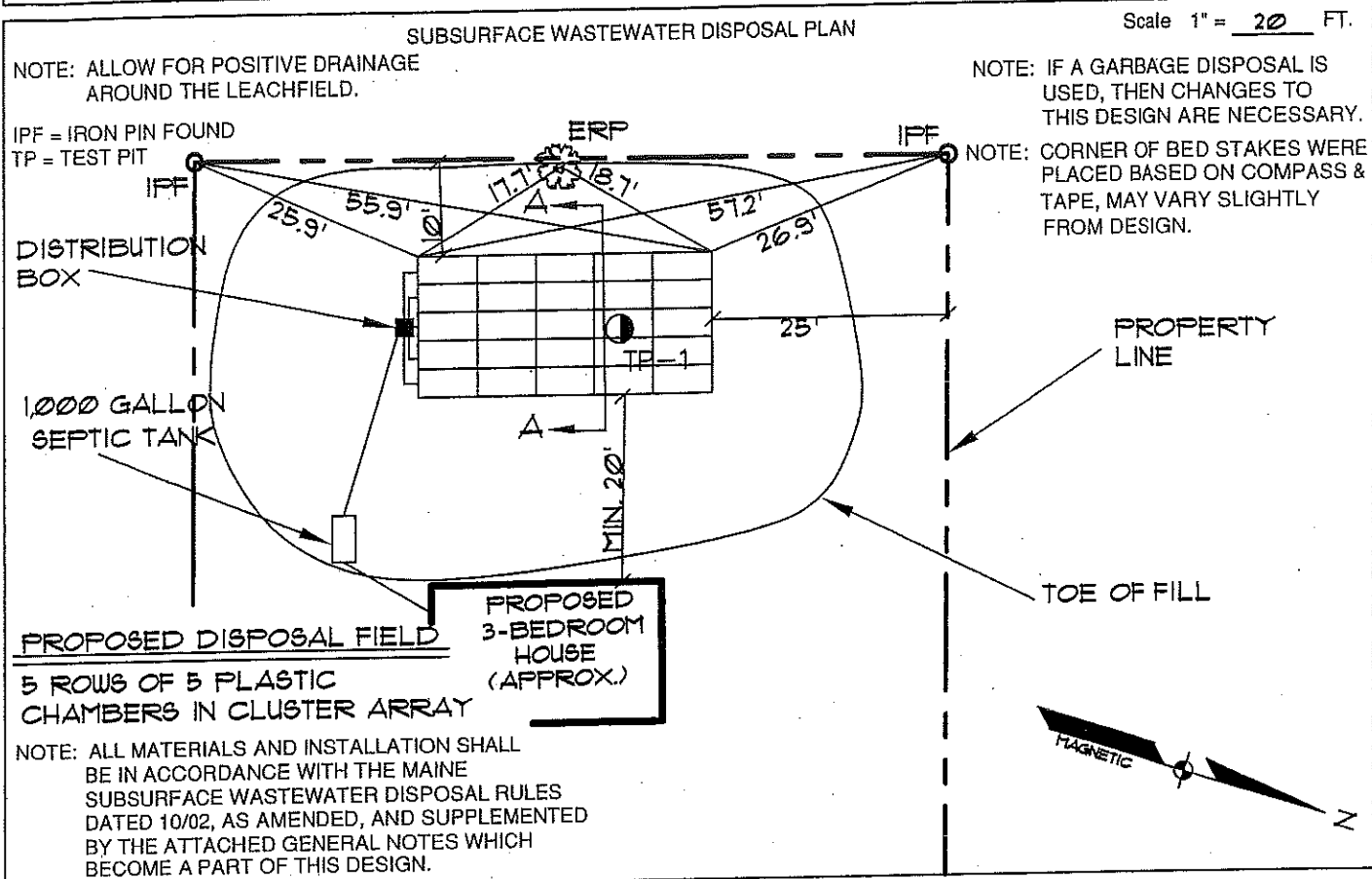

BACKFILL REQUIREMENTS	CONSTRUCTION ELEVATIONS	ELEVATION REFERENCE POINT
Depth of Fill (Upslope) VARIABLES 35"-51"	Finished Grade Elevation -8"	Location & Description Nail up
Depth of Fill (Downslope) VARIABLES 39"-60"	Top of Distribution Pipe or Proprietary Device -20"	33" in a 16" dia. White Pine
	Bottom of Disposal Area (Bottom of Stone) -38"	Reference Elevation 0"

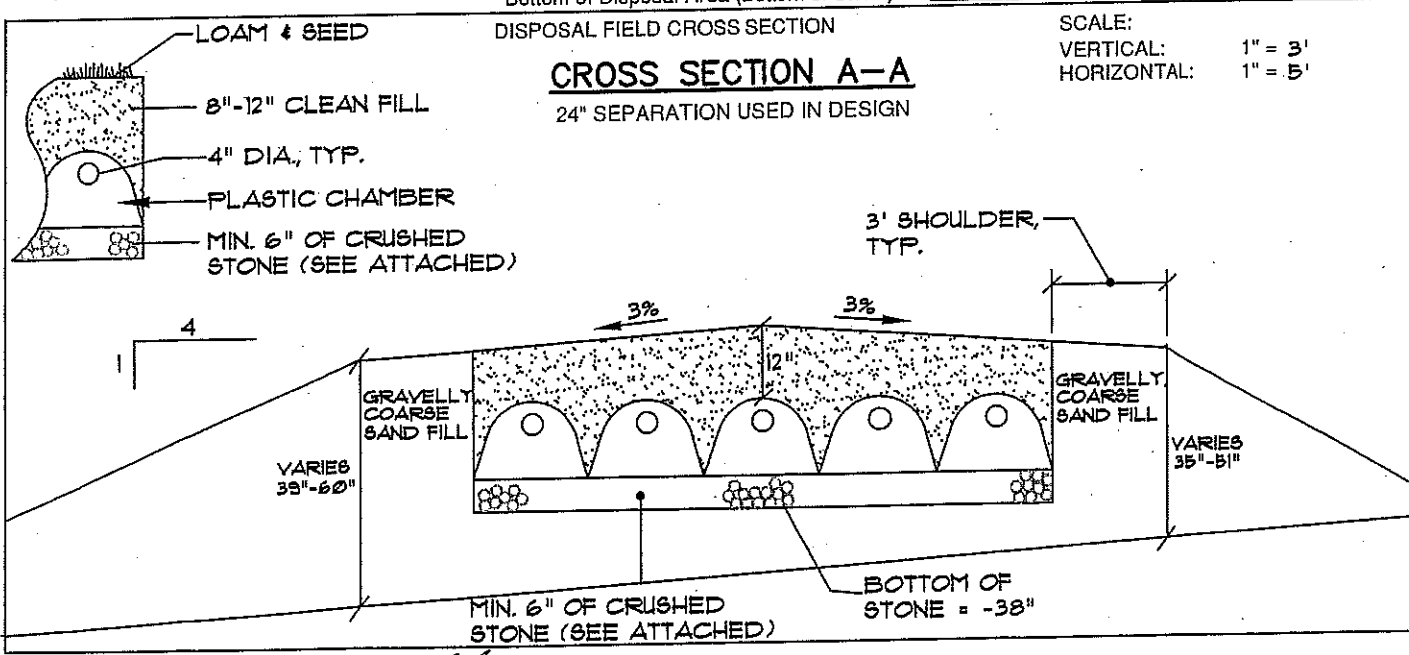

 Site Evaluator Signature	355 SE #	4-8-04 Date	Page 3 of 3 HHE-200 Rev. 10/02
------------------------------	-------------	----------------	-----------------------------------

(attachment to form HHE-200)
< 1,000 gpd Septic System

1. The nature of the site evaluation profession is one of interpretation of soil and site conditions. We, in the field, attempt to both provide a satisfactory service to the client, and comply by the rules by which we are bound - The Maine Subsurface Wastewater Disposal Rules. If at any time you, the client, are not satisfied with the service provided or the results found, it is your right to hire another site evaluator for a second opinion.
2. Property information is supplied by the owner, applicant or representative. Such information presented herein shall be verified as correct by the owner or applicant prior to signing this application.
3. All work shall be in accordance with the Maine Subsurface Wastewater Disposal Rules dated 6/00, as amended.
4. All work should be performed under dry conditions only (for disposal area).
5. No vehicular or equipment traffic to be allowed on disposal area. Disposal field shall be constructed from outside the corner stakes located in the field. The downslope area is also to be protected in the same manner.
6. Backfill, if required, is to be gravelly coarse sand to coarse sand texture and to be free of foreign debris. If backfill is coarser than original soil, then mix top 4" of backfill and original soil with rototiller.
7. No neighboring wells are apparent (unless so indicated) within 100' of disposal area. Owner or applicant shall verify this prior to signing the application.
8. The disposal field stone shall be clean, uniform in size and free of fines, dust, ashes, or clay. It shall be no smaller than ¾ inch and no larger than 2½ inches in size (per Section 805.2.3 of the Maine Subsurface Wastewater Disposal Rules).
9. Minimum separation distances required (unless reduced by variance or special circumstance).
 - a) wells with water usage of 2000 or more gpd or public water supply wells:

Disposal Fields:	300'
Septic Tanks and Holding Tanks:	100'
 - b) any well to disposal area: 100'
 - c) any well to septic tank: 100'
 - d) septic tank or disposal area to lake, river, stream or brook: 100' for major watercourse,
50' for minor watercourse
 - e) house to treatment tank: 8'
 - f) house to disposal area: 20'
 - For all other separation distances, use separations for less than 1,000 gpd per Maine Subsurface Wastewater Disposal Rules Table 700.2.
9. Location of septic system near a wetland may require a separate permit. As such, the owner, prior to construction of the septic system, shall hire a professional to evaluate proximity of adjacent wetlands and prepare necessary permit applications.
10. Garbage disposals are not recommended and, if installed, are done so at the owner's risk. The additional waste load requires increased maintenance frequency, higher potential for failure, and larger septic tanks.
11. Pump stations, when required, shall be installed watertight to prevent infiltration of ground and/or surface water.
12. Force mains and pressure lines shall be flushed of any foreign material and pumps shall be checked for proper on/off cycle before being put into service.
13. Force mains, pump stations, and/or gravity piping subject to freezing shall be installed below frost line or adequately insulated.

April 22, 2004

Division of Health Engineering
State House Station 10
Augusta, Maine 04333

Re: Application Variance to Min Lot Size
Ray Street, Portland

Dear Sir/Madam:

Please find enclosed per your instructions:

- 1.) Copy of Deed
- 2.) Copy of Soils Investigation and HHE-200 Form
- 3.) Copy of Notice Forms sent to Abutters
- 4.) Copy of Notice Forms sent to Municipal Officers
and Municipal Planning Board
- 5.) A duplicate of this application was delivered to the Portland City Hall
- 6.) A check in the amount of \$50.00
- 7.) Directions: From the intersection of Washington Ave and Allen Ave; take
Allen Ave Extension East approximately ½ mile to Ray St on right. Subject
lot is approximately 150' on right. (Abutting 444 Ray Street).

Sincerely,

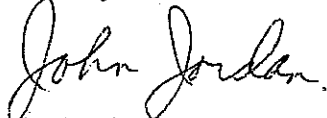
John Jordan

**WARRANTY DEED
(Maine Statutory Short Form)**



KNOW ALL PERSONS BY THESE PRESENTS, that Joan I. Waugh of Vista and State of California, for consideration paid, GRANTS to John R. Jordan of Falmouth, County of Cumberland and State of Maine, whose mailing address is 19 Mitchellwood Drive, Falmouth, Maine 04105 with **WARRANTY COVENANTS**, the land with buildings thereon in Portland, County of Cumberland and State of Maine, described as follows:

A certain lot of land, with the buildings thereon, situated on the southwesterly side of Ray Street in the City of Portland, County of Cumberland and State of Maine, bounded and described as follows:

Beginning at a point in the said southwesterly side of Ray Street, distant one hundred (100) feet southeasterly from its intersection with the southeasterly side of Allen Avenue; thence southeasterly, by said side of Ray Street, one hundred fifty-five (155) feet to land now or formerly of Raymond H. Sweetsir; thence southwesterly, at right angles, by said Sweetsir land one hundred ten (110) feet to a point; thence northwesterly, at right angles and by said Sweetsir land, fifty-five (55) feet to a point; thence northeasterly, at right angles and by said Sweetsir land, ten (10) feet to a point; thence northwesterly at right angles and by said Sweetsir land, one hundred (100) feet to a point; thence northeasterly, at right angles, by said Sweetsir land, one hundred (100) feet, more or less, to said Ray Street at the point of beginning.

Meaning and intending to convey the same premises conveyed to the Grantor by deed from Lyndon F. Thurston and Frances E. Thurston, dated November 27, 1963 and recorded in the County Registry of Deeds in Book 2790, Page 464, Lewis A. Waugh deceased on May 1, 1993 leaving Joan I. Waugh as sole surviving tenant.

Witness my hand and seal this 24th day of October, 2003.



Witness

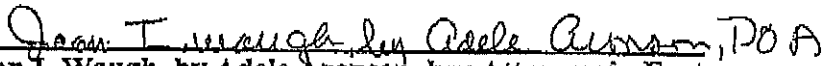

Joan I. Waugh, by Adele Aronson, her Attorney in Fact

STATE OF MAINE
COUNTY OF CUMBERLAND

October 24, 2003

Then personally appeared before me the above named Adele Aronson, Attorney in Fact on behalf of Joan I. Waugh and acknowledged the foregoing instrument to be her free act and deed.

Before me, 

Notary Public/ Attorney at Law

OCT 24 2003

G. TRENT GRACE
Notary Public, Maine
My Commission Expires February 6, 2008

Department of Human Services
Division of Health Engineering
#11 State House Station
Augusta ME 04333-0011
Tel: (207)287-5672
Fax: (207) 287-4172

\$50.00 REVIEW FEE
Make check payable to:
"Treasurer of State"
Appropriation #
014-10A-2426-01-2615

APPLICATION FOR
VARIANCE TO THE MINIMUM LOT SIZE LAW REQUIREMENTS
(12 MRSA §4807-B, 4807-C)

PLEASE TYPE OR PRINT:

Name of Applicant: John Jordan

Address: 426 Forest Ave., Portland, ME 04101

Telephone Number: (207) 318-6931

Local Agent (Name, Address and Tel. #) Sebago Technics, Inc.

1 Chabot St., P.O. Box 1339, Westbrook, ME 04098-1339

(207) 856-0277

LOT LOCATION

Name of Project: Ray Street

Street or Route Number: Ray Street

Municipality or Township: Portland

County: Cumberland

By signing this application, the applicant certifies that he/she has (1) sent a copy of the notice form to the owners of property abutting the land upon which the project is located; (2) sent a copy of the public notice form to the chief municipal officer, chairperson of the municipal planning board and the Local Plumbing Inspector, and (3) filed a duplicate of this application in the municipal office.

DATE: 4/22/04

John Jordan
Signature of Applicant

John Jordan, owner
Print name and title

(If signature is other than the applicant,
attach letter of agent authorization.)

**INSTRUCTIONS
PLEASE READ**

- ✓1) Fill out the application completely. Incomplete applications will be returned.
- ✓2) Obtain a copy of your deed, lease, option or other legal document, establishing your title, right or interest in the property.
- ✓3) Obtain the services of a Licensed Site Evaluator to perform a soils investigation on your property. Attach a copy of the report of the lot to this application. If the application involves an existing subsurface wastewater disposal system, submit a statement from a local plumbing inspector or a licensed site evaluator describing the functioning of that system, plus the soils investigation report.
- ✓4) Send a copy of the NOTICE form (attached to this application) to the owners of property abutting the land upon which the project is located. Their names and addresses can be obtained from town tax maps or local public officials.
- ✓5) Send a copy of the NOTICE form (attached to this application) to the municipal officers and the Municipal Planning Board.
- ✓6) Send a duplicate of this application to the Municipal Office, or if the project is located in an unorganized township, send the duplicate to the County Commissioner's Office.
- 7) When returning the completed application to the Division of Health Engineering, be sure to include (1) a copy of your deed or document establishing title, right or interest in the property, (2) an explanation of how to find the property, (3) a completed HHE-200 form, (4) a check for \$50.00 made payable to the "Treasurer of State", and (5) a statement from the local plumbing inspector for an existing subsurface wastewater disposal system. Send this information to the Division of Health Engineering, State House Station 10, Augusta, Maine 04333. If any item is missing, the application will be returned.

NOTE

BE SURE TO SEND YOUR APPLICATION WELL IN ADVANCE OF THE DATE ON WHICH YOU PLAN TO START THE PROJECT. PROCESSING MAY REQUIRE UP TO 30 DAYS.

NOTE: Use this form or one containing identical information:

NOTICE

(to owners of abutting property, municipal officials, and local plumbing inspector)

Please take notice that John Jordan
(Name of Applicant)

426 Forest Ave., Portland, ME 04101
(Address of Applicant)

is filing an application for a Waiver of Minimum Lot Size Law Requirements with the Department of Human Services, Division of Health Engineering pursuant to the provisions of 12 MRSA Sections 4807-B and 4807-C for permission to Install a subsurface wastewater disposal system for a 3-bedroom

home on an 8,000 sqft property.
(State specifically what is to be done)

will be filed for public inspection at the Department's office in Augusta and at the municipal offices of
Portland on 4/22/04
(Name of Municipality) (Date of Filing)

Written comments from any interested persons must be sent to the Division of Health Engineering, #10 State House Station, Augusta, Maine 04333 within 14 days of filing of the application to receive consideration.

Copy of notice sent to abutters. 4/22/04 JS.

NOTE: Use this form or one containing identical information:

NOTICE

(to owners of abutting property, municipal officials, and local plumbing inspector)

Please take notice that John Jordan
(Name of Applicant)

426 Forest Ave., Portland, ME 04101
(Address of Applicant)

is filing an application for a Waiver of Minimum Lot Size Law Requirements with the Department of Human Services, Division of Health Engineering pursuant to the provisions of 12 MRSA Sections 4807-B and 4807-C for permission to Install a subsurface wastewater disposal system for a 3-bedroom

home on an 8,000 sqft property.
(State specifically what is to be done)

will be filed for public inspection at the Department's office in Augusta and at the municipal offices of
Portland on 4/22/04
(Name of Municipality) (Date of Filing)

Written comments from any interested persons must be sent to the Division of Health Engineering, #10 State House Station, Augusta, Maine 04333 within 14 days of filing of the application to receive consideration.

Notice form sent to abutters + Municipal officers.

BSURFACE WASTEWATER DISPOSAL SYSTEM APPLICATION

Maine Department of Human Services
 Division of Health Engineering, 10 SHS
 (207) 287-5672 FAX (207) 287-3165

town, City, Plantation
 Portland

Street, Road, Subdivision
 Ray Street

Owner or Applicant Name
 John Jordan

SITE PLAN

Scale 1" = 30 Ft.
 or as shown

N+S. SZANTON

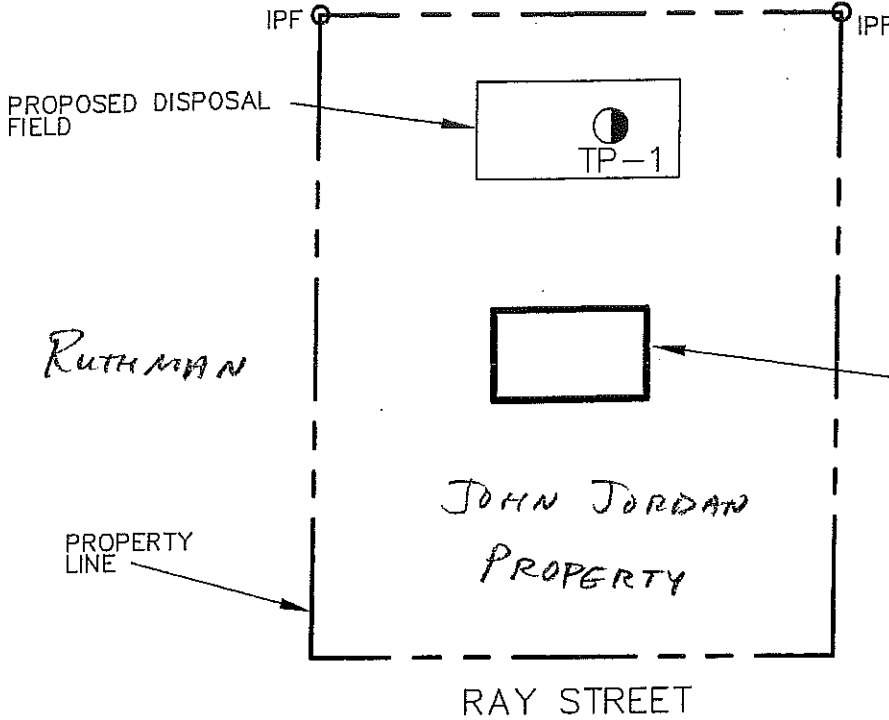
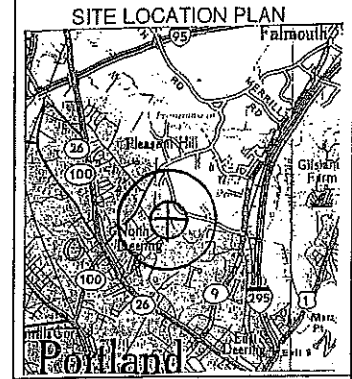

Hea YOOME
 PROPOSED 3-BEDROOM HOUSE (APPROX.)
 kwangdo Kim

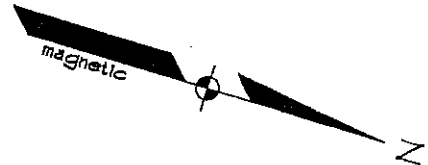

SOIL DESCRIPTION AND CLASSIFICATION (Location of Observation Holes Shown Above)

Observation Hole TP-1 Test pit Boring
1-2 " Depth of Organic Horizon Above Mineral Soil

DEPTH BELOW MINERAL SOIL SURFACE (inches)	Texture	Consistency	Color	Mottling
0	SANDY LOAM	FRIABLE	DARK BROWN	
10	FINE SANDY LOAM		BROWN	COMMON & DISTINCT
20		HEDGE @ 19"		
40			BROWN	

Soil Classification: 2 Profile, C/AIII Condition
 Slope: 0-3 %
 Limiting Factor: 19 "
 Ground Water
 Restrictive Layer
 Bedrock
 Pit Depth

Observation Hole _____ Test pit Boring
 _____ " Depth of Organic Horizon Above Mineral Soil

DEPTH BELOW MINERAL SOIL SURFACE (inches)	Texture	Consistency	Color	Mottling
0				
10				
20				
30				
40				
50				

Soil Classification: _____ Profile, _____ Condition
 Slope: _____ %
 Limiting Factor: _____ "
 Ground Water
 Restrictive Layer
 Bedrock
 Pit Depth

[Signature]
 Site Evaluator Signature

355
 SE #

4-8-04
 Date

*sent to abutters
 + Municipal officers*

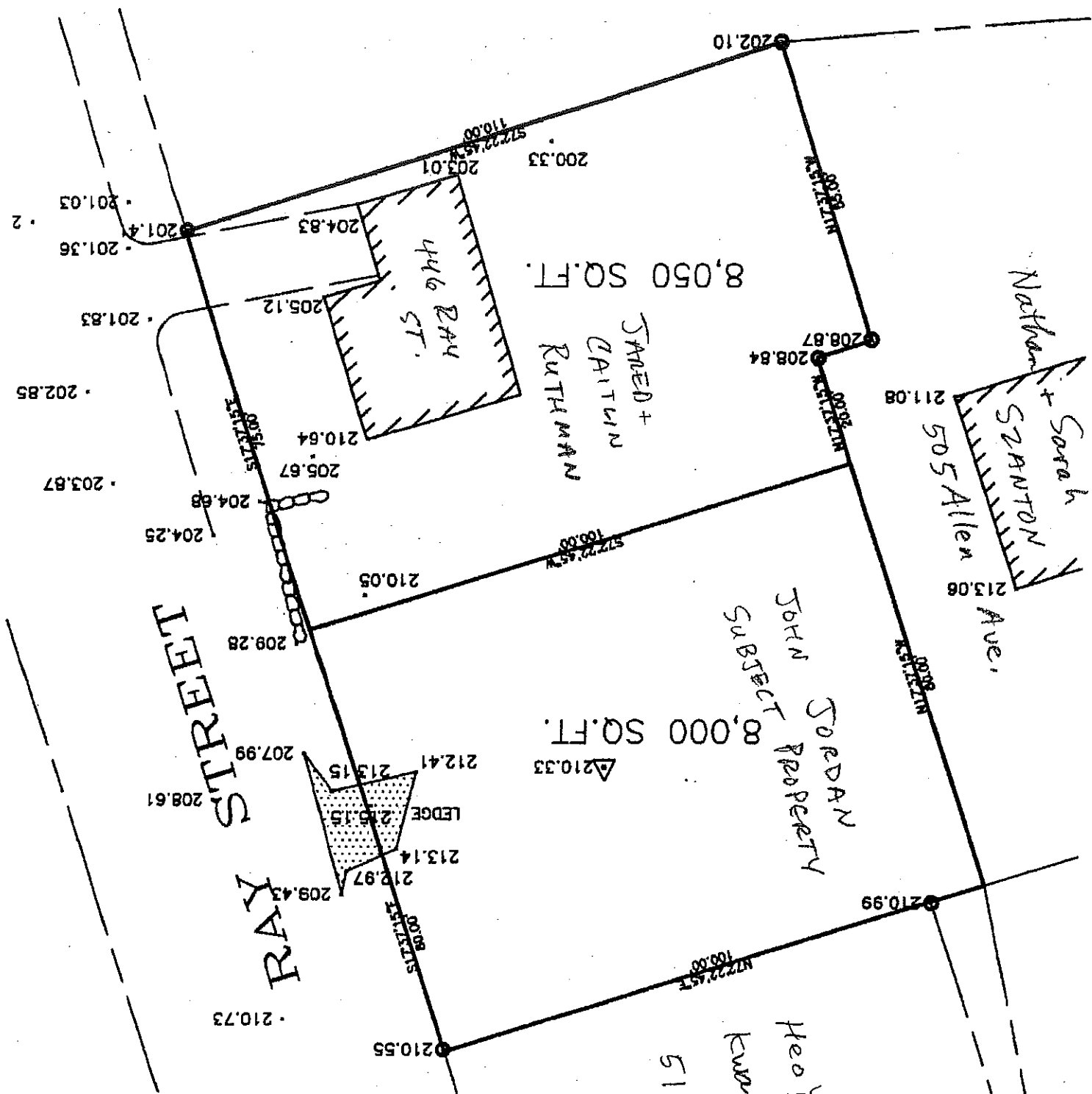

Sent to abatters
& Municipal officers