

2004-6013

04169

# SUBSURFACE WASTEWATER DISPOSAL SYSTEM APPLICATION

Maine Department of Human Services  
Division of Health Engineering, 10 SHS  
(207) 287-5672 Fax: (207) 287-3165

<b>PROPERTY LOCATION</b>		<b>&gt;&gt; CAUTION: PERMIT REQUIRED - ATTACH IN SPACE BELOW &lt;&lt;</b>
City, Town, or Plantation	Portland	
Street or Road	Ray Street	

<b>OWNER/APPLICANT INFORMATION</b>		PORTLAND Date Permit Issued: <u>7.7.04</u> <i>Jeannie Burt</i> Local Plumbing Inspector Signature	8989 TOWN COPY \$ <u>110.00</u> FEE Charged LPI # <u>0732</u>
Name (last, first, MI)	<input checked="" type="checkbox"/> Owner <input type="checkbox"/> Applicant		
Mailing Address of Owner/Applicant			

Name (last, first, MI)	Jordan, John	Municipal Tax Map # <u>400</u> Lot # <u>D 008</u>
Daytime Tel. #	(207) 318-6931	

<b>OWNER OR APPLICANT STATEMENT</b>	<b>CAUTION: INSPECTION REQUIRED</b>
I state and acknowledge that the information submitted is correct to the best of my knowledge and understand that any falsification is reason for the Department and/or Local Plumbing Inspector to deny a Permit.	I have inspected the installation authorized above and found it to be in compliance with the Subsurface Wastewater Disposal Rules Application
<i>John Jordan</i> Signature of Owner or Applicant	<i>Jeannie Burt</i> Local Plumbing Inspector Signature
Date: <u>4/22/04</u>	(1st) date approved: _____ (2nd) date approved: _____

## PERMIT INFORMATION

<b>TYPE OF APPLICATION</b> <input checked="" type="checkbox"/> 1. First Time System <input type="checkbox"/> 2. Replacement System Type replaced: _____ Year installed: _____ <input type="checkbox"/> 3. Expanded System <input type="checkbox"/> a. Minor Expansion <input type="checkbox"/> b. Major Expansion <input type="checkbox"/> 4. Experimental System <input type="checkbox"/> 5. Seasonal Conversion	<b>THIS APPLICATION REQUIRES</b> <input type="checkbox"/> 1. No Rule Variance <input type="checkbox"/> 2. First Time System Variance <input type="checkbox"/> a. Local Plumbing Inspector Approval <input type="checkbox"/> b. State & Local Plumbing Inspector Approval <input type="checkbox"/> 3. Replacement System Variance <input type="checkbox"/> a. Local Plumbing Inspector Approval <input type="checkbox"/> b. State & Local Plumbing Inspector Approval <input checked="" type="checkbox"/> 4. Minimum Lot Size Variance <input type="checkbox"/> 5. Seasonal Conversion Permit	<b>DISPOSAL SYSTEM COMPONENTS</b> <input checked="" type="checkbox"/> 1. Complete Non-engineered System <input type="checkbox"/> 2. Primitive System (graywater & ait. toilet) <input type="checkbox"/> 3. Alternative Toilet, specify: _____ <input type="checkbox"/> 4. Non-engineered Treatment Tank (only) <input type="checkbox"/> 5. Holding Tank, _____ gallons <input type="checkbox"/> 6. Non-engineered Disposal Field (only) <input type="checkbox"/> 7. Separated Laundry System <input type="checkbox"/> 8. Complete Engineered System (2000 gpd or more) <input type="checkbox"/> 9. Engineered Treatment Tank (only) <input type="checkbox"/> 10. Engineered Disposal Field (only) <input type="checkbox"/> 11. Pre-treatment, specify: _____ <input type="checkbox"/> 12. Miscellaneous Components
<b>SIZE OF PROPERTY</b> <u>3000</u> <input checked="" type="checkbox"/> SQ. FT. <input type="checkbox"/> ACRES	<b>DISPOSAL SYSTEM TO SERVE</b> <input checked="" type="checkbox"/> 1. Single Family Dwelling Unit, No. of Bedrooms: <u>3</u> <input type="checkbox"/> 2. Multiple Family Dwelling, No. of Units: _____ <input type="checkbox"/> 3. Other: _____ (specify) Current Use <input type="checkbox"/> Seasonal <input type="checkbox"/> Year Round <input checked="" type="checkbox"/> Undeveloped	<b>TYPE OF WATER SUPPLY</b> <input type="checkbox"/> 1. Drilled Well <input type="checkbox"/> 2. Dug Well <input type="checkbox"/> 3. Private <input checked="" type="checkbox"/> 4. Public <input type="checkbox"/> 5. Other
<b>SHORELAND ZONING</b> <input type="checkbox"/> Yes <input checked="" type="checkbox"/> No		

## DESIGN DETAILS (SYSTEM LAYOUT SHOWN ON PAGE 3)

<b>TREATMENT TANK</b> <input checked="" type="checkbox"/> 1. Concrete <input checked="" type="checkbox"/> a. Regular <input type="checkbox"/> b. Low Profile <input type="checkbox"/> 2. Plastic <input type="checkbox"/> 3. Other: _____ CAPACITY: <u>1000</u> GAL.	<b>DISPOSAL FIELD TYPE &amp; SKE</b> <input type="checkbox"/> 1. Stone Bed <input type="checkbox"/> 2. Stone Trench <input checked="" type="checkbox"/> 3. Proprietary Device <input type="checkbox"/> a. cluster array <input type="checkbox"/> c. Linear <input checked="" type="checkbox"/> b. regular load <input type="checkbox"/> d. H-20 load <input type="checkbox"/> 4. Other: _____ SIZE: <u>900</u> <input checked="" type="checkbox"/> sq. ft. <input type="checkbox"/> lin. ft.	<b>GARBAGE DISPOSAL UNIT</b> <input checked="" type="checkbox"/> 1. No <input type="checkbox"/> 2. Yes <input type="checkbox"/> 3. Maybe If Yes or Maybe, specify one below: <input type="checkbox"/> a. multi-compartment tank <input type="checkbox"/> b. _____ tanks in series <input type="checkbox"/> c. increase in tank capacity <input type="checkbox"/> d. Filter on Tank Outlet	<b>DESIGN FLOW</b> <u>270</u> gallons per day BASED ON: <input checked="" type="checkbox"/> 1. Table 501.1 (dwelling unit(s)) <input type="checkbox"/> 2. Table 501.2 (other facilities) SHOW CALCULATIONS ---- for other facilities ----
<b>SOIL DATA &amp; DESIGN CLASS</b> PROFILE <u>2</u> / CONDITION <u>C/III</u> / DESIGN <u>1</u> at Observation Hole # <u>TP-1</u> Depth <u>19</u> " of Most Limiting Soil Factor	<b>DISPOSAL FIELD SIZING</b> <input type="checkbox"/> 1. Small---2.0 sq. ft. / gpd <input type="checkbox"/> 2. Medium---2.6 sq. ft. / gpd <input checked="" type="checkbox"/> 3. Medium---Large 3.3 sq. ft. / gpd <input type="checkbox"/> 4. Large---4.1 sq. ft. / gpd <input type="checkbox"/> 5. Extra Large---5.0 sq. ft. / gpd	<b>EFFLUENT/EJECTOR PUMP</b> <input type="checkbox"/> 1. Not Required <input checked="" type="checkbox"/> 2. May Be Required <input type="checkbox"/> 3. Required Specify only for engineered systems: DOSE: _____ gallons	<b>3 bedrooms @ 90 gpd =</b> <b>210 gpd</b> <input type="checkbox"/> 3. Section 503.0 (meter readings) ATTACH WATER METER DATA

## SITE EVALUATOR STATEMENT

I certify that on 4-7-04 (date) I completed a site evaluation on this property and state that the data reported are accurate and that the proposed system is in compliance with the State of Maine Subsurface Wastewater Disposal Rules (10-144A CMR 241).

*Gary M. Fullerton*  
Site Evaluator Signature

355 SE # 4-8-04 Date

Gary M. Fullerton (207) 856-0277 gfullerton@sebagotech.com  
Site Evaluator Name Printed Telephone Number E-mail Address

Sebago Technics Engineering Expertise You Can Build On

Note: Changes to or deviations from the design should be confirmed with the Site Evaluator. HHE-200 Rev. 10/02

SUBSURFACE WASTEWATER DISPOSAL SYSTEM APPLICATION

Maine Department of Human Services  
 Division of Health Engineering, 10 SHS  
 (207) 287-5672 FAX (207) 287-3165

Town, City, Plantation  
**Portland**

Street, Road, Subdivision  
**Ray Street**

Owner or Applicant Name  
**John Jordan**

SITE PLAN

Scale 1" = 30 Ft.  
 or as shown

SITE LOCATION PLAN

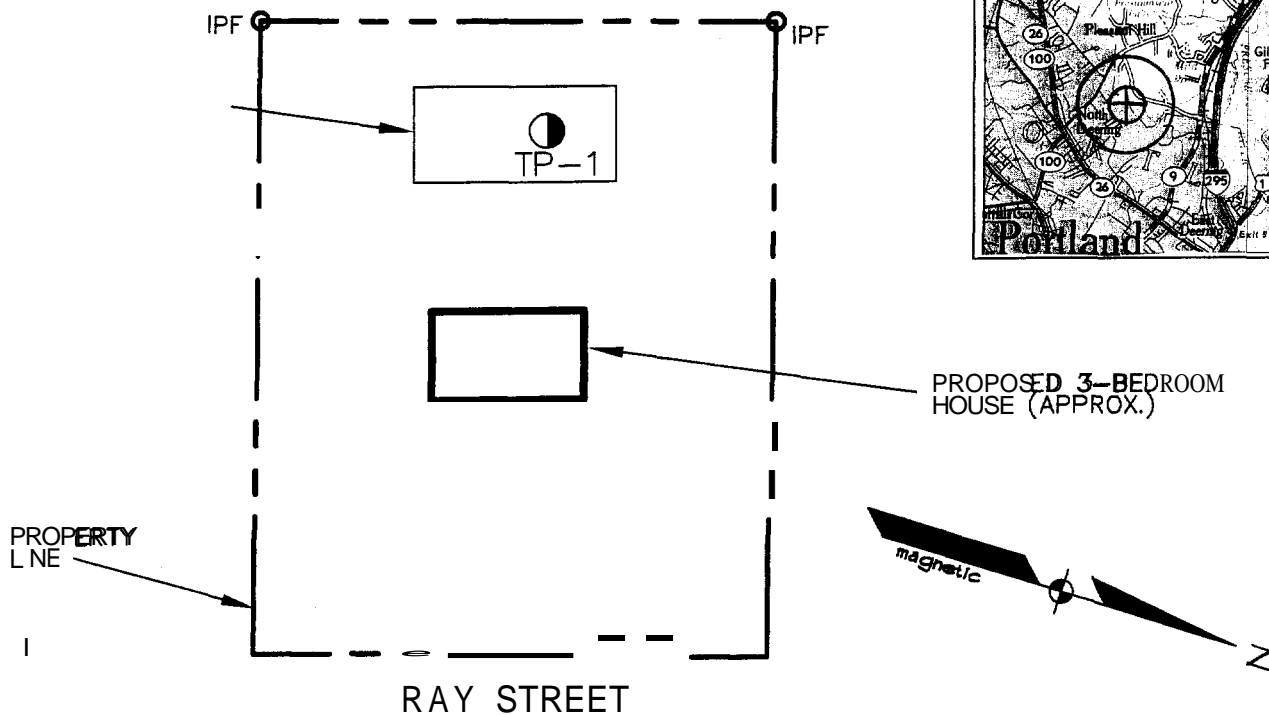

SOIL DESCRIPTION AND CLASSIFICATION

(Location of Observation Holes Shown Above)

Observation Hole TP-1  Test pit  Boring

1-2 " Depth of Organic Horizon Above Mineral Soil

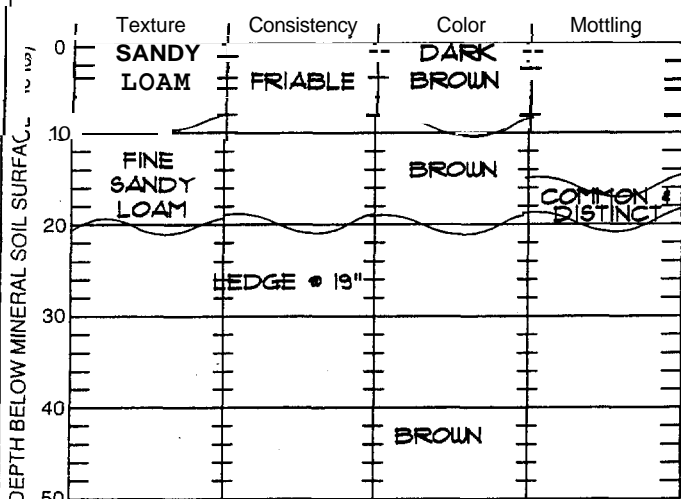

Soil Classification: 2 Profile, C/III Condition  
 Slope: 0-3 %  
 Limiting Factor: 19 "  
 Ground Water  
 Restrictive Layer  
 Bedrock  
 Pit Depth

Observation Hole \_\_\_\_\_  Test pit  Boring

\_\_\_\_\_ " Depth of Organic Horizon Above Mineral Soil

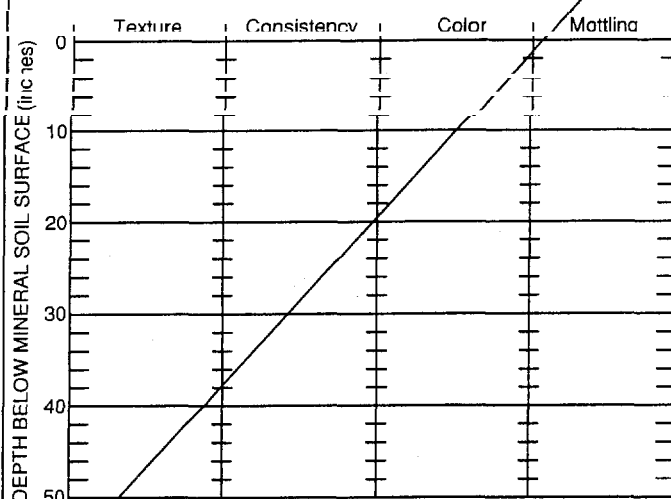

Soil Classification: \_\_\_\_\_ Profile, \_\_\_\_\_ Condition  
 Slope: \_\_\_\_\_ %  
 Limiting Factor: \_\_\_\_\_ "  
 Ground Water  
 Restrictive Layer  
 Bedrock  
 Pit Depth

*John Jordan*  
 Site Evaluator Signature

355  
 SE #

4-8-04  
 Date

# SUBSURFACE WASTEWATER DISPOSAL SYSTEM APPLICATION

Maine Department of Human Services  
 Division of Health Engineering, 10 SFS  
 (207) 287-5672 FAX (207) 287-3165

Town, City, Plantation  
**Portland**

Street, Road, Subdivision  
**Ray Street**

Owner or Applicant Name  
**John Jordan**

## SUBSURFACE WASTEWATER DISPOSAL PLAN

Scale 1" = 20' FT

NOTE ALLOW FOR POSITIVE DRAINAGE  
 AROUND THE LEACHFIELD

NOTE IF A GARBAGE DISPOSAL IS  
 USED, THEN CHANGES TO  
 THIS DESIGN ARE NECESSARY

IPF = IRON PIN FOUND  
 TP = TEST PIT

NOTE CORNER OF BED STAKES WERE  
 PLACED BASED ON COMPASS &  
 TAPE, MAY VARY SLIGHTLY  
 FROM DESIGN

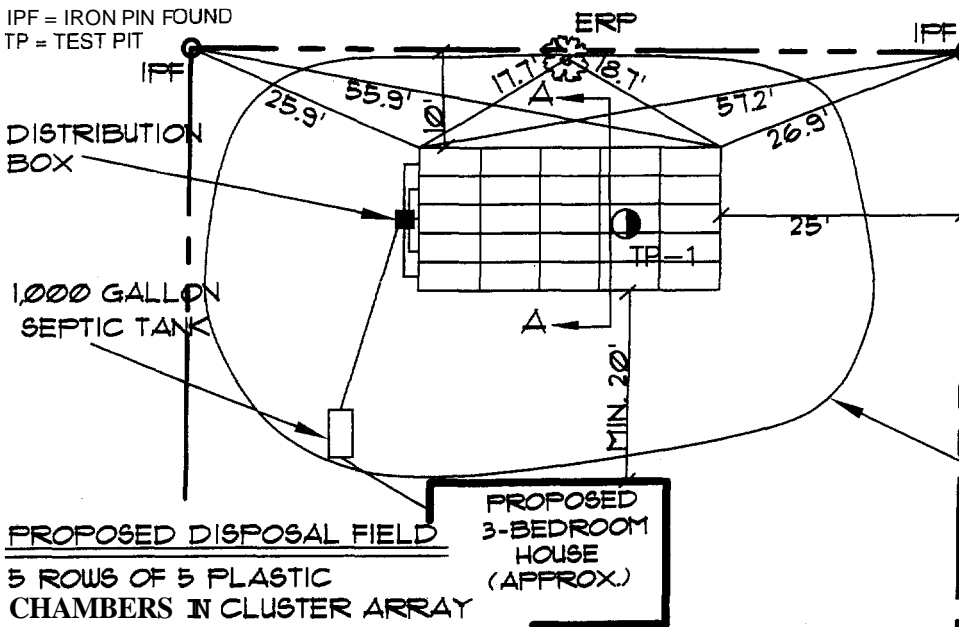

**PROPOSED DISPOSAL FIELD**  
 5 ROWS OF 5 PLASTIC  
 CHAMBERS IN CLUSTER ARRAY

**PROPOSED  
 3-BEDROOM  
 HOUSE  
 (APPROX.)**

NOTE ALL MATERIALS AND INSTALLATION SHALL  
 BE IN ACCORDANCE WITH THE MAINE  
 SUBSURFACE WASTEWATER DISPOSAL RULES  
 DATED 10/02, AS AMENDED, AND SUPPLEMENTED  
 BY THE ATTACHED GENERAL NOTES WHICH  
 BECOME A PART OF THIS DESIGN

### BACKFILL REQUIREMENTS

Depth of Fill (Upslope) **VARIES 35"-51"**  
 Depth of Fill (Downslope) **VARIES 33"-60"**

### CONSTRUCTION ELEVATIONS

Finished Grade Elevation **-8"**  
 Top of Distribution Pipe or Proprietary Device **-20"**  
 Bottom of Disposal Area (Bottom of Stone) **-38"**

### ELEVATION REFERENCE POINT

Location & Description **Nail up**  
**33" in a 16" dia. White Pine**  
 Reference Elevation **0"**

### DISPOSAL FIELD CROSS SECTION

## CROSS SECTION A-A

24" SEPARATION USED IN DESIGN

SCALE  
 VERTICAL: 1" = 3'  
 HORIZONTAL: 1" = 5'

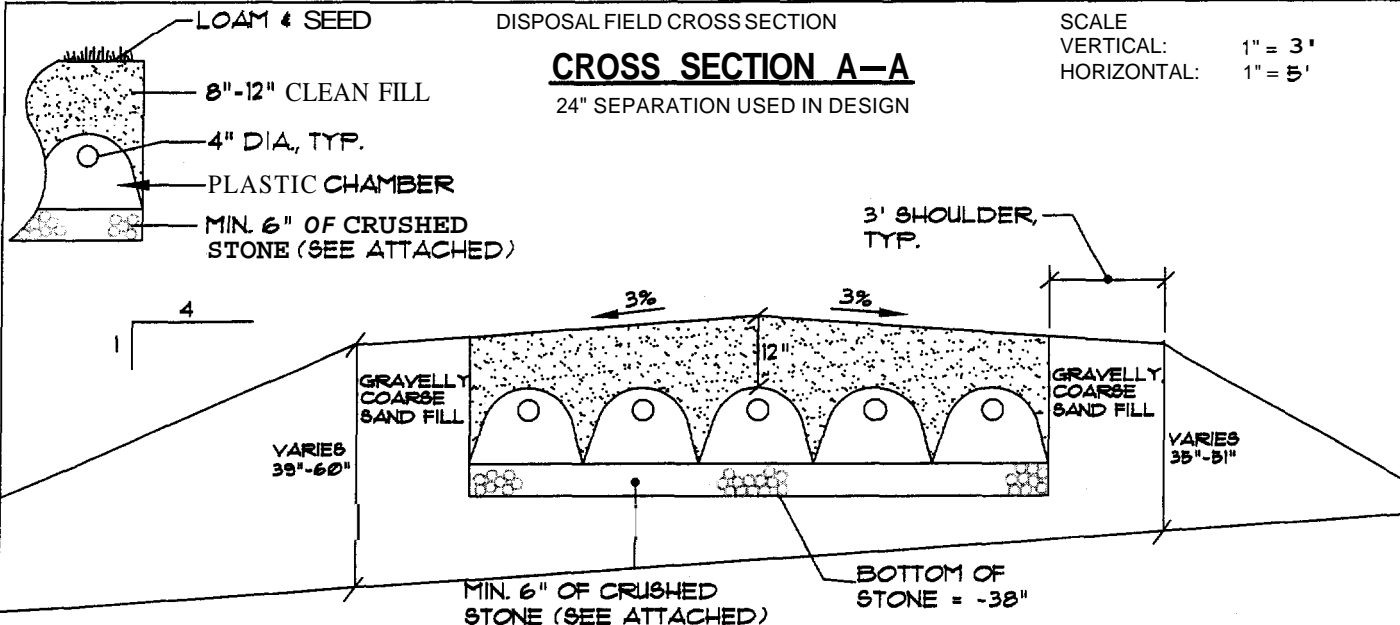

*David A. Lill*  
 Site Evaluator Signature

355  
 SE #

4-8-04  
 Date

Page 3 of 3  
 HHE-200 Rev. 10/02

**(attachment to form HHE-200)**  
**< 1,000 gpd Septic System**

1. The nature of the site evaluation profession is one of interpretation of soil and site conditions. We, in the field, attempt to both provide a satisfactory service to the client, and comply by the rules by which we are bound - The Maine Subsurface Wastewater Disposal Rules. If at any time you, the client, are not satisfied with the service provided or the results found, it is your right to hire another site evaluator for a second opinion.
2. Property information is supplied by the owner, applicant or representative. Such information presented herein **shall** be verified **as** correct by the owner or applicant prior to signing **this** application.
3. All work shall be in accordance with the Maine Subsurface Wastewater Disposal Rules dated 6/00, as amended.
4. All work should be performed under dry conditions only (for disposal area).
5. No vehicular or equipment traffic to be allowed on disposal area. Disposal field shall be constructed from outside the corner stakes located in the field. The downslope area is also to be protected in the same manner.
6. Backfill, if required, **is** to be gravelly coarse sand to coarse sand texture and to be free of foreign debris. If backfill is coarser ~~than~~ original soil, ~~then mix~~ top 4" of backfill and original soil with rototiller.
7. No neighboring wells are apparent (unless **so** indicated) within 100' of disposal area. Owner or applicant shall verify **this** prior to signing the application.
8. The disposal field stone shall be **clean, uniform** in size and free of fines, **dust**, ashes, or **clay**. It shall be no smaller ~~than~~  $\frac{3}{4}$  inch and no larger than  $2\frac{1}{2}$  inches in size (per Section 805.2.3 of the Maine Subsurface Wastewater Disposal Rules).
9. **Minimum** separation distances required (unless reduced by variance or special circumstance).
  - a) wells with water usage of 2000 **or** more gpd or public water supply wells:

<b>Disposal Fields:</b>	<b>300'</b>
<b>Septic Tanks and Holding Tanks:</b>	<b>100'</b>
  - b) any well to disposal area: 100'
  - c) any well to septic tank: 100'
  - d) septic tank or disposal area to lake, river, stream or brook: 100' for major watercourse,  
50' for minor watercourse
  - e) house to treatment tank: 8'
  - f) house to disposal area: 20'
  - For all other separation distances, use separations for less than 1,000 gpd per Maine Subsurface Wastewater Disposal Rules Table 700.2.
9. Location of septic system near a wetland may require a separate permit. As such, the owner, prior to construction of the septic system, shall hire a professional to evaluate proximity of adjacent wetlands and prepare necessary permit applications.
10. Garbage disposals are not recommended and, if installed, are done so at the owner's **risk**. The additional waste load requires increased maintenance frequency, higher potential for failure, and larger septic tanks.
11. Pump **stations**, when required, shall be installed watertight to prevent infiltration of ground and/or surface water.
12. Force mains **and** pressure lines shall be flushed of any foreign material and pumps shall be checked for proper on/off cycle before being put into service.
13. Force **mains**, pump stations, and/or gravity piping subject to freezing shall be installed below frost line or adequately insulated.

April 22, 2004

Division of Health Engineering  
State House Station 10  
Augusta, Maine 04333

Re: Application Variance to Min Lot Size  
Ray Street, Portland

Dear Sir/Madam:

Please find enclosed per your instructions:

- 1.) Copy of Deed
- 2.) Copy of Soils Investigation and HHE-200 Form
- 3.) Copy of Notice Forms sent to Abutters
- 4.) Copy of Notice Forms sent to Municipal Officers  
and Municipal Planning Board
- 5.) A duplicate of this application was delivered to the Portland City Hall
- 6.) A check in the amount of \$50.00
- 7.) Directions: From the intersection of Washington Ave and Allen Ave; take  
Allen Ave Extension East approximately ½ mile to Ray St on right. Subject  
lot is approximately 150' on right. (Abutting 444 Ray Street).

Sincerely,

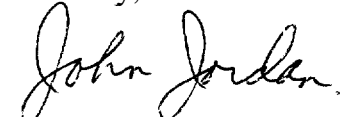
  
John Jordan

**WARRANTY DEED  
(Maine Statutory Short Form)**



**KNOW ALL PERSONS BY THESE PRESENTS**, that **Joan I. Waugh** of **Vista** and **State of California**, for **consideration paid**, **GRANTS to John R Jordan** of **Falmouth, County of Cumberland and State of Maine**, whose **mailing address is 19 Mitchellwood Drive, Falmouth, Maine 04105** with **WARRANTY COVENANTS**, the **land with buildings thereon in Portland, County of Cumberland and State of Maine**, described as follows:

**A certain lot of land, with the buildings thereon**, situated **on the southwesterly side of Ray Street** in the **City of Portland, County of Cumberland and State of Maine**, bounded and **described as follows**:

**Beginning at a point in the said southwesterly side** of **Ray Street**, distant one **hundred (100) feet southeasterly** from ~~its~~ **intersection with the southeasterly side** of **Allen Avenue**; thence **southeasterly, by said side of Ray Street, one hundred fifty-five (155) feet to land now or formerly of Raymond H. Sweetsir**; thence **southwesterly, at right angles, by said Sweetsir land one hundred ten (110) feet to a point**; thence **northwesterly, at right angles and by said Sweetsir land, fifty-five (55) feet to a point**; thence **northeasterly, at right angles and by said Sweetsir land, ten (10) feet to a point**; thence **northwesterly at right angles and by said Sweetsir land, one hundred (100) feet to a point**; thence **northeasterly, at right angles, by said Sweetsir land, one hundred (100) feet, more or less, to said Ray Street at the point of beginning.**

**Meaning and intending to convey the same premises conveyed to the Grantor by deed from Lyndon F. Thurston and Frances E. Thurston, dated November 27, 1963 and recorded in the County Registry of Deeds in Book 2790, Page 464, Lewis A. Waugh** deceased on **May 1, 1993** leaving **Joan I. Waugh as sole surviving tenant.**

**Witness my hand and seal this 24<sup>th</sup> day of October, 2003.**

  
\_\_\_\_\_  
Witness

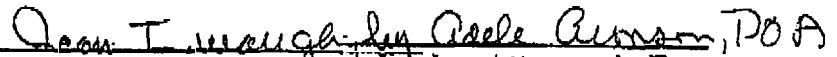
  
\_\_\_\_\_  
**Joan I. Waugh, by Adele Aronson, POA**  
**Joan I. Waugh, by Adele Aronson, her Attorney in Fact**

**STATE OF MAINE  
COUNTY OF CUMBERLAND**

October 24, 2003

Then **personally appeared before me** the above **named Adele Aronson, Attorney in Fact** on behalf of **Joan I. Waugh and acknowledged the foregoing instrument to be her free act and deed.**

Before me,  **OCT 24 2003**  
\_\_\_\_\_  
**Notary Public/ Attorney at Law**

**C. TRENT GRACE  
Notary Public, Maine  
My Commission Expires February 6, 2008**



MULKERIN ASSOCIATES  
REAL ESTATE

# FAX COVER SHEET

Date: 7/1/04

Total Pages: 2

To: Jeanie Bourke

Fax#

From: Greg McCormack

Subject: 450 Kay St. - Dept. Health Engineering.  
Approval.

Enclosed.

CALL US AT (207) 772-2127 IF THERE ARE ANY PROBLEMS.

TO: JOHN JORDAN  
FROM: GREG



STATE OF MAINE  
DEPARTMENT OF HUMAN SERVICES  
BUREAU OF HEALTH, DIVISION OF HEALTH ENGINEERING  
161 CAPITOL STREET  
11 STATE HOUSE STATION  
AUGUSTA, MAINE

JOHN ELIAS BALDACCIO  
GOVERNOR

04333-0011  
May 24, 2004

JOHN R. NICHOLAS  
COMMISSIONER

John Jordan  
426 Forest Avenue  
Portland, ME 04101

SUBJECT: Approval, Minimum Lot Size Waiver, Jordan Property, Ray Street, Portland

Dear Mr. Jordan:

The Division has reviewed a minimum lot size waiver application for the subject property. The proposal is to install a subsurface wastewater disposal system to serve one single family dwelling. This application was submitted in accordance with Title 12 MRSA §4807-B. The lot is 8,000 square feet and 20,000 square feet are required. The lot would be served by public water and onsite sewage disposal. No additional variances to the Maine Subsurface Waste Water Disposal Rules are required.

Pursuant to the language provided in 12MRSA §4807-B, which is the sole basis for our review, we find that based upon the subsurface wastewater disposal system design prepared by Gary Fullerton, SE, on April 8, 2004, and submitted with the application; the amount and nature of wastes, expected construction standards of the subsurface disposal system, soil types and slopes, percolation rates, depth to bedrock and groundwater, and the density of any proposed development, the proposed subsurface waste disposal system meets the current rules and as a result, is therefore considered to not lower the water quality of, or otherwise pose a threat to, any lake, pond, stream, river or tidal waters, any underground water supply, or to the public health, safety and general welfare.

Because the subsurface wastewater disposal system design has been found to be in compliance with the Maine Subsurface Wastewater Disposal Rules, we hereby approve your application for a waiver to the Minimum Lot Size law. This approval requires the following:

1. A permit for system installation shall be obtained from the Local Plumbing Inspector in advance of the start of system construction.
2. The system shall be constructed in accordance with the submitted and approved system design. Should alterations to the design be necessary at the time of construction, including addition of a garbage grinder in the proposed dwelling, the site evaluator shall be contacted prior to making any changes.
3. The approval is based only on the rules administered by this Department. The approval of the septic system for this proposal does not relieve the property owner from compliance with all other state and local requirements for licensing, permitting, system installation and/or use.
4. By accepting this approval and the associated plumbing permit, the owner agrees to comply fully with the conditions of approval and the Subsurface Wastewater Disposal Rules.

Because installation and owner maintenance has a significant effect on the working order of onsite sewage disposal systems, including their components, the Division makes no representation or guarantee as to the efficiency and/or operation of the system.

Should you or others have any questions please feel free to contact me at 287-5695.

Sincerely,

James A. Jacobsen, Environmental Specialist IV  
Wastewater and Plumbing Control Program  
Division of Health Engineering  
e-mail: james.jacobsen@maine.gov

JUL 1 2004

RECEIVED

cc: Fib  
Michael Nugent, LPI  
Gary Fullerton, SE

PHONE: (207) 287-5338  
TTY: Deaf/Hard of Hearing (207)287-5550

FAX: Admin./Plumbing/Eating S. Lodging: (207) 287-3165  
Drinking Water: (207) 287-4172  
Radiation Control: (207)287-3059