

C BUILDING SECTION
3/8"=1'-0" BREEZWAY

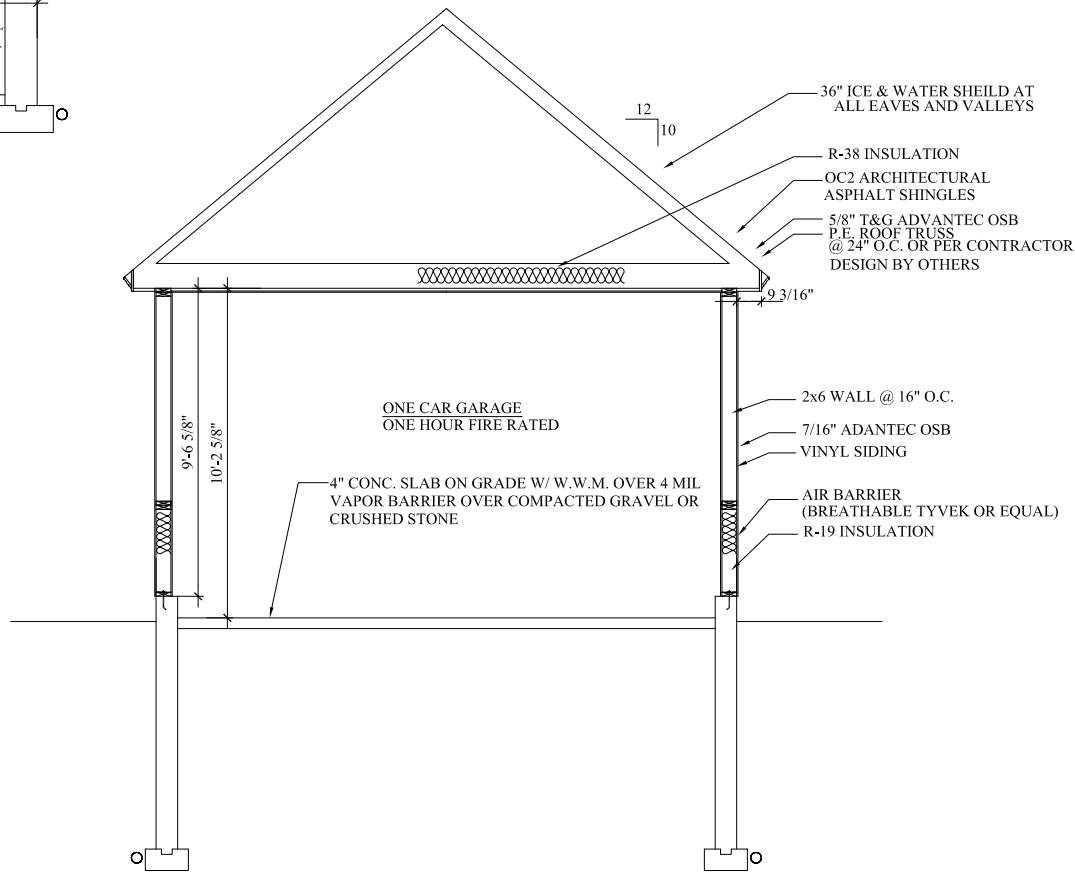

D BUILDING SECTION
3/8"=1'-0" GARAGE

THIS P.E. REVIEW COVERS STRUCTURAL FRAMING MEMBERS DENOTED BY (ADP) ONLY. DESIGN AND DETAIL FOR FOUNDATION ELEMENTS, FRAMING CONNECTIONS (UNLESS OTHERWISE NOTED), COMPONENTS AND CLADDING, FINISHES, FLOOR PLAN LAYOUT, AND LIFE SAFETY CODE REQUIREMENTS HAVE NOT BEEN REVIEWED AND ARE BEYOND THE PURVIEW OF THIS P.E. SEAL. USE OF THESE DRAWINGS INDICATES OWNER/CONTRACTOR AGREEMENT TO THESE TERMS.

- NOTES:
1. ALL BEAMS ARE 1.9E PARALAMS UNLESS OTHERWISE NOTED.
 2. ALL SPECIFIED HEADER POST ARE "JACK STUDS" & SHOULD EXTEND TO THE UNDERSIDE OF HEADER. CONTRACTOR SHOULD PROVIDE (1) 2xKING STUD.
 3. QUANTITY OF (2) 2x'S BUILT UP POSTS ARE NUMBER REQ'D @ EACH END OF HEADER UNLESS OTHERWISE NOTED.
 4. ALL NEW STRUCTURAL POSTS SHALL CONTINUE DOWN TO NEXT FLOOR LEVEL.
 5. GENERAL CONTRACTOR TO COMPLY WITH BOCA 1999 TABLE 2305.2 FASTENING SCHEDULE.
 6. ALL STRUCTURAL STEEL TO BE ASTM 992 FY=50 KSI.

THE PROFESSIONAL SEAL AND SIGNATURE OF THE ENGINEER ARE REQUIRED FOR ALL DRAWINGS. THE ENGINEER'S SEAL AND SIGNATURE ARE REQUIRED FOR ALL DRAWINGS. THE ENGINEER'S SEAL AND SIGNATURE ARE REQUIRED FOR ALL DRAWINGS. THE ENGINEER'S SEAL AND SIGNATURE ARE REQUIRED FOR ALL DRAWINGS.

BUILDING SECTIONS

CHAMBERLAIN CONSTRUCTION
1022 PORTLAND ROAD
SACO ME
PHONE: 262-7577

Builder's Name and Address

2.	8/29/05	ENGINEER REV.
	8/17/05	
		FINAL
No.	Revision/Issue	Date

Project	WHITE	Sheet
Date	5/19/05	S3
Scale	1/4"=1'-0"	