

THE PRINCIPLES OF CHAMBERLAIN CONSTRUCTION ARE NOT PROVIDED FOR GENERAL INFORMATIONAL PURPOSES AND ARE NOT TO BE USED FOR ANY OTHER PURPOSES WITHOUT THE WRITTEN PERMISSION OF CHAMBERLAIN CONSTRUCTION, INC. ALL CONSTRUCTION AND ARCHITECTURE ARE SUBJECT TO THE HEIGHTS AND CONDITIONS OF THE SITE. ALL CONDITIONS AND WARRANTIES ARE MADE WITH REGARD TO THESE CONCEPTUAL DRAWINGS.

**BUILDING SECTIONS**

**CHAMBERLAIN CONSTRUCTION**  
 1022 PORTLAND ROAD  
 SACO, ME  
 PHONE: 262-7577

Builders Name and Address

2.	8/29/05	ENGINEER	REV.
	8/17/05		
		FINAL	
No.	Revision/Issue	Date	

Project	WHITE	Sheet	S2
Date	5/19/05		
Scale	1/4"=1'-0"		

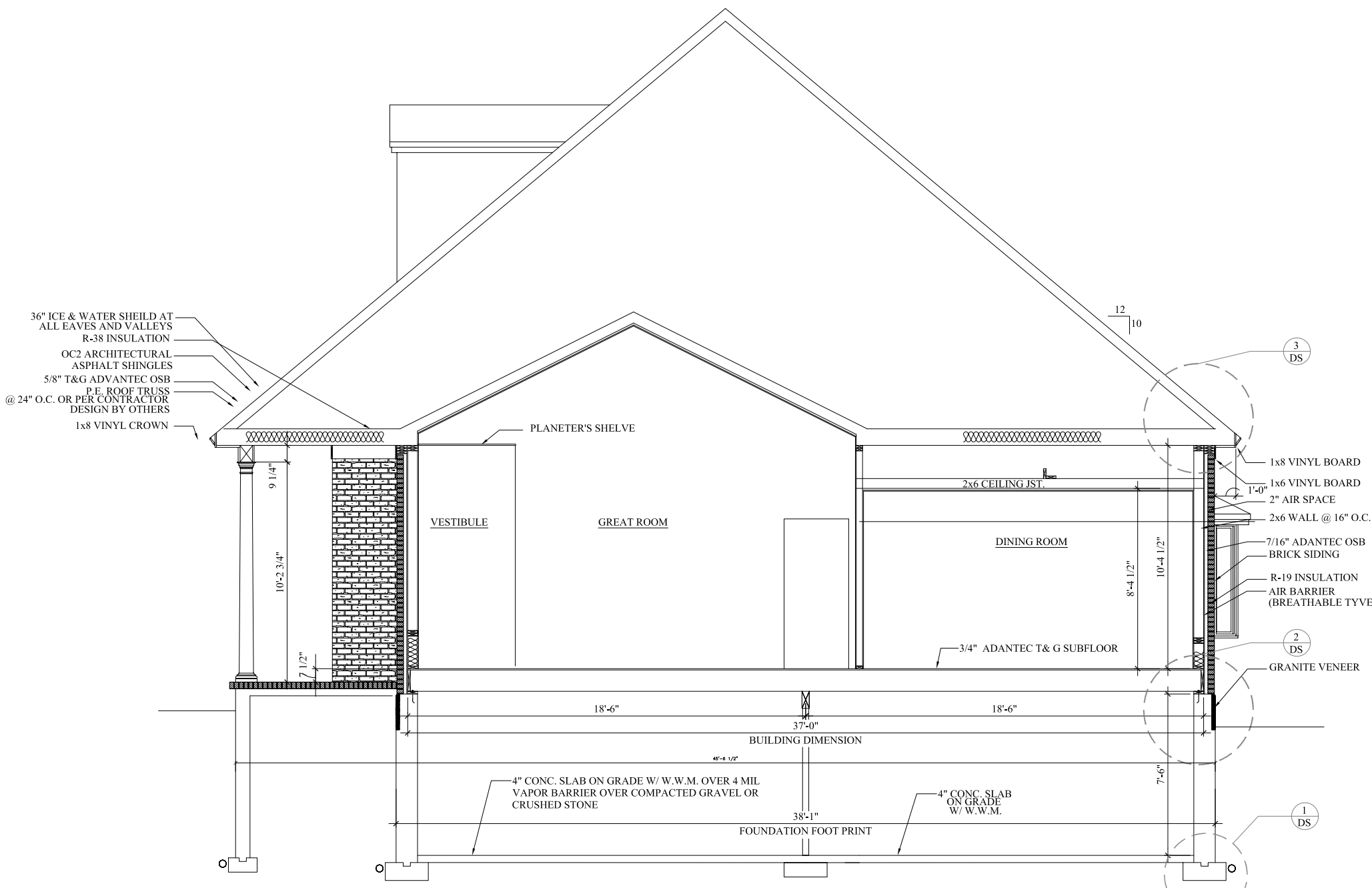

- 36" ICE & WATER SHIELD AT ALL EAVES AND VALLEYS
- R-38 INSULATION
- OC2 ARCHITECTURAL ASPHALT SHINGLES
- 5/8" T&G ADVANTEC OSB
- P.E. ROOF TRUSS @ 24" O.C. OR PER CONTRACTOR DESIGN BY OTHERS
- 1x8 VINYL CROWN

- 1x8 VINYL BOARD
- 1x6 VINYL BOARD
- 2" AIR SPACE
- 2x6 WALL @ 16" O.C.
- 7/16" ADANTEC OSB
- BRICK SIDING
- R-19 INSULATION
- AIR BARRIER (BREATHABLE TYVEK OR EQUAL)

THIS P.E. REVIEW COVERS STRUCTURAL FRAMING MEMBERS DENOTED BY (ADP) ONLY. DESIGN AND DETAIL FOR FOUNDATION ELEMENTS, FRAMING CONNECTIONS (UNLESS OTHERWISE NOTED), COMPONENTS AND CLADDING, FINISHES, FLOOR PLAN LAYOUT, AND LIFE SAFETY CODE REQUIREMENTS HAVE NOT BEEN REVIEWED AND ARE BEYOND THE PURVIEW OF THIS P.E. SEAL. USE OF THESE DRAWINGS INDICATES OWNER/CONTRACTOR AGREEMENT TO THESE TERMS.

- NOTES:
1. ALL BEAMS ARE 1.9E PARALAMS UNLESS OTHERWISE NOTED.
  2. ALL SPECIFIED HEADER POST ARE "JACK STUDS" & SHOULD EXTEND TO THE UNDERSIDE OF HEADER. CONTRACTOR SHOULD PROVIDE (1) 2xKING STUD.
  3. QUANTITY OF (2) 2x'S BUILT UP POSTS ARE NUMBER REQ'D @ EACH END OF HEADER UNLESS OTHERWISE NOTED.
  4. ALL NEW STRUCTURAL POSTS SHALL CONTINUE DOWN TO NEXT FLOOR LEVEL.
  5. GENERAL CONTRACTOR TO COMPLY WITH BOCA 1999 TABLE 2305.2 FASTENING SCHEDULE.
  6. ALL STRUCTURAL STEEL TO BE ASTM 992 FY=50 KSI.

**B BUILDING SECTION**  
 3/8"=1'-0"