

PERMIT ISSUED

City of Portland, Maine - Building or Use Permit Application
 389 Congress Street, 04101 Tel: (207) 874-8703, Fax: (207) 874-8716

Permit No: 03-1049	Issue Date: AUG 27 2003	CBL: 397 C013001
-----------------------	-----------------------------------	---------------------

Location of Construction: 81 Deepwood Dr	Owner Name: Moran David P &	Owner Address: 81 Deepwood Dr CITY OF PORTLAND	Phone: 878-3294
Business Name:	Contractor Name: Namco Pools	Contractor Address: Larabee Road Westbrook	Phone:
Lessee/Buyer's Name	Phone:	Permit Type: Swimming Pools	Zone: R2

Past Use: Single Family	Proposed Use: Single Family w/swimming pool	Permit Fee: \$57.00	Cost of Work: \$4,000.00	CEO District: 2
----------------------------	--	------------------------	-----------------------------	--------------------

FIRE DEPT: <input type="checkbox"/> Approved <input type="checkbox"/> Denied	INSPECTION: Use Group: R3 Type: POOL BOCA 1999
--	---

Proposed Project Description:
 Install 15x30x52" oval above ground swimming pool to existing deck

Signature: _____ Date: **8/27/03**

Signature: **JMB** Date: **8/27/03**

Signature: _____ Date: _____

Permit Taken By: jmb	Date Applied For: 08/27/2003	Zoning Approval	
-------------------------	---------------------------------	------------------------	--

1. This permit application does not preclude the Applicant(s) from meeting applicable State and Federal Rules. 2. Building permits do not include plumbing, septic or electrical work. 3. Building permits are void if work is not started within six (6) months of the date of issuance. False information may invalidate a building permit and stop all work..	Special Zone or Reviews <input type="checkbox"/> Shoreland <input type="checkbox"/> Wetland <i>Approved</i> <input type="checkbox"/> Flood Zone <i>10' setback</i> <input type="checkbox"/> Subdivision <input type="checkbox"/> Site Plan Maj <input type="checkbox"/> Minor <input type="checkbox"/> MM <input type="checkbox"/> Date: 8/27/03 JMB	Zoning Appeal <input type="checkbox"/> Variance <input type="checkbox"/> Miscellaneous <input type="checkbox"/> Conditional Use <input type="checkbox"/> Interpretation <input type="checkbox"/> Approved <input type="checkbox"/> Denied Date: _____	Historic Preservation <input checked="" type="checkbox"/> Not in District or Landmark <input type="checkbox"/> Does Not Require Review <input type="checkbox"/> Requires Review <input type="checkbox"/> Approved <input type="checkbox"/> Approved w/Conditions <input type="checkbox"/> Denied Date: JMB
--	---	--	--

CERTIFICATION

I hereby certify that I am the owner of record of the named property, or that the proposed work is authorized by the owner of record and that I have been authorized by the owner to make this application as his authorized agent and I agree to conform to all applicable laws of this jurisdiction. In addition, if a permit for work described in the application is issued, I certify that the code official's authorized representative shall have the authority to enter all areas covered by such permit at any reasonable hour to enforce the provision of the code(s) applicable to such permit.

SIGNATURE OF APPLICANT	ADDRESS	DATE	PHONE
RESPONSIBLE PERSON IN CHARGE OF WORK, TITLE		DATE	PHONE

City of Portland, Maine - Building or Use Permit

389 Congress Street, 04101 Tel: (207) 874-8703, Fax: (207) 874-8716

Permit No: 03-1049	Date Applied For: 08/27/2003	CBL: 397 C013001
------------------------------	--	----------------------------

Location of Construction: 81 Deepwood Dr	Owner Name: Moran David P &	Owner Address: 81 Deepwood Dr	Phone: () 878-3294
Business Name:	Contractor Name: Namco Pools	Contractor Address: Larabee Road Westbrook	Phone:
Lessee/Buyer's Name	Phone:	Permit Type: Swimming Pools	

Proposed Use: Single Family w/swimming pool	Proposed Project Description: Install 15x30x52" oval above ground swimming pool to existing deck
---	--

Dept: Zoning	Status: Approved	Reviewer: Jeanine Bourke	Approval Date: 08/27/2003
Note:			Ok to Issue: <input checked="" type="checkbox"/>
Dept: Building	Status: Approved	Reviewer: Jeanine Bourke	Approval Date: 08/27/2003
Note:			Ok to Issue: <input checked="" type="checkbox"/>
1) Permit approved to meet Sec. 421 of BOCA 1999			

Permit required for electrical -

BUILDING PERMIT INSPECTION PROCEDURES

Please call 874-8703 or ~~874-8693~~ to schedule your inspections as agreed upon

Permits expire in 6 months, if the project is not started or ceases for 6 months.

The Owner or their designee is required to notify the inspections office for the following inspections and provide adequate notice. Notice must be called in 48-72 hours in advance in order to schedule an inspection:

By initializing at each inspection time, you are agreeing that you understand the inspection procedure and additional fees from a "Stop Work Order" and "Stop Work Order Release" will be incurred if the procedure is not followed as stated below.

JB **Pre-construction Meeting:** Must be scheduled with your inspection team upon receipt of this permit. Jay Reynolds, Development Review Coordinator at ~~874-8632~~ must also be contacted at this time, before any site work begins on any project other than single family additions or alterations.

Footing/Building Location Inspection: Prior to pouring concrete

NA **Re-Bar Schedule Inspection:** Prior to pouring concrete

NA **Foundation Inspection:** Prior to placing ANY backfill

~~NA~~ **Framing/Rough Plumbing/Electrical:** Prior to any insulating or drywalling

Final Certificate of Occupancy: Prior to any occupancy of the structure or use. NOTE: There is a ~~\$75.00~~ fee per inspection at this point.
Complete

Certificate of Occupancy is not required for certain projects. Your inspector can advise you if your project requires a Certificate of Occupancy. All projects DO require a final inspection

If any of the inspections do not occur, the project cannot go on to the next phase, REGARDLESS OF THE NOTICE OR CIRCUMSTANCES.

NA **CERIFICATE OF OCCUPANICES MUST BE ISSUED AND PAID FOR, BEFORE THE SPACE MAY BE OCCUPIED**

[Signature]
Signature of applicant/designee

8-27-03

Date

[Signature]
Signature of Inspections Official

8/27/03
Date

CBL: 397-C-13 Building Permit #: 03-1049

DISPLAY THIS CARD ON PRINCIPAL FRONTAGE OF WORK

CITY OF PORTLAND

BUILDING DEPARTMENT

PERMIT ISSUED

PERMIT

Permit Number: 031049

AUG 27 2003

Please Read Application And Notes, If Any, Attached

This is to certify that Moran David P &/Namco Po

has permission to Install 15x30x52" oval above ground swimming pool to existing deck **CITY OF PORTLAND**

AT 81 Deepwood Dr 397 C013001

provided that the person or persons, firm or corporation accepting this permit shall comply with all of the provisions of the Statutes of the State and of the Ordinances of the City of Portland regulating the construction, maintenance and use of buildings and structures, and of the application on file in this department.

Apply to Public Works for street line and grade if nature of work requires such information.

Notification of inspection must be given and written permission procured before this building or part thereof is opened or enclosed-in. **48 HOUR NOTICE IS REQUIRED.**

A certificate of occupancy must be procured by owner before this building or part thereof is occupied.

OTHER REQUIRED APPROVALS

Fire Dept. _____
Health Dept. _____
Appeal Board _____
Other _____
Department Name _____

James Burke 8/27/03
Director - Building & Inspection Services

PENALTY FOR REMOVING THIS CARD

Pool Installation/Construction Permit Application

If you or the property owner owes real estate or personal property taxes or user charges on any property within the City, payment arrangements must be made before permits of any kind are accepted.

Location/Address of Construction: <u>81 Deepwood Drive</u>		
Total Square Footage of Proposed Structure <u>450</u>	Square Footage of Lot <u>10,073</u>	
Tax Assessor's Chart, Block & Lot Chart# <u>397</u> Block# <u>C</u> Lot# <u>13</u>	Owner: <u>David & Lauri-Ann Moran</u>	Telephone: <u>878-3294</u>
Lessee/Buyer's Name (If Applicable)	Applicant name, address & telephone:	Cost of Fee <u>Work</u> : \$ <u>51.00</u> Fee: \$ <u>3436.85</u> \$500 + <u>Gate</u> = <u>4,000</u>
Dimensions of pool: <u>15'x30'x52'</u> Above or below ground: <u>Above</u>		
Dimensions of decking and/or any platforms, sheds, or other structures: _____		
Contractor's name, address & telephone:		
Whom should we contact when the permit is ready: <u>Lauri-Ann Moran</u>		
Mailing address: <u>81 Deepwood Drive</u> <u>Portland, Maine 04103</u>		
We will contact you by phone when the permit is ready. You must come in and pick up the permit and review the requirements before starting any work, with a Plan Reviewer. A stop work order will be issued and a \$100.00 fee if any work starts before the permit is picked up. PHONE:		

IF THE REQUIRED INFORMATION IS NOT INCLUDED IN THE SUBMISSIONS THE PERMIT WILL BE AUTOMATICALLY DENIED AT THE DISCRETION OF THE BUILDING/PLANNING DEPARTMENT, WE MAY REQUIRE ADDITIONAL INFORMATION IN ORDER TO APPROVE THIS PERMIT.

I hereby certify that I am the Owner of record of the named property, or that the owner of record authorizes the proposed work and that I have been authorized by the owner to make this application as his/her authorized agent. I agree to conform to all applicable laws of this jurisdiction. In addition, if a permit for work described in this application is issued, I certify that the Code Official's authorized representative shall have the authority to enter all areas covered by this permit at any reasonable hour to enforce the provisions of the codes applicable to this permit.

Signature of applicant: <u>Lauri-Ann Moran</u>	Date: <u>8/27/03</u>
--	----------------------

**This is NOT a permit; you may not commence ANY work until the permit is issued.
If you are in a Historic District you may be subject to additional permitting
and fees with the Planning Department on the 4th floor of City Hall**

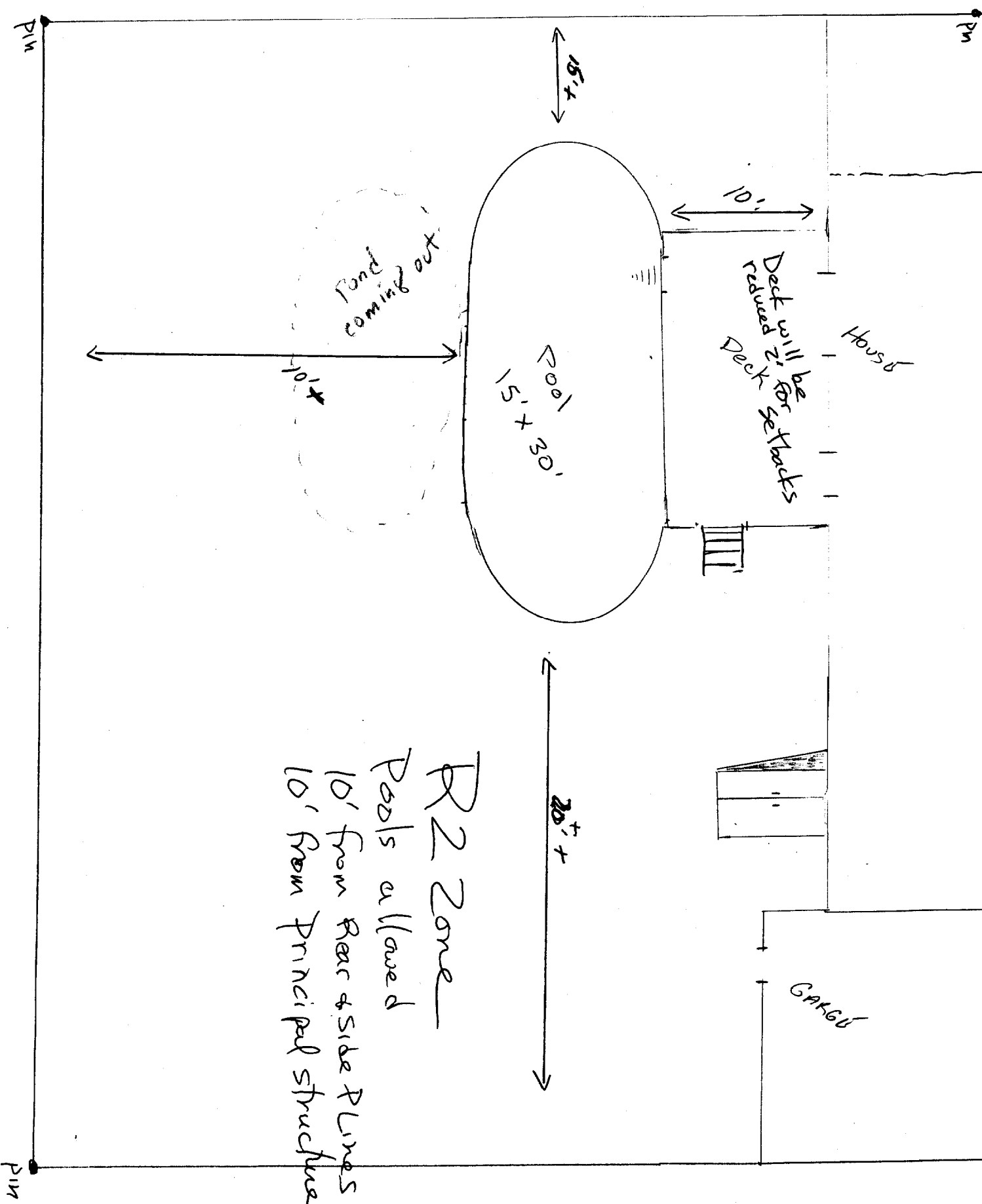

R2 Zone
 Pools allowed
 10' from Rear & side P Lines
 10' from Principal structure

This page contains a detailed description of the Parcel ID you selected. Press the **New Search** button at the bottom of the screen to submit a new query.

Current Owner Information

Card Number 1 of 1
Parcel ID 397 C013001
Location 81 DEEPWOOD DR
Land Use SINGLE FAMILY

Owner Address MORAN DAVID P & LAURI-ANN MCLELLAN JTS
 81 DEEPWOOD DR
 PORTLAND ME 04103

Book/Page 14198/125
Legal 397-C-13
 DEEPWOOD DR 79-83
 10013 SF

Valuation Information

Land	Building	Total
\$39,270	\$174,620	\$213,890

Property Information

Year Built 1988	Style Colonial	Story Height 2	Sq. Ft. 2184	Total Acres 0.23		
Bedrooms 4	Full Baths 2	Half Baths 1	Total Rooms 8	Attic None	Basement Full	

Outbuildings

Type	Quantity	Year Built	Size	Grade	Condition
-------------	-----------------	-------------------	-------------	--------------	------------------

Sales Information

Date	Type	Price	Book/Page
10/05/1998	LAND + BLDING	\$212,000	14198-125
03/01/1996	LAND + BLDING	\$197,000	12378-212

Picture and Sketch

Picture Sketch

[Click here](#) to view Tax Roll Information.

Any information concerning tax payments should be directed to the Treasury office at 874-8490 or e-mailed.





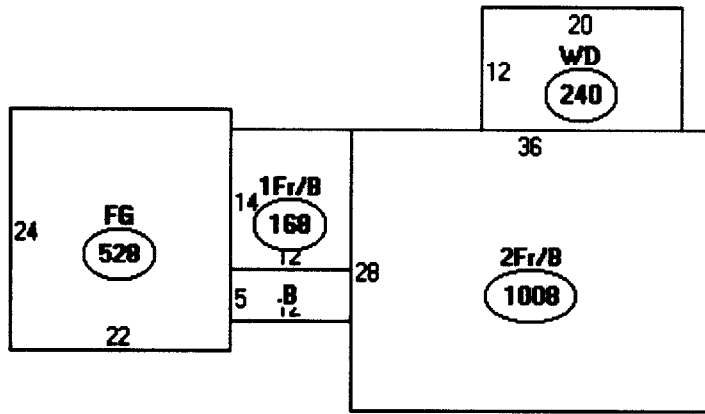

Descriptor/Area

A: 2Fr/B
1008 sqft

B: OFP
60 sqft

C: 1Fr/B
168 sqft

D: FG
528 sqft

E: WD
240 sqft

Door and Window Alarm with Key Lock

49-424 **A**

OWNER'S MANUAL — Please read before using this equipment.

Thank you for purchasing a RadioShack Door and Window Alarm. Your alarm is your 24 hour "electronic sentry." The alarm can sound instantly, or after a delay that gives you time to disarm it. Disarming the alarm is easy using one of the two supplied keys.

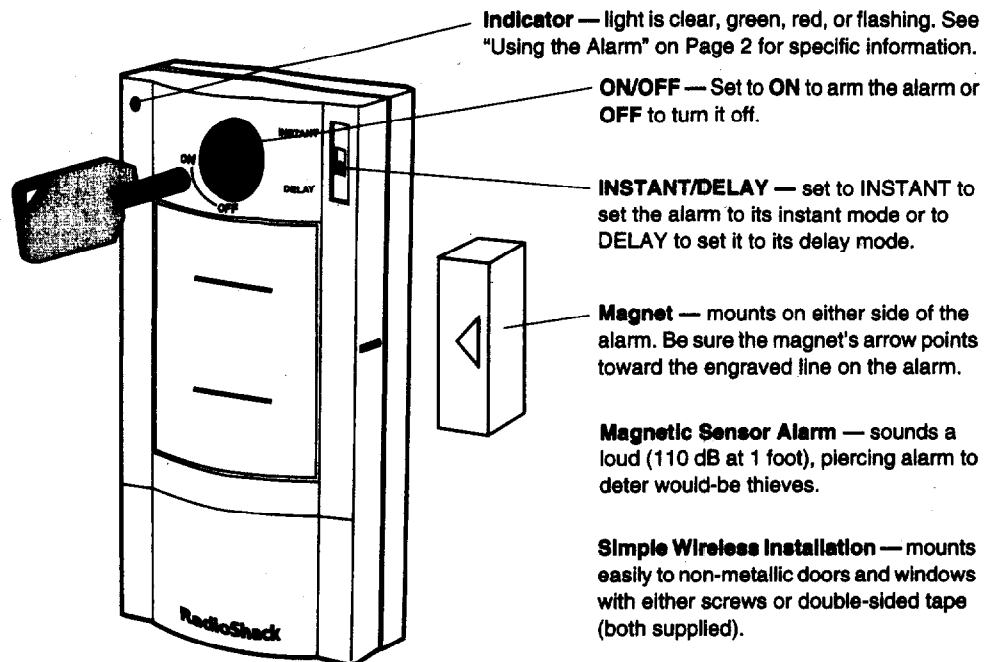

PREPARATION

INSTALLING BATTERIES

Your alarm requires two AAA batteries (not supplied) for power. For the best performance and longest life, we recommend RadioShack alkaline batteries.

1. Use a small Phillips screwdriver to loosen the screw on the bottom of the alarm, then slide the cover down to remove it.
2. Place the batteries in the compartment as indicated by the polarity symbols (+ and -) marked inside.
3. Replace the cover and secure it with the screw.

Replace the batteries when the alarm's indicator flashes red or when its sound weakens. If the alarm does not work after you replace the batteries, remove and reinstall the batteries. ⚠

MOUNTING THE ALARM

You can mount the alarm using screws or double sided mounting tape (both supplied).

Selecting a Location

Choose a location that lets you install the magnet on a door or window and the alarm next to it on the frame, or vice versa.

Be sure to align the alarm and the magnet so they are mounted no more than $\frac{5}{16}$ -inch (8 mm) apart, with the magnet's arrow pointing toward one of the engraved lines on the side of the alarm. ⚠

Using Screws

1. Use the supplied drilling template to mark the locations for the alarm and magnet's mounting screws.
2. Drill holes $\frac{1}{16}$ -inch (2 mm) in diameter at the marked locations.
3. Thread one of the supplied screws into hole A until the screw's head extends about $\frac{1}{8}$ -inch (3 mm) from the mounting surface.

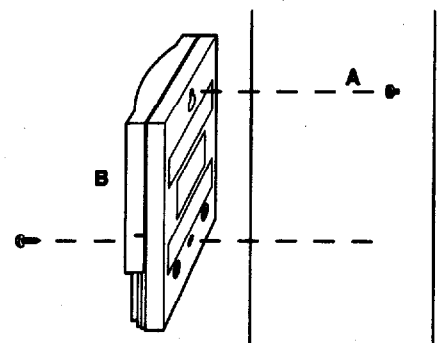

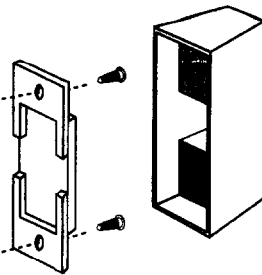
4. Align the keyhole slot on the back of the alarm with the screw, then slide the alarm down onto the screw to secure it.
5. Remove the battery compartment cover and the batteries. Then thread a screw into hole B. Reinstall the batteries and replace the cover.
6. Use a small flat-head screwdriver to detach the mounting bracket from the back of the magnet. 
7. Use the two remaining screws to mount the mounting bracket.
8. Snap the magnet onto the mounting bracket. Make sure the magnet's arrow points toward one of the engraved lines on either side of the alarm.

When you set **ON/OFF** to **ON**, the indicator lights green for about 12–18 seconds before the alarm is armed, giving you time to exit and close the door. After about 12–18 seconds, the alarm arms and the indicator turns off. !

When you return home and open the secured door, you have about 12 seconds to disarm (turn off) the alarm. The indicator lights red during this entry delay.

After the 12-second delay has expired, the alarm sounds for 90 seconds, then automatically turns off. To silence the alarm sooner, set **ON/OFF** to **OFF**.

If the alarm is triggered while you are out, the indicator alternately slowly flashes green and lights red to indicate an intrusion occurred, until the alarm is set to **OFF**.

LOW BATTERY INDICATION

If the battery is low, the indicator flashes red, whether the alarm is set to **ON** or **OFF**. Replace the batteries. ☑

CARE

Keep the alarm dry; if it gets wet, wipe it dry immediately. Use and store the alarm only in normal temperature environments. Handle the alarm carefully; do not drop it. Keep the alarm away from dust and dirt, and wipe it with a damp cloth occasionally to keep it looking new.

SERVICE AND REPAIR

If your alarm is not performing as it should, take it to your local RadioShack store for assistance. Modifying or tampering with the alarm's internal components can cause a malfunction and might invalidate its warranty.

SPECIFICATIONS

Power Source	2 × 1.5 V AAA Batteries
Operation Voltage	2.4V Minimum
Current Drain at 3V:	
Standby Mode	0.04 mA Limit (0.05 mA Maximum)
Alarm Sounding	150 mA Nominal (200 mA Maximum)
Alarm Frequency	3 kHz ± 25%
Alarm Cycle Frequency	5 Hz ± 25%
Operating Temperature	32 – 122°F (0 – 50°C)
Dimensions (HWD)	4 ¹ / ₈ × 2 ¹ / ₈ × 1 in. (105 × 54 × 25.4 mm)
Weight	3.17 oz (98.6 g)

Specifications are typical; individual units might vary. Specifications are subject to change and improvement without notice.

NOTE

The indicator also flashes red, even while it flashes green to indicate an intrusion occurred.

Limited Ninety-Day Warranty

This product is warranted by RadioShack against manufacturing defects in material and workmanship under normal use for ninety (90) days from the date of purchase from RadioShack company-owned stores and authorized RadioShack franchisees and dealers. EXCEPT AS PROVIDED HEREIN, RadioShack MAKES NO EXPRESS WARRANTIES AND ANY IMPLIED WARRANTIES, INCLUDING THOSE OF MERCHANTABILITY AND FITNESS FOR A PARTICULAR PURPOSE, ARE LIMITED IN DURATION TO THE DURATION OF THE WRITTEN LIMITED WARRANTIES CONTAINED HEREIN. EXCEPT AS PROVIDED HEREIN, RadioShack SHALL HAVE NO LIABILITY OR RESPONSIBILITY TO CUSTOMER OR ANY OTHER PERSON OR ENTITY WITH RESPECT TO ANY LIABILITY, LOSS OR DAMAGE CAUSED DIRECTLY OR INDIRECTLY BY USE OR PERFORMANCE OF THE PRODUCT OR ARISING OUT OF ANY BREACH OF THIS WARRANTY, INCLUDING, BUT NOT LIMITED TO, ANY DAMAGES RESULTING FROM INCONVENIENCE, LOSS OF TIME, DATA, PROPERTY, REVENUE, OR PROFIT OR ANY INDIRECT, SPECIAL, INCIDENTAL, OR CONSEQUENTIAL DAMAGES, EVEN IF RadioShack HAS BEEN ADVISED OF THE POSSIBILITY OF SUCH DAMAGES.

Some states do not allow limitations on how long an implied warranty lasts or the exclusion or limitation of incidental or consequential damages, so the above limitations or exclusions may not apply to you.

In the event of a product defect during the warranty period, take the product and the RadioShack sales receipt as proof of purchase date to any RadioShack store. RadioShack will, at its option, unless otherwise provided by law: (a) correct the defect by product repair without charge for parts and labor; (b) replace the product with one of the same or similar design; or (c) refund the purchase price. All replaced parts and products, and products on which a refund is made, become the property of RadioShack. New or reconditioned parts and products may be used in the performance of warranty service. Repaired or replaced parts and products are warranted for the remainder of the original warranty period. You will be charged for repair or replacement of the product made after the expiration of the warranty period.

This warranty does not cover: (a) damage or failure caused by or attributable to acts of God, abuse, accident, misuse, improper or abnormal usage, failure to follow instructions, improper installation or maintenance, alteration, lightning or other incidence of excess voltage or current; (b) any repairs other than those provided by a RadioShack Authorized Service Facility; (c) consumables such as fuses or batteries; (d) cosmetic damage; (e) transportation, shipping or insurance costs; or (f) costs of product removal, installation, set-up service adjustment or reinstallation. This warranty gives you specific legal rights, and you may also have other rights which vary from state to state.

RadioShack Customer Relations, 200 Taylor Street, 8th Floor, Fort Worth, TX 76102

USING THE ALARM

INSTANT ACTIVATION

To arm the alarm while you are at home, set **INSTANT/DELAY** to **INSTANT** then use one of the supplied keys to set **ON/OFF** on the front of the alarm to **ON**.

If the secured door or window is opened and the magnet moves away from the alarm unit, a piercing alarm sounds for about 90 seconds, or until you set **ON/OFF** to **OFF**.

After 90 seconds, the alarm turns off and the indicator slowly flashes green.

When the alarm sounds, use the key to set **ON/OFF** to **OFF** to silence it.

EXIT/ENTRY DELAY

To arm the alarm when you leave the house, close the secured door or window, set **INSTANT/DELAY** to **DELAY**, then set **ON/OFF** to **ON**.

GATE TO FIT INTO EXISTING SPAC W/IN VERIFY WITH 36" ±

GATE LATCH INSIDE DECK

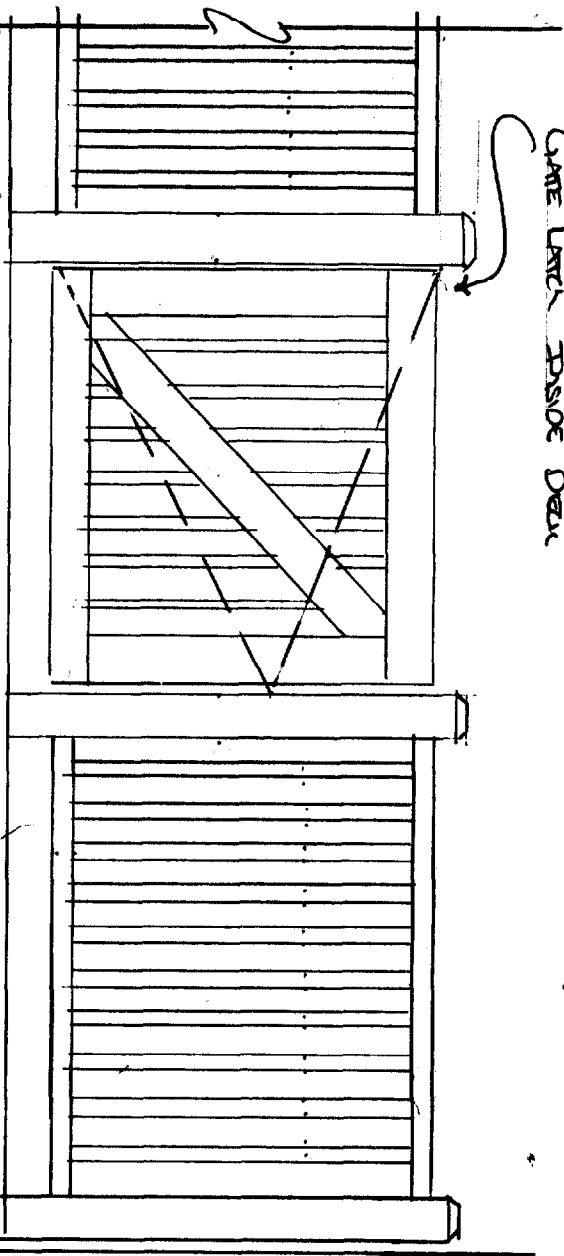

EXISTING DECK SPANS AND RAILING

* NEW GATE TO BE FASTENED ONTO EXISTING RAILING WITH STAPLES 2060 4x4 SPRING HINGE AND LATCH WITH 4 STAPLES 1261 GATE LATCH

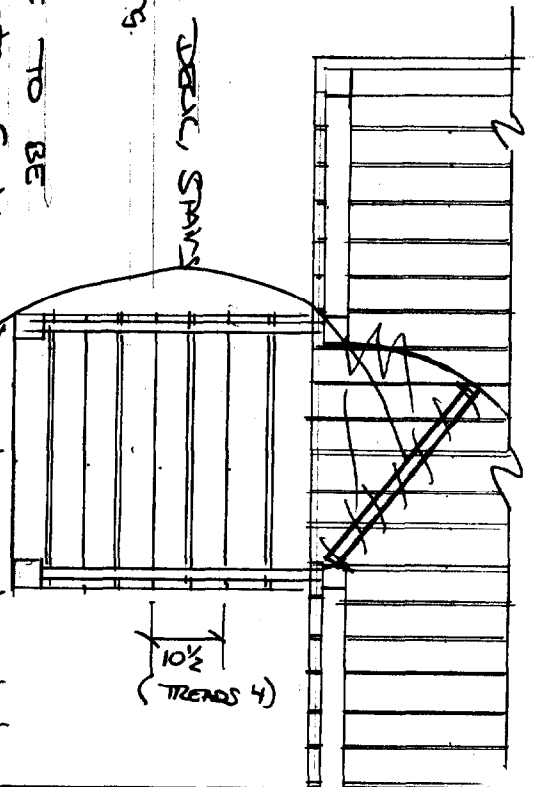

→ gate will be at bottom of stairs - swing away - self close, self latch - min. 48" w/ latch 3" down from top on **inside** w/ no more than 1/2 space within 18" of latch

EXISTING RAILING 36" TALL 2x2 BLASTERS 2 space

Decks

© 2001 by The McGraw-Hill Companies



POOL QUOTATION



DATE: _____
 STORE: _____
 NAME: _____ PHONE NO. _____
 ADDRESS: _____ CITY: _____ ZIP: _____
 SALES PERSON: Christene STORE PHONE NO. _____

POOL: _____
 SIZE: 15x30x52 MODEL: HA9G DESC. Haus Atlantic
 LINER: _____ UPGRADE: _____ +\$ _____
Price includes 25 gauge liner \$ 2197.00

POOL: _____
 SIZE: _____ MODEL: _____ DESC. _____ w/ tax
 LINER: _____ UPGRADE: _____ +\$ _____ \$ 2306.85
 \$ _____

FILTER PACKAGE [\$ _____] INCLUDES:

<input type="checkbox"/> 1 HP SAND	<input checked="" type="checkbox"/> 1 1/2 HP SAND
<input type="checkbox"/> 1 HP ELEMENT	<input type="checkbox"/> 1 1/2 HP ELEMENT
<input type="checkbox"/> 1 HP D.E.	<input type="checkbox"/> 1 1/2 HP DE
<input type="checkbox"/> 1 1/2 HP 2 SPEED UPGRADE +\$ _____	<input type="checkbox"/> 2 HP 2 SPEED UPGRADE +\$ _____

FILTER MEDIA, IN WALL SKIMMER, DLX RESIN A-FRAME LADDER, DELUXE MAINTENANCE KIT, POOL ALARM AND DELIVERY OF POOL, FILTER AND LADDER.

ESSENTIAL ITEMS TO CONSIDER:

<input type="checkbox"/> AUTOMATIC CLEANER	<input type="checkbox"/> POOL LIGHT
<input type="checkbox"/> SOLAR HEATER	<input type="checkbox"/> NAMCO SANITIZING KIT
<input type="checkbox"/> SOLAR BLANKET	<input type="checkbox"/> BALL VALVES
<input type="checkbox"/> SOLAR REEL	<input type="checkbox"/> WINTER COVER
<input type="checkbox"/> GAS HEATER	<input type="checkbox"/> ENTRY SYSTEM
<input type="checkbox"/> DECK _____	
<input type="checkbox"/> FENCE _____	

OTHER price includes deck ladder

NAMCO HAS SWIMMING POOLS FROM \$299 AND POOL PACKAGES FROM \$879

SALE ENDS 8/23/03 OR WHEN SOLD OUT
HAVE YOU SIGNED UP FOR NAMCO'S PREFERRED CUSTOMER CARD?

SPECIAL PAYMENT OPTIONS: NO MONEY DOWN, NO PAYMENTS UNTIL _____

8-29-03

checked jet buds

OK speed minimum's

OK MW