

ELECTRICAL PERMIT

City of Portland, Me.



396-C002

INSPECTION SERVICE

DATE

To the Chief Electrical Inspector, Portland Maine:
 The undersigned hereby applies for a permit to make electrical installations in accordance with the laws of Maine, the City of Portland Electrical Ordinance, National Electrical Code and the following specifications:

Date 7/20/09

Permit # 2009 4408

CBL# 396-C002

LOCATION: 59 OIDE Birch Rd METER MAKE & # _____
 CMP ACCOUNT # _____ OWNER Pierce
 TENANT _____ PHONE # 637-3440

TOTAL EACH FEE

OUTLETS	Receptacles	Switches	Smoke Detector		
				.20	
FIXTURES	Incandescent	Fluorescent	Strips		
				.20	
SERVICES	Overhead	Underground	TTL AMPS <800	15.00	
	Overhead	Underground	>800	25.00	
Temporary Service	Overhead	Underground	TTL AMPS	25.00	
				25.00	
METERS	(number of)			1.00	
MOTORS	(number of)			2.00	
RESID/COM	Electric units			1.00	
HEATING	oil/gas units	Interior	Exterior	5.00	
APPLIANCES	Ranges	Cook Tops	Wall Ovens	2.00	
	Insta-Hot	Water heaters	Fans	2.00	
	Dryers	Disposals	Dishwasher	2.00	
	Compactors	Spa	Washing Machine	2.00	
	Others (denote)			2.00	
MISC. (number of)	Air Cond/win			3.00	
	Air Cond/cent		Pools	10.00	10.00
	HVAC	EMS	Thermostat	5.00	
	Signs			10.00	
	Alarms/res			5.00	
	Alarms/com			15.00	
	Heavy Duty(CRKT)			2.00	
	Circus/Carnv			25.00	
	Alterations			5.00	
	Fire Repairs			15.00	
	E Lights			1.00	
	E Generators			20.00	
PANELS	Service	Remote	Main	4.00	
TRANSFORMER	0-25 Kva			5.00	
	25-200 Kva			8.00	
	Over 200 Kva			10.00	
				TOTAL AMOUNT DUE	
	MINIMUM FEE/COMMERCIAL 55.00			MINIMUM FEE	45.00

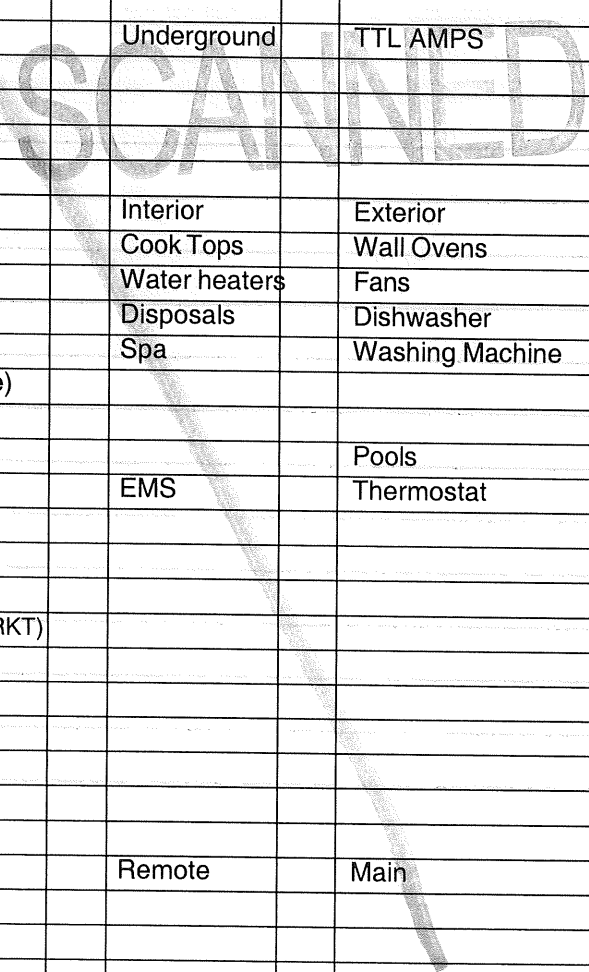

2008
396

CONTRACTORS NAME Superior Electric LLC MASTER LIC. # ML 60018033
 ADDRESS PO Box 357 Limington ME LIMITED LIC. # _____
 TELEPHONE 415-4644 C 637-3440(H) 04009

SIGNATURE OF CONTRACTOR [Signature]