

BULKHEAD:

THE STEEL BILDO DOORS WILL BE REMOVED FROM THE BULKHEAD. A PRESSURE TREATED ACCESS HATCH WITH RUBBER MEMBRANE WILL LAY FLAT ON THE EXISTING CONCRETE BULKHEAD. THE ACCESS HATCH WILL BE REMOVABLE SO THAT I CAN 16' THROW WOOD INTO THE BASIN IN THE WINTER. THE HATCH WILL BE FLUSH WITH THE NEW DECK AND BE CONSTRUCTED AS THE DECK IS. 2X10 16 O.C. WILL BE UTILIZED. PLEASE SEE PICTURE.

NOTES:

1. NEW SLIDER WILL BE AN ANDERSON VINYL 72" X 80",
2. RISER HEIGHT OF DECK STEP WILL BE 7.5" OR LESS.
3. TREAD DEPTH WILL BE 11",
4. STEP WIDTH WILL BE APPROX. 45",
5. ENTRY DOOR INTO GARAGE WILL HAVE A PLATFORM STEP APPROX. 36" WIDE X 24" DEEP X 8" HIGH. IT WILL BE PLACED ON THE CONCRETE GARAGE FLOOR.
6. GARAGE ENTRY DOOR WILL BE RAISED APPROX. 6" TO ACCOMMODATE A FOOT DECK. THE PLATFORM STEP WILL BE BUILT TO REDUCE THE STEP HEIGHT WHEN WALKING INTO THE GARAGE FROM THE DECK.

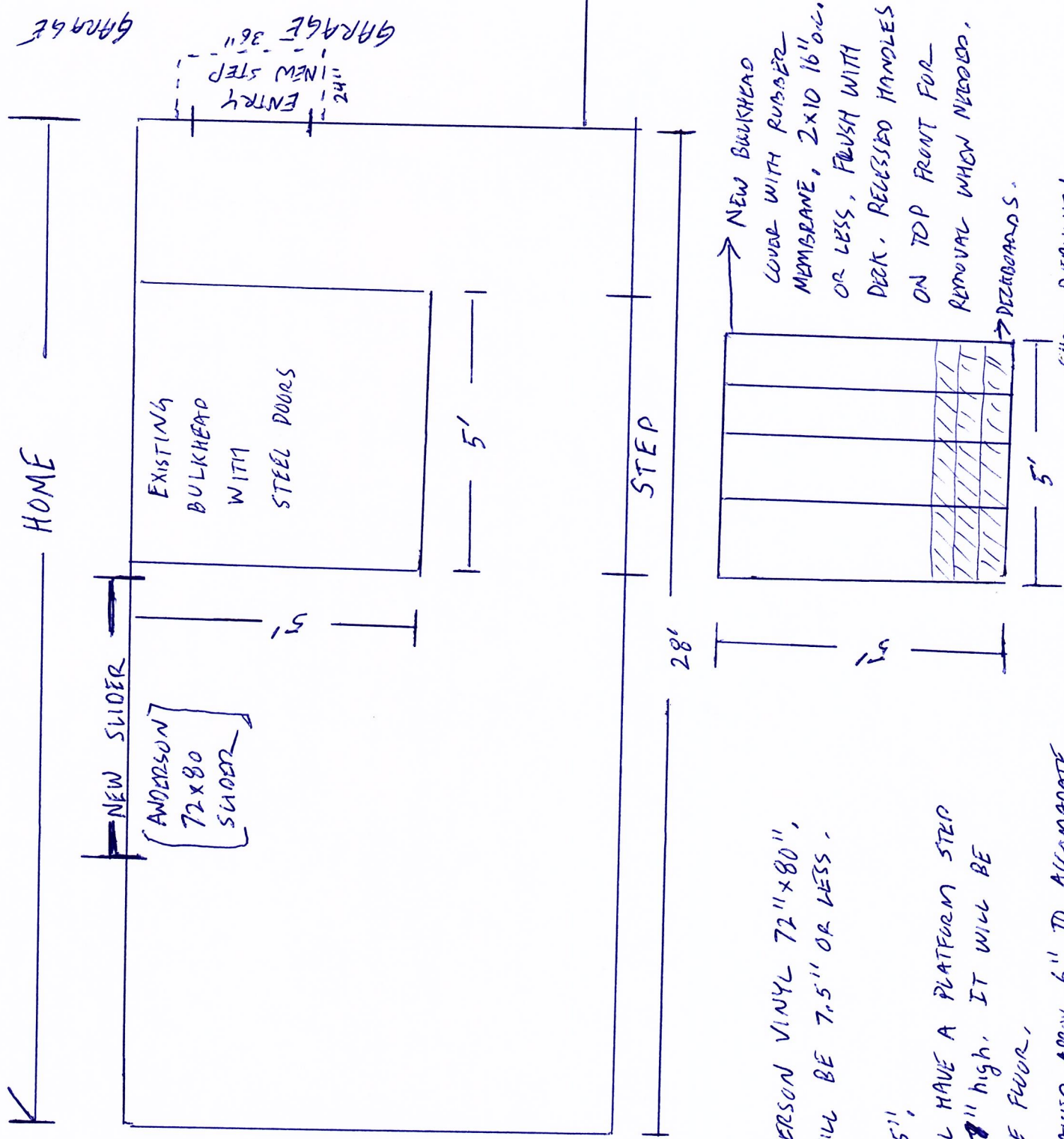

CARIS BEAUVIEU
74 CURTIS ROAD
DECK PROJECT