

# DISPLAY THIS CARD ON PRINCIPAL FRONTAGE OF WORK CITY OF PORTLAND

Please Read  
Application And  
Notes, If Any,  
Attached

**PERMIT**

**PERMIT ISSUED**  
Permit Number: 050924  
AUG 26 2005  
CITY OF PORTLAND

This is to certify that Fitzgerald Wayne B Sr &/Ov  
has permission to install bulkhead entrance to car  
AT 28 Curtis Rd

394 I003001

provided that the person or persons, firm or corporation accepting this permit shall comply with all of the provisions of the Statutes of Maine and of the ordinances of the City of Portland regulating the construction, maintenance and use of buildings and structures, and of the application on file in this department.

Apply to Public Works for street line and grade if nature of work requires such information.

Notification of inspection must be given and written permission procured before this building or part thereof is altered or closed-in.  
**48 HOUR NOTICE IS REQUIRED.**

A certificate of occupancy must be procured by owner before this building or part thereof is occupied.

**OTHER REQUIRED APPROVALS**

Fire Dept. \_\_\_\_\_  
Health Dept. \_\_\_\_\_  
Appeal Board \_\_\_\_\_  
Other \_\_\_\_\_  
Department Name

  
Director - Building & Inspection Services

**PENALTY FOR REMOVING THIS CARD**

**City of Portland, Maine - Building or Use Permit Application**

389 Congress Street, 04101 Tel: (207) 874-8703, Fax: (207) 874-8716

Permit No: 05-0924	Issue Date: <b>PERMIT ISSUED</b> AUG 26 2005	CBL: 394 1003001
-----------------------	--	---------------------

<b>Location of Construction:</b> 28 Curtis Rd	<b>Owner Name:</b> Fitzgerald Wayne B Sr &	<b>Owner Address:</b> 28 Curtis Rd	<b>Phone:</b>
<b>Business Name:</b>	<b>Contractor Name:</b> Owner	<b>Contractor Address:</b> Portland	<b>Phone:</b> 442-7773
<b>Lessee/Buyer's Name</b>	<b>Phone:</b>	<b>Permit Type:</b> Additions - Dwellings	<b>Zone:</b> R-2

<b>Past Use:</b> Single Family Home	<b>Proposed Use:</b> Single Family Home/ install bulkhead entrance to cellar	<b>Permit Fee:</b> \$39.00	<b>Cost of Work:</b> \$1,100.00	<b>CEO District:</b> 5
<b>Proposed Project Description:</b> install bulkhead entrance to cellar		<b>FIRE DEPT:</b> <input type="checkbox"/> Approved <input type="checkbox"/> Denied	<b>INSPECTION:</b> Use Group: R-3 Type: 53 IBC 2003 Signature: <i>AM</i>	

**PEDESTRIAN ACTIVITIES DISTRICT (P.A.D.)**

Action:  Approved  Approved w/Conditions  Denied

Signature: \_\_\_\_\_ Date: \_\_\_\_\_

<b>Permit Taken By:</b> Idobson	<b>Date Applied For:</b> 07/08/2005	<b>Zoning Approval</b>	
------------------------------------	--	------------------------	--

1.  2.  3.	<b>Special Zone or Reviews</b>	<b>Zoning Appeal</b>	<b>Historic Preservation</b>
	<input type="checkbox"/> Shoreland <input type="checkbox"/> Wetland <input type="checkbox"/> Flood Zone <input type="checkbox"/> Subdivision <input type="checkbox"/> Site Plan Maj <input type="checkbox"/> Minor <input type="checkbox"/> MM <input type="checkbox"/> Date: 8/5/05	<input type="checkbox"/> Variance <input type="checkbox"/> Miscellaneous <input type="checkbox"/> Conditional Use <input type="checkbox"/> Interpretation <input type="checkbox"/> Approved <input type="checkbox"/> Denied Date:	<input checked="" type="checkbox"/> Not in District or Landmark <input type="checkbox"/> Does Not Require Review <input type="checkbox"/> Requires Review <input type="checkbox"/> Approved <input type="checkbox"/> Approved w/Conditions <input type="checkbox"/> Denied Date: 8/5/05

**CERTIFICATION**

I hereby certify that I am the owner of record of the named property, or that the proposed work is authorized by the owner of record and that I have been authorized by the owner to make this application as his authorized agent and I agree to conform to all applicable laws of this jurisdiction. In addition, if a permit for work described in the application is issued, I certify that the code official's authorized representative shall have the authority to enter all areas covered by such permit at any reasonable hour to enforce the provision of the code(s) applicable to such permit.

SIGNATURE OF APPLICANT	ADDRESS	DATE	PHONE
RESPONSIBLE PERSON IN CHARGE OF WORK, TITLE		DATE	PHONE

**City of Portland, Maine - Building or Use Permit**

389 Congress Street, 04101 Tel: (207) 874-8703, Fax: (207) 874-8716

<b>Permit No:</b> 05-0924	<b>Date Applied For:</b> 07/08/2005	<b>CBL:</b> 394 I003001
------------------------------	--	----------------------------

<b>Location of Construction:</b> 28 Curtis Rd	<b>Owner Name:</b> Fitzgerald Wayne B Sr &	<b>Owner Address:</b> 28 Curtis Rd	<b>Phone:</b>
<b>Business Name:</b>	<b>Contractor Name:</b> Owner	<b>Contractor Address:</b> Portland	<b>Phone:</b>
<b>Lessee/Buyer's Name:</b>	<b>Phone:</b>	<b>Permit Type:</b> Additions - Dwellings	

<b>Proposed Use:</b> Single Family Home/ install bulkhead entrance to cellar	<b>Proposed Project Description:</b> install bulkhead entrance to cellar
---	---

<b>Dept:</b> Zoning	<b>Status:</b> Approved	<b>Reviewer:</b> Tammy Munson	<b>Approval Date:</b> 08/05/2005
<b>Note:</b>	<b>Ok to Issue:</b> <input checked="" type="checkbox"/>		

<b>Dept:</b> Building	<b>Status:</b> Approved	<b>Reviewer:</b> Peter Merrow	<b>Approval Date:</b> 08/22/2005
<b>Note:</b> .Spoke with contractor. Bulk head foundation will be pinned to main foundation using "I" bolts through the foundation tied to rebar. 4x4 sill plate will be doubled with 1/2 steel plates lag bolted and extending 1' on either side of the opening. Stairs are Ptand will be cut to fit.			
<b>Ok to Issue:</b> <input type="checkbox"/>			

2) Permit approved based on the plans submitted and reviewed w/owner/contractor, with additional information as agreed on and as noted on plans.

**Comments:**  
08/22/2005-pwm: Spoke with owner. Existing building. 2x12 floor construction w/ 4x6 carrying beam. Sitting on 5- 12" sona tubes. Doub 2x12 gerders.

# All Purpose Building Permit Application

If you or the property owner owes real estate or personal property taxes or user charges on any property within the City, payment arrangements must be made before permits of any kind are accepted.

Location/Address of Construction: <u>28 Curtis Rd Portland Me.</u>		
Total Square Footage of Proposed Structure		Square Footage of Lot
Tax Assessor's Chart, Block & Lot Chart# <u>394</u> Block# <u>1</u> Lot# <u>3</u>	Owner <u>Wayne B. Fitzgerald</u> <u>28 Curtis Rd</u> <u>Portland Me 04103</u>	Telephone: <u>207-797-0896</u>
Lessee/Buyer's Name (If Applicable)	Applicant name, address & telephone: <u>Wayne B Fitzgerald</u>	cost Of Work: \$ <u>1100</u> Fee: \$ <u>35</u>
Current use: <u>SFH</u>		
If the location is currently vacant, what was prior use: _____		
Approximately how long has it been vacant: _____		
Proposed use: _____		
Project description: <u>Bulkhead entrance into cellar.</u>		
Contractor's name, address & telephone:		
Who should we contact when the permit is ready: <u>Wayne B. Fitzgerald</u>		
Mailing address: <u>28 Curtis</u> <u>Portland, Me. 04103</u>		
We will contact you by phone when the permit is ready. You must come in and pick up the permit and review the requirements before starting any work, with a Plan Reviewer. A stop work order will be issued and a \$100.00 fee if any work starts before the permit is picked up. PHONE: <u>207-797-0896</u>		

IF THE REQUIRED INFORMATION IS NOT INCLUDED IN THE SUBMISSIONS THE PERMIT WILL BE AUTOMATICALLY DENIED AT THE DISCRETION OF THE BUILDING/PLANNING DEPARTMENT, WE MAY REQUIRE ADDITIONAL INFORMATION IN ORDER TO APPROVE THIS PERMIT.

I hereby certify that I am the Owner of record of the named property, or that the owner of record authorizes the proposed work and that I have been authorized by the owner to make this application as his/her authorized agent. I agree to conform to all applicable laws of this jurisdiction. In addition, if a permit for work described in this application is issued, I certify that the Code Official's authorized representative shall have the authority to enter all areas covered by this permit at any reasonable hour to enforce the provisions of the codes applicable to this permit.

Signature of applicant: <u>Wayne B. Fitzgerald</u>	Date: <u>7-8-05</u>
--	---------------------

This is NOT a permit, you may not commence ANY work until the permit is issued. If you are in a Historic District you may be subject to additional permitting and fees with the Planning Department on the 4<sup>th</sup> floor of City Hall

## **Cellar Bulkhead Plans**

Wayne & Bette Fitzgerald  
28 Curtis Road  
Portland, Maine 04103

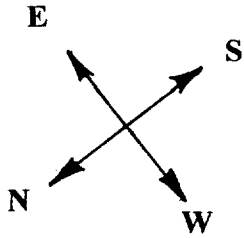

*R-2  
Lot cov-016  
Rev-25-14  
Side-14*

28 Curtis Road

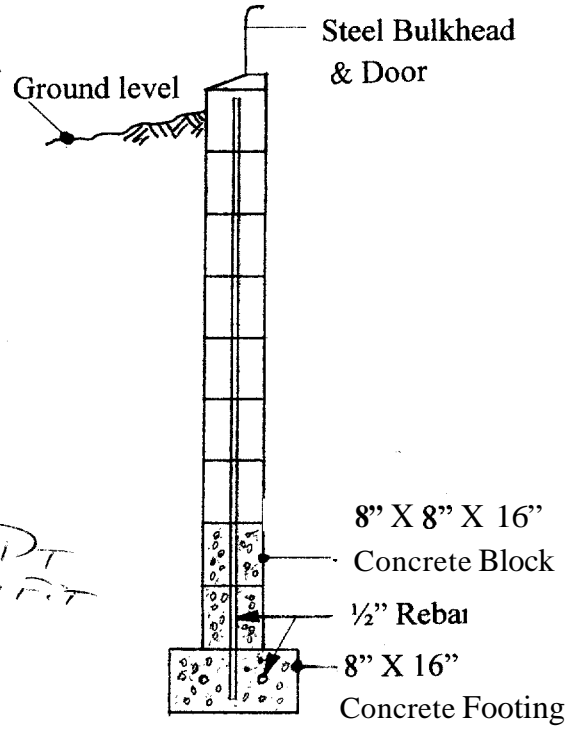
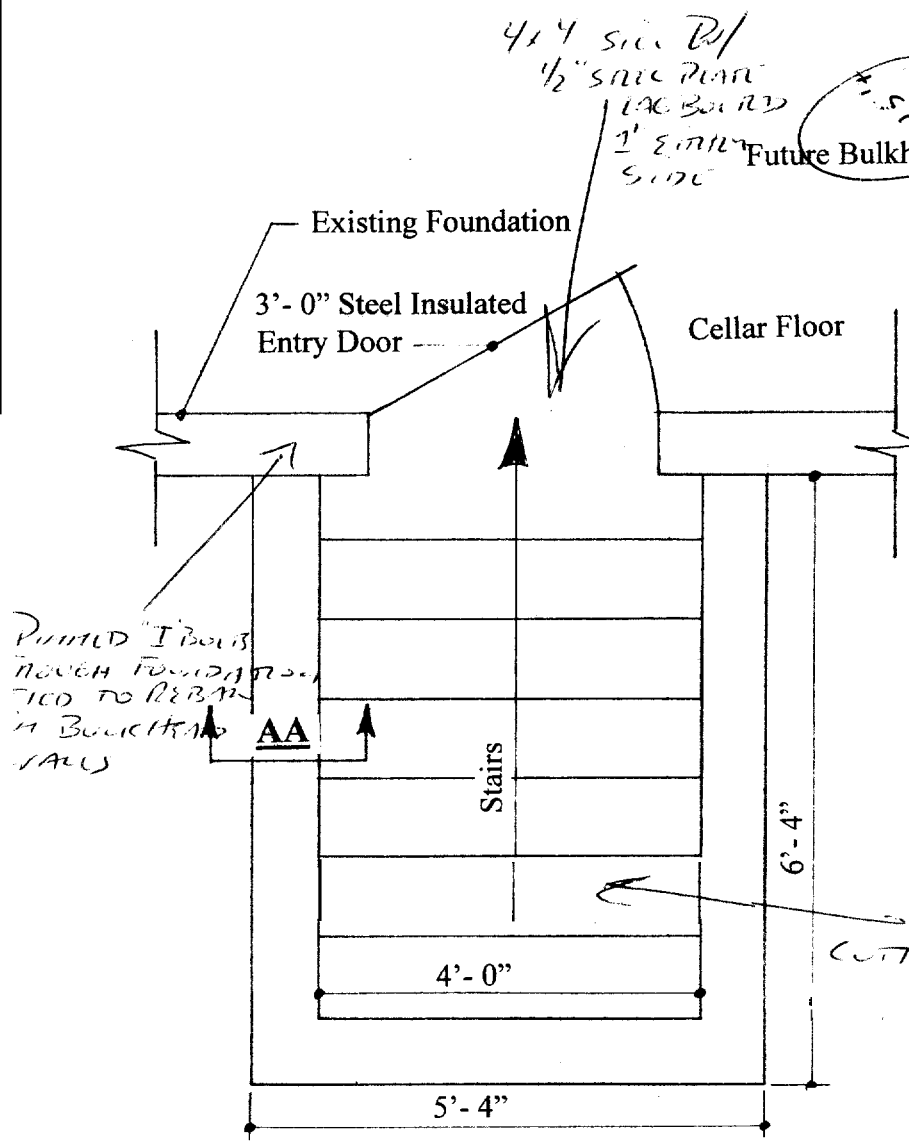
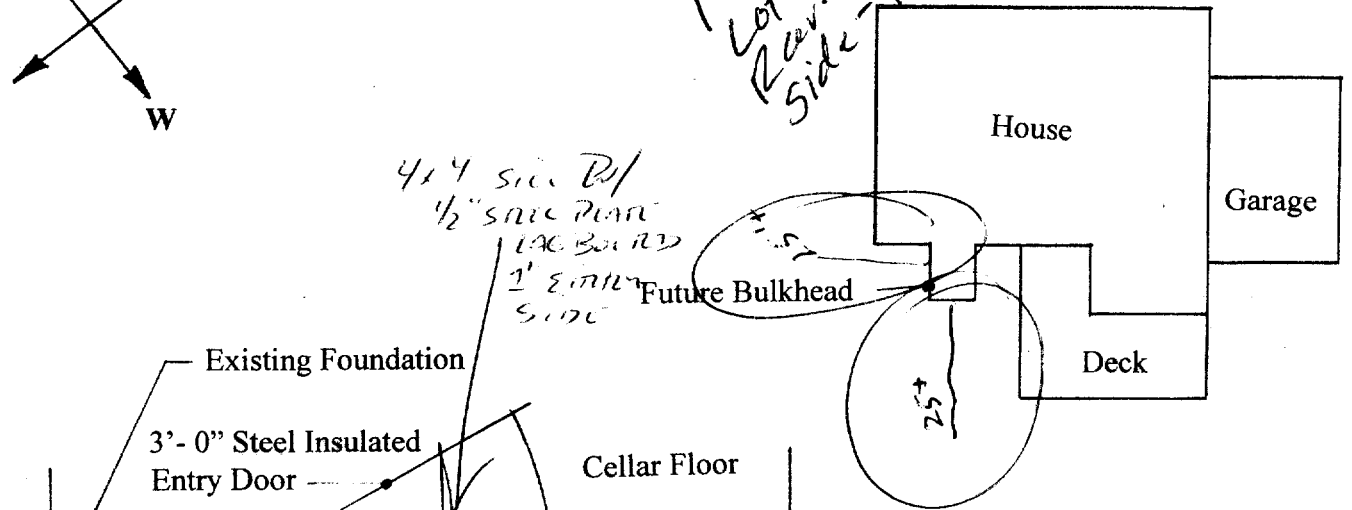

**Cross Section AA**

**Bulkhead Foundation Plan 1/2" = 1'-0"**

## Material List

<u>Item &amp; Size</u>	<u>Quantity</u>	<u>Price Each</u>	<u>Total</u>
<u>Masonry</u>			
<b>8" X 8" X 16" Concrete Block</b>	<b>88</b>	<b>1.08</b>	<b>95.04</b>
“ “ “ Corner Block	<b>18</b>	<b>1.08</b>	<b>19.44</b>
80 Ibs Concrete Mix	<b>60</b>	<b>3.46</b>	<b>207.60</b>
70 Ibs Mortar Mix	<b>3</b>	<b>4.85</b>	<b>14.55</b>
1/2" X 10' Rebar	<b>14</b>	<b>3.81</b>	<b>53.34</b>
<u>Doors</u>			
Bulkhead 19-1/2" X 71" X 53"	<b>1</b>	<b>299.99</b>	<b>299.99</b>
3'-0" Steel Insul Entry Door for 6" wall, R-18, 6 panel	<b>1</b>	<b>185.00</b>	<b>185.00</b>
<u>Pressure Treated Lumber</u>			
2" X 8" X 12'	<b>3</b>	<b>14.10</b>	<b>42.30</b>
2" X 12" X 16'	<b>2</b>	<b>34.72</b>	<b>69.82</b>
<u>Other Items</u>			
Rental of Concrete cutting saw			<b>45.00</b>
<u>Hardware</u>			
3/8" X 3" Galv. Lag Bolts	<b>8</b>	<b>.58</b>	<b>4.64</b>
3/8" X 1" Lead anchor sleeve	<b>8</b>	<b>.88</b>	<b>7.28</b>
Miscellaneous fasteners			<b>10.00</b>
			<b><u>Total \$1,054.00</u></b>