

**ROOF FRAMING PLAN**  
1/4" = 1'-0"

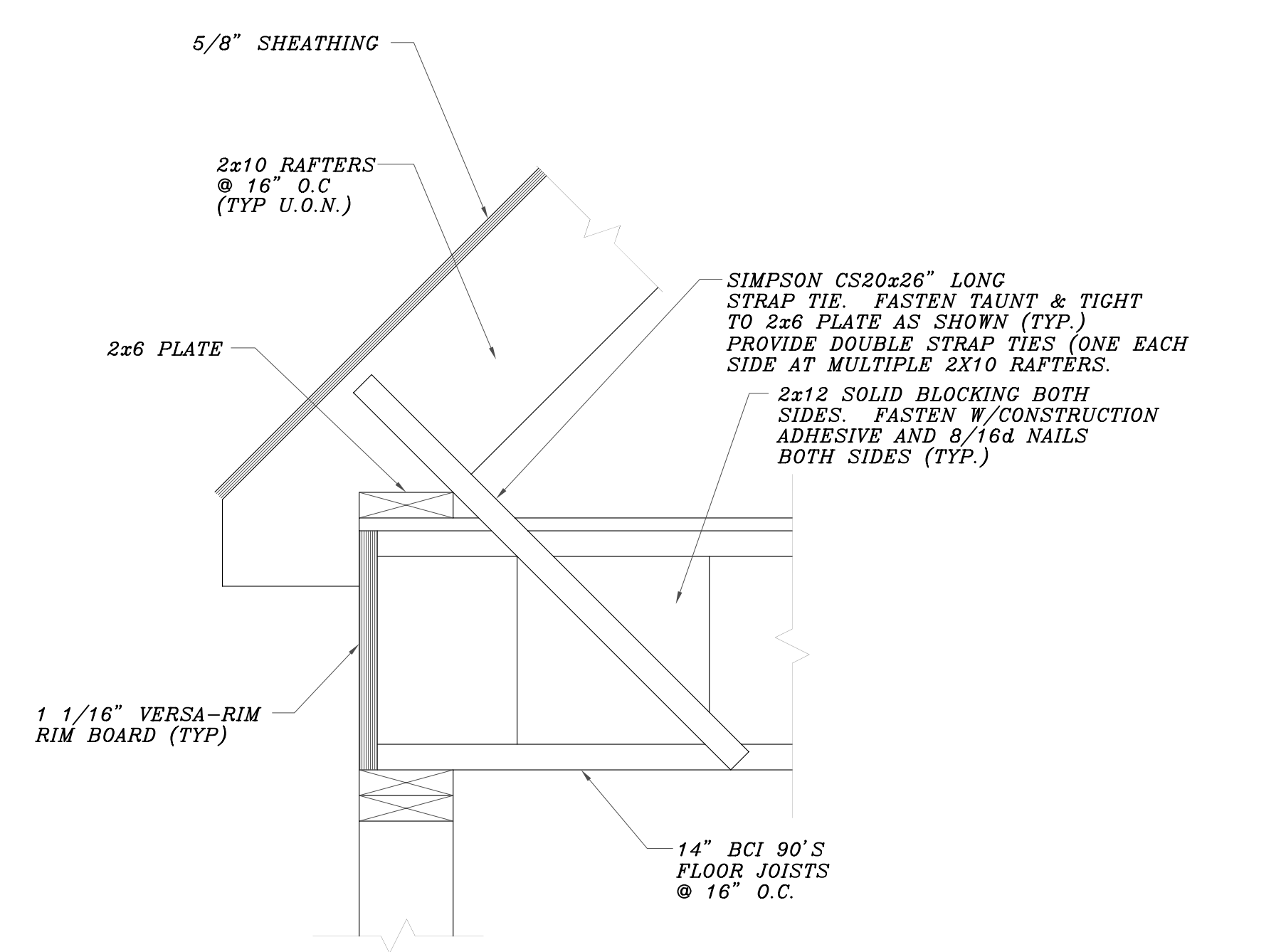

**SECTION 1**  
1 1/2" = 1'-0"

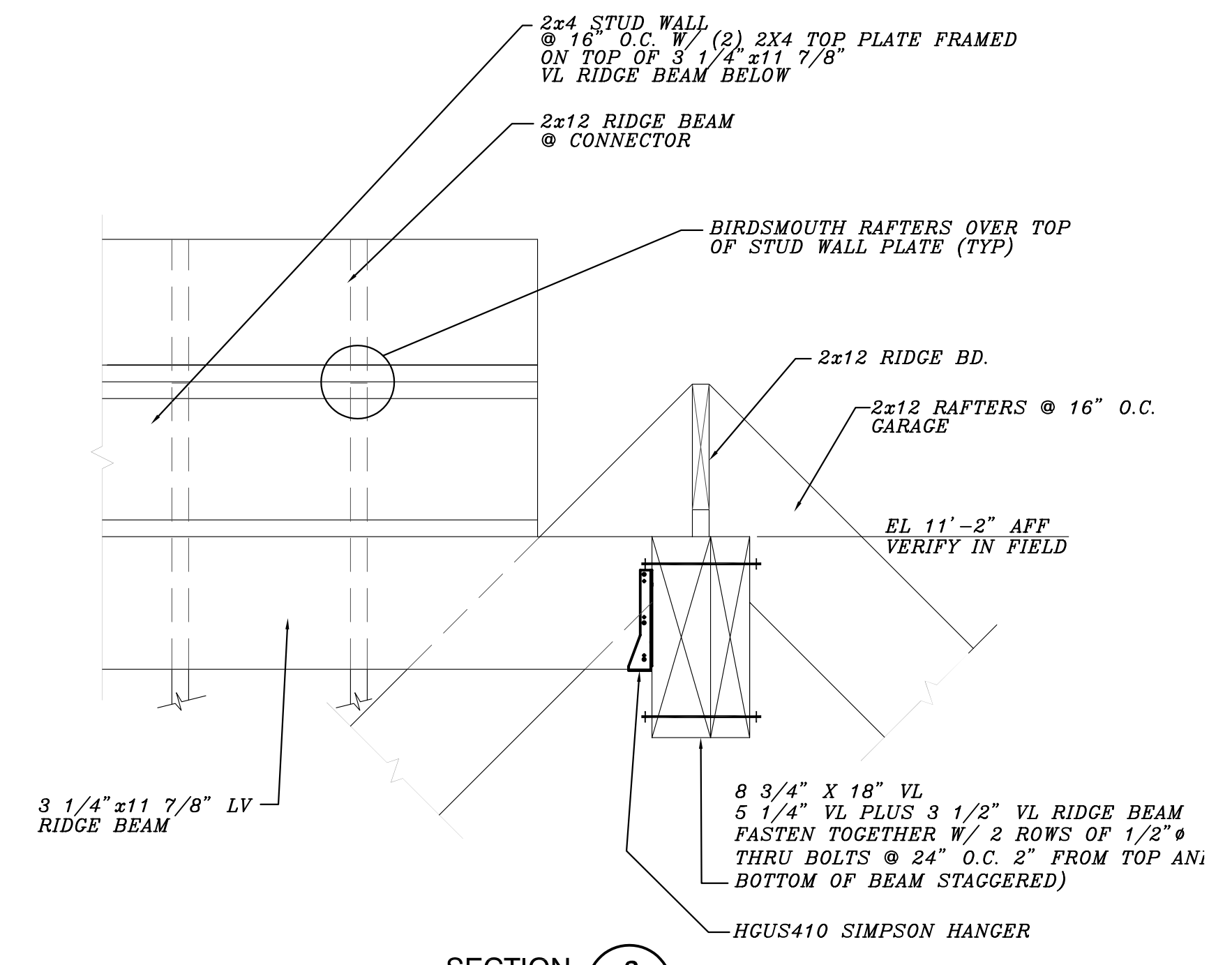

**SECTION 2**  
1" = 1'-0"

- NOTES**
- SEE GENERAL NOTES ON DRAWING S1
  - ROOF TRUSS LOADING:  
TCLL = 40 PSF  
TCDL = 10 PSF  
BCLL = 0 PSF  
BDLL = 10 PSF
  - ALL HEADERS SHALL HAVE 2X6 JACK STUD PLUS 2X6 KING STUD AT BOTH ENDS (TYP U.O.N.)
  - "VL" INDICATES VERSALAM BEAM MANUFACTURED BY BOISE CASCADES CORP. OR APPROVED EQUAL.

**L & L STRUCTURAL**  
ENGINEERING SERVICES, INC.  
SIX Q STREET  
SOUTH PORTLAND, MAINE 04106  
PHONE: (207) 767-4830  
FAX: (207) 799-5432

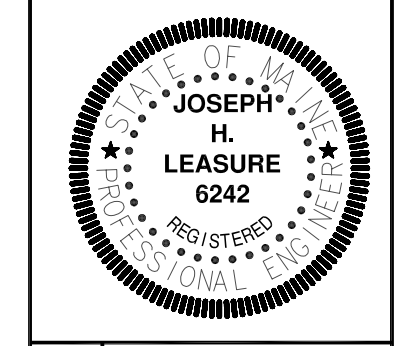

| app'd             | description            |
|-------------------|------------------------|
|                   |                        |
| date              | description            |
|                   |                        |
| rev.              | description            |
|                   |                        |
| designed by: JHL  | project #:             |
| drawn by: LEM     | date:                  |
| checked by: JHL   | scale: AS NOTED        |
| date: MAY 5, 2006 | plot date: MAY 5, 2006 |

DIXON RESIDENCE  
121 HOPE AVENUE  
PRESUMPSCOT RIVER PLACE  
PORTLAND, MAINE  
ROOF FRAMING PLAN

**S5**