

THIS INFORMATION IS PROVIDED TO OUR CUSTOMERS AS A SERVICE OF MAINE RESIDENTIAL DESIGN. CUSTOMERS SHOULD APPRECIATE, HOWEVER, THAT THIS INFORMATION IS NOT THE PRODUCT OF ANY ARCHITECT, NEITHER MAINE RESIDENTIAL DESIGN OR ANY OF ITS EMPLOYEES ARE REGISTERED ARCHITECTS WITHIN THE STATE OF MAINE AND CUSTOMERS MAY WANT TO CONSULT WITH AN ARCHITECT BEFORE TAKING FINAL ACTION WITH REGARD TO ANY BUILDING OR STRUCTURE. CUSTOMERS SHOULD ALSO APPRECIATE THAT BY PROVIDING YOU WITH THIS INFORMATION, MAINE RESIDENTIAL DESIGN DOES NOT GUARANTEE THE SOUNDNESS OR SUITABILITY OF THE INFORMATION FOR ANY PURPOSE OF THE CUSTOMER.

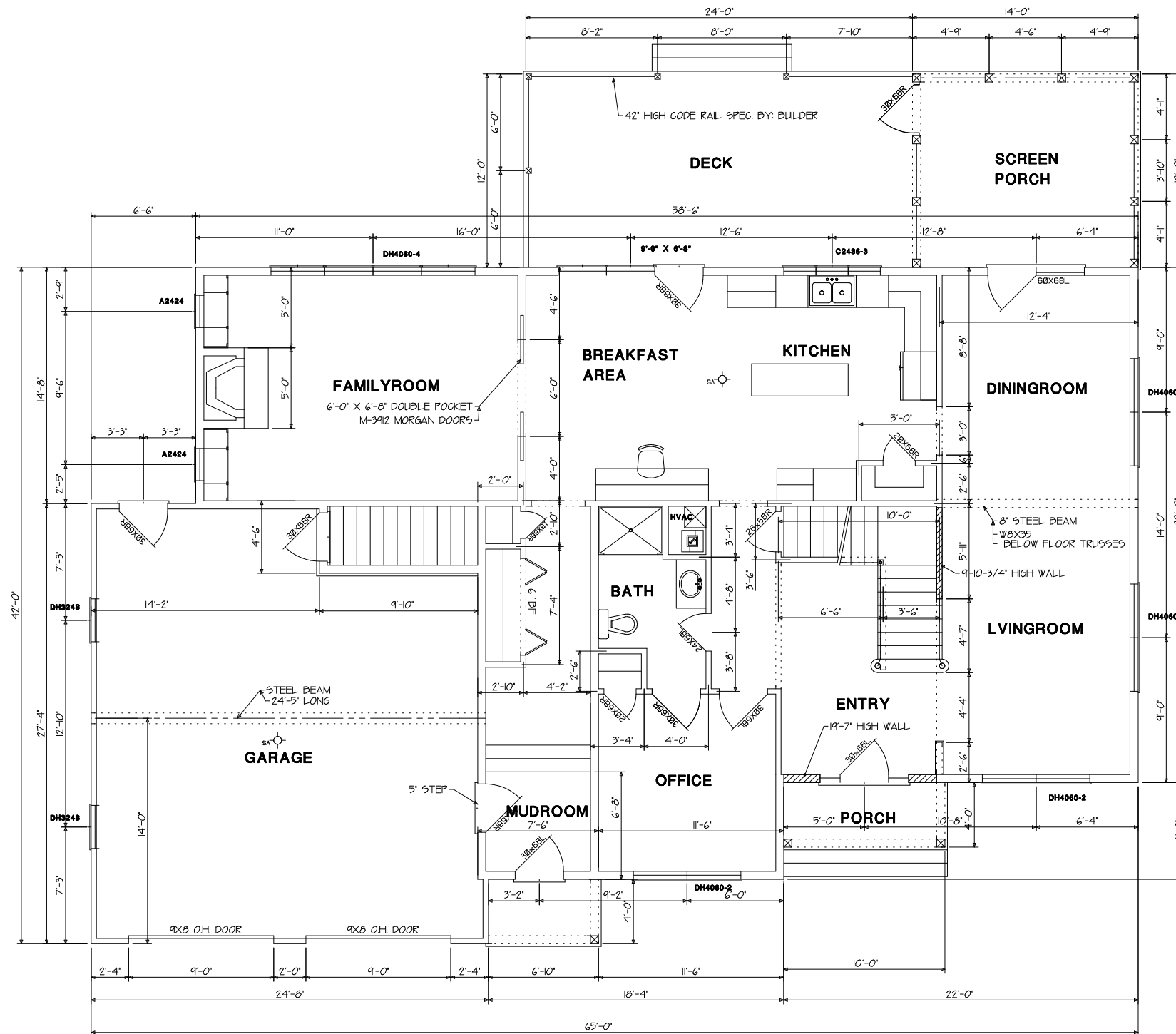

ELECTRICAL KEY	
	DUPLEX OUTLET
	RANGE OUTLET
	WEATHERPROOF OUTLET
	GROUND FAULT OUTLET
	LAMP/PULL SWITCH
	LIGHTING FOR CEILING
	WEATHERPROOF LIGHT
	SINGLE POLE SWITCH
	THREE WAY SWITCH
	FURNACE SWITCH 5' OFF FLOOR
	TELEPHONE
	FLUORESCENT LIGHT
	SMOKE ALARM (3-1N SERIES)
NOTE: SMOKE ALARM IN BASEMENT	

FIRST FLOOR PLAN
1687 SQ.FT.

MAINE RESIDENTIAL DESIGN	FILE NAME
LEWISTON, ME. 207-783-4327	2 OF 13
JOB: MIKE & BARBARA PEISNER	SCALE: 1/4" = 1'-0"
	DATE: 03/16/06
DISCIPTION: FIRST FLOOR PLAN	DRAWN BY: MEJ
	APPROVED: