

DISPLAY THIS CARD ON PRINCIPAL FRONTAGE OF WORK



CITY OF PORTLAND

BUILDING PERMIT

This is to certify that RICHARD G POWELL

Located At 111 ALICE ST

Job ID: 2012-07-4460-POOL

CBL: 389-D-019-001

has permission to 12' x13' x52" Above Ground Pool

provided that the person or persons, firm or corporation accepting this permit shall comply with all of the provisions of the Statutes of Maine and of the Ordinances of the City of Portland regulating the construction, maintenance and use of the buildings and structures, and of the application on file in the department.

Notification of inspection and written permission procured before this building or part thereof is lathed or otherwise closed-in. 48 HOUR NOTICE IS REQUIRED.

A final inspection must be completed by owner before this building or part thereof is occupied. If a certificate of occupancy is required, it must be

Fire Prevention Officer

Code Enforcement Officer / Plan Reviewer

THIS CARD MUST BE POSTED ON THE STREET SIDE OF THE PROPERTY
PENALTY FOR REMOVING THIS CARD

BUILDING PERMIT INSPECTION PROCEDURES

Please call 874-8703 or 874-8693 (ONLY)

or email: buildinginspections@portlandmaine.gov

With the issuance of this permit, the owner, builder or their designee is required to provide adequate notice to the city of Portland Inspections Services for the following inspections. Appointments must be requested 48 to 72 hours in advance of the required inspection. The inspection date will need to be confirmed by this office.

- **Please read the conditions of approval that is attached to this permit!! Contact this office if you have any questions.**
- **Permits expire in 6 months. If the project is not started or ceases for 6 months.**
- **If the inspection requirements are not followed as stated below additional fees may be incurred due to the issuance of a "Stop Work Order" and subsequent release to continue.**

Required Inspections:

Pool location inspection

Electrical inspection

Final Inspection

The project cannot move to the next phase prior to the required inspection and approval to continue, REGARDLESS OF THE NOTICE OF CIRCUMSTANCES.

IF THE PERMIT REQUIRES A CERTIFICATE OF OCCUPANCY, IT MUST BE PAID FOR AND ISSUED TO THE OWNER OR DESIGNEE BEFORE THE SPACE MAY BE OCCUPIED.



PORTLAND MAINE

Strengthening a Remarkable City, Building a Community for Life • www.portlandmaine.gov

Director of Planning and Urban Development
Jeff Levine

Job ID: 2012-07-4460-POOL

Located At: 111 ALICE ST

CBL: 389- D-019-001

Conditions of Approval:

Zoning



1. This permit is being approved on the basis of revised plans submitted. Any deviations shall require a separate approval before starting that work.
2. As discussed during the review process, the property must be clearly identified prior to pouring concrete and compliance with the required setbacks must be established. Due to the proximity of the setbacks of the proposed addition, it may be required to be located by a surveyor.
3. This property shall remain a single family dwelling. Any change of use shall require a separate permit application for review and approval.



Building

Separate permits are required for any electrical, plumbing, sprinkler, fire alarm HVAC systems, heating appliances, commercial hood exhaust systems and fuel tanks. Separate plans may need to be submitted for approval as a part of this process.

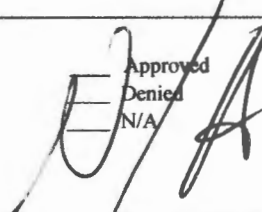
City of Portland, Maine - Building or Use Permit Application

389 Congress Street, 04101 Tel: (207) 874-8703, FAX: (207) 8716

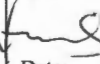
Job No: 2012-07-4460-POOL	Date Applied: 7/13/2012	CBL: 389- D-019-001	
Location of Construction: 111 ALICE ST	Owner Name: RICHARD & CAROLE POWELL	Owner Address: 111 ALICE ST PORTLAND, ME 04103	Phone: 797-9163
Business Name:	Contractor Name: Dave's Pool Sales & Service, Inc.	Contractor Address: 110 ROOSEVELT TRAIL WINDHAM MAINE 04062	Phone: (207) 893-2500
Lessee/Buyer's Name:	Phone:	Permit Type: POOL	Zone: R-2
Past Use: Single Family dwelling	Proposed Use: Same: Single Family Dwelling - to install an above ground pool 12' x 23' x 52"	Cost of Work: \$4,000.00	CEO District:
		Fire Dept: Approved Denied N/A	Inspection: Use Group: Type: Pool DEC 09
		Signature: 	Signature: 
Proposed Project Description: 12' x 13' x 52" Above Ground Pool		Pedestrian Activities District (P.A.D.)	
Permit Taken By: Lannie		Zoning Approval	

<p>1. This permit application does not preclude the Applicant(s) from meeting applicable State and Federal Rules.</p> <p>2. Building Permits do not include plumbing, septic or electrical work.</p> <p>3. Building permits are void if work is not started within six (6) months of the date of issuance. False informatin may invalidate a building permit and stop all work.</p>	<p>Special Zone or Reviews</p> <p><input type="checkbox"/> Shoreland</p> <p><input type="checkbox"/> Wetlands</p> <p><input type="checkbox"/> Flood Zone</p> <p><input type="checkbox"/> Subdivision</p> <p><input type="checkbox"/> Site Plan</p> <p>____ Maj ____ Min ____ MM</p> <p>Date: <i>ok with conditions</i> <i>7/18/12</i></p>	<p>Zoning Appeal</p> <p><input type="checkbox"/> Variance</p> <p><input type="checkbox"/> Miscellaneous</p> <p><input type="checkbox"/> Conditional Use</p> <p><input type="checkbox"/> Interpretation</p> <p><input type="checkbox"/> Approved</p> <p><input type="checkbox"/> Denied</p> <p>Date: </p>	<p>Historic Preservation</p> <p><input checked="" type="checkbox"/> Not in Dist or Landmark</p> <p><input type="checkbox"/> Does not Require Review</p> <p><input type="checkbox"/> Requires Review</p> <p><input type="checkbox"/> Approved</p> <p><input type="checkbox"/> Approved w/Conditions</p> <p><input type="checkbox"/> Denied</p> <p>Date: </p>
	CERTIFICATION		

I hereby certify that I am the owner of record of the named property, or that the proposed work is authorized by the owner of record and that I have been authorized by the owner to make this application as his authorized agent and I agree to conform to all applicable laws of this jurisdiction. In addition, if a permit for work described in the appication is issued, I certify that the code official's authorized representative shall have the authority to enter all areas covered by such permit at any reasonable hour to enforce the provision of the code(s) applicable to such permit.

SIGNATURE OF APPLICANT	ADDRESS	DATE	PHONE
RESPONSIBLE PERSON IN CHARGE OF WORK, TITLE		DATE	PHONE



Pool Installation/Construction Permit Application

R-2

If you or the property owner owes real estate or personal property taxes or user charges on any property within the City, payment arrangements must be made before permits of any kind are accepted.

Location/Address of Construction: <u>111 Alice St, Portland, ME 04103</u>		
Total Square Footage of Proposed Structure <u>288 276</u>	Square Footage of Lot <u>10,040</u>	
Tax Assessor's Chart, Block & Lot Chart# Block# Lot# <u>389 - D - 019 - 001</u>	Owner: <u>Powell, Richard G & Carole J</u>	Telephone: <u>207-797-9163</u>
Lessee/Buyer's Name (If Applicable)	Applicant name, address & telephone: <u>Carole Powell</u> <u>111 Alice St, Portland</u> <u>797-9163</u>	Cost Of Work: \$ <u>3900.-</u> Fee: \$ _____
Dimensions of pool: <u>12' x 23' x 52"</u> above or below ground: <u>above ground</u>		
Dimensions of decking and/or any platforms, sheds, or other structures:		
Contractor's name, address & telephone: <u>Dave's Pool Sales & Service, Inc</u> <u>110 Roosevelt Trail, Windham, ME 04062</u>		
Who should we contact when the permit is ready: <u>Carole Powell</u>		
Mailing address: <u>111 Alice St</u> <u>Portland, ME 04103</u>	Phone: <u>207-797-9163</u>	

City of Portland Building Inspections
JUL 13 2012
RECEIVED
207-555-2500

Please submit all of the information outlined in the pool application checklist. Failure to do so could result in the automatic denial of your permit.

In order to be sure the City fully understands the full scope of the project, the Planning and Development Department may request additional information prior to the issuance of a permit. For further information visit us on-line at www.portlandmaine.gov, stop by the Building Inspections office, room 315 City Hall or call 874-8703.

I hereby certify that I am the Owner of record of the named property, or that the owner of record authorizes the proposed work and that I have been authorized by the owner to make this application as his/her authorized agent. I agree to conform to all applicable laws of this jurisdiction. In addition, if a permit for work described in this application is issued, I certify that the Code Official's authorized representative shall have the authority to enter all areas covered by this permit at any reasonable hour to enforce the provisions of the codes applicable to this permit.

Signature of applicant: <u>Carole Powell</u>	Date:
--	-------

This is not a permit; you may not commence ANY work until the permit is issued.

Powell, 111 Alice St

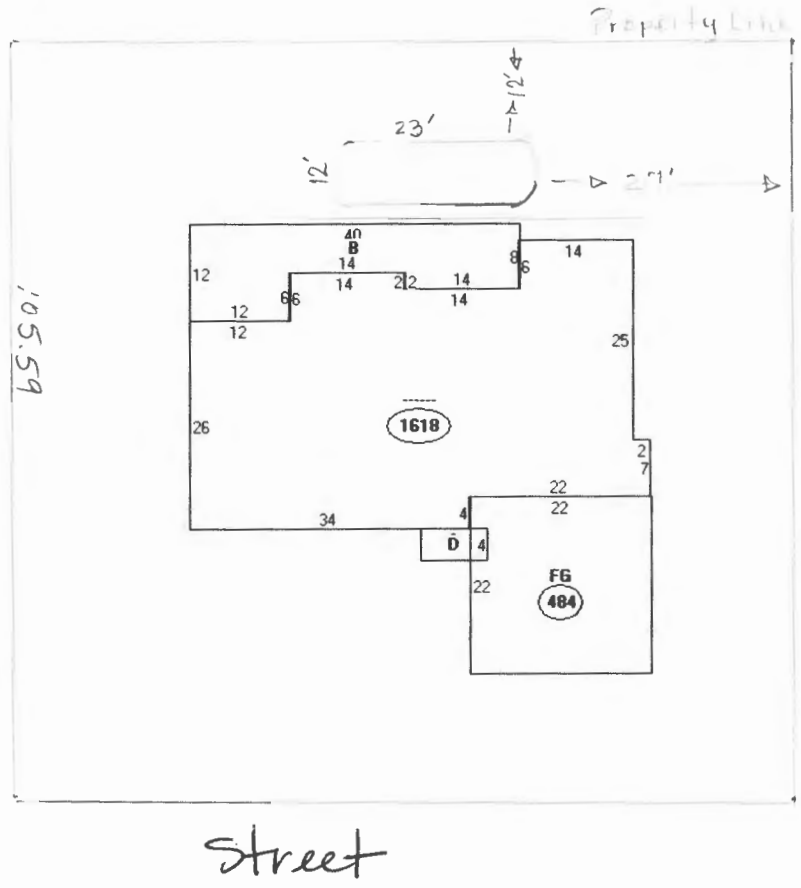

(b) *Public art.* Except in residential zones, public art that has been individually accepted by the city council for inclusion within the public art collection, pursuant to Article XI, Public Art Program of the Land Use Code, (Section 14-852(c)), shall not be subject to the height limitations for buildings within the underlying zone.

(c) *Temporary wind anemometer towers.* Temporary wind anemometer towers may be erected above the height limitation for buildings within the underlying zone, subject to receiving Board of Appeals approval and FAA approval, if necessary. (Code 1968, § 602.19.I; Ord. No. 428-83, § 1, 4-25-83; Ord. No. 36-89, § 3, 6-28-89; Ord. No. 96-08/09, 11-17-08; Ord. No. 29-09/10, 8-3-09 emergency passage)

Sec. 14-431. Yards.

The height in stories or feet of that part of the principal building adjoining a yard shall be used in determining the required width or depth of that yard, but in no case shall any higher part of the building be closer to the property line than width or depth of yard required for that height. In case an addition is to be made to a building which existed on June 5, 1957, the side yard spaces of which complied with the ordinance in effect on that date, the aggregate side yards may be the same as required on that date, provided the yard on the side where the addition is intended would comply with the minimum width required by the present ordinance. Yards as prescribed for residential uses shall be required for an apartment house or hotel erected above the ground floor of a building where the ground floor is designed exclusively for business purposes.

(Code 1968, § 602.19.J)

Sec. 14-432. Swimming pools.

Outdoor swimming pools accessory to dwellings, apartment houses, hotels or motels shall be permitted on lots, provided the following conditions are met:

(a) No swimming pool shall be sited in the front yard.

(b) No part of any swimming pool shall be located closer than ten (10) feet from the principal structure, nor closer than ten (10) feet from the side or rear lot lines.

(Code 1968, § 602.19.K; Ord. No. 271-77, 5-16-77; Ord. No. 90-88, 7-19-88)

Powell - 111 Alice St

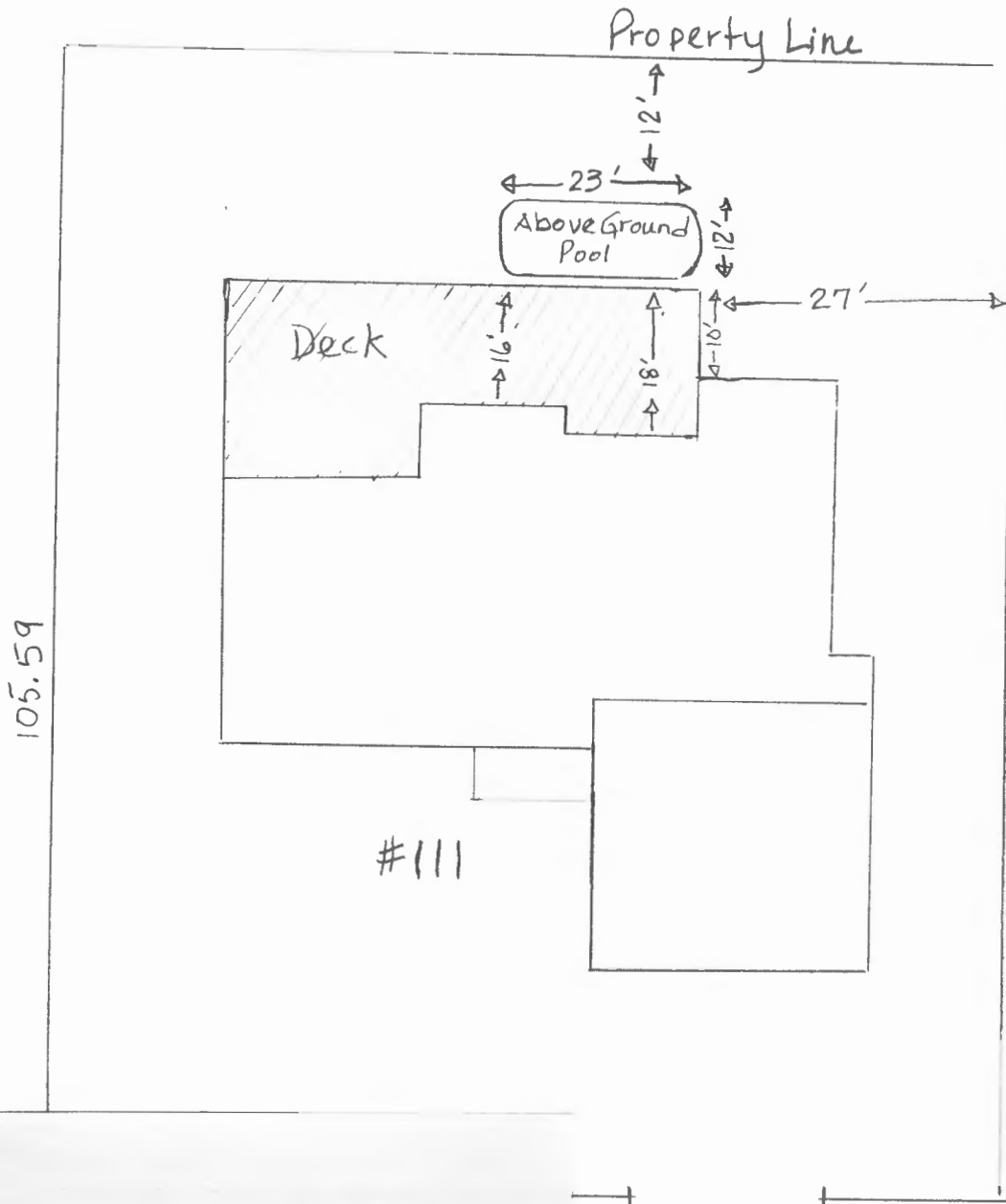

R-3 Zone

POOLS CAN be NO closer than 10' from REAR & Side property lines

NOR 10' from principal structures (open outside deck or sun tubes is AN Accessory Attached Structure)

7-18-12

Marge,

Here's my 2nd attempt at sketching the layout for the pool application. It's still not to scale, but I tried my best to get all of the necessary measurements included this time.

Thanks for working with me on this. — Carole Powell

street

RECEIVED

JUL 18 2012

Dept. of Building Inspections
City of Portland Maine

Above Ground Vinyl Liners

All Integrity liners are available in the following beads -



EZ-Bead

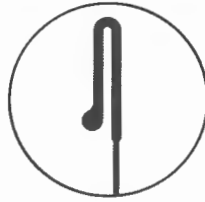

J-Bead

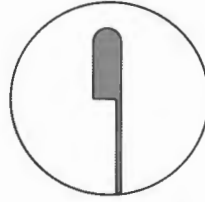

E W Bead

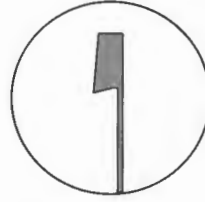

Standard Bead

INTEGRITY AG LADDER

Strong, stable & the most versatile
above-ground pool ladder ever offered.

The Integrity AG Ladder is built on experience –
over 45 years of it. For maximum family
enjoyment, we didn't skip a step.



"Deck-To-Pool"

"A" Frame Design
Available in white and gray.

USE THE STRONGEST MATERIALS The Integrity AG Ladder is molded of rugged, high-impact resistant thermoplastic. It resists pool chemicals, and contains UV inhibitors – for years of safe, carefree use.

EASY-CLIMBING STEPS The Integrity AG Ladder has five steps – rather than the typical four. We set the first tread low, and the others just over 10" apart. Result: easier climbing, particularly for kids and seniors.

ANTI-SLIP TREADS We mold in texture – rather than glue it on. The result: superior, permanent traction on both steps and deck.

BUILT-IN VERSATILITY Adjustable to three pool heights: 48", 52" and 54". The A-frame ladder is convertible to deck-to-pool or stand-alone. And on the A-frame, there is a removable, portable outside ladder.

NO COMPROMISE ON QUALITY OR SAFETY The Integrity AG Ladder is designed according to the **NEW ANSI-NSPI supplemental standards effective December 31, 2004.** The new Integrity AG ladder was designed with enhanced features and manufactured under the International ISO 9001:2000 Quality Standard.

Integrity AG Ladder weight limit 300 lbs.
Exceeds NSPI standards

5 Year Warranty



Division of Latham Manufacturing
1-800-562-0024

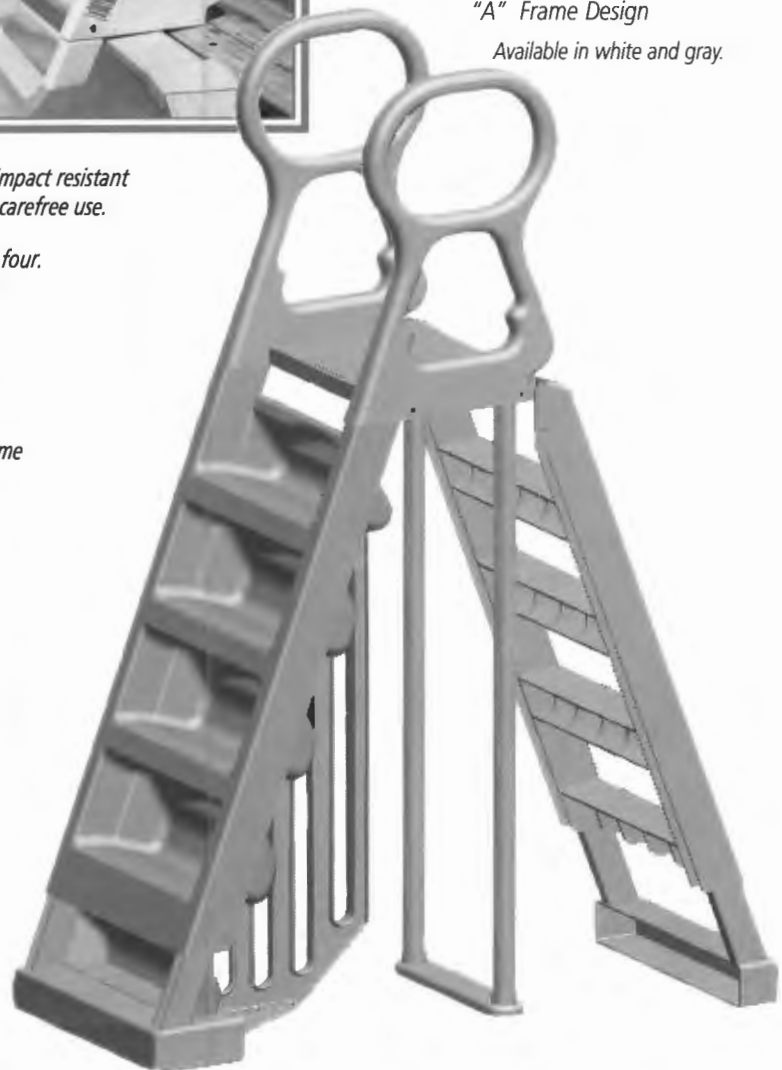

Celebration™

Above Ground Pools

Distinction LX™

Wall and structure now
coordinated for style

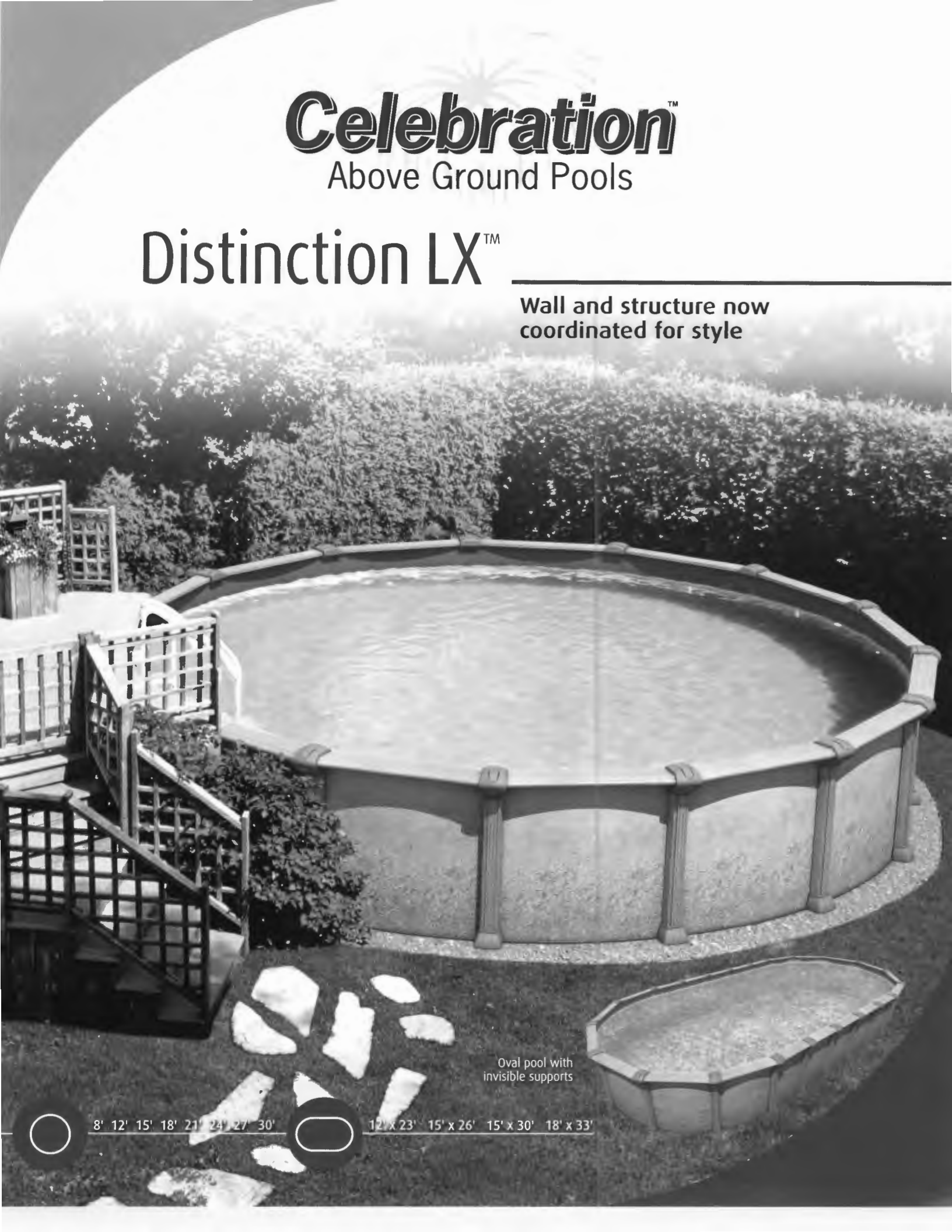

Oval pool with
invisible supports

8' 12' 15' 18' 21' 24' 27' 30'

12' x 23' 15' x 26' 15' x 30' 18' x 33'

Distinction LX™

Wall and structure now coordinated for style

Nuance™ wall – 52" (1.32 m)

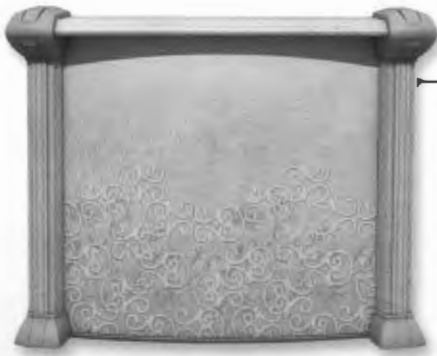

Structure

- 8-inch multi-ribbed top ledge
- 6-inch fully supportive uprights
- Synpro™ resin decorator ledge cover:
 - Won't chip, peel or splinter
 - Tie-in support to the upright for greater rigidity
 - Flush design eliminates exposed screws

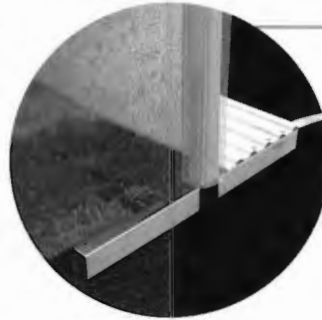

Yard Extender System

Our oval pools come with the Yard Extender System, a series of practically invisible lateral supports that you place in the ground

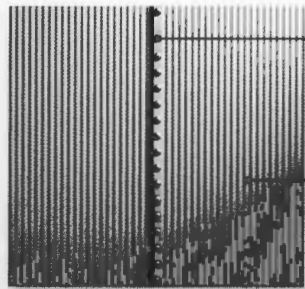

Wall Joint

- Computer-designed wall joint ensures better resistance to water pressure
- Oversized bolts augment stability

Corrugation

- A rippled finish lets the wall resist both water pressure and external shocks

Pool-fit System

- Parts are pre-grooved for fast and easy installation of screws
- Unique design locks screws solidly in place for long-lasting structural integrity



Protective Finishes

Zincguard™ 275 hot-dipped galvanized

Zinc coating on both sides of the steel for maximum protection against corrosion

Tru-Kote™

Undercoating process applied to the inner face for extra protection

Polyenamel™ Kote

Excellent tried-and-true finish for a long-lasting pool

Resin-Shield™

Textured resin coating applied to the outer face

Synpro™

Non-corrosive resin that contains UV stabilizers that protect against discoloration and chemicals

Duoguard™

An epoxy and alkyd resin compound that protects against condensation between the wall and the liner

Tuf Base Z™

Applied to bottom wall channels for superior corrosion protection



- A Galvanization
- B Zincguard™ 275, 99.5% pure
- C Alkaline cleaned
- D Bonderized
- E Chromic rinse
- F Tru-Kote™
- G Resin-Shield™
- H Synpro™
- I Pre-finished quality steel core
- J Polyenamel™ Kote
- K Tuf Base Z™
- L Duoguard™

Pre-finished pool components

All metal parts are coated and finished before assembly for longer-lasting effects

50-year Warranty

3 years at 100% (47 years prorated)

Water Safety

The purchase of an aboveground pool provides years of pleasure and fun, but it also involves water safety. Although we cannot supply a full-time lifeguard, we strongly recommend that you implement the following safety rules. These will help provide a pleasant atmosphere for you and your family.

- NEVER jump or dive in an aboveground pool.
- Maintain constant adult supervision when children are in or near any body of water.
- Read all of the safety, installation, and maintenance information contained in the instruction manual and Water Safety brochure before you start installing your pool.
- Ask your city about any specific rules and regulations that apply to aboveground pools.

- Follow the instruction manual and maintenance instructions.
- Never remove applied or posted safety stickers or signs from your pool or pool area.
- Barriers to prevent unsupervised access, especially by young children, should be built, installed and checked on a regular basis to ensure they are in good working order.
- Inspect your pool, barriers, alarms, and other related equipment on a regular basis in order to ensure they are in good working order and that they are safe.

The installation, maintenance and safety manual contains detailed tips and recommendations. They must be read, followed and applied on a regular basis, as they will prevent unnecessary accidents and will ensure many summers of pleasant, safe family fun.



SWIM SAFELY AND STAY SAFE

The dimensions, weights, illustrations and other specifications are approximate. The company reserves the right to modify and/or discontinue without notification any feature in any pool model.

© Copyright 2009



MKG-88-6316/M3.11