



RESIDENTIAL DESIGN INC

DESIGNERS

CONSULTANTS

CONSTRUCTION DRAWINGS

P.O. BOX 67
CONWAY, NH 03818
978-928-5581
RESIDENTIALDESIGNING.COM

AI BD AMERICAN INSTITUTE OF BUILDING DESIGN NORTHEAST

PROJECT

DOUG CAMPBELL
BUILDER

THE ROMA
RESIDENCE

PORTLAND, ME

SHEET TITLE

CROSS SECTIONS

DATE

11-17-2015

REVISIONS

SHEET NUMBER

S-2

RIDGE VENTING CONTINUOUS
PRE FABRICATED / PRE ENGINEERED
ROOF TRUSS @ 24" O.C.
FINAL DESIGN BY MANUFACTURER
5/8" O.S.B. ROOF SHEATHING
ZIP ROOF SYSTEM
MEMBRANE SHIELD EAVES AND
VALLEYS
ASPHALT ROOF SHINGLE

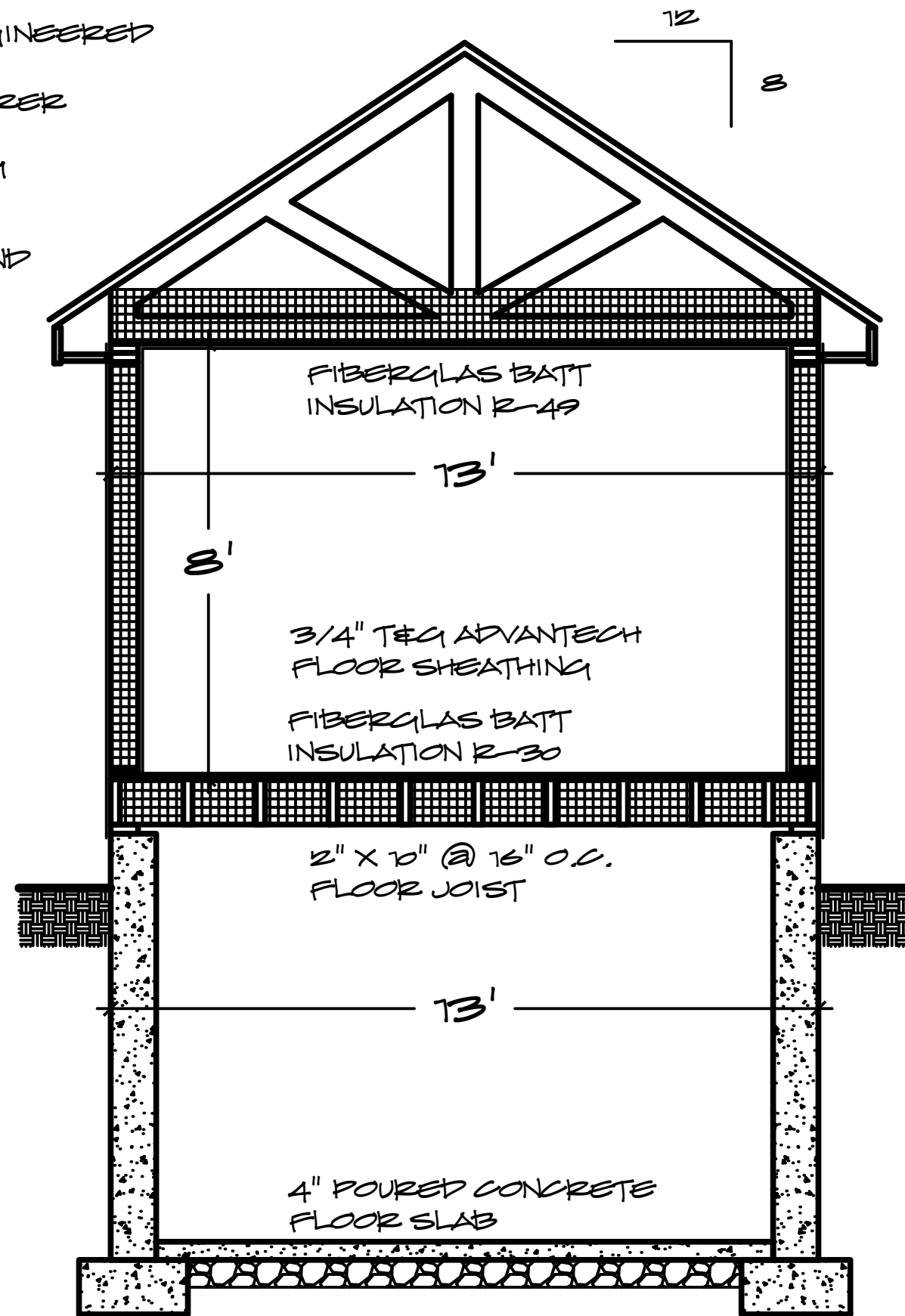

VINYL TRIM BOARD
SOFFIT VENTING
2" X 6" @ 16" O.C.
STUD WALL
FIBERGLAS BATT
INSULATION R-21
1/2" O.S.B. WALL
SHEATHING
ZIP WALL SYSTEM
VINYL SIDING
2" X 6" PRESSURE
TREATED
WOOD SILL
CONTINUOUS

POURED CONCRETE
FOUNDATION WITH
PERIMETER DRAIN

SECTION 3
3/8"=1'-0"

RIDGE VENTING CONTINUOUS
PRE FABRICATED / PRE ENGINEERED
ROOF TRUSS @ 24" O.C.
FINAL DESIGN BY MANUFACTURER
5/8" O.S.B. ROOF SHEATHING
ZIP ROOF SYSTEM
MEMBRANE SHIELD EAVES AND
VALLEYS
ASPHALT ROOF SHINGLE

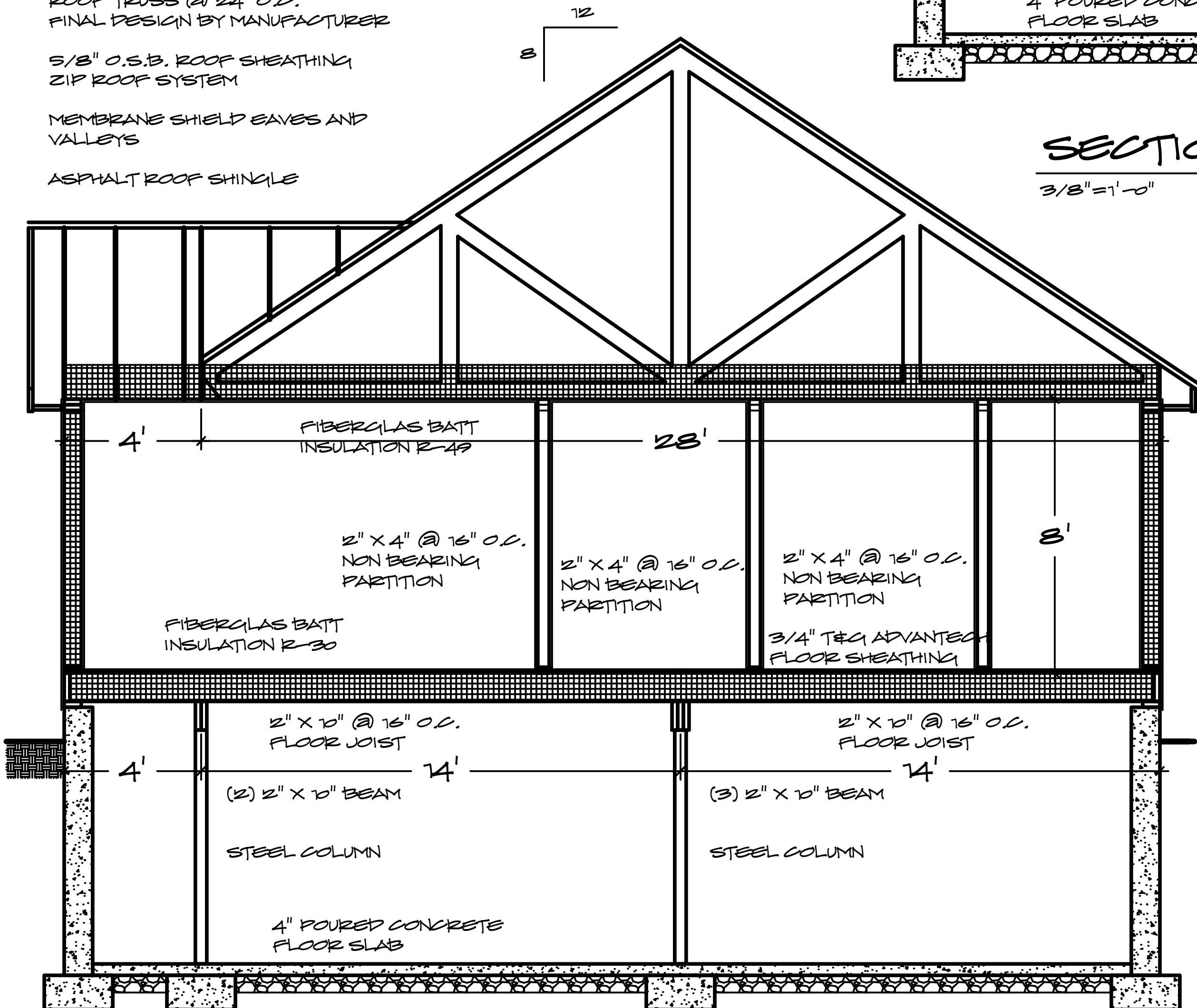

VINYL TRIM BOARD
SOFFIT VENTING
2" X 6" @ 16" O.C.
STUD WALL
FIBERGLAS BATT
INSULATION R-21
1/2" O.S.B. WALL
SHEATHING
ZIP WALL SYSTEM
VINYL SIDING
2" X 6" PRESSURE
TREATED
WOOD SILL
CONTINUOUS

POURED CONCRETE
FOUNDATION WITH
PERIMETER DRAIN

SECTION 1
3/8"=1'-0"

RIDGE VENTING CONTINUOUS
PRE FABRICATED / PRE ENGINEERED
ROOF TRUSS @ 24" O.C.
FINAL DESIGN BY MANUFACTURER
5/8" O.S.B. ROOF SHEATHING
ZIP ROOF SYSTEM
MEMBRANE SHIELD EAVES AND
VALLEYS
ASPHALT ROOF SHINGLE

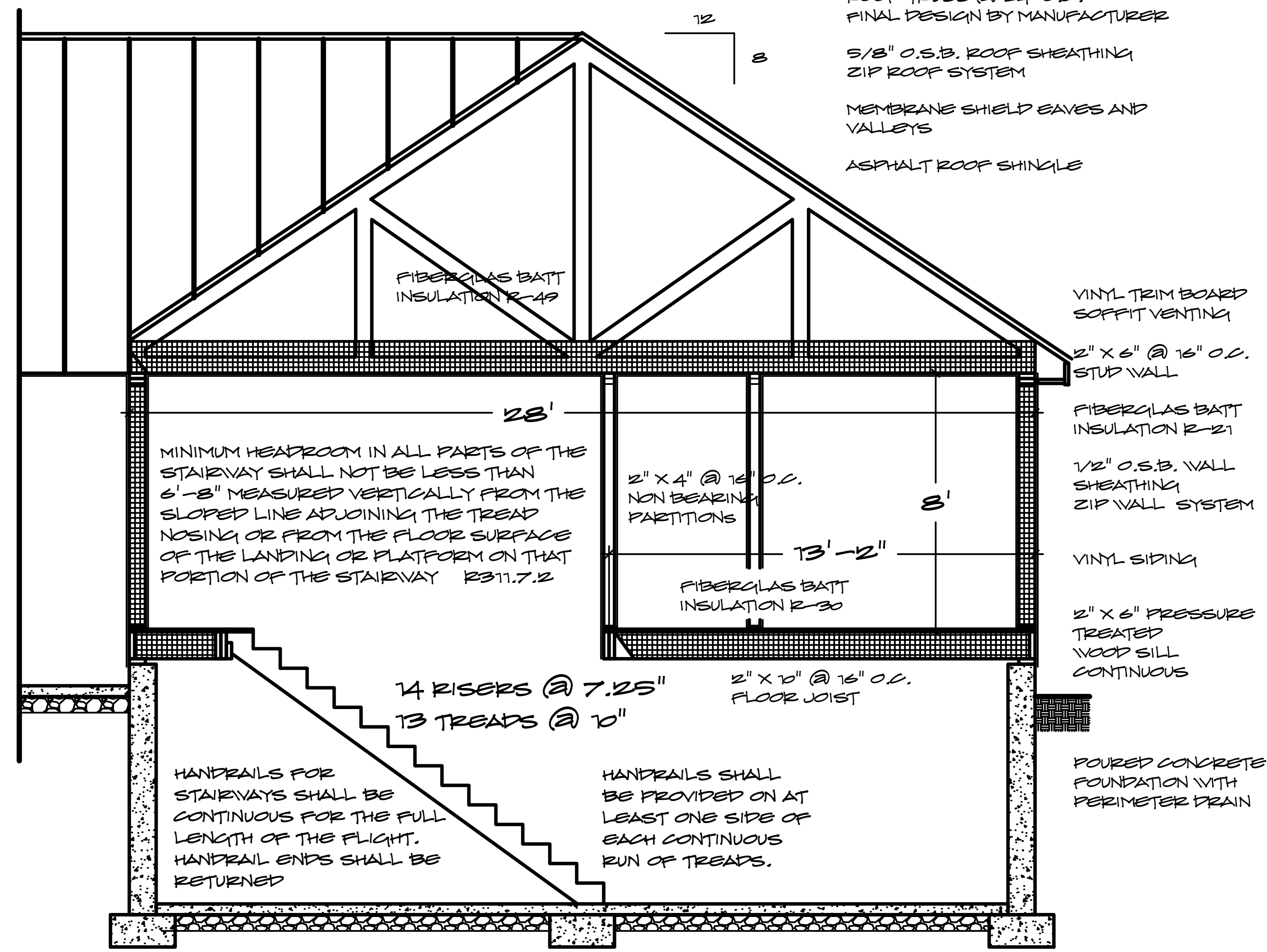

VINYL TRIM BOARD
SOFFIT VENTING
2" X 6" @ 16" O.C.
STUD WALL
FIBERGLAS BATT
INSULATION R-21
1/2" O.S.B. WALL
SHEATHING
ZIP WALL SYSTEM
VINYL SIDING
2" X 6" PRESSURE
TREATED
WOOD SILL
CONTINUOUS

POURED CONCRETE
FOUNDATION WITH
PERIMETER DRAIN

HANDRAILS WITH A CIRCULAR
CROSS SECTION SHALL HAVE A
DIAMETER OF AT LEAST 1 1/4"
AND NOT GREATER THAN 2"
R311.7.7.7

SECTION 2
3/8"=1'-0"