

3 FOUNDATION WALL AT BUILDING
3/4" = 1'-0" (WHEN PRINTED AT 24"X36")

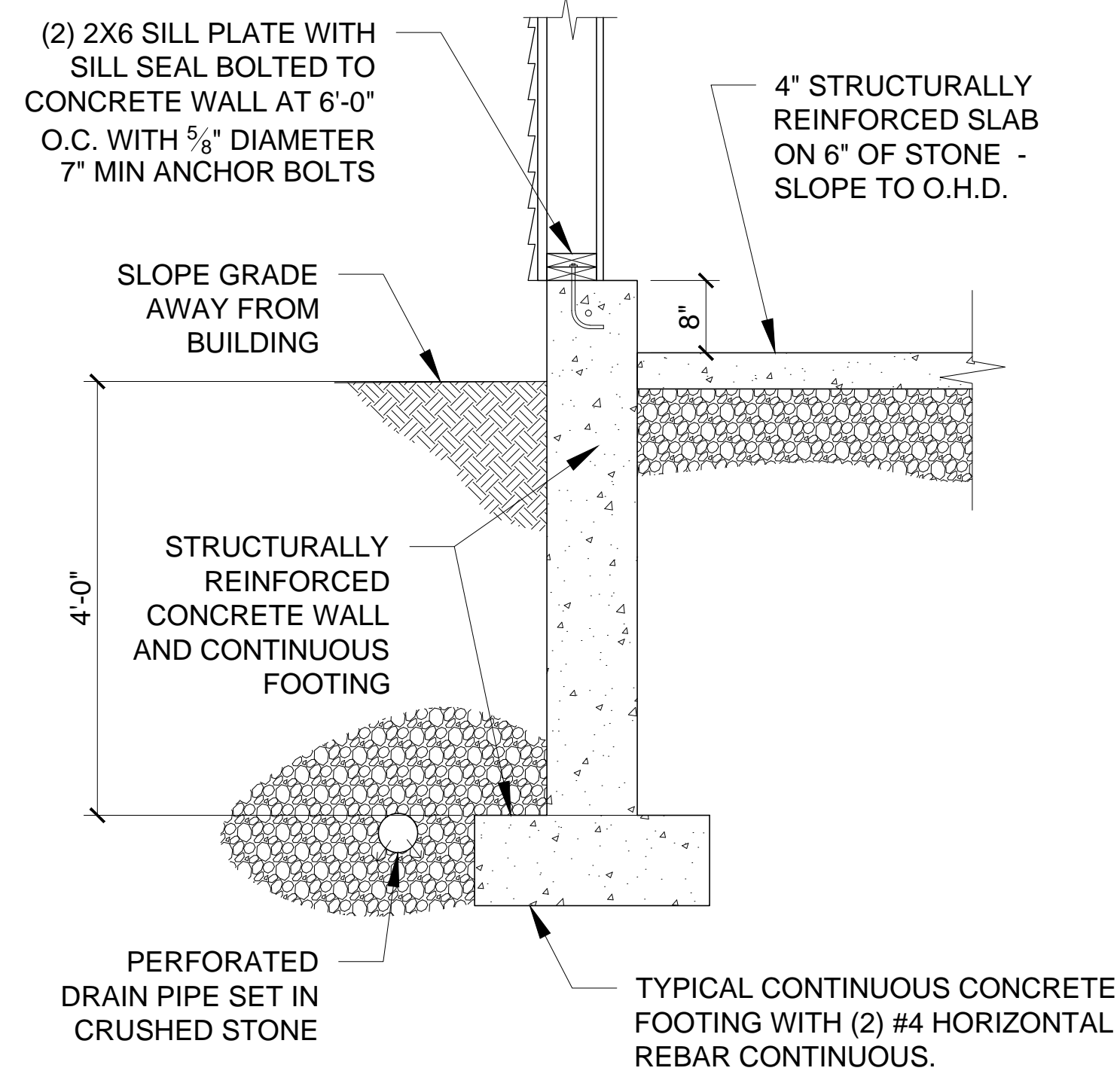

2 FOUNDATION WALL AT BUILDING
3/4" = 1'-0" (WHEN PRINTED AT 24"X36")

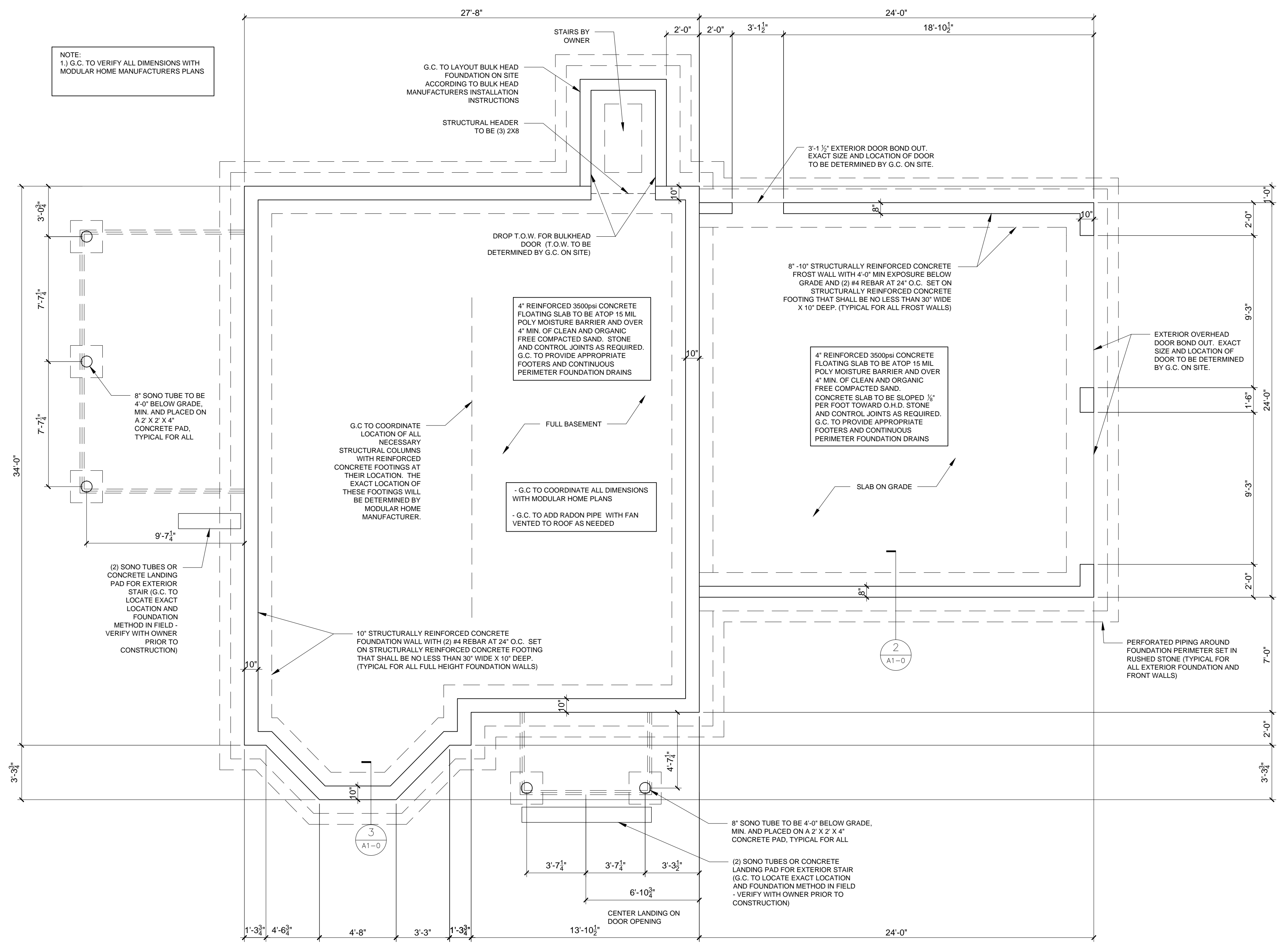

1 FOUNDATION PLAN
1/4" = 1'-0" (WHEN PRINTED AT 24"X36")

PROGRESS PRINT
NOT FOR CONSTRUCTION