

FRONT

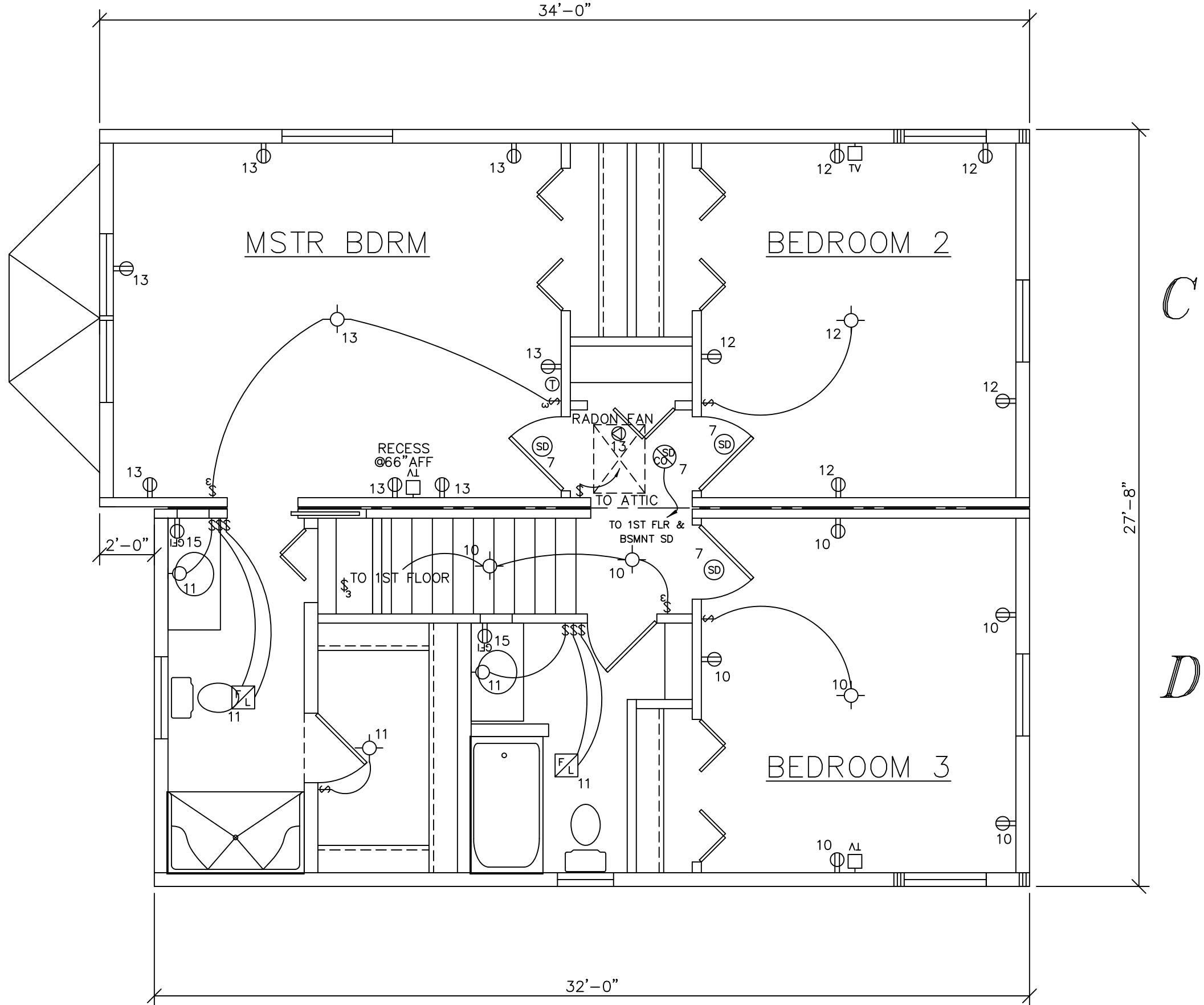

WMH TO PROVIDE JUNCTION BOX AND CIRCUIT FOR FUTURE RADON FAN BY B/P - CIRCUIT #13

2011 N.E.C.

- * ALL OUTLETS TO BE TAMPER RESISTANT *
- * ALL LIGHT FIXTURE BOXES TO BE HEAVY DUTY [50# MIN.] *
- * ALL EXT. GFI RECEPTACLES TO BE UV RATED *
- * MAX (2) WIRES PER HOLE THRU PLATES [WHEN CAULKED] *
- * NEUTRAL REQUIRED AT ALL LIGHTING CONTROLS *

SEE STANDARD NOTES & DETAILS DWG #8

| | | | | | | | | | |
|---|--|---|--|--|--|-------------------------|--|-------------------------------|--|
| USE GROUP: SINGLE FAMILY | | BUILDER: SILVER BEACH LLC DBA SILVER BEACH HOMES 83 WELLWOOD RD PORTLAND ME 04103 | | HOMEOWNER: BOUCHARD/MEOLI SITE: 291 SUMMIT STREET PORTLAND, ME 04103 | | SERIAL No. 18066 | | THIRD PARTY INSPECTION AGENCY | |
| CONST. TYPE: VB | | RICHMOND CTM-L 2nd.FL ELECTRICAL PLAN | | PRODUCTION No. | | PE / RA | | PE / RA | |
| DESIGNER: MJC | | DATE: 03/06/18 | | REVISION | | DATE | | CHECK | |
| SCALE: 1/4" = 1'-0" | | PAGE: 6B | | REVISION | | DATE | | CHECK | |
| WESTCHESTER MODULAR HOMES INC 30 REAGANS MILL ROAD, WINGDALE, NEW YORK, 12594 TEL (845)832-9400 FAX (845)832-6698 | | REVISION | | DATE | | CHECK | | DATE | |