

**FRONT**

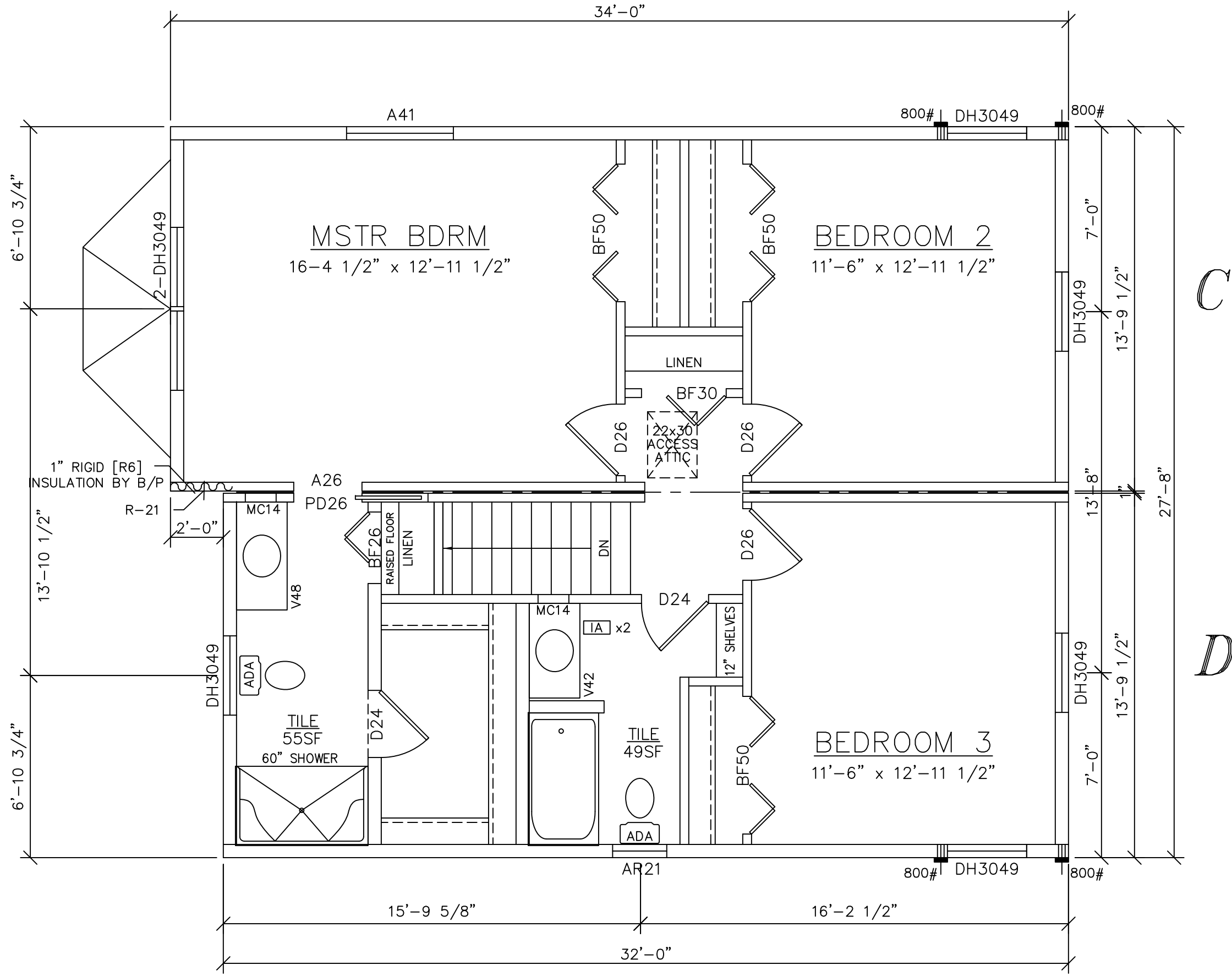

- NOTES:**
- \*R21 INSULATION\*
  - \*ANDERSEN 200 SERIES WINDOWS\*
  - \*INTERIOR DOORS ARE 6 PANEL SOLID SMOOTH CORE\*
  - \*FOAM ATTIC RAFTER BAFFLES\*
  - \*UPGRADE TRIM\*

**LIGHT & VENTILATION SCHEDULE (SF)**

ROOM	AREA	LIGHT SUPPLIED	VENT SUPPLIED
MSTR BDRM	212	25.7	13.52
BEDROOM 2	149	19.8	11.52
BEDROOM 3	149	19.8	11.52

SEE STANDARD NOTES & DETAILS DWG #8

<b>USE GROUP:</b> SINGLE FAMILY	<b>BUILDER:</b> SILVER BEACH LLC DBA SILVER BEACH HOMES 83 WELLMOOD RD PORTLAND ME 04103	<b>HOMEOWNER:</b> BOUCHARD/MEOLI	<b>THIRD PARTY INSPECTION AGENCY:</b>
<b>CONSTR. TYPE:</b> VB	<b>SITE:</b> 291 SUMMIT STREET PORTLAND, ME 04103	<b>DESIGNER:</b> MJG	<b>PE / RA</b>
<b>DATE:</b> 05/05/17	<b>SCALE:</b> 1/4" = 1'-0"	<b>PRODUCTION No.:</b> <b>17066</b>	<b>SERIAL No.:</b> <b>17066</b>
<b>PAGE:</b> <b>3B</b>	<b>REVISION</b>	<b>DATE</b>	<b>DATE</b>
	<b>CHECK</b>	<b>DATE</b>	<b>DATE</b>
	<b>STD REVISION</b>	<b>08/29/06</b>	

**RICHMOND**  
SECOND FLOOR PLAN

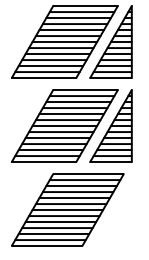

**Westchester Modular Homes Inc**  
30 Reagans Mill Road, Wingdale, New York, 12594  
Tel (845)832-9400 Fax (845)832-6698