

PERMIT ISSUED

City of Portland, Maine - Building or Use Permit Application

389 Congress Street, 04101 Tel: (207) 874-8703, Fax: (207) 874-8716

Permit No: 02-0236	Issue Date: MAR 25 2002	CBL: 388 H001001
-----------------------	----------------------------	---------------------

Location of Construction: 52 Abby Ln	Owner Name: Knop David T & Alisa J Its	Owner Address: 52 Abby Ln	Phone: 207-797-5465
Business Name: n/a	Contractor Name: Atlantic Pool	Contractor Address: 7 Union St. Biddeford	Phone: 2072841505
Lessee/Buyer's Name n/a	Phone: n/a	Permit Type: Swimming Pools	Zone: R-2

Past Use: Single Family	Proposed Use: Single Family / Install 30' round above ground pool.	Permit Fee: \$37.00	Cost of Work: \$1,100.00	CEO District: 2
Proposed Project Description: Install 30' above ground pool		FIRE DEPT: <input type="checkbox"/> Approved <input type="checkbox"/> Denied		INSPECTION: Use Group: R-3 Type: BOCA 1999 Signature: <i>J. Bowker</i>
		PEDESTRIAN ACTIVITIES DISTRICT (P.A.D.) Action: <input type="checkbox"/> Approved <input type="checkbox"/> Approved w/Conditions <input type="checkbox"/> Denied Signature: _____ Date: _____		

Permit Taken By: gg	Date Applied For: 03/18/2002	Zoning Approval
------------------------	---------------------------------	------------------------

1. This permit application does not preclude the Applicant(s) from meeting applicable State and Federal Rules. 2. Building permits do not include plumbing, septic or electrical work. 3. Building permits are void if work is not started within six (6) months of the date of issuance. False information may invalidate a building permit and stop all work..	Special Zone or Reviews <input type="checkbox"/> Shoreland <input type="checkbox"/> Wetland <input type="checkbox"/> Flood Zone <input type="checkbox"/> Subdivision <input type="checkbox"/> Site Plan Maj <input type="checkbox"/> Minor <input type="checkbox"/> MM <input type="checkbox"/> Date: <i>3/25/02</i>	Zoning Appeal <input type="checkbox"/> Variance <input type="checkbox"/> Miscellaneous <input type="checkbox"/> Conditional Use <input type="checkbox"/> Interpretation <input type="checkbox"/> Approved <input type="checkbox"/> Denied	Historic Preservation <input checked="" type="checkbox"/> Not in District or Landmark <input type="checkbox"/> Does Not Require Review <input type="checkbox"/> Requires Review <input type="checkbox"/> Approved <input type="checkbox"/> Approved w/Conditions <input type="checkbox"/> Denied Date: _____
--	--	--	--

CERTIFICATION

I hereby certify that I am the owner of record of the named property, or that the proposed work is authorized by the owner of record and that I have been authorized by the owner to make this application as his authorized agent and I agree to conform to all applicable laws of this jurisdiction. In addition, if a permit for work described in the application is issued, I certify that the code official's authorized representative shall have the authority to enter all areas covered by such permit at any reasonable hour to enforce the provision of the code(s) applicable to such permit.

SIGNATURE OF APPLICANT	ADDRESS	DATE	PHONE
RESPONSIBLE PERSON IN CHARGE OF WORK, TITLE		DATE	PHONE

Application ID Number: 2-0236

Delete Review Save Close

Department: Zoning Status: Approved with Conditions Reviewer: Marge Schmuckal

Comments: 52 Abby Lane Approval Date: 03/25/2002

Given On Date: 03/22/2002

OK to Issue Permit Name: Marge Schmuckal Date: 03/25/2002 Date 2:

Conditions Section: Add New Condition From Default List Add New Condition Delete Condition

This permit is being approved on the basis of plans submitted. Any deviations shall require a separate approval before starting that work.

Please note that your pool is closer than 10 feet to your exterior deck. This deck could be in structural jeopardy if this pool were to fail. The Zoning Ordinance requires a 10 foot setback to principal structures (your main living structure). Please take care to protect your accessory deck.

Create Date: 03/18/2002 By: gg Update Date: 03/25/2002 By: mes

All Purpose Building Permit Application

If you or the property owner owes real estate or personal property taxes or user charges on any property within the City, payment arrangements must be made before permits of any kind are accepted.

Location/Address of Construction: <u>52 Abby Lane Portland</u>		
Total Square Footage of Proposed Structure <u>30 foot round pool</u>	Square Footage of Lot <u>11,554</u>	
Tax Assessor's Chart, Block & Lot Chart# <u>388</u> Block# <u>11</u> Lot# <u>001</u>	Owner: <u>Dave Knop</u>	Telephone: <u>797-5465</u>
Lessee/Buyer's Name (If Applicable)	Applicant name, address & telephone: <u>Dave Knop</u> <u>52 Abby Lane Portland</u> <u>04103</u> <u>797-5465</u>	Cost Of Work: <u>\$1100.00</u> Fee: \$ <u>37-</u>
What size is the pool: <u>30 ft. round</u> Above or below ground: <u>above</u>		
Dimensions of decking and/or platforms: <u>n/a</u>		
Contractor's name, address & telephone: <u>Don Ballard - Atlantic Pool + Billiards</u> <u>7 Union St Biddford, ME 04005</u> <u>284-1505</u>		
Who should we contact when the permit is ready: <u>Dave Knop</u>		
Mailing address: <u>52 Abby Ln.</u> <u>Portland, ME 04103</u>		
We will contact you by phone when the permit is ready. You must come in and pick up the permit and review the requirements before starting any work, with a Plan Reviewer. A stop work order will be issued and a \$100.00 fee if any work starts before the permit is picked up. PHONE: <u>797-5465</u>		

IF THE REQUIRED INFORMATION IS NOT INCLUDED IN THE SUBMISSIONS THE PERMIT WILL BE AUTOMATICALLY DENIED AT THE DISCRETION OF THE BUILDING/PLANNING DEPARTMENT, WE MAY REQUIRE ADDITIONAL INFORMATION IN ORDER TO APPROVE THIS PERMIT.

I hereby certify that I am the Owner of record of the named property, or that the owner of record authorizes the proposed work and that I have been authorized by the owner to make this application as his/her authorized agent. I agree to conform to all applicable laws of this jurisdiction. In addition, if a permit for work described in this application is issued, I certify that the Code Official's authorized representative shall have the authority to enter all areas covered by this permit at any reasonable hour to enforce the provisions of the codes applicable to this permit.

Signature of applicant: 	Date: <u>3/15/02</u>
---	----------------------

This is NOT a permit; you may not commence ANY work until the permit is issued. If you are in a Historic District you may be subject to additional permitting and fees with the Planning Department on the 4th floor of City Hall

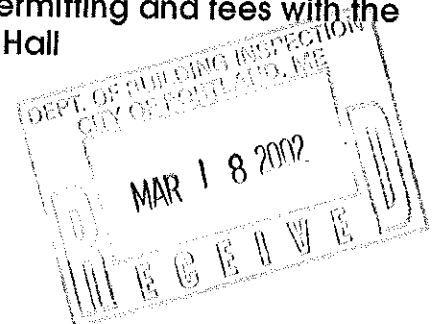

3/20/02 left message w/ Applicant to call concerning code issues JB

3/20/02 Mr. Knopf called - reviewed code requirements - he will submit changes. JB

3/21/02 submittal addressing code issues ok to approve. JB

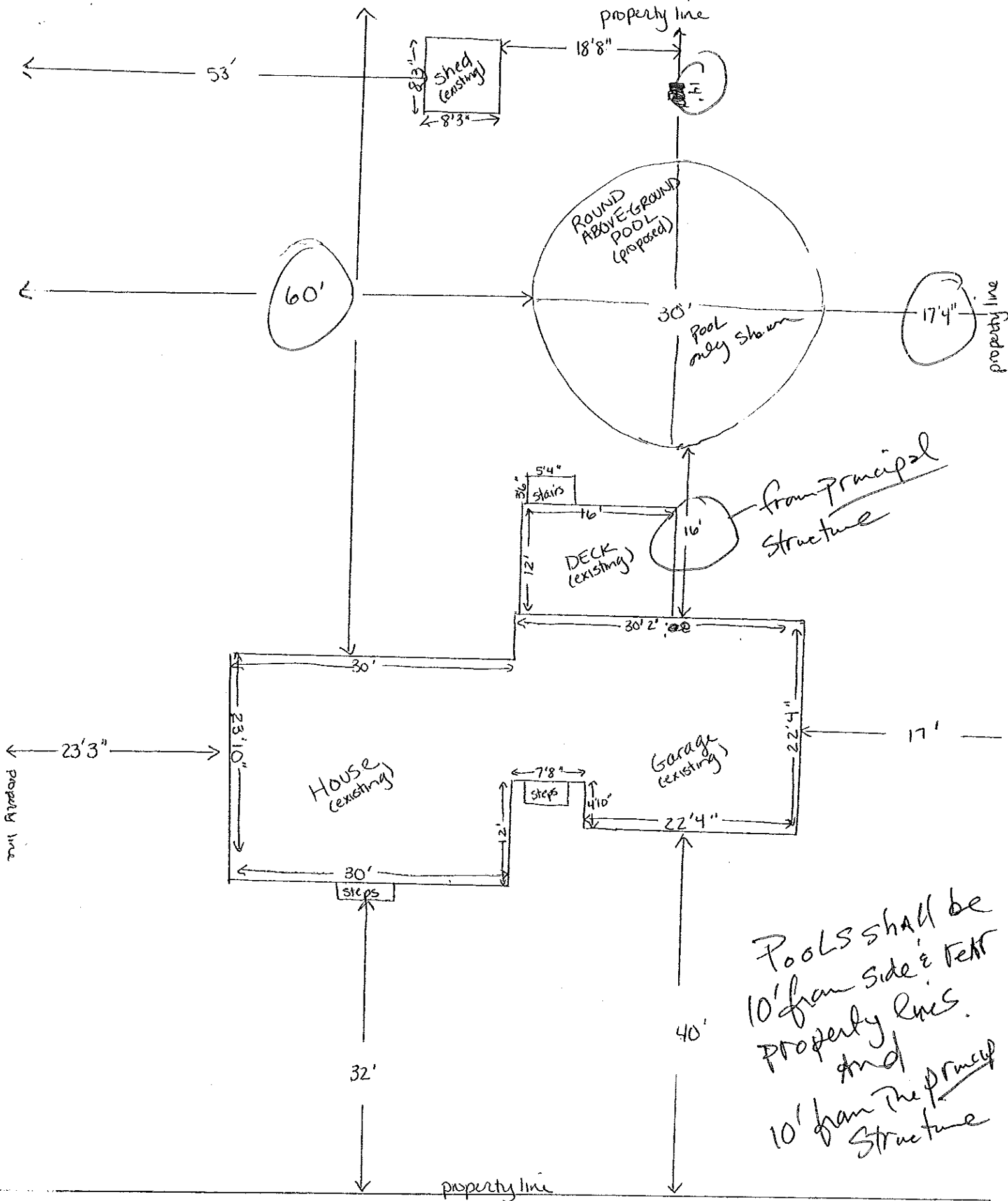

PLOT PLAN FOR 30' ROUND ABOVE-GROUND POOL AT 52 ABBY LANE PORTLAND

STREET

Building Plan
 30' Round above-ground
 pool - 52 Abby Ln.
 Portland

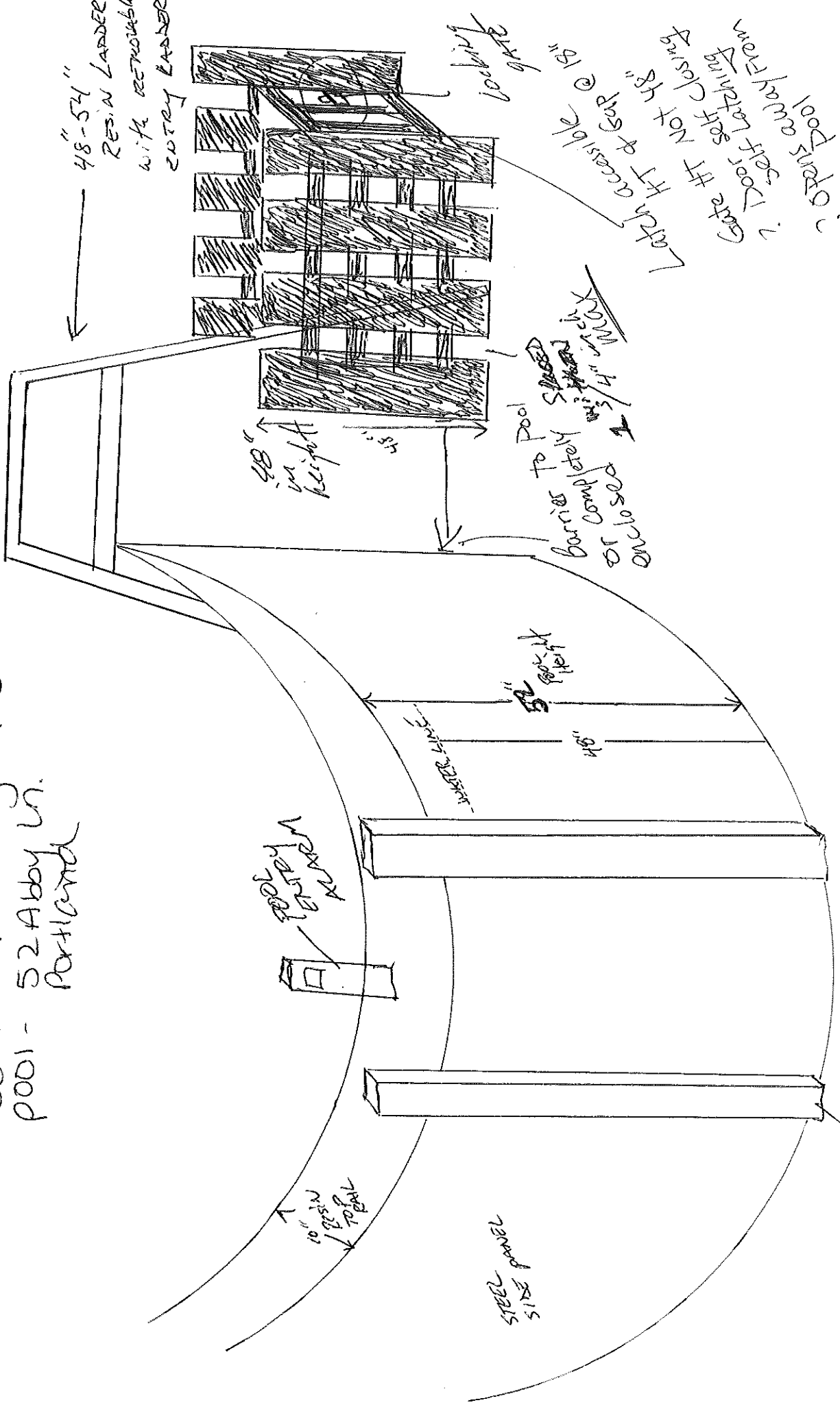

- TOP RAIL USE THE I-BEAM construction technique
- CLOSED CHANNEL construction
- USE IN MANUFACTURING OF VERTICLE

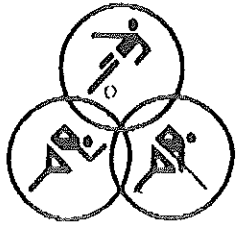

**SACO BAY ORTHOPAEDIC &
SPORTS PHYSICAL THERAPY, P.A.**

400 North Street, Suite 2
Saco, ME 04072
(207) 282-7121
Fax: (207) 282-0073

FAX COVER SHEET

**FAX NO. (207) 282-0073
TELEPHONE NO. (207) 282-7121**

DATE: 3/21/02

For 52 Abby Lane

TO: Jennie

CBL 388-H-001

RE: pool permit

FROM: David Knop

PAGES INCLUDING COVER SHEET:

******* CONFIDENTIALITY NOTICE *******

THIS MESSAGE IS INTENDED ONLY FOR THE USE OF THE INDIVIDUAL OF ENTITY TO WHICH IT IS ADDRESSED AND MAY CONTAIN INFORMATION THAT IS PRIVILEGED, CONFIDENTIAL AND EXEMPT FROM DISCLOSURE UNDER APPLICABLE LAW. IF THE READER OF THIS MESSAGE IS NOT THE INTENDED RECIPIENT, YOU ARE HEREBY NOTIFIED THAT ANY DISSEMINATION, DISTRIBUTION OR COPYING OF THE COMMUNICATION IS STRICTLY PROHIBITED. IF YOU RECEIVE THIS MESSAGE IN ERROR, PLEASE NOTIFY US IMMEDIATELY BY TELEPHONE AND RETURN THE ORIGINAL MESSAGE TO US AT THE ADDRESS NOTED ABOVE, VIA THE UNITED STATES POSTAL SERVICE.

THANK YOU!!!

Pool

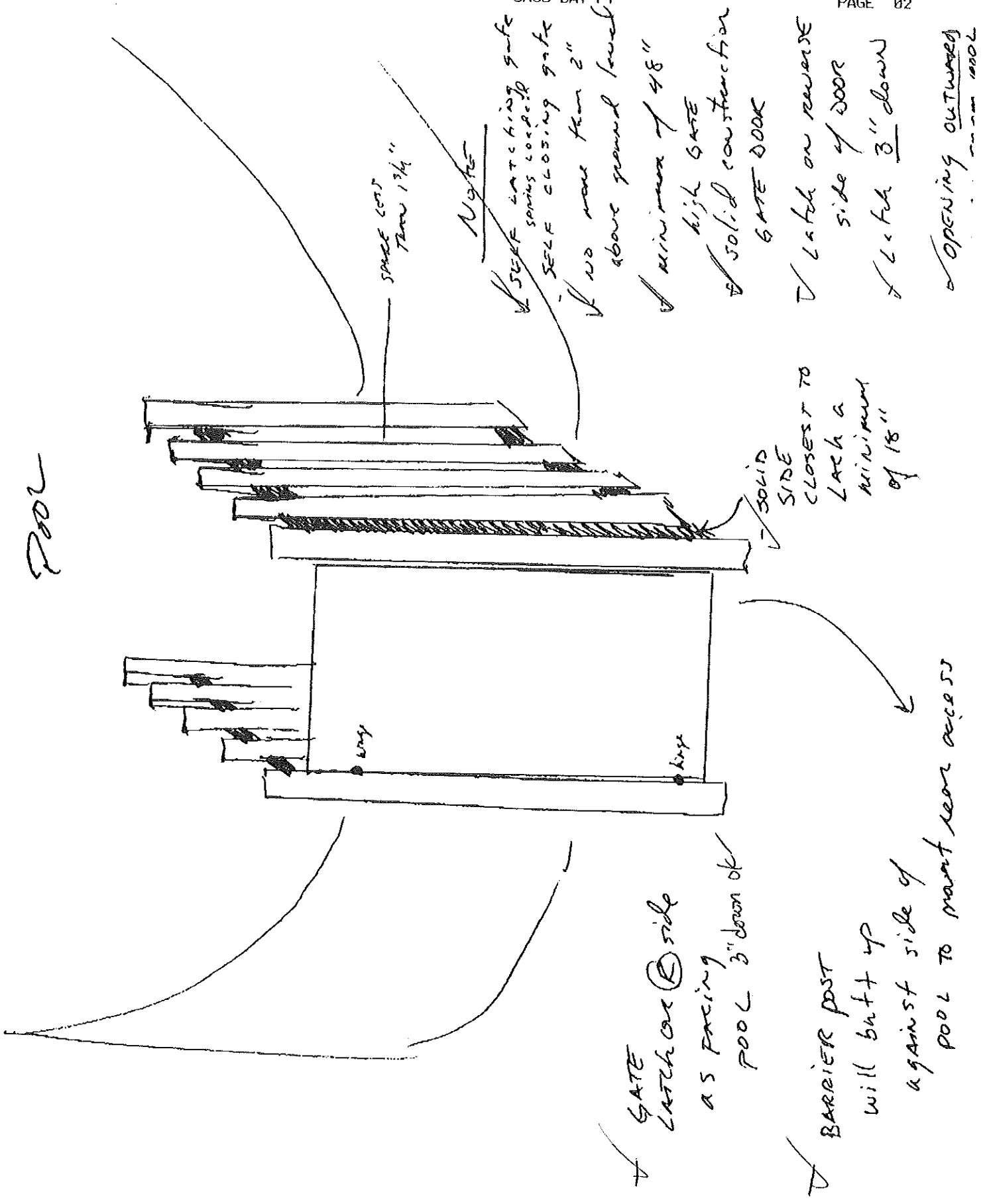

SPACE COUPLER
1 3/4"

NOTE

- ✓ SELF LATCHING GATE
- ✓ SELF CLOSING GATE
- ✓ NO MORE THAN 2" ABOVE GROUND LEVEL

- ✓ MINIMUM OF 48" HIGH GATE
- ✓ SOLID CONSTRUCTION GATE DOOR

- ✓ LATCH ON REVERSE SIDE OF DOOR
- ✓ LATCH 3" DOWN

OPENING OUTWARD

✓ SOLID SIDE CLOSEST TO LATCH A MINIMUM OF 18"

✓ GATE LATCH ON R SIDE AS FACING POOL 3" DOWN OK

✓ BARRIER POST will butt up AGAINST SIDE OF POOL TO prevent rear access