

# DISPLAY THIS CARD ON PRINCIPAL FRONTAGE OF WORK CITY OF PORTLAND

Please Read Application And Notes, If Any, Attached

BUILDING INSPECTION

PERMIT

PERMIT ISSUED  
Permit Number: 000723

JUL 14 2006

388 B001000 CITY OF PORTLAND

This is to certify that MCAULEY PENNY I/Class Window Systems

has permission to Replace existing windows with new large windows

AT 25 CARON ST

provided that the person or persons firm or corporation accepting this permit shall comply with all of the provisions of the Statutes of this State and of the Ordinances of the City of Portland regulating the construction, maintenance and use of buildings and structures, and of the application on file in this department.

Apply to Public Works for street line and grade if nature of work requires such information.

Notification of inspection must be given and when permission procured before this building or part thereof is altered or enclosed-in. 24 HOUR NOTICE IS REQUIRED.

A certificate of occupancy must be procured by owner before this building or part thereof is occupied.

**OTHER REQUIRED APPROVALS**

Fire Dept. \_\_\_\_\_

Health Dept. \_\_\_\_\_

Appeal Board \_\_\_\_\_

Other \_\_\_\_\_

Department Name

*[Signature]*  
Director - Building & Inspection Services  
2/5/06

**PENALTY FOR REMOVING THIS CARD**

**City of Portland, Maine - Building or Use Permit Application**

389 Congress Street, 04101 Tel: (207) 874-8703, Fax: (207) 874-8716

Permit No: 06-0773	Issue Date: JUL 17 2006 PERMIT ISSUED	CBL: 388 B001001
-----------------------	---	---------------------

Location of Construction: 25 CARON ST	Owner Name: MCAULEY PENNY J	Owner Address: 25 CARON ST	Phone:
Business Name:	Contractor Name: Classic Window Systems	Contractor Address: P.O. Box 1097 Portland	Phone: 2077731950
Lessee/Buyer's Name	Phone:	Permit Type: Alterations - Dwellings	Zone: R-2

Past Use: Single Family Home	Proposed Use: Single Family Home/ Replace existing windows with new larger windows	Permit Fee: \$48.00	Cost of Work: \$2,847.00	CEO District: 5
Proposed Project Description: Replace existing windows with new larger windows		FIRE DEPT: <input type="checkbox"/> Approved <input type="checkbox"/> Denied	INSPECTION: Use Group: R3 Type: SB 7/15/06	
		Signature:	Signature: <i>[Signature]</i>	

PEDESTRIAN ACTIVITIES DISTRICT (P.A.D.)	
Action: <input type="checkbox"/> Approved <input type="checkbox"/> Approved w/Conditions <input type="checkbox"/> Denied	Signature: _____ Date: _____

Permit Taken By: Idobson	Date Applied For: 05/22/2006	<b>Zoning Approval</b>	
-----------------------------	---------------------------------	------------------------	--

<ol style="list-style-type: none"> <li>This permit application does not preclude the Applicant(s) from meeting applicable State and Federal Rules.</li> <li>Building permits do not include plumbing, septic or electrical work.</li> <li>Building permits are void if work is not started within six (6) months of the date of issuance. False information may invalidate a building permit and stop all work..</li> </ol>	<b>Special Zone or Reviews</b> <input type="checkbox"/> Shoreland <input type="checkbox"/> Wetland <input type="checkbox"/> Flood Zone <input type="checkbox"/> Subdivision <input type="checkbox"/> Site Plan Maj <input type="checkbox"/> Minor <input type="checkbox"/> MM <input type="checkbox"/> Date: <i>[Signature]</i>	<b>Zoning Appeal</b> <input type="checkbox"/> Variance <input type="checkbox"/> Miscellaneous <input type="checkbox"/> Conditional Use <input type="checkbox"/> Interpretation <input type="checkbox"/> Approved <input type="checkbox"/> Denied Date: _____	<b>Historic Preservation</b> <input checked="" type="checkbox"/> Not in District or Landmark <input type="checkbox"/> Does Not Require Review <input type="checkbox"/> Requires Review <input type="checkbox"/> Approved <input type="checkbox"/> Approved w/Conditions <input type="checkbox"/> Denied Date: <i>[Signature]</i>
---	--	---	---

**CERTIFICATION**

I hereby certify that I am the owner of record of the named property, or that the proposed work is authorized by the owner of record and that I have been authorized by the owner to make this application as his authorized agent and I agree to conform to all applicable laws of this jurisdiction. In addition, if a permit for work described in the application is issued, I certify that the code official's authorized representative shall have the authority to enter all areas covered by such permit at any reasonable hour to enforce the provision of the code(s) applicable to such permit.

SIGNATURE OF APPLICANT	ADDRESS	DATE	PHONE
RESPONSIBLE PERSON IN CHARGE OF WORK, TITLE		DATE	PHONE

**City of Portland, Maine - Building or Use Permit**

389 Congress Street, 04101 Tel: (207) 874-8703, Fax: (207) 874-8716

Permit No: 06-0773	Date Applied For: 05/22/2006	CBL: 388 B001001
-----------------------	---------------------------------	---------------------

<b>Location of Construction:</b> 25 CARON ST	<b>Owner Name:</b> MCAULEY PENNY J	<b>Owner Address:</b> 25 CARON ST	<b>Phone:</b>
<b>Business Name:</b>	<b>Contractor Name:</b> Classic Window Systems	<b>Contractor Address:</b> P.O. Box 1097 Portland	<b>Phone</b> (207) 773-1950
<b>Lessee/Buyer's Name</b>	<b>Phone:</b>	<b>Permit Type:</b> Alterations - Dwellings	

<b>Proposed Use:</b> Single Family Home/ Replace existing windows with new larger windows	<b>Proposed Project Description:</b> Replace existing windows with new larger windows
--	--

<b>Dept:</b> Zoning	<b>Status:</b> Approved	<b>Reviewer:</b> Marge Schmuckal	<b>Approval Date:</b> 06/06/2006
<b>Note:</b>			<b>Ok to Issue:</b> <input checked="" type="checkbox"/>
<b>Dept:</b> Building	<b>Status:</b> Approved with Conditions	<b>Reviewer:</b> Mike Nugent	<b>Approval Date:</b> 07/05/2006
<b>Note:</b>			<b>Ok to Issue:</b> <input checked="" type="checkbox"/>
1) All new framing must be at least 2 inches away from the existing chimney.			



# General Building Permit Application

If you or the property owner owes real estate or personal property taxes or user charges on any property within the City, payment arrangements must be made before permits of any kind are accepted.

Location/Address of Construction: <u>25 Crown St.</u>		
Total Square Footage of Proposed Structure _____		Square Footage of Lot
Tax Assessor's Chart, Block & Lot Chart# <u>388</u> Block# <u>B</u> Lot# <u>1</u>	Owner: <u>PENNY J. McAULEY</u>	Telephone: <u>878-9414</u>
Lessee/Buyer's Name (If Applicable) _____	Applicant name, address & telephone: <u>CLASSIC WINDOW SYSTEMS, INC</u> <u>P.O. Box 1097</u> <u>PORTLAND, ME. 04104</u> <u>ATTN: JAMES SMITH</u> <u>671-3017</u>	Cost Of Work: \$ <u>2847.00</u> Fee: \$ <u>48<sup>00</sup>/00</u> C of O Fee: \$ _____
Current Specific use: <u>RESIDENCE</u>		
If vacant, what was the previous use? _____		
Proposed Specific use: _____		
Project description: <u>REMOVING 2 SMALL WINDOWS, MODIFYING FRAMING TO RECEIVE 2 WIDER WINDOWS.</u>		
Contractor's name, address & telephone: <u>CLASSIC WINDOW SYSTEMS (SEE ABOVE)</u>		
Who should we contact when the permit is ready: <u>JAMES SMITH</u>		
Mailing address: _____ Phone: <u>671-3017</u>		

**Please submit all of the information outlined in the Commercial Application Checklist. Failure to do so will result in the automatic denial of your permit.**

In order to be sure the City fully understands the full scope of the project, the Planning and Development Department may request additional information prior to the issuance of a permit. For further information visit us on-line at [www.portlandmaine.gov](http://www.portlandmaine.gov), stop by the Building Inspections office, room 315 City Hall or call 874-8703

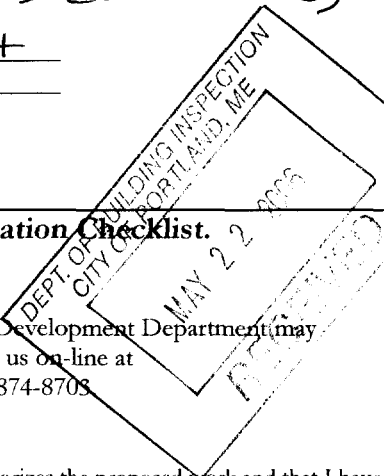

I hereby certify that I am the Owner of record of the named property, or that the owner of record authorizes the proposed work and that I have been authorized by the owner to make this application as his/her authorized agent. I agree to conform to all applicable laws of this jurisdiction. In addition, if a permit for work described in this application is issued, I certify that the Code Official's authorized representative shall have the authority to enter all areas covered by this permit at any reasonable hour to enforce the provisions of the codes applicable to this permit.

Signature of applicant:	Date: <u>5/22/06</u>
-------------------------	----------------------

**This is not a permit; you may not commence ANY work until the permit is issued.**



MEAWLEY - LIVING ROOM WINDOW DETAIL

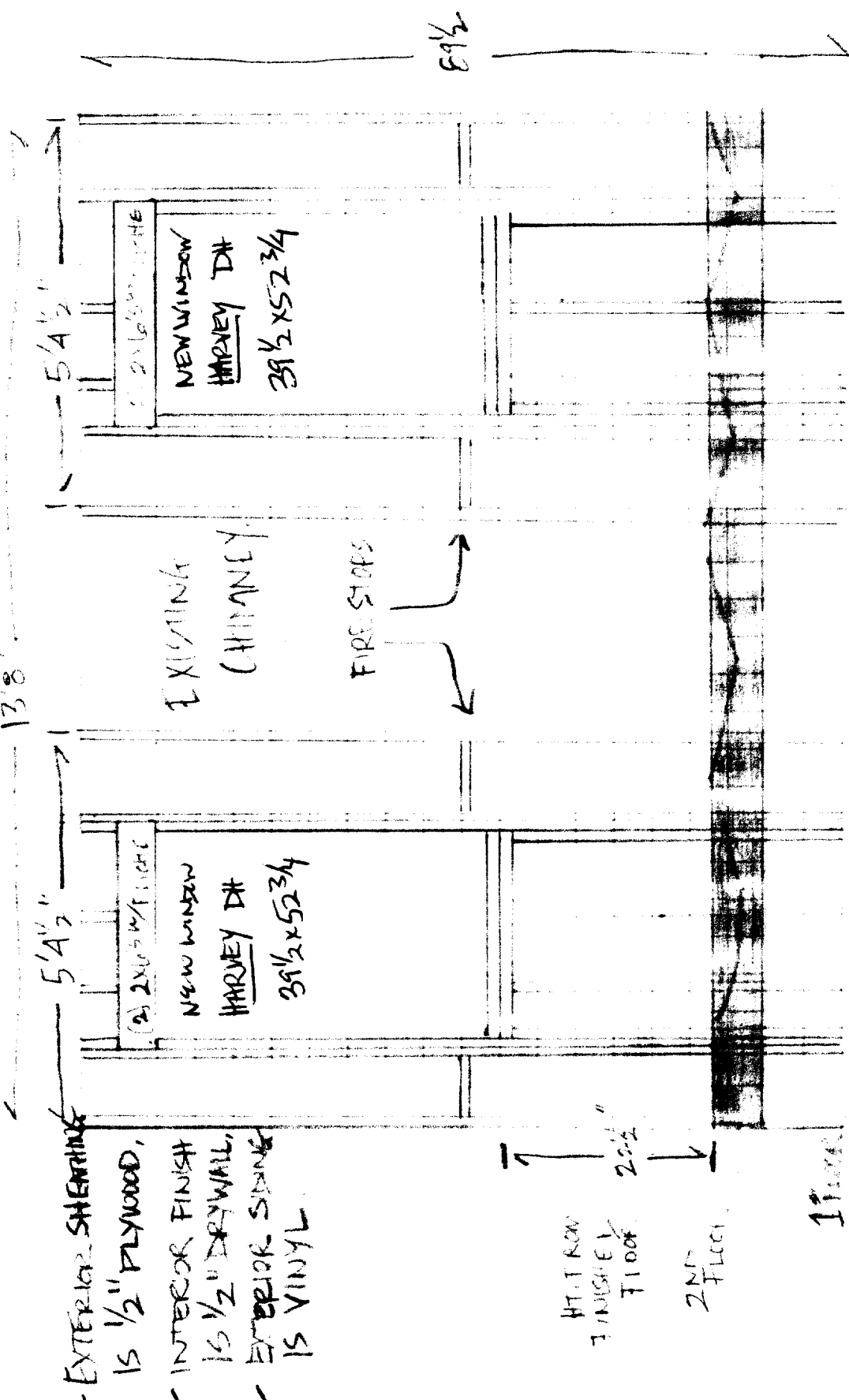

EXISTING WINDOWS ARE 185/8" x 51 1/2" TALL. THE EXISTING WINDOWS WILL BE REMOVED AND REPLACED WITH NEWER HARVEY D# 185/8" x 51 1/2" WINDOWS. NEW WINDOWS WILL BE 39 1/2" x 52 3/4". NEW 2' x 6" PLANKS WILL BE INSTALLED TO REPLACE EXISTING CHIMNEY. NEW WINDOWS ARE POSTHOLE CUT THROUGH EXISTING WALL WITH ONLY ROD ABOVE. THE NEW WALL IS TO BE 1/2" THICK WITH FINISH OVER.

- EXTERIOR SHEATHING IS 1/2" PLYWOOD,
- INTERIOR FINISH IS 1/2" DRYWALL,
- EXTERIOR SIDING IS VINYL.

H.T. ROW FINISHED FLOOR 2nd FLOOR

Job: \_\_\_\_\_ Date: \_\_\_\_\_



Visit Our New Showroom



2325 Broadway, Suite 1  
 So. Portland, ME 04106-3362  
 tel: 207-772-2223 fax: 207-773-3261  
 email: sales@lorangerdoor.com