

City of Portland, Maine - Building or Use Permit Application

389 Congress Street, 04101 Tel: (207) 874-8703, Fax: (207) 874-8716

Permit No: 07-1438	Issue Date: 11/29/07	CBL: 386A B034001
-----------------------	-------------------------	----------------------

Location of Construction: 38 ARMSTRONG HEIGHTS	Owner Name: ARMSTRONG JULIE L	Owner Address: 38 ARMSTRONG HEIGHTS	Phone:
Business Name:	Contractor Name: Irving Oil	Contractor Address: 385 Main Street South Portland	Phone: 2077728304
Lessee/Buyer's Name	Phone:	Permit Type: HVAC	Zone: R-2

Past Use: Single family home	Proposed Use: single family home with 500 gallon underground LP tank	Permit Fee: \$50.00	Cost of Work: \$2,934.00	CEO District: 5
Proposed Project Description: Install 500 gallon underground LP tank		FIRE DEPT: <input checked="" type="checkbox"/> Approved <input type="checkbox"/> Denied TO NJPA 58	INSPECTION: Use Group: R-3 Type: 5B JMC 2003 NJPA-58	

Signature: Greg Cass
Signature: 11/29/07 el M

PEDESTRIAN ACTIVITIES DISTRICT (P.A.D.)
Action: Approved Approved w/Conditions Denied
Signature: _____ Date: _____

Permit Taken By: lmd	Date Applied For: 11/12/2007	Zoning Approval
-------------------------	---------------------------------	------------------------

- This permit application does not preclude the Applicant(s) from meeting applicable State and Federal Rules.
- Building permits do not include plumbing, septic or electrical work.
- Building permits are void if work is not started within six (6) months of the date of issuance. False information may invalidate a building permit and stop all work..

Special Zone or Reviews <input type="checkbox"/> Shoreland <input type="checkbox"/> Wetland <input type="checkbox"/> Flood Zone <input type="checkbox"/> Subdivision <input type="checkbox"/> Site Plan Maj <input type="checkbox"/> Minor <input checked="" type="checkbox"/> MM Date: 11/27/07	Zoning Appeal <input type="checkbox"/> Variance <input type="checkbox"/> Miscellaneous <input type="checkbox"/> Conditional Use <input type="checkbox"/> Interpretation <input type="checkbox"/> Approved <input type="checkbox"/> Denied Date: _____	Historic Preservation <input checked="" type="checkbox"/> Not in District or Landmark <input type="checkbox"/> Does Not Require Review <input type="checkbox"/> Requires Review <input type="checkbox"/> Approved <input type="checkbox"/> Approved w/Conditions <input type="checkbox"/> Denied Date: _____
--	---	--

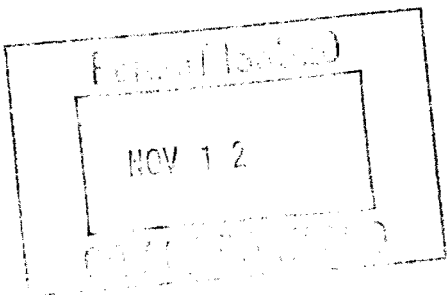

Scanned

CERTIFICATION

I hereby certify that I am the owner of record of the named property, or that the proposed work is authorized by the owner of record and that I have been authorized by the owner to make this application as his authorized agent and I agree to conform to all applicable laws of this jurisdiction. In addition, if a permit for work described in the application is issued, I certify that the code official's authorized representative shall have the authority to enter all areas covered by such permit at any reasonable hour to enforce the provision of the code(s) applicable to such permit.

SIGNATURE OF APPLICANT _____ ADDRESS _____ DATE _____ PHONE _____

RESPONSIBLE PERSON IN CHARGE OF WORK, TITLE _____ DATE _____ PHONE _____

City of Portland, Maine - Building or Use Permit
389 Congress Street, 04101 Tel: (207) 874-8703, Fax: (207) 874-8716

Permit No: 07-1438	Date Applied For: 11/12/2007	CBL: 386A B034001
-----------------------	---------------------------------	----------------------

Location of Construction: 38 ARMSTRONG HEIGHTS	Owner Name: ARMSTRONG JULIE L	Owner Address: 38 ARMSTRONG HEIGHTS	Phone:
Business Name:	Contractor Name: Irving Oil	Contractor Address: 385 Main Street South Portland	Phone: (207) 772-8304
Lessee/Buyer's Name	Phone:	Permit Type: HVAC	

Proposed Use: single family home with 500 gallon underground LP tank	Proposed Project Description: Install 500 gallon underground LP tank
---	---

Dept: Zoning Status: Approved Reviewer: Marge Schmuckal Approval Date: 11/27/2007
Note: Ok to Issue:

Dept: Building Status: Approved with Conditions Reviewer: Chris Hanson Approval Date: 11/29/2007
Note: Ok to Issue:

- Application approval based upon information provided by applicant. Any deviation from approved plans requires separate review and approval prior to work.
- The installation must comply with the State of Maine Gas Regulations.
- Installation shall comply with 2003 International Mechanical Code and State of Maine Oil and Solid Fuel Board Laws and Rules



FILL IN AND SIGN WITH INK

APPLICATION FOR PERMIT HEATING OR POWER EQUIPMENT

386A-0034

PERMIT NO.
NOV 2007
09-1468
CITY OF PORTLAND

To the INSPECTOR OF BUILDINGS, PORTLAND, ME.

The undersigned hereby applies for a permit to install the following heating, cooking or power equipment in accordance with the Laws of Maine, the Building Code of the City of Portland, and the following specifications:

Location / CBL 38 ARMSTRONG HEIGHTS Use of Building RESIDENTIAL Date 11-12-07
 Name and address of owner of appliance KIRK ARMSTRONG
38 ARMSTRONG HEIGHTS PORTLAND, ME. 04103-2146
 Installer's name and address IRVING OIL
385 MAIN ST. SOUTH PORTLAND Telephone 939-8407

<p>Location of appliance:</p> <p><input type="checkbox"/> Basement <input type="checkbox"/> Floor <input type="checkbox"/> Attic <input type="checkbox"/> Roof</p> <p>Type of Fuel:</p> <p><input type="checkbox"/> Gas <input type="checkbox"/> Oil <input type="checkbox"/> Solid</p> <p>Appliance Name: _____ U.L. Approved <input type="checkbox"/> Yes <input type="checkbox"/> No</p> <p>Will appliance be installed in accordance with the manufacture's installation instructions? <input type="checkbox"/> Yes <input type="checkbox"/> No</p> <p>IF NO Explain: _____ _____</p> <p>The Type of License of Installer:</p> <p><input type="checkbox"/> Master Plumber # _____ <input type="checkbox"/> Solid Fuel # _____ <input type="checkbox"/> Oil # _____ <input checked="" type="checkbox"/> Gas # <u>212</u> <u>MIKE EATON</u> <input type="checkbox"/> Other _____</p>	<p>Type of Chimney:</p> <p><input type="checkbox"/> Masonry Lined Factory built _____</p> <p><input type="checkbox"/> Metal Factory Built U.L. Listing # _____</p> <p><input type="checkbox"/> Direct Vent Type _____ UL# _____</p> <p>Type of Fuel Tank</p> <p><input type="checkbox"/> Oil <input checked="" type="checkbox"/> Gas</p> <p>Size of Tank <u>500 GALLON UNDERGROUND L.P. TANK</u></p> <p>Number of Tanks <u>ONE</u></p> <p>Distance from Tank to Center of Flame <u>80</u> feet.</p> <p>Cost of Work: \$ <u>2934.00</u> Permit Fee: \$ <u>50.00</u></p>
---	---

<p>Approved</p> <p>Fire: _____ Ele.: _____ Bldg.: _____</p> <p>Signature of Installer <u>SALSMAN - Ed [Signature]</u></p>	<p>Approved with Conditions</p> <p><input checked="" type="checkbox"/> See attached letter or requirement</p> <p><u>[Signature]</u> <u>11/29/07</u> Inspector's Signature Date Approved</p>
--	---

White - Inspection Yellow - File Pink - Applicant's Gold - Assessor's Copy

PROPANE INSTALLATION SHEET

SCHEDULE DATE AND TIME:

ACCOUNT# 907682 Svc# Tak#
 CUSTOMER NAME: KIRK ARMSTRONG
 SITE CONTACT:
 TELEPHONE #'S: 939-8407

INSTALLATION LOCATION & DIRECTIONS:
 38 ARMSTRONG HEIGHTS PORTLAND, ME.
 INSTALL 500 GALLON UNDERGROUND
 L.P. TANK AND GAS LINE TO BUILDINGS.

Site diagram: tank and regulator location, pipe sizing and distances, new and/or existing piping, and appliance locations.

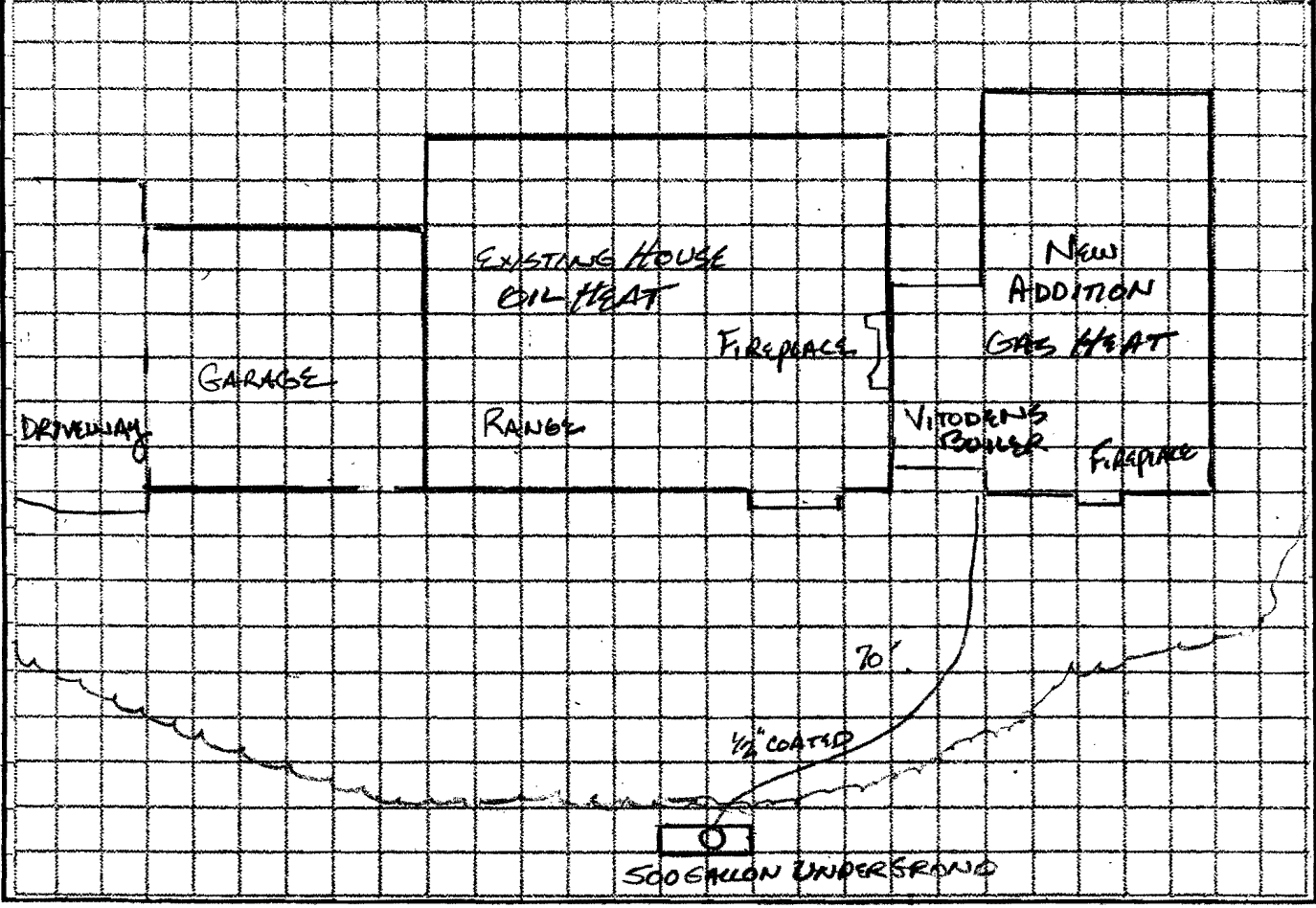

TANK SIZE: 500 UNDERGROUND
 TANK SET: ONE OR TWO MEN
 APP#1 MODEL: RANGE
 APP#1 BTU:
 APP#2 MODEL: FIREPLACE
 APP#2 BTU:
 APP#3 MODEL: VITODENS
 APP#3 BTU:
 APP#4 MODEL: FIREPLACE
 APP#4 BTU:

ESTIMATED YEARLY USAGE:
 PRIMARY HEAT: YES NEW ADDITION NO, CH or SH
 HOT WATER GALLONS:
 SPECIAL USAGE INFORMATION:

TOOLS NEEDED:
 Boom Truck: Y or N
 Drills: Y or N
 Step Ladder: Y or N
 Ext. Ladder: Y or N
 Hole Saw: Y or N
 Hammer Drill: Y or N
 Thread Gear: Y or N
 Size:

TOTAL LABOR: 1 man 2 hours 5 hours = 7 Total Hours
 PIPE LENGTH AND SIZE(S): 70' 1/2\"/>

SALESPERSON: ED



CITY OF PORTLAND, MAINE
 Department of Building Inspections

10-27 2007

Received from Robert Carlson

Location of Work 38 Armstrong Ave. etc

Cost of Construction \$ _____

Permit Fee \$ 50⁰⁰

Building (I1) _____ Plumbing (I5) _____ Electrical (I2) _____ Site Plan (U2) _____

Other Heating

CBL: 07-1438
386A-13034

Check #: Mastercard Total Collected \$ 50⁰⁰

THIS IS NOT A PERMIT

No work is to be started until PERMIT CARD is actually posted upon the premises. Acceptance of fee is no guarantee that permit will be granted. PRESERVE THIS RECEIPT. In case permit cannot be granted the amount of the fee will be refunded upon return of the receipt less \$10.00 or 10% whichever is greater.

WHITE - Applicant's Copy
 YELLOW - Office Copy
 PINK - Permit Copy