

PERMIT ISSUED

City of Portland, Maine - Building or Use Permit Application

389 Congress Street, 04101 Tel: (207) 874-8703, Fax: (207) 874-8716

Permit No: 03-0922	Issue Date: AUG 01 2003	CBL: 386A B022001
-----------------------	----------------------------	----------------------

Location of Construction: 98 Garsoe Dr	Owner Name: Myers Stephen R & Linda L Jts	Owner Address: 98 Garsoe Dr CITY OF PORTLAND	Phone: 878*4158
Business Name:	Contractor Name: Poolside Inc	Contractor Address: Walnut Hill Commons Rt9&115 N Yar	Phone: 2078296705
Lessee/Buyer's Name	Phone:	Permit Type: Swimming Pools	Zone: R-2

Past Use: single family	Proposed Use: single family - install 16' x 36' inground pool and build 8' x 10' shed	Permit Fee: \$237.00	Cost of Work: \$24,000.00	CEO District: 2
Proposed Project Description: install 16' x 36' inground pool and build 8' x 10' shed		FIRE DEPT: <input type="checkbox"/> Approved <input checked="" type="checkbox"/> Denied Signature: <i>[Signature]</i>	INSPECTION: Use Group: U Type: Pool Signature: <i>[Signature]</i>	

PEDESTRIAN ACTIVITIES DISTRICT (P.A.D.)	
Action: <input type="checkbox"/> Approved <input type="checkbox"/> Approved w/Conditions <input type="checkbox"/> Denied	Signature: _____ Date: _____

Permit Taken By: tmm	Date Applied For: 08/01/2003	Zoning Approval	
-------------------------	---------------------------------	------------------------	--

<p>1. This permit application does not preclude the Applicant(s) from meeting applicable State and Federal Rules.</p> <p>2. Building permits do not include plumbing, septic or electrical work.</p> <p>3. Building permits are void if work is not started within six (6) months of the date of issuance. False information may invalidate a building permit and stop all work..</p>	<p>Special Zone or Reviews</p> <input type="checkbox"/> Shoreland <input type="checkbox"/> Wetland <input type="checkbox"/> Flood Zone <input type="checkbox"/> Subdivision <input type="checkbox"/> Site Plan <p>Maj <input type="checkbox"/> Minor <input type="checkbox"/> MM <input type="checkbox"/></p> <p>Date: 8/1/03</p>	<p>Zoning Appeal</p> <input type="checkbox"/> Variance <input type="checkbox"/> Miscellaneous <input type="checkbox"/> Conditional Use <input type="checkbox"/> Interpretation <input type="checkbox"/> Approved <input type="checkbox"/> Denied <p>Date: _____</p>	<p>Historic Preservation</p> <input checked="" type="checkbox"/> Not in District or Landmark <input type="checkbox"/> Does Not Require Review <input type="checkbox"/> Requires Review <input type="checkbox"/> Approved <input type="checkbox"/> Approved w/Conditions <input type="checkbox"/> Denied <p>Date: 8/1/03</p>
---	--	---	---

CERTIFICATION

I hereby certify that I am the owner of record of the named property, or that the proposed work is authorized by the owner of record and that I have been authorized by the owner to make this application as his authorized agent and I agree to conform to all applicable laws of this jurisdiction. In addition, if a permit for work described in the application is issued, I certify that the code official's authorized representative shall have the authority to enter all areas covered by such permit at any reasonable hour to enforce the provision of the code(s) applicable to such permit.

SIGNATURE OF APPLICANT _____ ADDRESS _____ DATE _____ PHONE _____

RESPONSIBLE PERSON IN CHARGE OF WORK, TITLE _____ DATE _____ PHONE _____

Form # P 04

DISPLAY THIS CARD ON PRINCIPAL FRONTAGE OF WORK

CITY OF PORTLAND

Permit Number: 030922

Please Read Application And Notes, if Any, Attached

BUILDING INSPECTION PERMIT

This is to certify that Myers Stephen R & Linda L Poolside Inc
 has permission to install 16' x 36' inground pool and build
 AT 98 Garsoe Dr 386A B022001

provided that the person or persons, firm or corporation accepting this permit shall comply with all of the provisions of the Statutes of Maine and of the Ordinances of the City of Portland regulating the construction, maintenance and use of buildings and structures, and of the application on file in this department.

Apply to Public Works for street line and grade if nature of work requires such information.

Notification of inspection must be given and when permit is procured before this building or structure is placed or commenced-in. **NO OTHER NOTICES REQUIRED.**

A certificate of occupancy must be procured by owner before this building or part thereof is occupied.

OTHER REQUIRED APPROVALS
 Fire Dept. PERMIT ISSUED
 Health Dept.
 Appeal Board
 Other

[Signature]
 Director - Building & Inspection Services

AUG 01 2003
 Department Name

CITY OF PORTLAND **PENALTY FOR REMOVING THIS CARD**

BUILDING PERMIT INSPECTION PROCEDURES

Please call 874-8703 or 874-8693 to schedule your inspections as agreed upon

Permits expire in 6 months, if the project is not started or ceases for 6 months.

The Owner or their designee is required to notify the inspections office for the following inspections and provide adequate notice. Notice must be called in 48-72 hours in advance in order to schedule an inspection:

By initializing at each inspection time, you are agreeing that you understand the inspection procedure and additional fees from a "Stop Work Order" and "Stop Work Order Release" will be incurred if the procedure is not followed as stated below.

_____ **Pre-construction Meeting:** Must be scheduled with your inspection team upon receipt of this permit. Jay Reynolds, Development Review Coordinator at 874-8632 must also be contacted at this time, before any site work begins on any project other than single family additions or alterations.

Footing/Building Location Inspection: Prior to pouring concrete

_____ **Re-Bar Schedule Inspection:** Prior to pouring concrete

_____ **Foundation Inspection:** Prior to placing ANY backfill

Framing/Rough Plumbing/Electrical: Prior to any insulating or drywalling

Final/Certificate of Occupancy: Prior to any occupancy of the structure or use. NOTE: There is a \$75.00 fee per inspection at this point.

Certificate of Occupancy is not required for certain projects. Your inspector can advise you if your project requires a Certificate of Occupancy. All projects DO require a final inspection

_____ **If any of the inspections do not occur, the project cannot go on to the next phase, REGARDLESS OF THE NOTICE OR CIRCUMSTANCES.**

_____ **CERIFICATE OF OCCUPANICES MUST BE ISSUED AND PAID FOR, BEFORE THE SPACE MAY BE OCCUPIED**

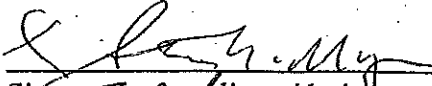

Signature of applicant/designee

Date

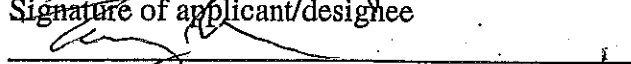

Signature of Inspections Official

Date

CBL: 386-A B-022 Building Permit #: 03 0922

Pool Installation/Construction Permit Application

If you or the property owner owes real estate or personal property taxes or user charges on any property within the City, payment arrangements must be made before permits of any kind are accepted.

Location/Address of Construction: <u>98 Garsoe Dr</u>		
Total Square Footage of Proposed Structure	Square Footage of Lot <u>28,454 sq ft</u>	
Tax Assessor's Chart, Block & Lot Chart# Block# Lot#	Owner: <u>Stephenthilda Myers</u>	Telephone: <u>207-878-4658</u>
Lessee/Buyer's Name (If Applicable)	Applicant name, address & telephone: <u>Stephenthilda Myers</u> <u>98 Garsoe Dr</u> <u>Portland</u> <u>878-4658</u>	Cost Of Work: \$ <u>21,000</u> Fee: \$ _____
Dimensions of pool: <u>16 x 36</u> Above or below ground: <u>Below</u>		
Dimensions of decking and/or any platforms, sheds, or other structures: <u>900 sq ft patio</u> <u>8x10 shed shed</u>		
Contractor's name, address & telephone: <u>Poolside Inc</u> <u>W. NOT Hill Commons</u> <u>Rt 9415</u> <u>N. Yarmouth, Me 04097</u>		
Whom should we contact when the permit is ready: <u>Stephen Myers</u> Mailing address: _____ <u>207-829-6705</u>		
We will contact you by phone when the permit is ready. You must come in and pick up the permit and review the requirements before starting any work, with a Plan Reviewer. A stop work order will be issued and a \$100.00 fee if any work starts before the permit is picked up. PHONE:		

IF THE REQUIRED INFORMATION IS NOT INCLUDED IN THE SUBMISSIONS THE PERMIT WILL BE AUTOMATICALLY DENIED AT THE DISCRETION OF THE BUILDING/PLANNING DEPARTMENT, WE MAY REQUIRE ADDITIONAL INFORMATION IN ORDER TO APPROVE THIS PERMIT.

I hereby certify that I am the Owner of record of the named property, or that the owner of record authorizes the proposed work and that I have been authorized by the owner to make this application as his/her authorized agent. I agree to conform to all applicable laws of this jurisdiction. In addition, if a permit for work described in this application is issued, I certify that the Code Official's authorized representative shall have the authority to enter all areas covered by this permit at any reasonable hour to enforce the provisions of the codes applicable to this permit.

Signature of applicant: <u>Stephenthilda Myers</u>	Date: <u>8/1/03</u>
--	---------------------

This is NOT a permit; you may not commence ANY work until the permit is issued. If you are in a Historic District you may be subject to additional permitting and fees with the Planning Department on the 4th floor of City Hall

A

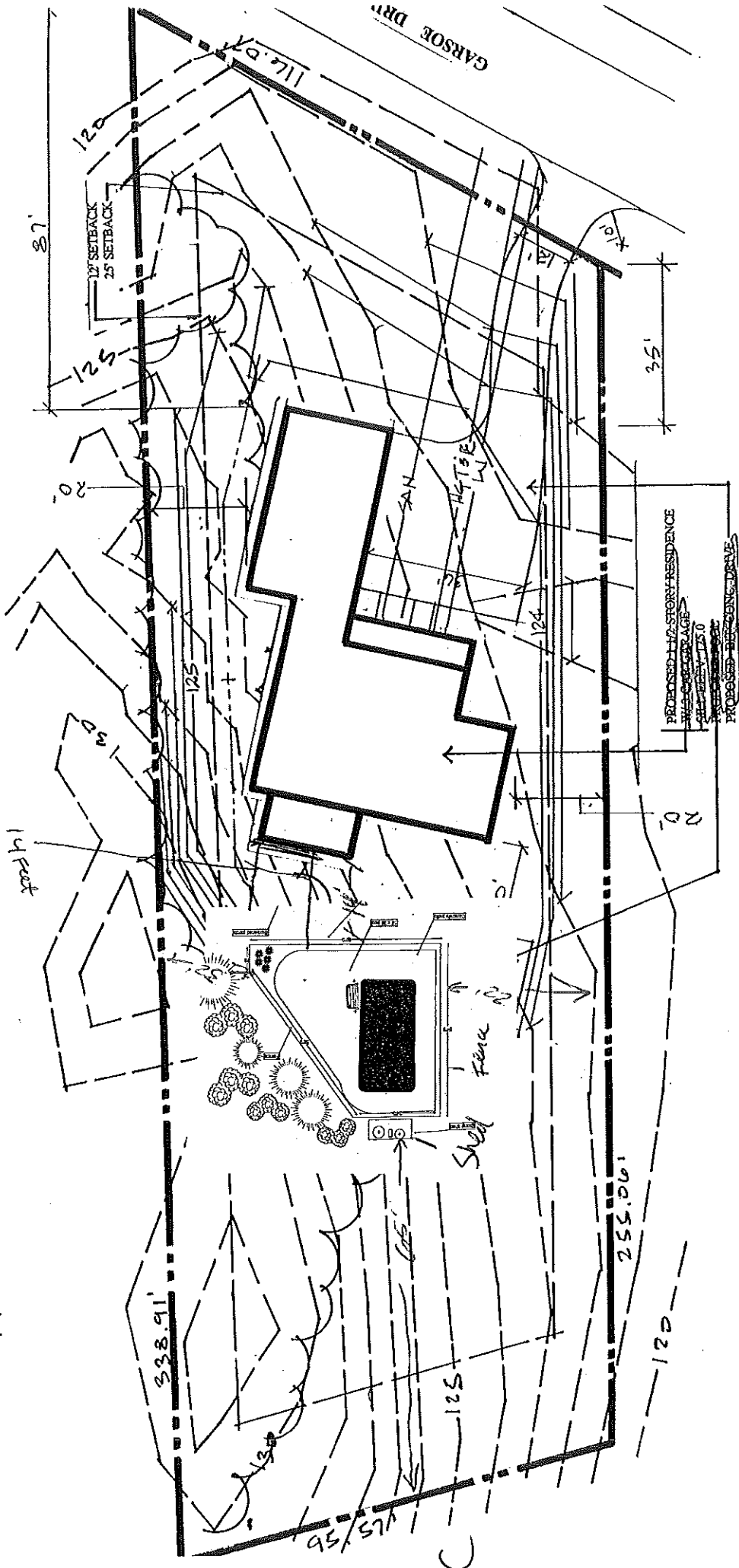

LOT 22 AUBURN
28,454 SF
BUILDING COVERA
PAVEMENT COVER

~~SITE PLAN~~

Porch/House to Fence 14'
Patio 18'
Pool 27'

Neighbor A to
Fence 32'
Patio 36'
Pool 51' Shed 55'

Neighbor B to
Fence 22'
Concrete 24'
Pool 36'

B

Neighbor to Shed 65'
Fence 75'
Patio 77'
Pool 82'

18' X 36' RECTANGLE 2' RADIUS

AREA: 645 SQ. FT. PERIMETER: 105' GALLONS: 27,392

BUILD OF MATERIALS

10-8' Plain Panels	08-009-5	08-009
1-6' Plain Panel	08-014-5	08-014
2-3' Plain Panels	08-017-5	08-017
4-2' Radius Corners	08-141	08-141
17-Braces	08-214	08-214
1-Steel Hardware Kit	08-204	08-204
1-1/8x3/8 Straight Coping Set 6" Radius	10-002	10-002
1-2' Radius Coping Corner Set	10-138	10-138
1-Vinyl Liner		

STERLING FRONTIER

08-009-5	08-009
08-014-5	08-014
08-017-5	08-017
08-141	08-141
08-214	08-214
08-204	08-204
10-002	10-002
10-138	10-138

STEP-OPTIONS

- 6' Step- Remove 1-8' panel and 1-6' panel, insert 1-6' step, 2-4 panels and 1-brace.
- 8' Step- Remove 1-8' panel and 1-6' panel, insert 1-8' step, 2-3 panels and 1-brace.

STEEL PANEL OPTIONS

Replace 4-8' plain panels with:	Optional
1-8' skimmer panel	08-010-5
2-8' inlet panels	08-012-5
1-8' light panel	08-012

STERLING FRONTIER

Optional	08-010-5
08-010	08-010
08-012-5	08-012

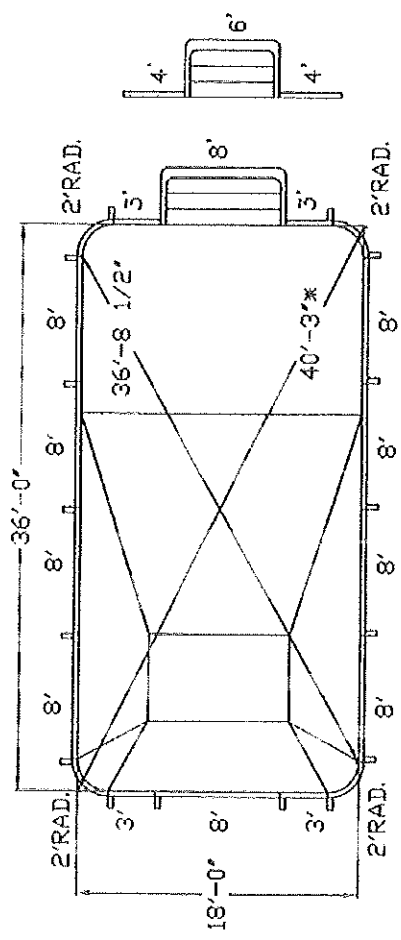
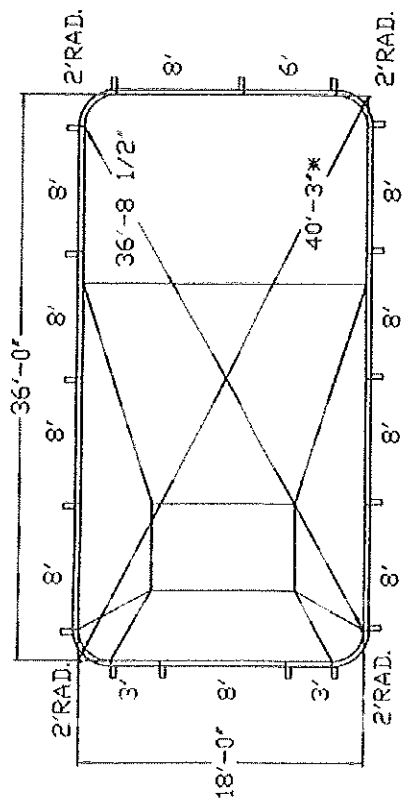

NSPI TYPE II

*Diagonals given to 90° point of corners.

GENERAL NOTES

1. All vertical dimensions are height from exterior of pool.
2. Excavation shall be 2" larger than pool all around.
3. Excavation shall be 2" larger than pool all around.
4. Backfill with non-compressive material.

EXCAVATION NOTES

1. Soil to show minimum bearing capacity of 2000 P.S.F.
2. Backfill pool at least 6" above surrounding ground surface.
3. Backfill with non-compressive material.

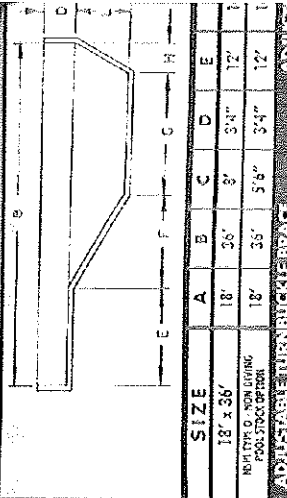

ADJUSTABLE TURNBUCKLE BRACE

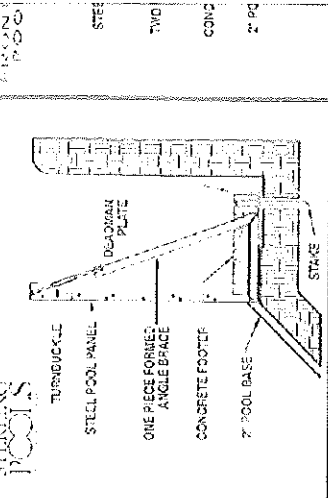

COPING LAYOUT

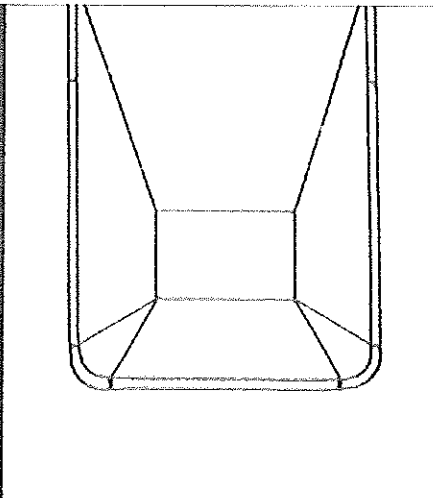

Attention Dealer: It is your responsibility to use the correct coping materials provided by Sterling Pools. Building codes are constantly in flux.

STERLING POOLS
FRONTIER
 BUILDING THE FOLLOWING POOL:
 STERLING
 FRONTIER
 DATE: JANUARY 1989
 TITLE: 18' X 36' RECTANGLE

GLE 2' RADIUS

AREA: 645 SQ. FT. PERIMETER: 105' GALLONS: 27,392

BILL OF MATERIALS

	STERLING FRONTIER
10-8" Plain Panels	08-009-5
1-6" Plain Panel	08-014-5
2-3" Plain Panels	08-017-5
4-2" Radius Corners	08-141
17-Braces	08-214
1-Steel Hardware Kit	08-204
1-18x36 Straight Coping Set 6" Radius	10-002
1-2" Radius Coping Corner Set	10-002
1-Vinyl Liner	10-138

STEP OPTIONS

- 6" Step - Remove 1-8" panel and 1-6" panel. Insert 1-6" step. 2-4" panels and 1-brace.
- 8" Step - Remove 1-8" panel and 1-6" panel. Insert 1-8" step. 2-3" panels and 1-brace.

STEEL PANEL OPTIONS

- Replace 4-8" plain panels with:
 - Optional 1-8" skimmer panel
 - Optional 2-8" inlet panels
 - Optional 1-8" light panel

STERLING FRONTIER

Optional	08-010-5
Optional	08-012-5

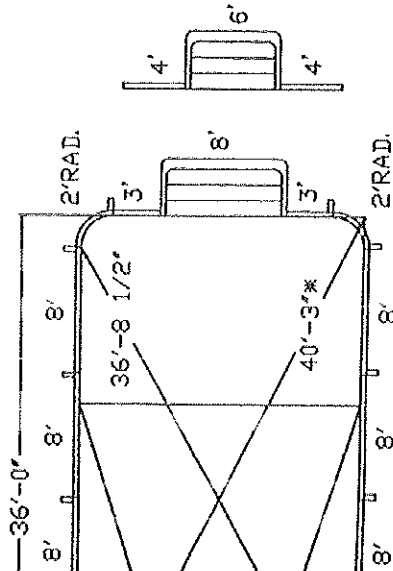
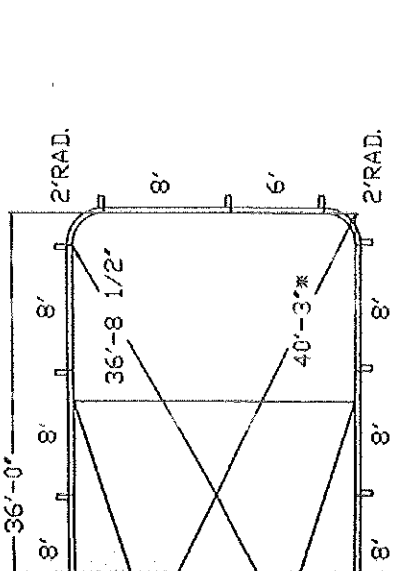

NSPI TYPE II

- NOTES:
- Minimum bearing capacity of 2000 P.S.F.
 - Fill in 3" under base of panels and pump pad.
 - Excavation shall be 2' larger than pool at ground.
 - Stabilize with appropriate material.

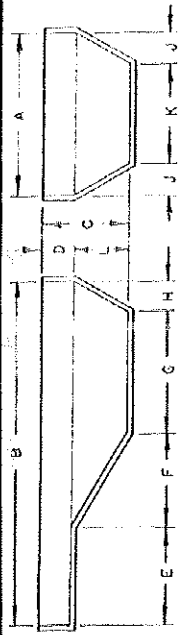

SIZE	A	B	C	D	E	F	G	H	J	K	L
18' x 36'	18'	36'	8'	34"	12'	14'	56"	46"	9'	46"	9'
REFER TO NSPI DRAWING FOR STRAIGHT COPING	18'	36'	56"	34"	12'	14'	56"	46"	9'	46"	9'

ADJUSTABLE TURNBUCKLE BRACE

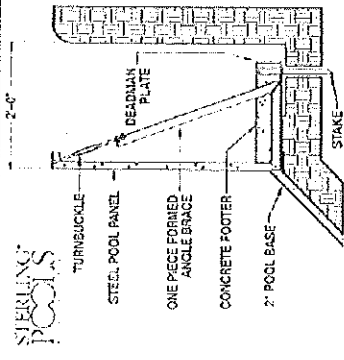

ADJUSTABLE BRACE

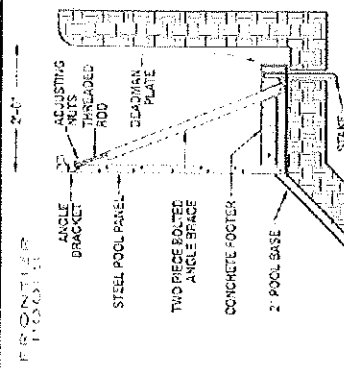

COPING LAYOUT

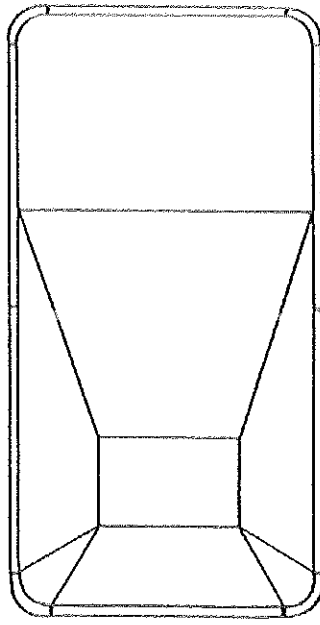

ADDITIONAL NOTES

THIS DOCUMENT IS FOR ILLUSTRATIVE PURPOSES ONLY. It does not constitute a contract. The contractor shall be responsible for obtaining all necessary permits and approvals. The contractor shall be responsible for obtaining all necessary permits and approvals. The contractor shall be responsible for obtaining all necessary permits and approvals.

Attention Dealer: It is your responsibility to see that the safety message provided by RVZ is obtained in pool owner's manual. Warming labels are properly installed.

STERLING POOLS
BUILDING THE FOLLOWING POOL - STERLING FRONTIER

DATE: JANUARY 1999
TITLE: 18' X 36' RECTANGLE 2' RADIUS

DRAWING NUMBER: STL-008

STERLING POOLS, INC.
6930 Gettysburg Pike
FT. WAYNE, IN 46804 USA
(219) 432-8731
www.sterlingpools.com

QTY	DESCRIPTION	QTY	DESCRIPTION
2	36" x 48" Plaster Panel-SA	1	Outside Step Assembly 76" Risers
4	56 9/16" x 48" 36"R Inside Corners-SA	4	56 9/16" x 48" 36"R Inside Corners-SA
4	72 1/4" x 48" 46"R Outside Corners-SA	4	72 1/4" x 48" 46"R Outside Corners-SA
6	36" x 48" Panel-SA	2	4" x 48" Panel-SA
24	72" x 48" Panel-SA	4	20" x 48" Panel-SA
		6	36" x 48" Panel-SA
		20	72" x 48" Panel-SA

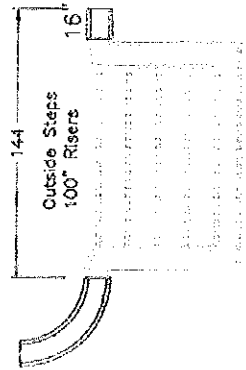
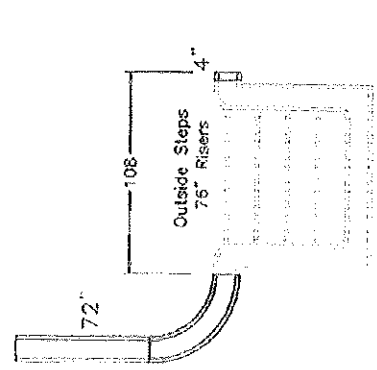
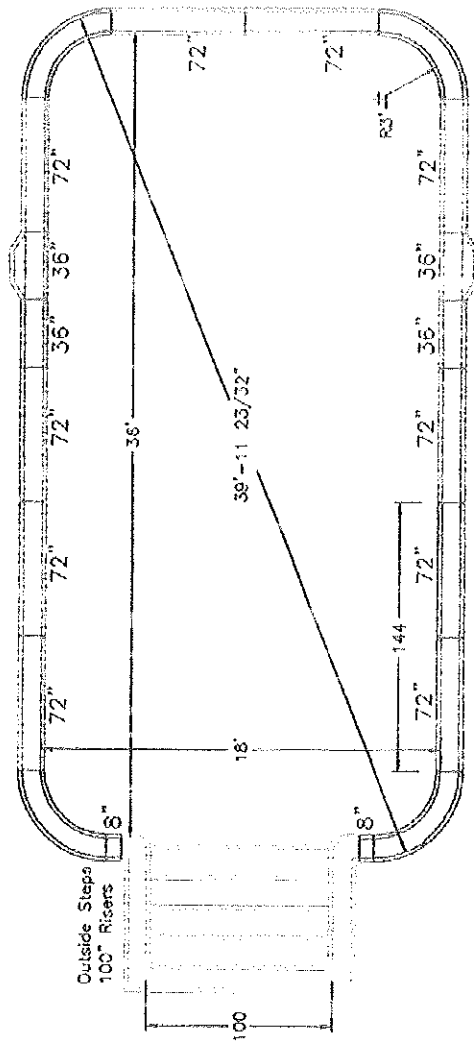
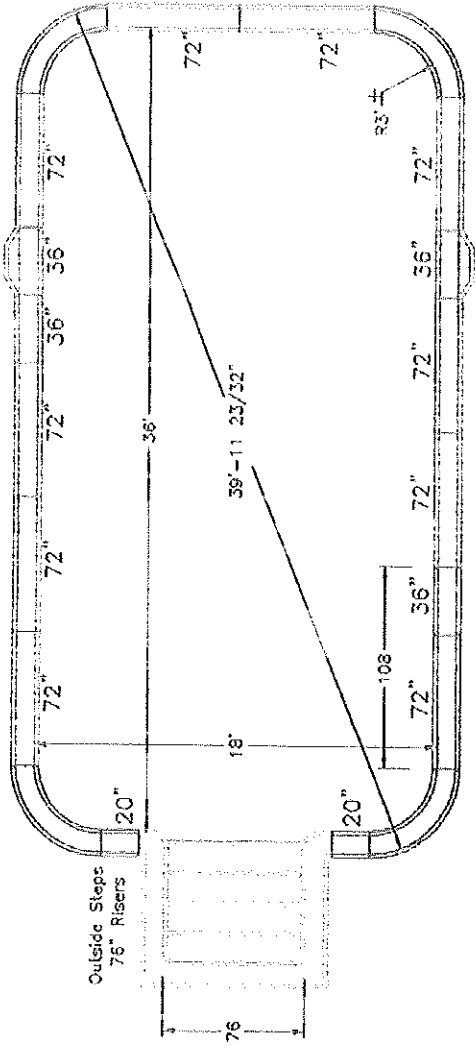

QTY	DESCRIPTION	QTY	DESCRIPTION
1	Outside Step Assembly 76" Risers	1	Outside Step Assembly 100" Risers
2	36" x 48" Plaster Panel-SA	2	36" x 48" Plaster Panel-SA
4	56 9/16" x 48" 36"R Inside Corners-SA	4	56 9/16" x 48" 36"R Inside Corners-SA
4	72 1/4" x 48" 46"R Outside Corners-SA	4	72 1/4" x 48" 46"R Outside Corners-SA
2	4" x 48" Panel-SA	2	4" x 48" Panel-SA
4	20" x 48" Panel-SA	4	20" x 48" Panel-SA
6	36" x 48" Panel-SA	6	36" x 48" Panel-SA
20	72" x 48" Panel-SA	20	72" x 48" Panel-SA

640.3 sq.ft.
 Rectangular Pools
 18' x 36'

with 36" Radius Corners
 Wall-tes & Forms
 Pool Form Layouts

NOTE:
 (1) Similar Colors Substitute in Layout for Different Designs
 (2) The Order of Panels Laid Out is Arbitrary

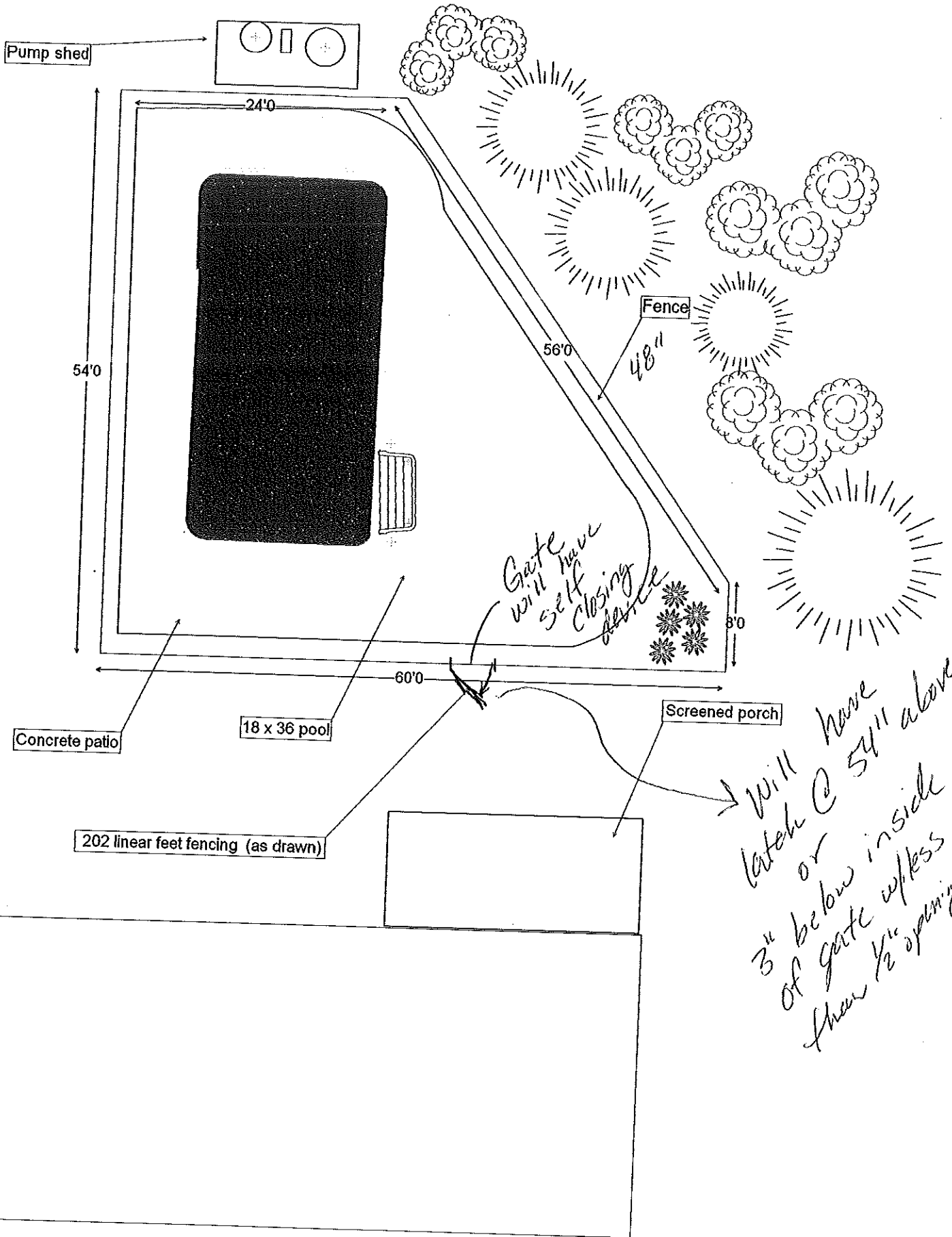

Pump shed

24'0"

54'0"

18 x 36 pool

Concrete patio

60'0"

202 linear feet fencing (as drawn)

Fence

48"

Gate will have self closing device

Screened porch

Will have latch @ 54" above or 3" below inside of gate w/less than 1/2 opening

From: Davis Woodworking

for mr myers 8 x 10 Pine Shed

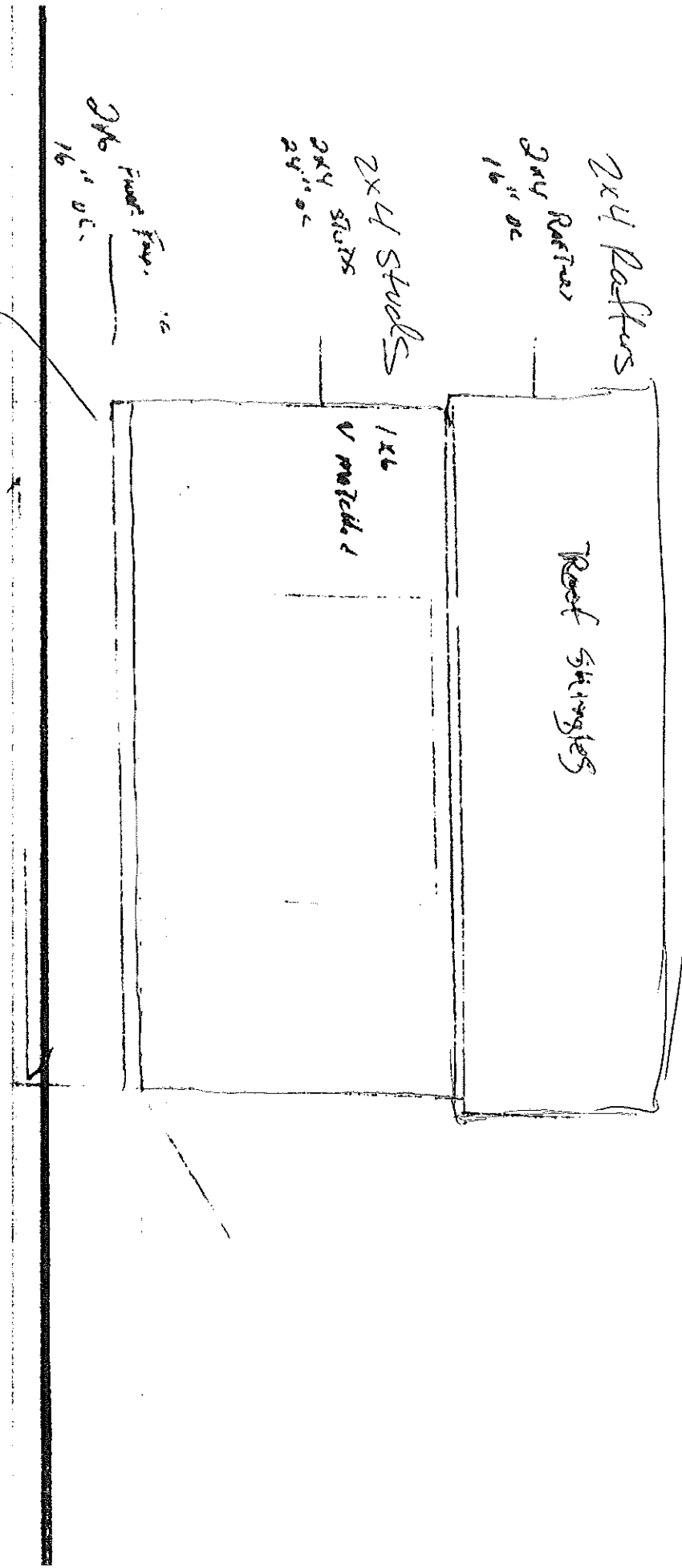

2x6 Floor Joist



LEGEND[®]
by MASTER-HALCO

PREMIUM VINYL FENCE SYSTEMS

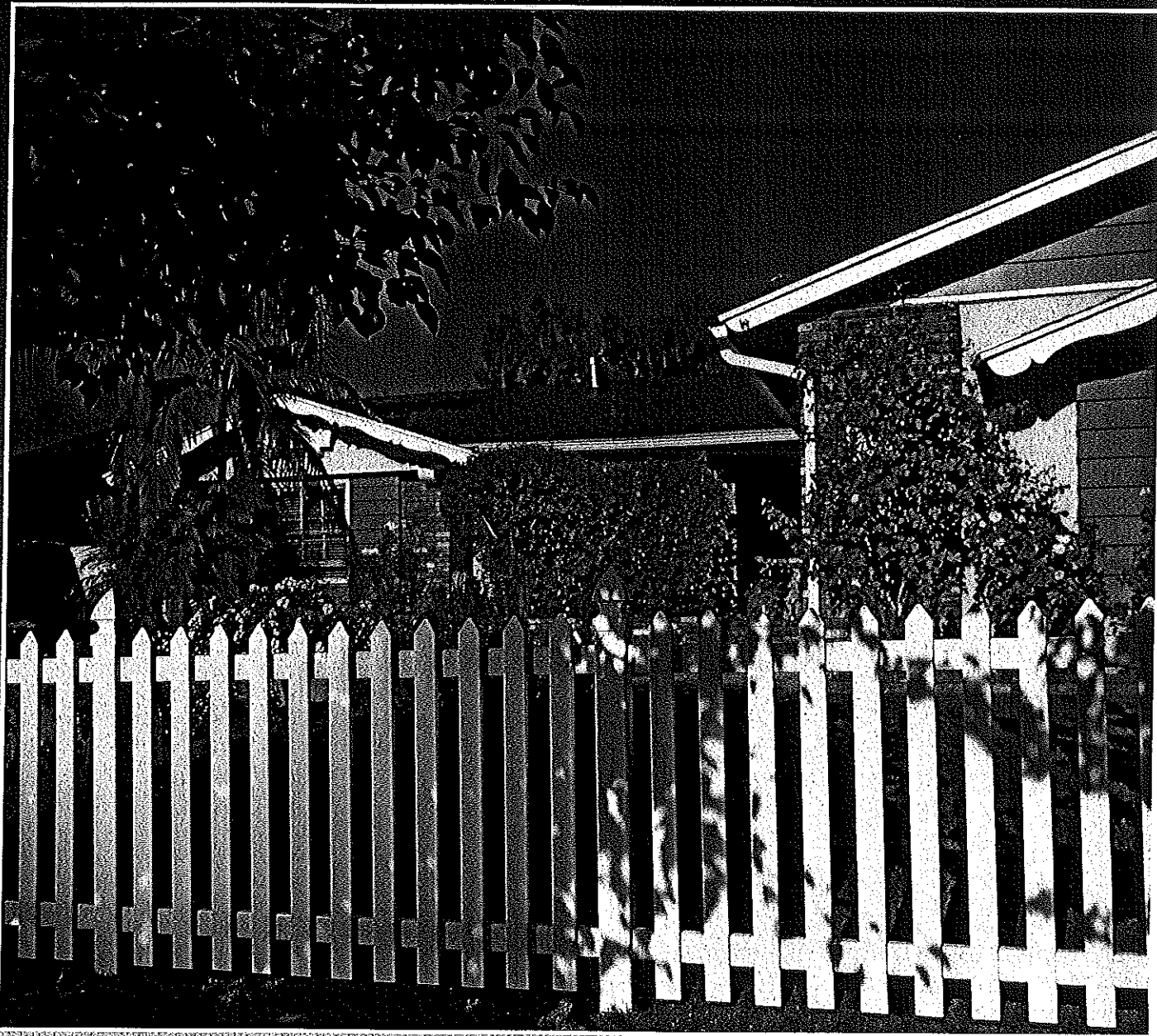

 **MASTER
HALCO**[™]

LEGEND FENCING: FENCE OF THE FUTURE

Master-Halco's Legend® line of premium vinyl fencing is the right combination of tradition and technology. Constructed of high-tech polyvinyl compounds, Legend fencing is virtually maintenance-free. You'll never have to worry about painting, rotting, warping, termites, corrosion or rust. Master-Halco guarantees it – every Legend fence is backed by a lifetime limited warranty.* Built to last, Legend fencing will retain its beautiful appearance, enhancing the value of your property for years to come. If you're thinking about buying and installing a vinyl fence, you've made a wise decision. However, as with any investment, you have to do your homework. Vinyl fencing comes in many ranges of quality and size, and it's important to understand the variety of vinyl products available. By taking a look at our brochure, you'll learn how to get the most value for your money and the right fence for your needs.



Clockwise from left:
Universal, Universal III,
Universal II

How popular are vinyl building materials?

Polyvinyl chloride (PVC) "vinyl" is the only plastic that can be used for various applications and it's virtually in every industry. Because of its low maintenance and durability, vinyl is a popular alternative for products normally constructed of wood – fences, gazebos, decks, siding and window frames.

How is vinyl fencing manufactured?

The best products are made from virgin vinyl which ensures that the product is made using contents most appropriate for its application. Recycled vinyl can contain "contaminates" that may not be appropriate for the application or may compromise the integrity of the product. For vinyl to have the characteristics necessary for fencing, it must be combined with special additives and modifiers to make it strong and durable. The formula contains UV inhibitors that guard against the sun's harsh rays and additives that make the vinyl rigid, yet flexible enough to resist cracking. The two most common methods for manufacturing vinyl fencing are a mono-extrusion process that uses one vinyl compound and a co-extrusion process that uses two or more vinyl compounds. With the co-extrusion process, a manufacturer can engineer a product with greater strength and durability.

How safe are vinyl fence systems?

Unlike some treated wood fencing, vinyl is an environmentally safe material with no toxins to pollute the sky or seep into the ground. Vinyl fencing has a smooth surface, no nails, sharp edges or splinters.

Aren't all vinyl fences the same?

No. Vinyl fence system components are available in a wide range of sizes and thickness. To reduce costs, some manufacturers decrease their wall thickness resulting in reduced strength.

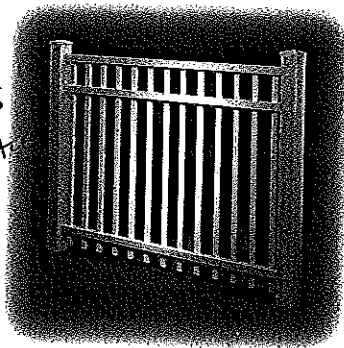

Traditional

3/2 inches
betw vert
slats

48" high

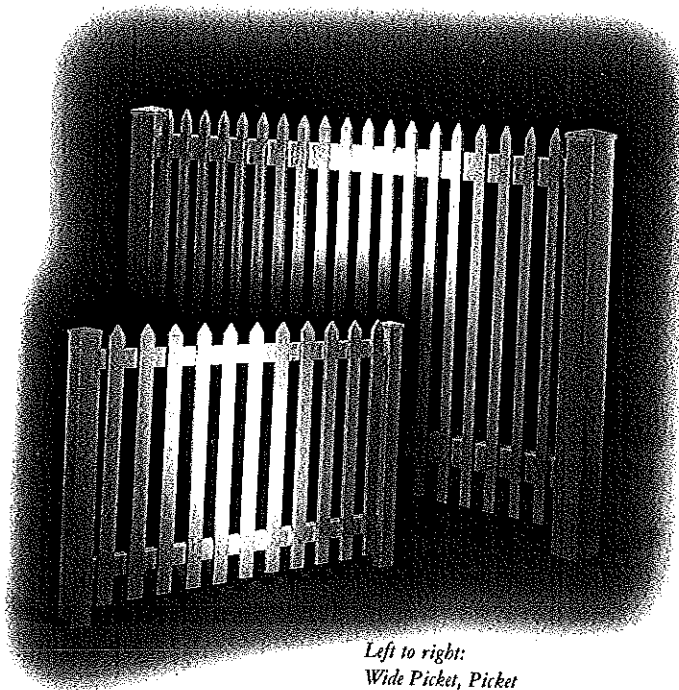

Left to right:
Wide Picket, Picket

* See actual warranty for details.

ELECTRICAL PERMIT

City of Portland, Me.



To the Chief Electrical Inspector, Portland Maine:
 The undersigned hereby applies for a permit to make electrical installations
 in accordance with the laws of Maine, the City of Portland Electrical Ordinance,
 National Electrical Code and the following specifications:

Date 8/8/03
 Permit # 20034719
 CBL# 386AB022

LOCATION: 78 GARSOE METER MAKE & # _____
 CMP ACCOUNT # _____ OWNER STEVE MEYERS
 TENANT _____ PHONE # _____

					TOTAL EACH FEE	
OUTLETS	Receptacles	Switches	Smoke Detector			.20
FIXTURES	Incandescent	Fluorescent	Strips			.20
SERVICES	Overhead	Underground	TTL AMPS	<800		15.00
	Overhead	Underground		>800		25.00
Temporary Service	Overhead	Underground	TTL AMPS			25.00
						25.00
METERS	(number of)					1.00
MOTORS	(number of)					2.00
RESID/COM	Electric units					1.00
HEATING	oil/gas units	Interior	Exterior			5.00
APPLIANCES	Ranges	Cook Tops	Wall Ovens			2.00
	Insta-Hot	Water heaters	Fans			2.00
	Dryers	Disposals	Dishwasher			2.00
	Compactors	Spa	Washing Machine			2.00
	Others (denote)					2.00
	MISC. (number of)	Air Cond/win				3.00
		Air Cond/cent				10.00
		HVAC	EMS	Thermostat		5.00
		Signs				10.00
		Alarms/res				5.00
	Alarms/com				15.00	
	Heavy Duty(CRKT)				2.00	
	Circus/Carnv				25.00	
	Alterations				5.00	
	Fire Repairs				15.00	
	E Lights				1.00	
	E Generators				20.00	
PANELS	Service	Remote	Main			4.00
TRANSFORMER	0-25 Kva					5.00
	25-200 Kva					8.00
	Over 200 Kva					10.00
TOTAL AMOUNT DUE						
MINIMUM FEE/COMMERCIAL 45.00					MINIMUM FEE	35.00

35.00

CONTRACTORS NAME FRANK LEMELIN MASTER LIC. # M540088523
 ADDRESS 186 SUMNER ST LIMITED LIC. # _____
 TELEPHONE 786-7279

SIGNATURE OF CONTRACTOR _____