

City of Portland, Maine - Building or Use Permit Application
 389 Congress Street, 04101 Tel: (207) 874-8703, Fax: (207) 874-8716

Permit No: 05-0738 Issue Date: JUN 13 2005 CBL: 385A D012001

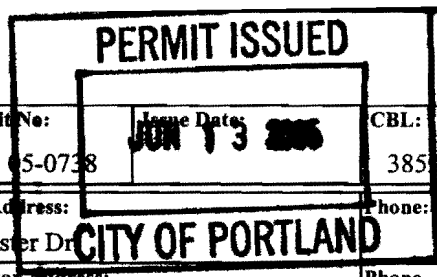

Location of Construction: 168 Lester Dr		Owner Name: Norbert Mary J & Stanley J Jts		Owner Address: 168 Lester Dr		Phone:	
Business Name:		Contractor Name: Delp Chimney Service		Contractor Address: 58 Ashland Dr Chelsea		Phone:	
Lessee/Buyer's Name		Phone:		Permit Type: HVAC		Zone: R2	
Past Use: Single Family		Proposed Use: Single Family w/direct vent gas fireplace and LP tank		Permit Fee: \$48.00		Cost of Work: \$3,000.00	
				CEO District: 5		INSPECTION: Use Group: R3 Type: HVAC	
Proposed Project Description: Install a direct vent gas fireplace and LP tank				FIRE DEPT: <input type="checkbox"/> Approved <input type="checkbox"/> Denied		Signature: JMB 6/13/05	
				PEDESTRIAN ACTIVITIES DISTRICT (P.A.D.)			
				Action: <input type="checkbox"/> Approved <input type="checkbox"/> Approved w/Conditions <input type="checkbox"/> Denied			
				Signature: _____ Date: _____			

Permit Taken By: jmb		Date Applied For: 06/13/2005		Zoning Approval					
1. This permit application does not preclude the Applicant(s) from meeting applicable State and Federal Rules. 2. Building permits do not include plumbing, septic or electrical work. 3. Building permits are void if work is not started within six (6) months of the date of issuance. False information may invalidate a building permit and stop all work..				Special Zone or Reviews <input type="checkbox"/> Shoreland <input type="checkbox"/> Wetland <input type="checkbox"/> Flood Zone <input type="checkbox"/> Subdivision <input type="checkbox"/> Site Plan Maj <input type="checkbox"/> Minor <input type="checkbox"/> MM <input type="checkbox"/> Date: JMB 06/13/05		Zoning Appeal <input type="checkbox"/> Variance <input type="checkbox"/> Miscellaneous <input type="checkbox"/> Conditional Use <input type="checkbox"/> Interpretation <input checked="" type="checkbox"/> Approved <input type="checkbox"/> Denied Date: _____		Historic Preservation <input type="checkbox"/> Not in District or Landmark <input type="checkbox"/> Does Not Require Review <input type="checkbox"/> Requires Review <input type="checkbox"/> Approved <input type="checkbox"/> Approved w/Conditions <input type="checkbox"/> Denied Date: JMB	

CERTIFICATION

I hereby certify that I am the owner of record of the named property, or that the proposed work is authorized by the owner of record and that I have been authorized by the owner to make this application as his authorized agent and I agree to conform to all applicable laws of this jurisdiction. In addition, if a permit for work described in the application is issued, I certify that the code official's authorized representative shall have the authority to enter all areas covered by such permit at any reasonable hour to enforce the provision of the code(s) applicable to such permit.

SIGNATURE OF APPLICANT ADDRESS DATE PHONE

RESPONSIBLE PERSON IN CHARGE OF WORK, TITLE DATE PHONE



FILL IN AND SIGN WITH INK

APPLICATION FOR PERMIT HEATING OR POWER EQUIPMENT

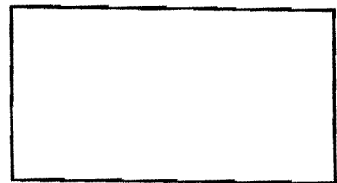

To the INSPECTOR OF BUILDINGS, PORTLAND, ME.

The undersigned hereby applies for a permit to install the following heating, cooking or power equipment in accordance with the Laws of Maine, the Building Code of the City of Portland, and the following specifications:

Location / CBL 385-A-D-012 Use of Building SF Home Date 6/13/05
 Name and address of owner of appliance MARY J. NORBERT
168 Lester Drive, Portland, ME. 04103
 Installer's name and address Dely chimney service 58 Ashland Drive Chelsea ME
 Telephone 04030

Location of appliance:

- Basement
- Floor
- Attic
- Roof

Type of Fuel:

- Gas
- Oil
- Solid

Appliance Name: Agency

U.L. Approved Yes No

Will appliance be installed in accordance with the manufacture's installation instructions? Yes No

IF NO Explain: _____

The Type of License of Installer:

- Master Plumber # _____
- Solid Fuel # _____
- Oil # _____
- Gas # PNT 3100 exp 02/07
- Other _____

Type of Chimney:

- Masonry Lined
Factory built _____
- Metal
Factory Built U.L. Listing # _____
- Direct Vent
Type FlexLine UL# _____

Type of Fuel Tank

- Oil
- Gas

Size of Tank _____

Number of Tanks one LP

Distance from Tank to Center of Flame _____ feet.

Cost of Work: \$ 3,000.

Permit Fee: \$ 48.00

Approved

Fire: _____
 Ele.: _____
 Bldg.: JMB

Approved with Conditions

- See attached letter or requirement

Inspector's Signature _____

Date Approved _____

Signature of Installer _____

White - Inspection Yellow - File Pink - Applicant's Gold - Assessor's Copy

Fireplace Measuring Form

Customer: _____

Phone: _____

Room: _____

Salesperson: _____

Please put exact measurements in spaces provided.
We make allowances for overlap and clearance.

Fireplace Facing:

- A. Material - Brick
 Marble
 Stone
 _____ (Other)

B. Protrusion-Does any portion of your fireplace extend out into the room that will prevent your glass door from fitting snugly against the fireplace face? If yes, please explain in "comments" section below or on the reverse side.

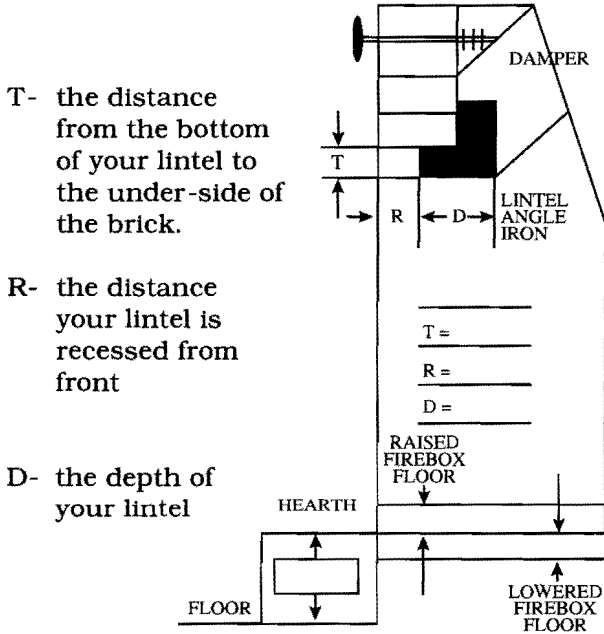

Additional Comments: _____

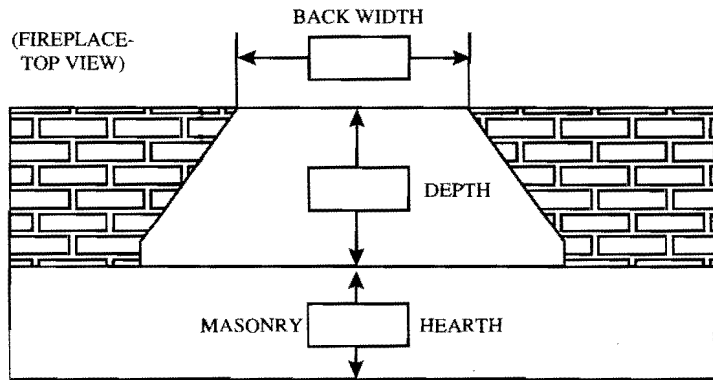
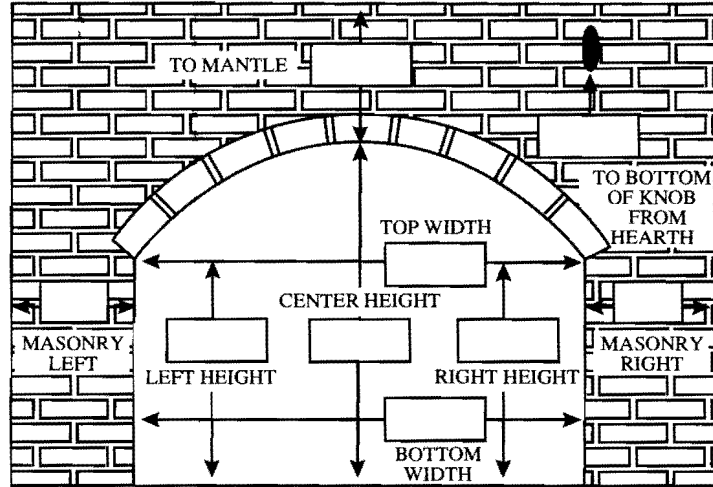
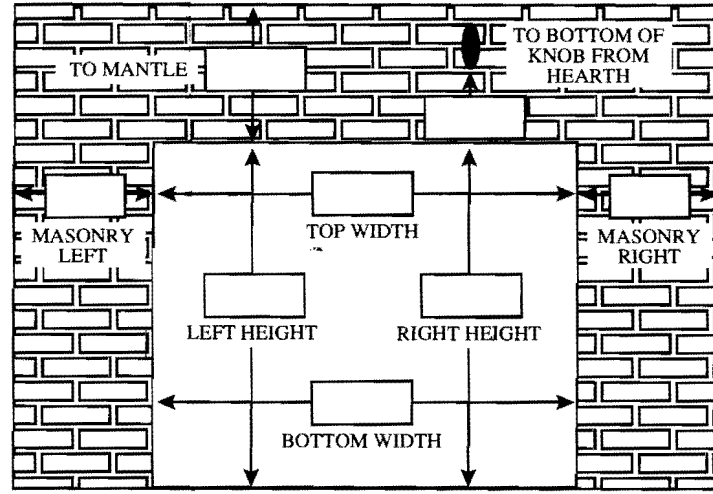

This page contains a detailed description of the Parcel ID you selected. Press the **New Search** button at the bottom of the screen to submit a new query.

Current Owner Information

Card Number 1 of 1
 Parcel ID 385A D012001
 Location 168 LESTER DR
 Land Use SINGLE FAMILY

Owner Address NORBERT MARY J & STANLEY J JTS
 168 LESTER DR
 PORTLAND ME 04103

Book/Page 10229/54
 Legal 385A-D-12
 LESTER DR 164-170
 10720 SF

*6/13 9 AM
 John*

#138 R2

Current Valuation Information

Land #34,650 Building #85,160 Total #119,810

New Estimated Valuation Information

Land #72,100 Building #129,900 Total #202,000 Phase-In Value #160,905

Property Information

Year Built 1986	Style Cape	Story Height 1.5	Sq. Ft. 2330	Total Acres 0.246	
Bedrooms 3	Full Baths 2	Half Baths	Total Rooms 6	Attic None	Basement Full

Outbuildings

Type	Quantity	Year Built	Size	Grade	Condition
------	----------	------------	------	-------	-----------

Sales Information

Date 08/14/1992	Type LAND + BLDING	Price #107,000	Book/Page 10229-054
--------------------	-----------------------	-------------------	------------------------

Picture and Sketch

[Picture](#) [Sketch](#) [Tax Map](#)

[Click here](#) to view Tax Roll Information.

Any information concerning tax payments should be directed to the Treasury office at 874-8490 or [e-mailed](#).

[Click here](#) to view comparable sales or below to view by:



CITY OF PORTLAND, MAINE
Department of Building Inspections

June 13 20 05

Received from Mary Norbert

Location of Work 168 Lester Dr.

Cost of Construction \$ 3,000.

Permit Fee \$ 48.00

Building (11) Plumbing (15) ___ Electrical (12) ___ Site Plan (12) ___

Other HVAC + Tank

CBL: _____

Check #: 2025 Total Collected \$ 48.00

THIS IS NOT A PERMIT

No work is to be started until PERMIT CARD is actually posted upon the premises. Acceptance of fee is no guarantee that permit will be granted. PRESERVE THIS RECEIPT. In case permit cannot be granted the amount of the fee will be refunded upon return of the receipt less \$10.00 or 10% whichever is greater.

WHITE - Applicant's Copy
YELLOW - Office Copy
PINK - Permit Copy

168 Lash Lane

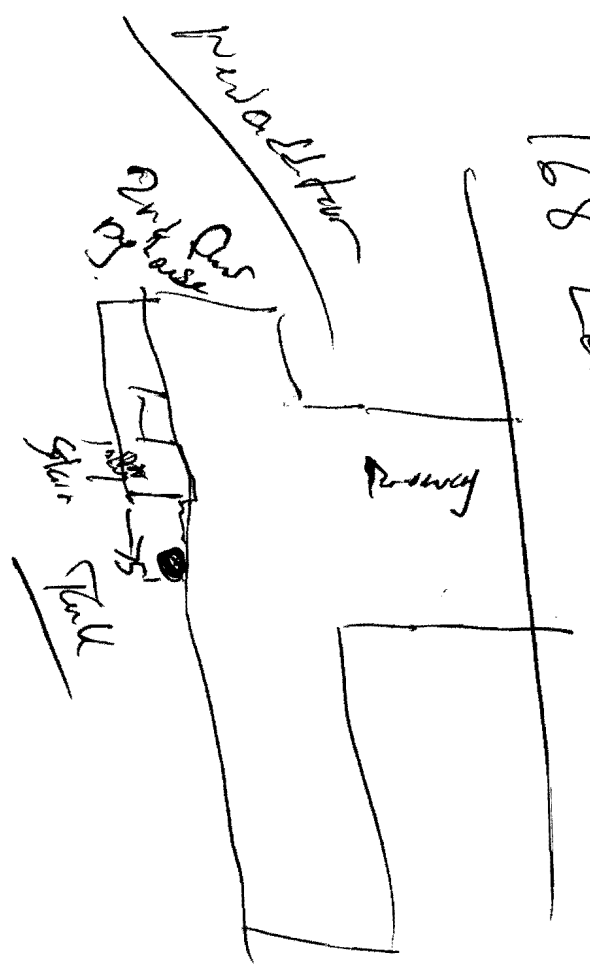

Rear