

ALL DRAWINGS, PLANS, SKETCHES ETC. ARE PROVIDED TO OUR CLIENTS BASED UPON INFORMATION PROVIDED BY THE CLIENT AND DRAWN IN ACCORDANCE WITH COMMON BUILDING PRACTICES. NONE OF THE EMPLOYEES OF MORIN DRAFTING ARE REGISTERED ARCHITECTS, STRUCTURAL ENGINEERS OR PROFESSIONAL LAND SURVEYORS. ALL CODES SHALL BE REVIEWED AND APPROVED BY APPROPRIATE REGISTERED PROFESSIONAL. IF NOT, IT SHALL BE THE RESPONSIBILITY OF THE CONTRACTOR OR OWNER. ALL NOTING, SPECIFICATIONS AND DIMENSIONS SHALL BE VERIFIED BY CLIENT AND/OR CONTRACTOR BEFORE WORK BEGINS. ALL DIMENSIONS SHALL BE BROUGHT TO THE ATTENTION OF MORIN DRAFTING AFTER REVIEW. IF PLANS ARE NOT VERIFIED BY CLIENT AND/OR CONTRACTOR BEFORE CONSTRUCTION BEGINS, MORIN DRAFTING SHALL BE HELD HARMLESS. IN ALL EVENTS DAMAGES SHALL BE LIMITED TO THE COST OF THE PLANS. MORIN DRAFTING ASSUMES NO LIABILITY FOR CONSTRUCTION DEFECTS, CHANGES AND/OR REVISIONS TO THE PLANS. ALL PLANS ARE THE PROPERTY OF MORIN DRAFTING.

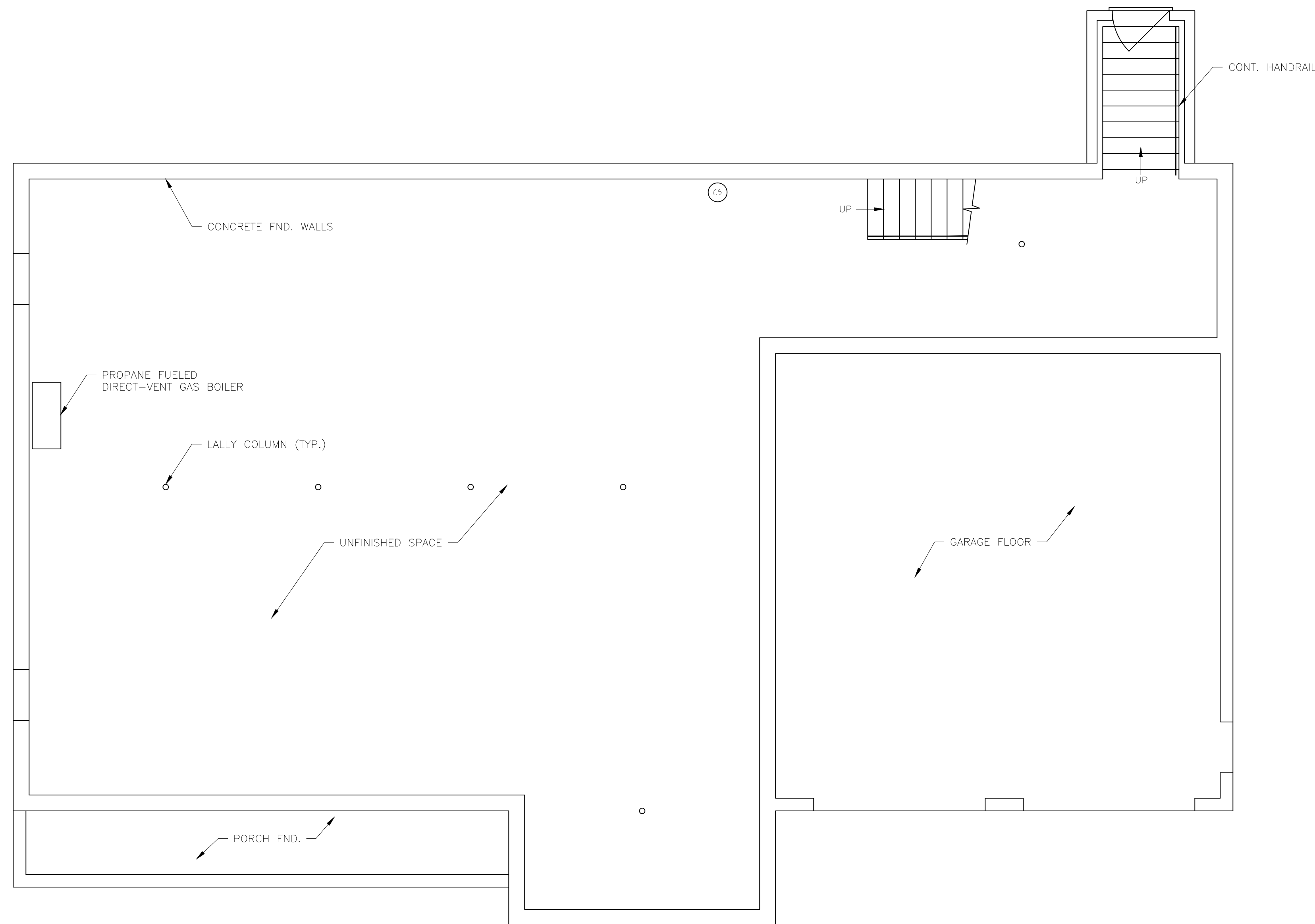

BASEMENT PLAN
SCALE: 1/4"=1'-0"

LEGEND		
SYMBOL	DESCRIPTION	REMARKS
⊙	CO/SMOKE DETECTOR	

THESE PLANS HAVE BEEN LICENSED TO THE CUSTOMER FOR USE IN CONSTRUCTION OF ONE BUILDING ONLY AND ARE SUBJECT TO THE CONDITIONS OF LICENSE ACCEPTED BY THE CUSTOMER. USE OF ANY PART OF THE PLANS BY ANY PARTY OTHER THAN THE CUSTOMER, EXCEPT ON LOAN BY THE CUSTOMER TO THIRD PARTIES NECESSARY TO ASSIST THE CUSTOMER IN USING THE PLANS, SUCH AS CONTRACTORS AND SUBCONTRACTORS, IS STRICTLY PROHIBITED. THE PLANS MAY NOT BE RE-USED OR COPIED IN WHOLE OR IN PART, WITHOUT WRITTEN PERMISSION FROM MORIN DRAFTING WHICH RETAINS COPYRIGHTS TO AND OWNERSHIP OF THE PLANS.

ISSUED FOR CONSTRUCTION
03-30-2016

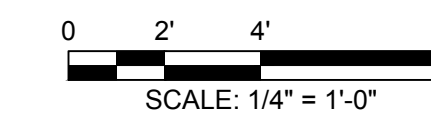

White Homes, Inc. 878-3361	
MORIN DRAFTING 318-1177	
DORLER RESIDENCE MORNINGSTAR LANE, PORTLAND, ME. (LOT NO. 3)	
BASEMENT FLOOR PLAN	
DRAWN: J. MORIN	A4
SCALE: 1/4"=1'-0"	
DATE: 05-22-2016	
PLAN NO:	