

for construction only at:
Lot 1 Morning Star Avenue, Portland, ME
 by or for Patco Construction, Inc.

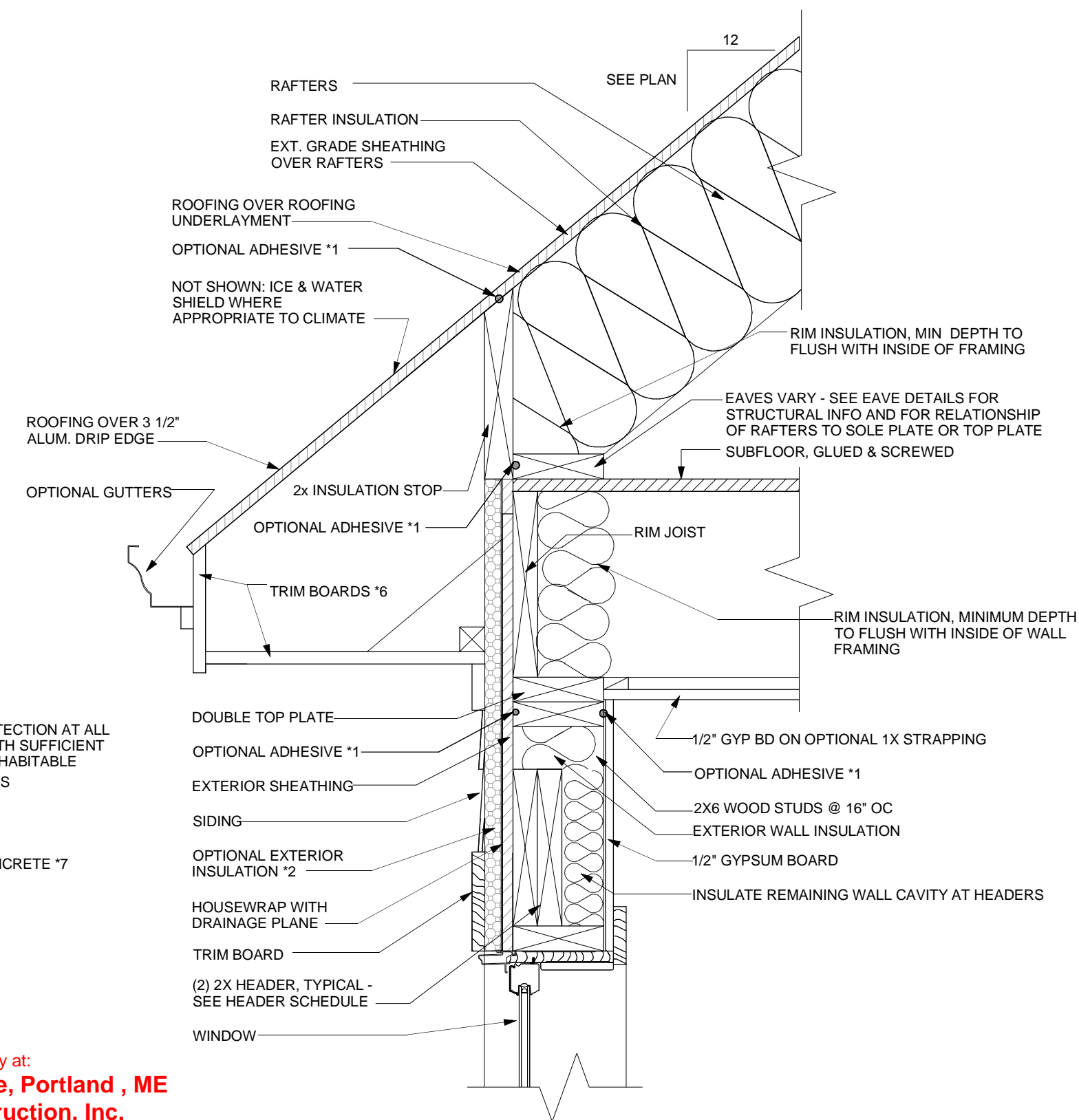

NOTES:

RESPONSIBILITY FOR THERMAL AND MOISTURE DESIGN LIES WITH THE BUILDER AND/OR HOMEOWNER. IF THESE DETAILS, IN COMBINATION WITH BUILDER-PROVIDED SPECIFICATIONS AND MANUFACTURER'S CUT SHEETS ARE INSUFFICIENT FOR PERMITTING, CONTACT ARTFORM HOME PLANS @ 603-431-9559 TO HAVE DETAILS ADJUSTED PER YOUR MARK-UP.

NOTE THAT SPRAY FOAM INSULATION PERFORMS THE SAME FUNCTION AS THE OPTIONAL SEALANTS SHOWN HERE.

*1 OPTIONAL SEALANTS AND ADHESIVES ARE RECOMMENDED FOR ADVANCED ENERGY PERFORMANCE.

*2 OPTIONAL EXTERIOR INSULATION IS RECOMMENDED FOR ADVANCED ENERGY PERFORMANCE.

*3 PROVIDE VAPOR BARRIER APPROPRIATE TO CLIMATE AND TO SELECTED INSULATION. LOCATE VAPOR BARRIER WITHIN WALL ASSEMBLY AS IS APPROPRIATE TO CLIMATE. BUILDER TO PROVIDE SPECIFIC MATERIAL CHOICES ON SEPARATE SPECIFICATIONS SHEET.

*4 OPTIONAL FOUNDATION INSULATION IS RECOMMENDED FOR ADVANCED ENERGY PERFORMANCE. IF EXTERIOR INSULATION IS SELECTED PROVIDE PROTECTION FROM WEATHER DAMAGE, INSECTS, ETC AS IS APPROPRIATE TO CLIMATE AND BUILDING SITE. IF INTERIOR FOUNDATION INSULATION IS CHOSEN, PROVIDE FIRE PROTECTION WHERE APPROPRIATE.

*5 OPTIONAL UNDERSLAB INSULATION IS RECOMMENDED FOR ADVANCED ENERGY PERFORMANCE. COORDINATE HEIGHTS WITH MECHANICAL FOUNDATION AND FRAMING TO ENSURE CODE CLEARANCE WHERE BASEMENT SPACE IS HABITABLE.

*6 FINISHING OF EAVES MAY VARY - SEE PROJECT DETAILS.

*7 DOUBLE SILL PLATE IS OPTIONAL IF BASMENT IS NOT HABITABLE. DOUBLE SILL IS INTEGRAL PART OF DESIGN WHERE BASEMENT IS HABITABLE, PARTICULARLY IF UNDER SLAB INSULATION IS INSTALLED. DESIGN ASSUMES 8 FOOT FORMS ACHIEVING 7'-10\"/>

Thermal and Moisture ONLY

1 1/2" = 1'-0"

Your use of these drawings constitutes an acceptance of responsibility as outlined in "Dear Code Officer" on the first page of these drawings, and on our web site: <http://www.artformhomeplans.com/TermsConditions.a5w>

If you have any concerns or questions, please feel free to contact us. We are happy to clarify matters that fall within our scope, as listed on the first page. We can also often provide affordable support for issues that are your responsibility, such as energy design/calcs, or additional detailing.

<p>Artform Home Plans AFHP Design # 190.124 KR © 2006-2014 Wendy L. Welton 603.431.9559</p>	<p>April Calla, Classic Lot 1 Morning Star Avenue Portland, ME</p>	<p>TM 1</p>

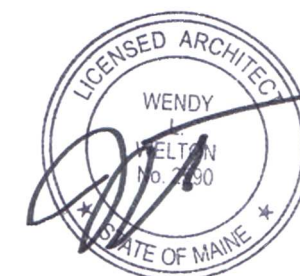

R2: 9.15.14 - Reverse