

City of Portland, Maine - Building or Use Permit Application

389 Congress Street, 04101 Tel: (207) 874-8703, Fax: (207) 874-8716

Permit No: 05-1635	Issue Date: NOV 14 2005	CDL 385 A007001
Owner Address: PMB 1152 PO BOX 9739		Phone:
Contractor Address: 1042 Chadborne Rd. Standish		2078923636
Permit Type: Sheds		Zone: R3

Location of Construction: 201 LAMBERT ST	Owner Name: PETERS PALMER F & RACHEL
Business Name:	Contractor Name: Shed Happens
Lessee/Buyer's Name	Phone:

Past Use: Single Family Home	Proposed Use: Single Family Home/ install an 8' x 12' Shed
---------------------------------	---

Permit Fee: FIRE DEPT: \$39.00	Cost of Work: <input type="checkbox"/> Approved \$1,975.00 <input type="checkbox"/> Denied <input type="checkbox"/> Approved <input type="checkbox"/> Denied	CEC District: INSPECTION: Use Group: R3 INSPECTION: Use Group: R3	Type: 66
-----------------------------------	--	---	----------

Proposed Project Description:

Signature: *JMB 11/9/05*

Action: Approved Approved w/Conditions Denied

Signature: _____ Date: _____

Permit Taken By:
Idobson

Date Applied For:
11/08/2005

Zoning Approval

- This permit application does not preclude the Applicant(s) from meeting applicable State and Federal Rules.
- Building permits do not include plumbing, septic or electrical work.
- Building permits are void if work is not started within six (6) months of the date of issuance. False information may invalidate a building permit and stop all work..

Special Zone or Reviews

Shoreland
 Wetland
 Flood Zone
 Subdivision
 Site Plan

Maj Minor MM

Date: *JMB 11/9/05*

Zoning Appeal

Variance
 Miscellaneous
 Conditional Use
 Interpretation
 Approved
 Denied

Date: _____

Historic Preservation

Not in District or Landmark
 Does Not Require Review
 Requires Review
 Approved
 Approved w/Conditions
 Denied

Date: *JMB*

CERTIFICATION

I hereby certify that I am the owner of record of the named property, or that the proposed work is authorized by the owner of record and that I have been authorized by the owner to make this application as his authorized agent and I agree to conform to all applicable laws of this jurisdiction. In addition, if a permit for work described in the application is issued, I certify that the code official's authorized representative shall have the authority to enter all areas covered by such permit at any reasonable hour to enforce the provision of the code(s) applicable to such permit.

SIGNATURE OF APPLICANT	ADDRESS	DATE	PHONE
RESPONSIBLE PERSON IN CHARGE OF WORK, TITLE		DATE	PHONE

City of Portland, Maine - Building or Use Permit

389 Congress Street, 04101 Tel: (207) 874-8703, Fax: (207) 874-8716

Permit No: 05-1635	Date Applied For: 11/08/2005	CBL: 385 A007001
------------------------------	--	----------------------------

Location of Construction: 201 LAMBERT ST	Owner Name: PETERS PALMER F & RACHEL L	Owner Address: PMB 1152 PO BOX 9739	Phone:
Business Name:	Contractor Name: Shed Happens	Contractor Address: 1042 Chadborne Rd. Standish	Phone (207) 892-3636
Lessee/Buyer's Name	Phone:	Permit Type: Sheds	

Single Family Home/ install an 8' x 12' Shed

install an 8' x 12' Shed

Dept: Zoning **Status:** Approved **Reviewer:** Jeanine Bourke **Approval Date:** 11/09/2005
Note: **Ok to Issue:**

Dept: Building **Status:** Not Applicable **Reviewer:** Jeanine Bourke **Approval Date:** 11/09/2005
Note: **Ok to Issue:**

1) This structure is exempt from meeting the City of Portland Building Code based on size.



General Building Permit Application

If you or the property owner owes real estate or personal property taxes or user charges on any property within the City, payment arrangements must be made before permits of any kind are accepted.

Location/Address of Construction: <u>201 Lambert St.</u>		
Total Square Footage of Proposed Structure <u>8x12' wooden shed</u>	Square Footage of Lot <u>100 wide by 200' deep (20,000 sq ft)</u>	
Tax Assessor's Chart, Block & Lot Chart# <u>385</u> Block# <u>A</u> Lot# <u>7</u>	Owner: <u>Palmer Peters</u>	Telephone: <u>775-7911 x240</u> <u>878-4962 Home</u>
Lessee/Buyer's Name (If Applicable)	Applicant name, address & telephone: <u>Palmer F. Peters</u> <u>201 Lambert St</u> <u>Portland, ME 04103</u>	Cost Of Work: \$ _____ Fee: \$ _____ C of O Fee: \$ <u>39⁰⁰</u>
Current Specific use: _____ Proposed Specific use: _____		
Project description: <u>Free standing wooden shed 8x12 shed -</u>		
Contractor's name, address & telephone:		
Who should we contact when the permit is ready: <u>Palmer Peters</u>		
Mailing address: _____ Phone: <u>775-7911 Social Services</u> <u>Please Leave message</u>		

Please submit all of the information outlined in the Commercial Application Checklist. Failure to do so will result in the automatic denial of your permit.

In order to be sure the City fully understands the full scope of the project, the Planning and Development Department may request additional information prior to the issuance of a permit. For further information visit us on-line at www.portlandmaine.gov, stop by the Building Inspections office, room 315 City Hall or call 874-8703.

I hereby certify that I am the Owner of record of the named property, or that the owner of record authorizes the proposed work and that I have been authorized by the owner to make this application as his/her authorized agent. I agree to conform to all applicable laws of this jurisdiction. In addition, if a permit for work described in this application is issued, I certify that the Code Official's authorized representative shall have the authority to enter all areas covered by this permit at any reasonable hour to enforce the provisions of the codes applicable to this permit.

Signature of applicant: <u><i>Palmer Peters</i></u>	Date: <u>11-7-05</u>
---	----------------------

This is not a permit; you may not commence ANY work until the permit is issued.

201 LAMBERT STREET-PORTLAND, ME 04103 Chart # 385 Block ##A Lot# 7

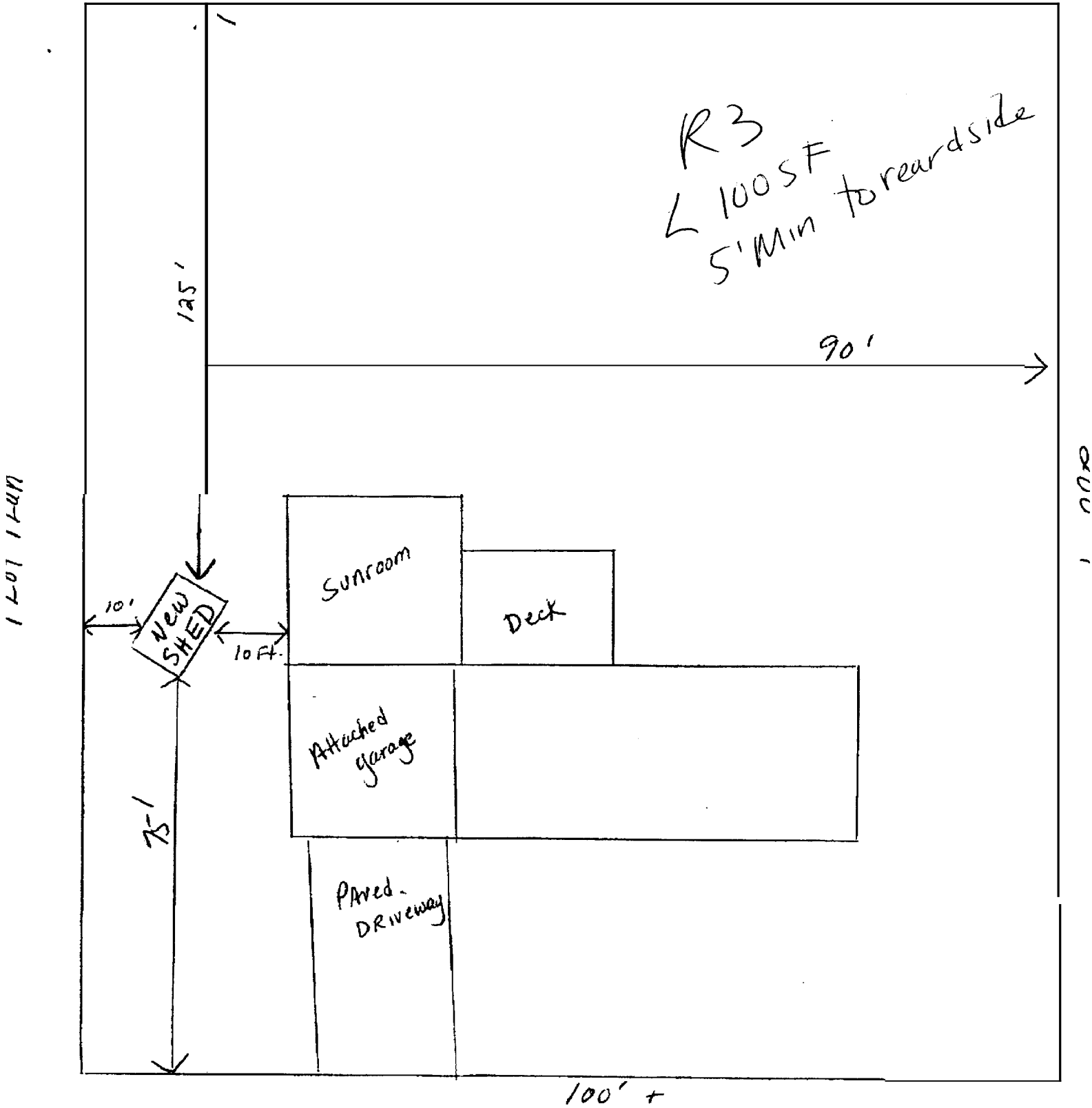

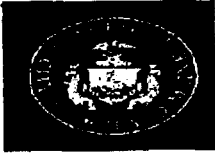

PORTLAND MAINE

Strengthening a Remarkable City. Building a Community for Life - www.portlandmaine.gov

Health & Human Services Department
Douglas S. Gardner, Director

Social Services Division
Robert Duranleau, Administrator

FAX

TO: LAMI

FROM: P. Peters

FAX #: 874-8716

OF PGS: 3 (Including Cover)

PHONE: _____

DATE: 11-7-05

RE: Review

COMMENTS:

I hope this makes sense -

NOTICE

This fax message is intended for the exclusive use of the individual or entity identified above. It may contain information that is privileged and/or confidential under both state and federal law. If you are not the intended recipient or an agent of the recipient, you are hereby notified that any further dissemination, copy, or disclosure of this communication and information contained herein is strictly prohibited. If you have received this transmittal in error, please immediately notify us at 207-775-5921 and return the original transmission to us by mail without making/retaining a copy. Your cooperation in protecting confidential information is greatly appreciated.

Social Services Division
1% Lancaster Street Portland, Maine 04101 Ph (207) 775-7911 Fx (207) 775-7918 TTY 775-6314

Structurally the Best Shed Available

Our sheds are built on P.T. 4" x 4" Skids
 6' and 8' wide sheds have 2 x 4 floorjoist 16" OC
 10' and wider sheds have 2 x 6 floorjoist 16" OC
 3/4" CDX Floor Sheathing
 Walls and roof framing 2 x 4, 16" OC
 Industry first metal wall bracing
 7/16" OSB roof sheathing
 Drip edge on rakes and eaves, 25 yr asphalt shingles
 2- 8" x 8" Aluminum Gable Vents
 shed 8 x 10 and smaller 1 window, larger with 2 windows
 Standard shed 1 door (30" single, 4' or 5' double
 Collar ties on all gambrels and regulars 10' and wider)



2 x 4 framing 16" O.C.



Industry First Metal Wall Bracing

Delivery

-Free delivery within 30 miles, we will deliver anywhere! (each additional mile over 30 will \$2.00 per mile)
 -Concrete blocks included in price (each end and 1 time in the middle up to 16' long, 2 times in the middle on 20' and larger)

delivery is considered to be driveway only (as long as property owner assumes full non-binding responsibility, we will place your shed where you want within our abilities and reason)

property owner is fully responsible for all permits to be obtained by their respective town (And are urged to do so) Also property owner is responsible to ensure all set backs from property lines are conformed to

-Site requires a 3' clear perimeter around where shed will be placed, land grade must be less than 12" from highest to lowest points with no protruding stumps or rocks, clear access to site is necessary

-Delivery schedule shall be Monday through Thursday, any shed that requires a Friday or Saturday delivery will be charged an additional \$100.00

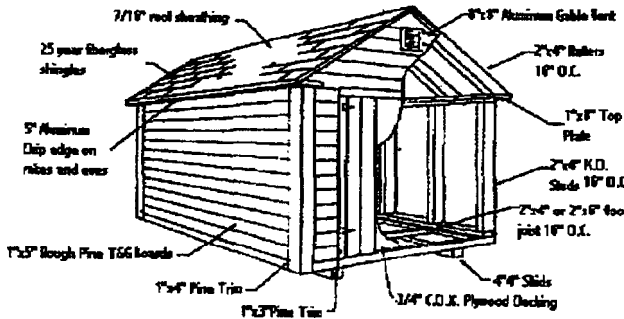

Notes

There is a charge to build your shed on site (this charge may vary) Its better if you can to put the shed someplace you can move it if you e v a need to
 -The average cost to move one of our sheds is \$350.00, to move a shed built by our competition (our competitors do not offer the service of moving their sheds) \$500.00
 -moving rocks, trash, or other item to have a clean safe work area will be charged a minimum fee of \$25.00
 -All of our structures are ordered to your specifications so we shall charge a 20% restocking fee on any cancelled orders after construction has begun
 -1/3 payment is due upon ordering your shed, the remaining balance is due upon completion of the shed, upon delivery
 -Failed or missed delivery appointments shall be charged \$150
 -Materials are subject to change without notice at manufacturers discretion

Limited Warranty

Shed Happens, Inc. warrants your building to the original owner as long as it remains in its original location against defects in workmanship and materials for 10 years, under normal residential use only. Our structures are not designed for commercial applications, except by written agreement with our customers. Shed Happens, Inc. makes no warranty expressed or implied With respect to customer's designs and specifications, except that products will be free from defects in workmanship and materials as indicated previously. No warranties are made, expressed or implied, with respect to doors and windows which are used in the construction of our buildings.

Screenhouse

We offer High Quality Screen Houses with removable metal screens. Available in all sizes, prices are same as Gambrel Shed Prices.

Shed Happens, Inc.

Structurally the Best manufactured Shed Available Gauranteed 2005

Mailing Address: 7042 Chadbourne Road Standish, Me 04084
 Phone #892-3636 Fax # 892-3622
 Retail Location: intersection of Rte 302 and 115 North Windham
WWW.Shedhappens.com

ATTN: LAM

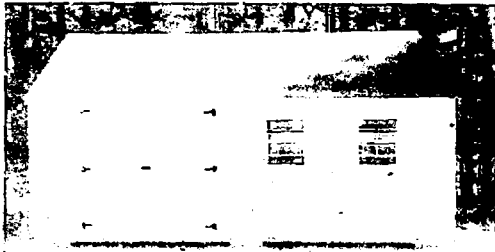

Gable

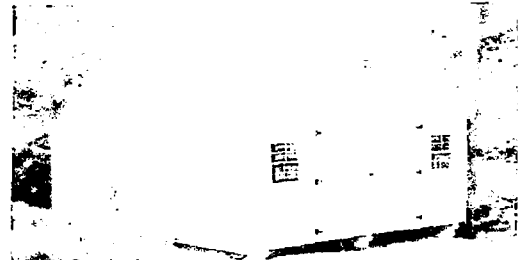

Gambrel

Delivery, setup and leveling are included granted 3 criteria are satisfied
 Delivery is within 30 d e s of Standish, over 30 miles is \$2 per mile one way
 That we can back our 1 ton pickup truck and 18' trailer up to shed site
 That the shed site grade is less than 12" from high comer to low comer

Gable Roof		Gambrel Roof	
6' x 8'	\$1225	12' x 12'	\$2575
6' x 10'	\$1400	12' x 14'	\$2900
6' x 12'	\$1575	12' x 16'	\$3100
8' x 8'	\$1475	12' x 20'	\$3925
8' x 10'	\$1675	12' x 24'	\$4950
8' x 12'	\$1875	14' x 14'	\$3578
8' x 14'	\$2100	14' x 16'	\$4082
8' x 16'	\$2325	14' x 20'	\$5082
8' x 20'	\$2900	14' x 24'	\$6182
10' x 10'	\$1975		
10' x 12'	\$2225		
10' x 14'	\$2475		
10' x 16'	\$2675		
10' x 20'	\$3475		
		6' x 8'	N/A
		6' x 10'	N/A
		6' x 12'	N/A
		8' x 8'	\$1575
		8' x 10'	\$1775
		8' x 12'	\$1975
		8' x 14'	\$2225
		8' x 16'	\$2425
		8' x 20'	\$3000
		10' x 10'	\$2100
		10' x 12'	\$2350
		10' x 14'	\$2625
		10' x 16'	\$2825
		10' x 20'	\$3600
		12' x 12'	\$2725
		12' x 14'	\$3050
		12' x 16'	\$3250
		12' x 20'	\$4075
		12' x 24'	\$5100
		14' x 14'	\$3778
		14' x 16'	\$4282
		14' x 20'	\$5282
		14' x 24'	\$6382

Quickest average delivery time in the Industry. Guaranteed! (Due to delivering completely built sheds) 2 week turnaround for most orders (excludes custom orders and materials) SHI is the only Shed company that can or will give you a delivery date ut time of order!

DISPLAY THIS CARD ON PRINCIPAL FRONTAGE OF WORK

CITY OF PORTLAND

Please Read Application And Notes, If Any, Attached

BUILDING INSPECTION

PERMIT

PERMIT ISSUED,
NOV 14 2005
CITY OF PORTLAND

Permit Number 51634

This is to certify that PETERS PALMER F & RAUEL L CONLEY ITS/Shed Housens

has permission to install an 8' x 12' Shed

AT 201 LAMBERT ST

385 A007001

provided that the person or persons who perform or supervise the work in accepting this permit shall comply with all of the provisions of the Statutes of the State and of the Ordinances of the City of Portland regulating the construction, maintenance and use of buildings and structures, and of the application on file in this department.

Apply to Public Works for street line and grade if nature of work requires such information.

Notification of inspection must be given and when permission proceeds before this building or part thereof is started or closed-in. 4 HOUR NOTICE IS REQUIRED.

A certificate of occupancy must be procured by owner before this building or part thereof is occupied.

OTHER REQUIRED APPROVALS

Fire Dept _____

Health Dept _____

Appeal Board _____

Other _____

Department Name

Jeannie Boule 11/9/05
Director - Building & Inspection Services

PENALTY FOR REMOVING THIS CARD